

CHAPTER

75

AIR



CHAPTER 75
AIR

CH-SC-SU	Schem	Page	Sheet	Date	CH-SC-SU	Schem	Page	Sheet	Date
75-EFFECTIVE PAGES									
		1		Aug 10/2009					
		2		BLANK					
75-CONTENTS									
		1		May 11/2009					
		2		BLANK					
75-ALPHABETICAL INDEX									
		1		Jan 18/2007					
		2		BLANK					
75-30-00									
		101	1	Feb 09/2009					
			2	Feb 09/2009					
75-31-11									
		101		May 11/2009					
		102		May 11/2009					
75-31-12									
		101		Feb 09/2009					
75-31-21									
		101		Jul 17/2007					
		102		May 11/2009					
75-31-22									
		101		Feb 09/2009					

A = Added, R = Revised, D = Deleted, O = Overflow

75-EFFECTIVE PAGES



CHAPTER 75
AIR

Title	CH-SC-SU	Schem	Page	Sheet	Date	Effectivity
<u>COMPRESSOR CONTROL</u>						
ENGINE AIR SYSTEM	75-30-00		101	1	Feb 09/2009	ALL
				2	Feb 09/2009	ALL
<u>TURBINE VARIABLE STATOR VANE (VSV) CONTROL</u>						
ENGINE 1 TURBINE CLEARANCE / TEMPERATURE	75-31-11		101		May 11/2009	YC001-YC050
			102		May 11/2009	YK901-YM670
ENGINE 1 VARIABLE STATOR VANE / BLEED CONTROL	75-31-12		101		Feb 09/2009	ALL
ENGINE 2 TURBINE CLEARANCE / TEMPERATURE	75-31-21		101		Jul 17/2007	YC001-YC050
			102		May 11/2009	YK901-YM670
ENGINE 2 VARIABLE STATOR VANE / BLEED CONTROL	75-31-22		101		Feb 09/2009	ALL

CHAPTER 75
AIR

CH-SC-SU	Title
75-31-11	ENGINE 1 TURBINE CLEARANCE / TEMPERATURE
75-31-12	ENGINE 1 VARIABLE STATOR VANE / BLEED CONTROL
75-31-21	ENGINE 2 TURBINE CLEARANCE / TEMPERATURE
75-31-22	ENGINE 2 VARIABLE STATOR VANE / BLEED CONTROL
75-30-00	ENGINE AIR SYSTEM

CH-SC-SU	Title
----------	-------

75-ALPHABETICAL INDEX

THIS PAGE INTENTIONALLY LEFT BLANK

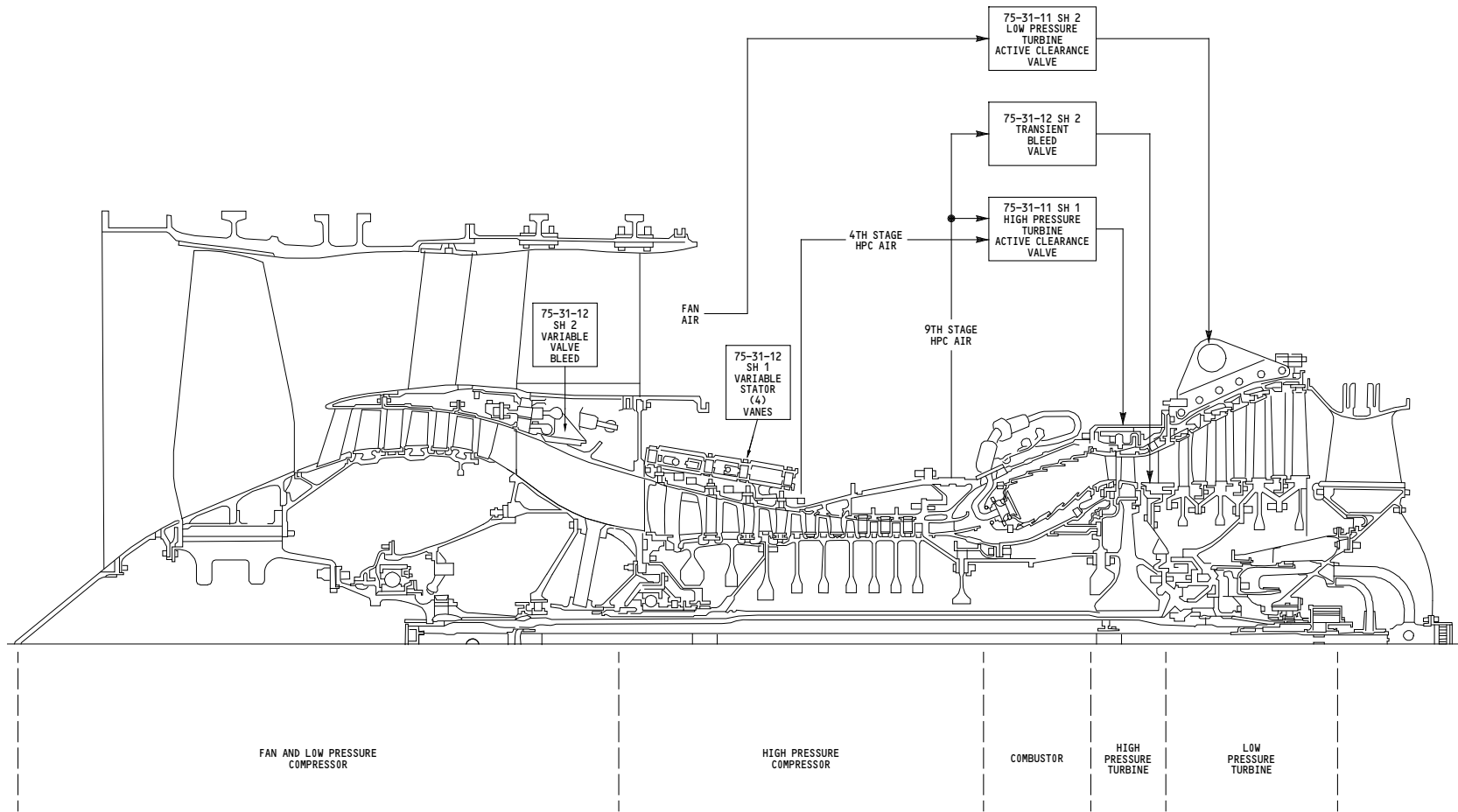

ALL	<p align="center">ENGINE AIR SYSTEM</p> <p align="center">D280A203</p>
-----	---

75-30-00

Page 101
Sheet 1
Feb 09/2009

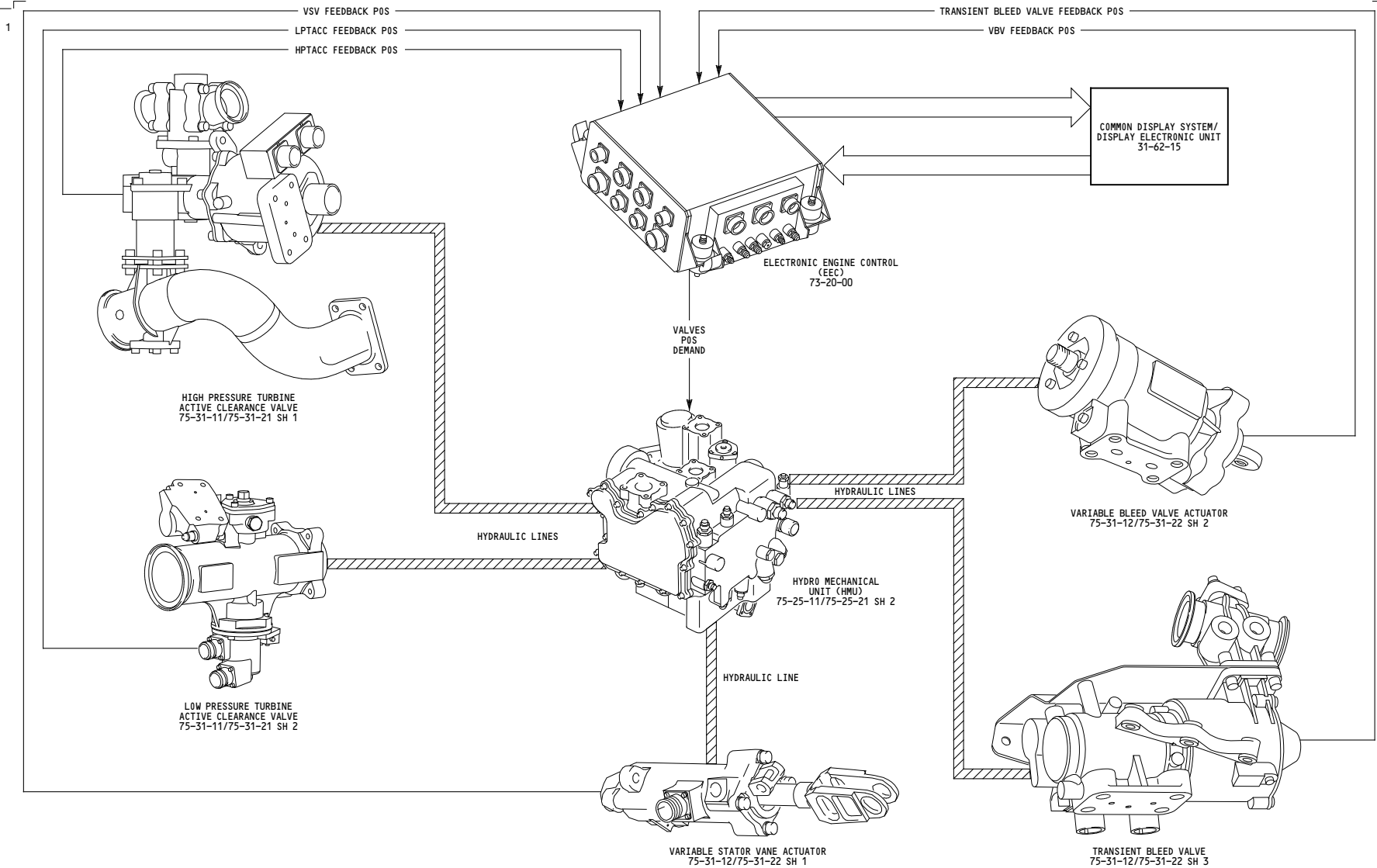

ALL	<p>ENGINE AIR SYSTEM</p> <p>D280A203</p>
-----	---

75-30-00

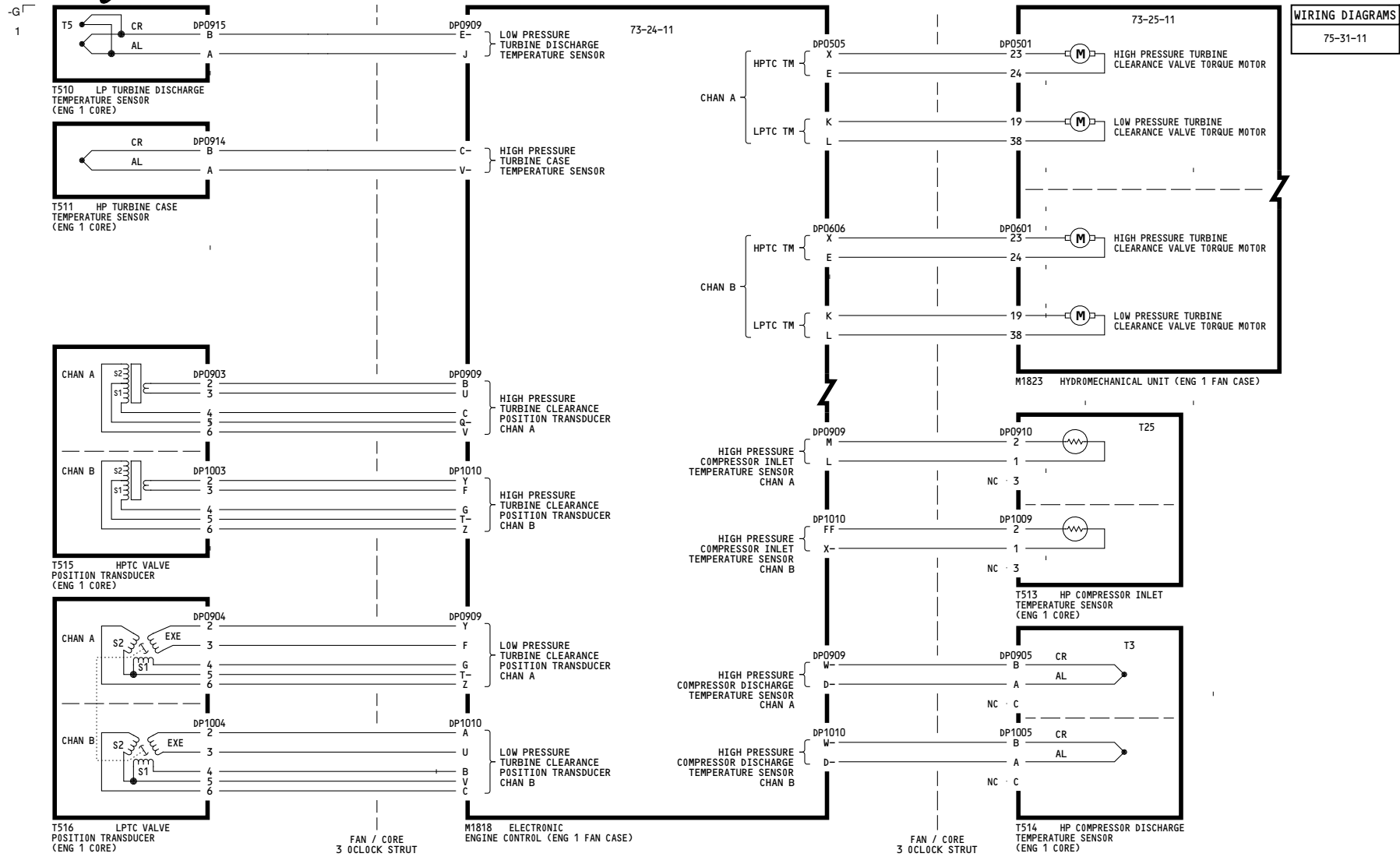

YCO01-YC050	<p>ENGINE 1 TURBINE CLEARANCE / TEMPERATURE</p> <p>D280A203</p>
-------------	--

-B
2

WIRING DIAGRAMS
75-31-11

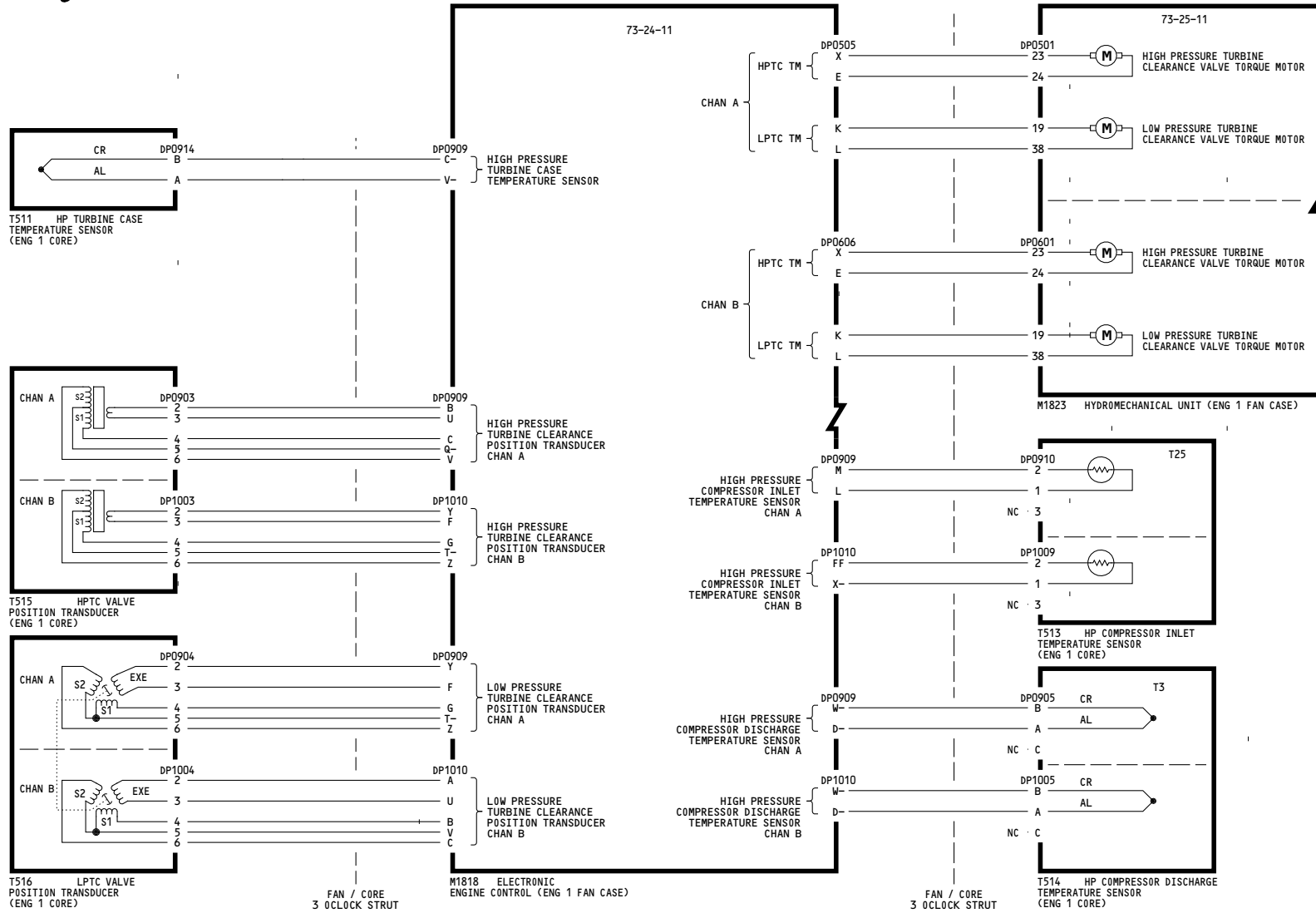

YK901-YM670	ENGINE 1 TURBINE CLEARANCE / TEMPERATURE
	D280A203

75-31-11

Page 102

May 11/2009

-G
1

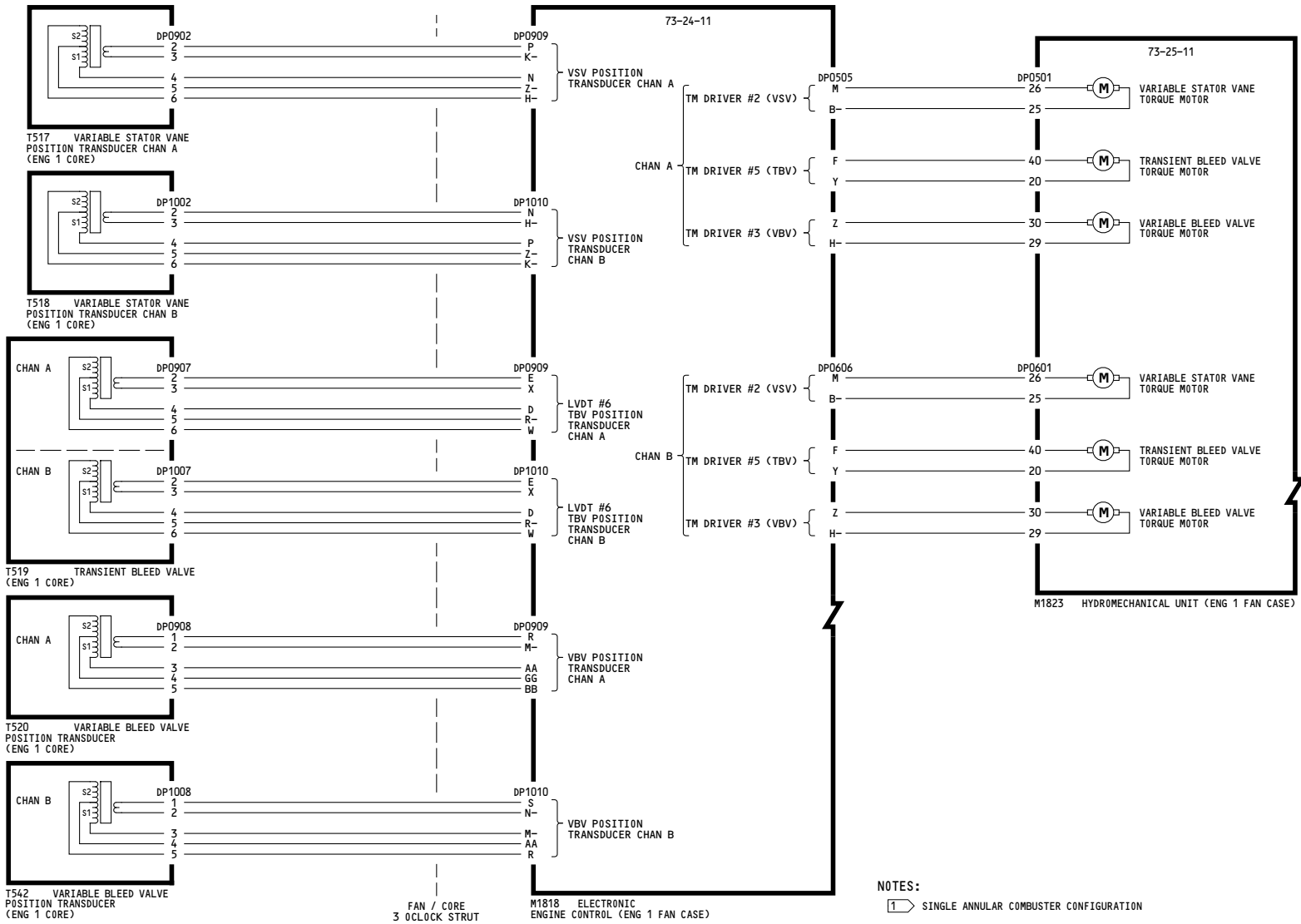

NOTES:
 1 SINGLE ANNULAR COMBUSTOR CONFIGURATION

ALL

ENGINE 1 VARIABLE STATOR VANE / BLEED CONTROL

D280A203

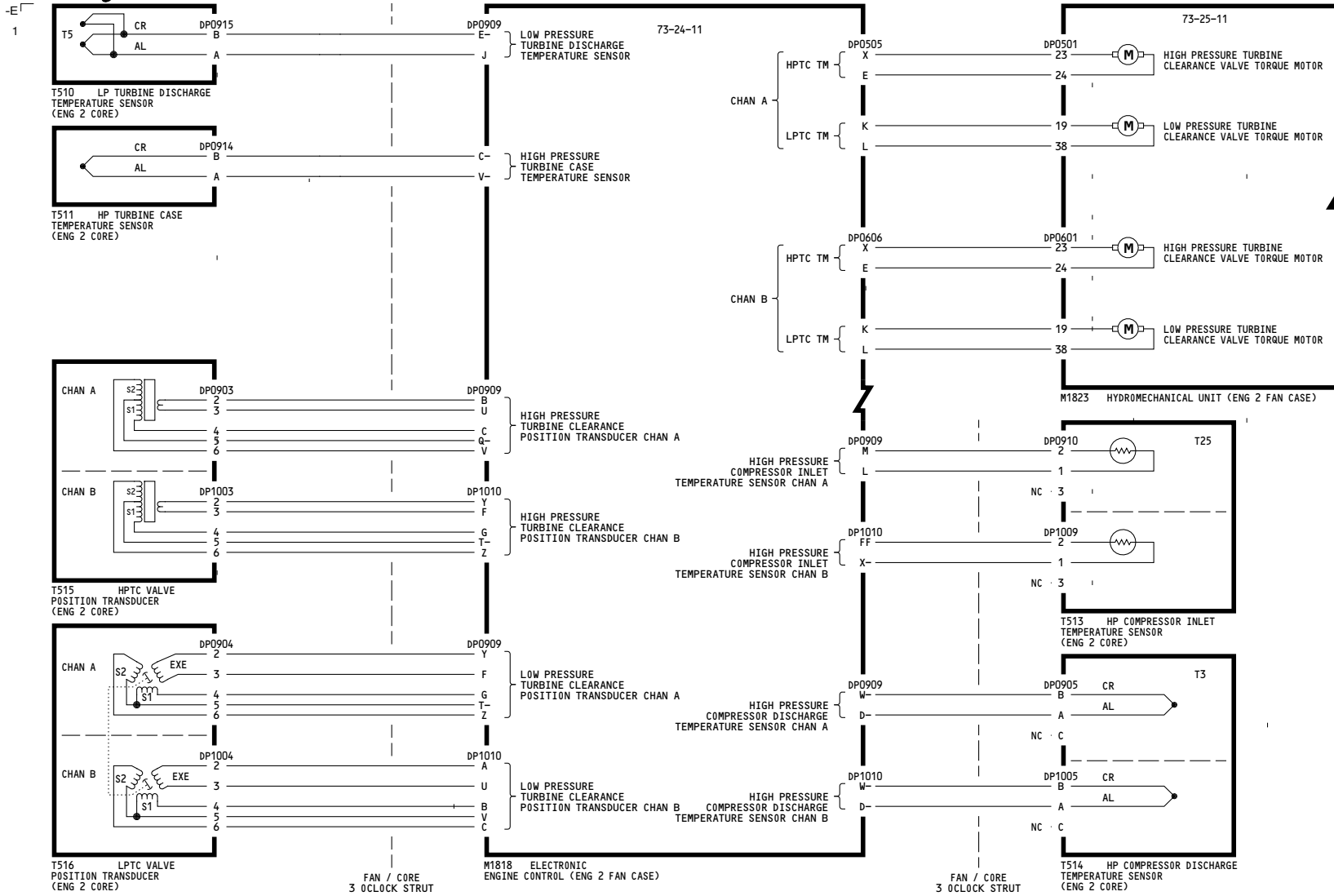

YC001-YC050

**ENGINE 2 TURBINE
CLEARANCE / TEMPERATURE**

D280A203

75-31-21

-C-
2

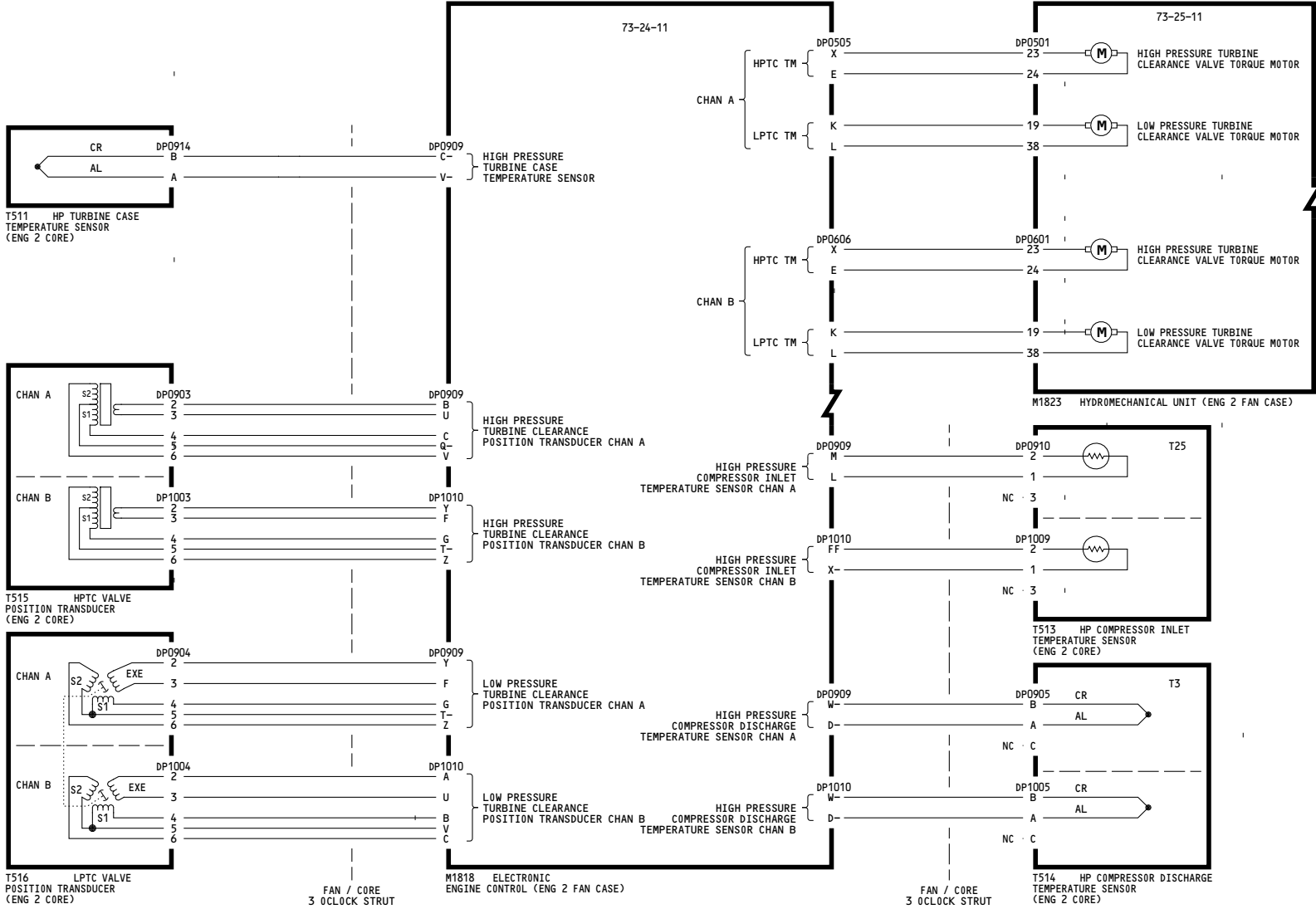

YK901-YM670	<p>ENGINE 2 TURBINE CLEARANCE / TEMPERATURE</p> <p>D280A203</p>
-------------	--

75-31-21

Page 102

May 11/2009

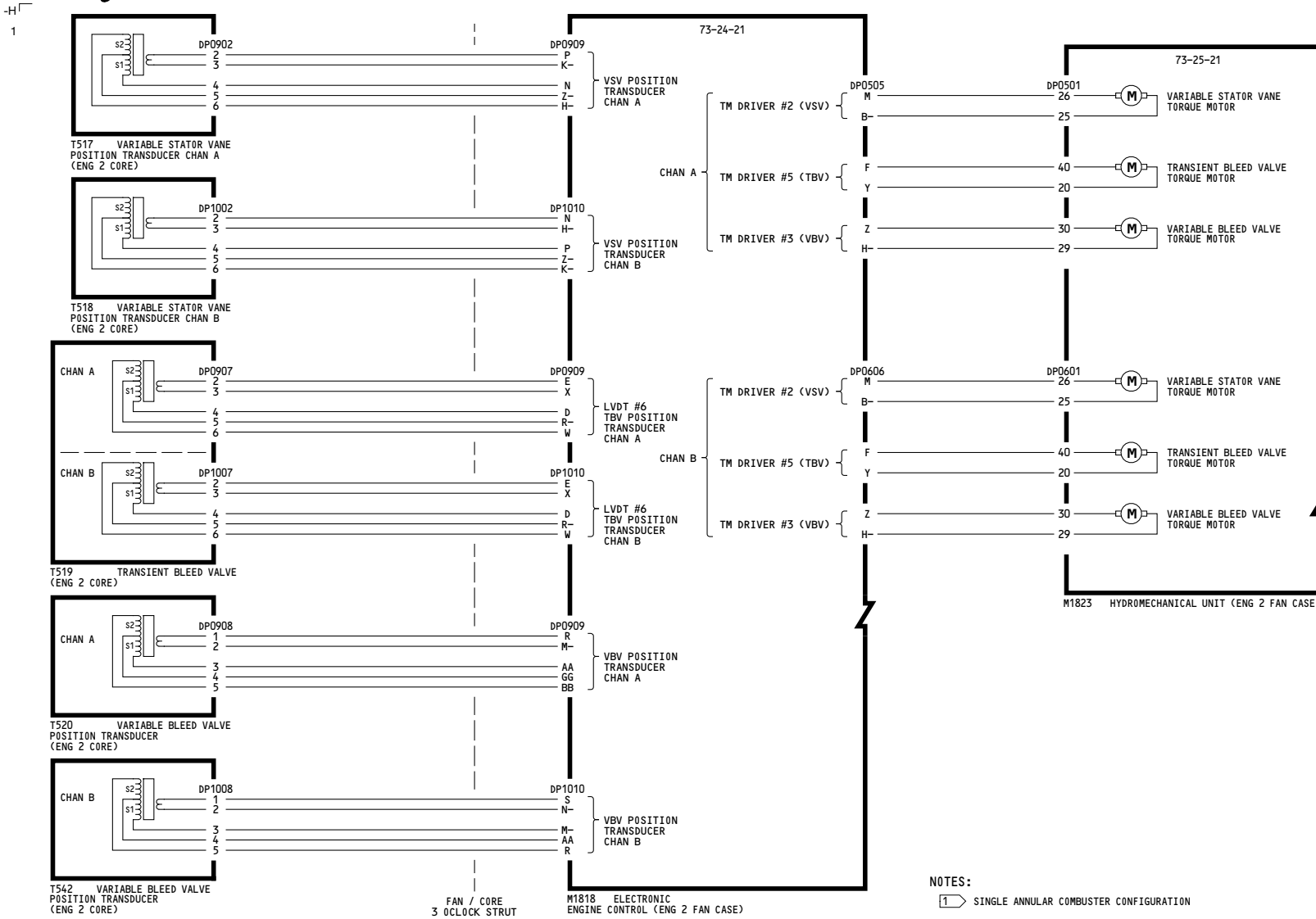

ALL

ENGINE 2 VARIABLE STATOR VANE / BLEED CONTROL

D280A203

75-31-22