

TO: ALL HOLDERS OF NOSE DOME ASSEMBLY OVERHAUL MANUAL, 71-13-16

REVISION NO. 2, DATED MAR 1/04
HIGHLIGHTS

DESCRIPTION OF CHANGE	TOPICS AFFECTED												
	D & O	D / A s s y	C l e a n i n g	I n s p / C h k	R e p a i r	A s s y	F / C	T e s t	T / S h o o t i n g	S / T o o l s	S t o r a g e	I P L	L / O v e r h a u l
Added washer and clarified illustration												X	

NOSE DOME ASSEMBLY

71-13-16

BOEING P/N 65-19684-2
65-85369-11, -12, -15, -16

AIRLINE P/N

THE FOLLOWING DIRECTIVES APPLY TO THIS SUBJECT:

BOEING SERVICE BULLETIN	BOEING TEMPORARY REVISION	OTHER DIRECTIVES	DATE DIRECTIVE INCORPORATED INTO TEXT
737-71-1253		MC 5460MK3003	Mar 5/92

LIST OF EFFECTIVE PAGES

- * Indicates pages revised, added or deleted in latest revision
 F Indicates foldout pages - print one side only

PAGE	DATE	PAGE	DATE	PAGE	DATE
71-13-16					
T-1	Mar 5/92				
T-2	BLANK				
* LEP-1	Mar 1/04				
LEP-2	BLANK				
T/C-1	May 10/80				
T/C-2	BLANK				
1	Mar 5/92				
2	Mar 5/92				
3	Mar 5/92				
* 4	Mar 1/04				
* 5	Mar 1/04				
6	BLANK				

Mar 1/04

 71-13-16
 Page LEP-1

BOEING 
COMMERCIAL JET
OVERHAUL MANUAL

TABLE OF CONTENTS

<u>Paragraph Title</u>	<u>Page</u>
Description and Operation	1
Disassembly	*[1]
Cleaning.	*[2]
Inspection/Check.	*[1]
Repair.	1
Assembly.	*[1]
Fits and Clearances (not applicable)	
Testing (not applicable)	
Trouble Shooting (not applicable)	
Storage Instructions.	*[3]
Special Tools, Fixtures, and Equipment (not applicable)	
Illustrated Parts List.	2
*[1] Special instructions not required. Use standard industry practices.	
*[2] Special instructions not required. Use applicable procedures in 20-30-03 and standard industry practices.	
*[3] Special instructions not required. Use applicable procedures in 20-70-01 and standard industry practices.	

OVERHAUL MANUAL

NOSE DOME ASSEMBLY

1. DESCRIPTION AND OPERATION

- A. The nose dome assembly is a conically shaped unit consisting of a sheet metal nose cone and a pressure tube. The pressure tube extends through the nose dome.
- B. The unit mounts on the engine nose and guides the flow of engine inlet air. The pressure tube ducts ram air through the nose cone to connecting tubing on the engine.
- C. Leading Particulars (approximately)
 - Length -- 15 inches
 - Diameter -- 12 inches

2. REPAIR

A. Materials

(1) Sealant -- No. 30-121, Dow Corning Corp.; BMS 5-63, Class B, optional (Ref 20-50-12)

(2) Primer -- BMS 10-11, Type 1 (Ref 20-60-02)

B. Replacement of tubing assembly (15, Fig. 1).

(1) Remove bolts (30, 35), washer (25) from bracket (45).

(2) Withdraw tubing assembly (15) from cup (60) and remove from nose dome assembly.

(3) Remove rivets (65) and cup (60) from cone (10).

(4) Remove sealant from cup and inner dome of cone.

(5) Touch up cup and inner dome of cone as necessary with primer BMS 10-11, Type 1 (Ref 20-60-02).

(6) Install cup in cone with rivets (65).

(7) Position small end of tubing through cup and cone in nose dome.

(8) Install bolts (30, 35) and washer (25).

(9) Fill cavity between cup and cone through existing filler holes with sealant per 20-50-12.

OVERHAUL MANUAL

C. Replacement of tube assembly (30, Fig. 2).

- (1) Remove bolts (10) and acoustic panel assembly (5) from the engine.
- (2) Remove bolts (35, 40), clamp (45) and lockwire (50).
- (3) Withdraw tube assembly (30) from cup (20) and remove from nose dome assembly.
- (4) Remove rivets (25) and cup (20) from cone (15).
- (5) Remove sealant from cup and inner dome of cone.
- (6) Touch up cup and inner dome of cone as necessary with primer BMS 10-11, Type 1 (Ref 20-60-02).
- (7) Install cup in cone with rivets (25).
- (8) Position small end of tubing through cup and cone in nose dome. Extend tube end 0.08-0.12 inch past nose dome tip.
- (9) Install bolts (35, 40), clamp (45) and lockwire (50).
- (10) Fill cavity between cup and cone, through existing filler holes, with sealant per 20-50-12.
- (11) Install acoustic panel on engine with bolts (10).

3. ILLUSTRATED PARTS LIST

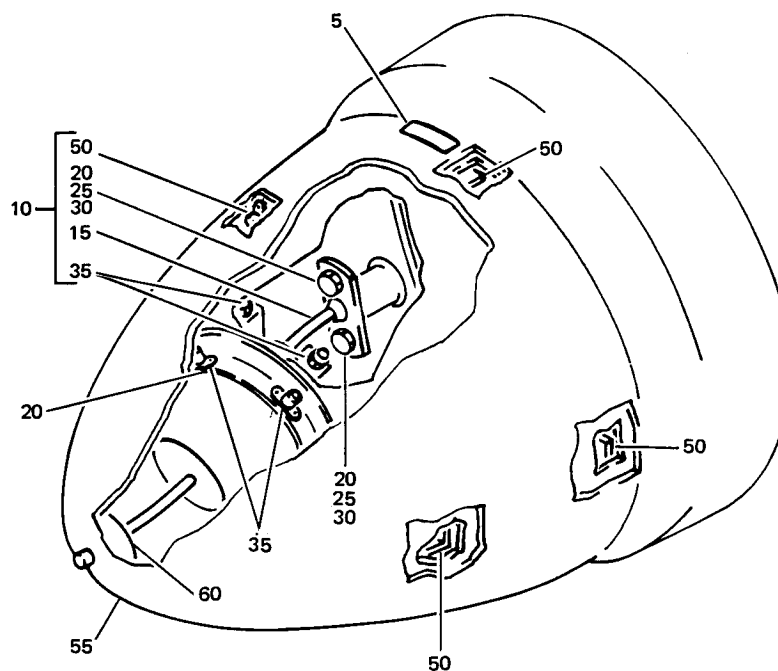

Nose Dome Assembly
Figure 1

65-19684
65-85639



OVERHAUL MANUAL

FIG. & ITEM NO.	PART NO.	AIRLINE PART NUMBER	N O M E N C L A T U R E							USE CODE	QTY PER ASSY
			1	2	3	4	5	6	7		
1-											
1	65-19684-2										RF
5	MS27253-1										1
10	65-19684-17										1
10	65-36532-1										1
15	69-18491-4										1
15	69-18491-3										1
15	69-18491-1										1
20	NAS679A3W										2
25	AN960D10										2
30	NAS1103-4W										2
35	NAS1103-2W										2
40	BAC540R07B20F										AR
45	66-14871-800										4
50	66-14871-801										4
55	65-19684-3										1
60	69-18490-2										1
-65	BACR15CE58										6

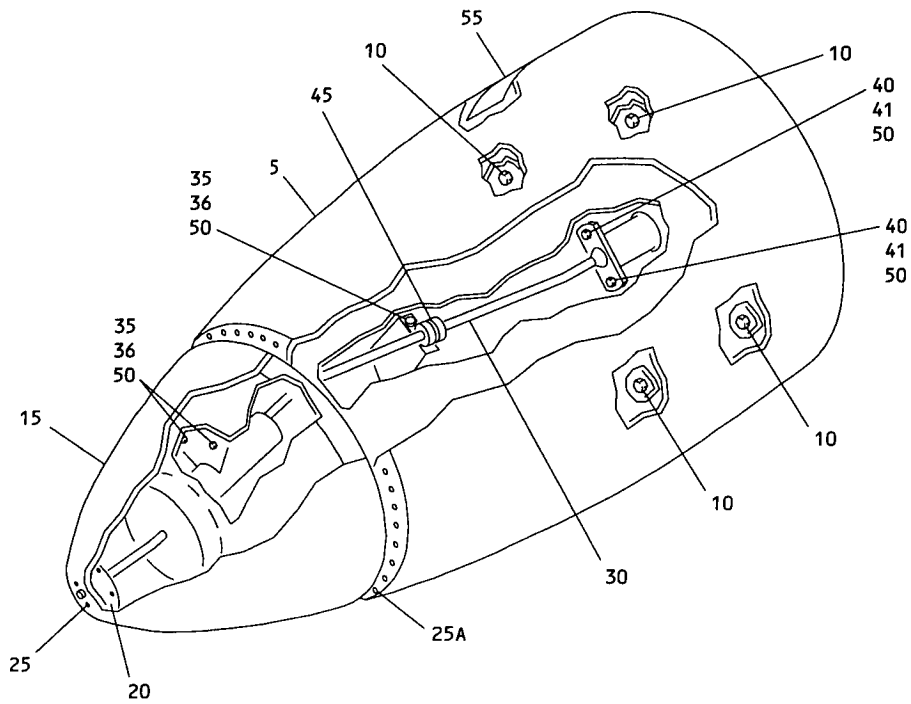

Nose Dome Assembly
Figure 2

FIG. & ITEM NO.	PART NO.	AIRLINE PART NUMBER	NOMENCLATURE							USE CODE	QTY PER ASSY
			1	2	3	4	5	6	7		
2-1	65-85369-11		NOSE DOME ASSY							A	RF
1	65-85369-12		NOSE DOME ASSY							B	RF
1	65-85369-15		NOSE DOME ASSY							C	RF
1	65-85369-16		NOSE DOME ASSY							D	RF
5	10-61900-1		. PANEL ASSY, ACOUSTIC							AC	1
5	10-61900-2		. PANEL ASSY, ACOUSTIC							BD	1
10	BACN10NT5A		ATTACHING PARTS								
			. NUT								4
			-----*-----								
15	65-85369-5		. CONE ASSY							AB	1
15	65-85369-17		. CONE ASSY							CD	1
20	65-85369-9		. . CUP (USED ON 65-85369-5)								1
20	65-85369-19		. . CUP (USED ON 65-85369-17)								1
			ATTACHING PARTS								
25	BACR15CE5D		. . RIVET								6
25A	BACR15CE5D		. . RIVET								24
			-----*-----								
30	65-85681-1		. TUBE ASSY, PT 2							AC	1
30	65-85681-2		. TUBE ASSY, PT 2							BD	1
			ATTACHING PARTS								
35	BACB30NE3H2		. . BOLT								3
36	AN960D10		. . WASHER								3
40	BACB30NE3H4		. . BOLT								2
41	AN960D10		. . WASHER								2
45	BACC10EP4		. . CLAMP								1
50	MS20995NC32		. . LOCKWIRE								AR
55	MS27253F1		PLATE ID								1