

CHAPTER

25

**EQUIPMENT/
FURNISHINGS
GENERAL**



757

ILLUSTRATED TOOL AND EQUIPMENT MANUAL

CHAPTER 25
EQUIPMENT/FURNISHINGS GENERAL

Subject/Page	Date	Subject/Page	Date	Subject/Page	Date
EFFECTIVE PAGES					
1	Sep 20/2008				
2	BLANK				
25-CONTENTS					
R 1	Sep 20/2008				
2	BLANK				
25-10-01					
1	Sep 20/2006				
2	BLANK				
25-20-01					
1	Sep 20/2006				
2	BLANK				
25-20-02					
1	Sep 20/2006				
2	Sep 20/2006				
25-20-03					
1	Sep 20/2006				
2	Sep 20/2006				
25-20-04					
1	Sep 20/2006				
2	Sep 20/2006				
25-20-05					
A 1	Sep 20/2008				
A 2	Sep 20/2008				
A 3	Sep 20/2008				
A 4	Sep 20/2008				
25-30-01					
1	Sep 20/2006				
2	Sep 20/2006				
25-60-01					
1	Sep 20/2006				
2	Sep 20/2006				
25-60-02					
1	Sep 20/2006				
2	Sep 20/2006				
25-60-03					
1	Sep 20/2006				
2	Sep 20/2006				

A = Added, R = Revised, O = Overflow, D = Deleted

25-EFFECTIVE PAGES



757

ILLUSTRATED TOOL AND EQUIPMENT MANUAL

TABLE OF CONTENTS

<u>Subject</u>	<u>Title</u>	<u>Part No.</u>
25-	EQUIPMENT/FURNISHINGS GENERAL	
25-10-01	ADJUSTOR - FRICTION BALL CATCH	A25017-1
25-20-01	GAGE - INSPECTION, SEAT TRACK, FLIGHT CREW	A25020-1, -4, -8
25-20-02	STANDARD TOOL - SPANNER NOSE PLIERS	ST2580-334C
25-20-03	WRENCH, SPANNER TYPE	ST2580-163A
25-20-04	WRENCH - ANTI-RATTLE NUT	C25001-1
I 25-20-05	ANTI-RATTLE NUT WRENCH KIT	G25012-1
25-30-01	REMOVAL/INSTALLATION TOOL - AFT GALLEY G4B AIR CHILLER	B25003-1
25-60-01	FUNCTIONAL TEST EQUIPMENT - ADAPTER, OFF WING ESCAPE SLIDE	B25002-37
25-60-02	TEST BOX - OFF-WING ESCAPE SYSTEM	B25001-1
25-60-03	TEST FIXTURE - PASSENGER DOOR LATCHING MECHANISM	B52007-1

25-CONTENTS

Page 1
Sep 20/2008

D634N501

ILLUSTRATED TOOL AND EQUIPMENT MANUAL

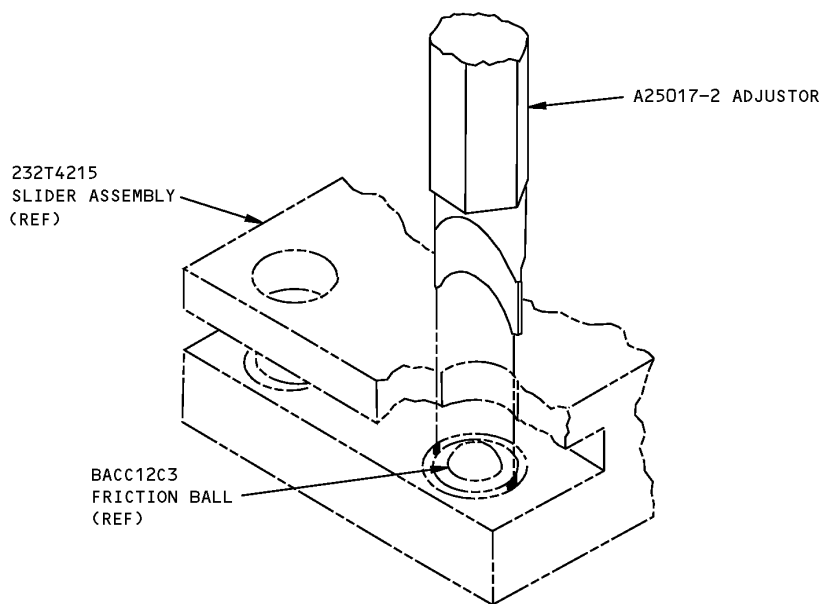
PART NUMBER: A25017-1**NAME:** ADJUSTOR - FRICTION BALL CATCH**AIRPLANE MAINTENANCE:** YES**COMPONENT MAINTENANCE:** NO**USAGE & DESCRIPTION:** Use to adjust the BACC12C3 friction-ball catch. Catch is used on sunvisor slider adjustor and other locations. Tool consists of a -2 adjustor in a -3 bag.**WEIGHT:** 1.0 lb (0.5 kg)**DIMENSIONS:** 3.0 x 2.0 x 2.0 inches (76 x 51 x 51 mm)

**Friction Ball Catch Adjustor
Figure 1**

ILLUSTRATED TOOL AND EQUIPMENT MANUAL

PART NUMBER: A25020-1, -4, -8

NAME: GAGE - INSPECTION, SEAT TRACK, FLIGHT CREW

AIRPLANE MAINTENANCE: YES

COMPONENT MAINTENANCE: NO

USAGE & DESCRIPTION: The gages included in this tool are used to measure seat track wear to determine when the wear limit has been reached and the track should be replaced. Refer to AMM 25-11-01 for further usage instructions. Each gage consists of a steel bar with a protrusion that fits into the holes, and into the troughs worn between the holes of the seat tracks. The -8 tool consists of 2 separate gages, a -5 gage which is used to measure IPECO seat tracks, and a -9 gage which is used to measure WEBER seat tracks. They are stored together in a -6 box assembly. The -4 tool consists of only a -5 gage which is stored in a -6 box assembly. The -1 tool consists of only a -2 gage which is stored in a -3 box assembly. Both the -4 and the -1 tools are used to measure the IPECO seat tracks only.

DIMENSIONS: 1 x 1 x 2 inches (25 x 25 x 51 mm)

NOTE: A25020-8 replaces A25020-4 for future procurement.
A25020-4 replaces A25020-1 for future procurement.

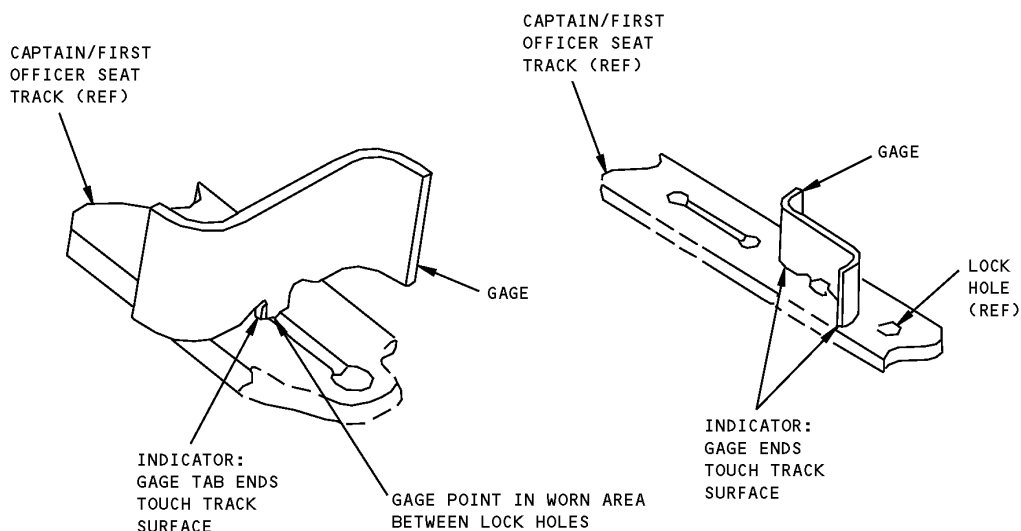

**Flight Crew Seat Track Inspection Gauge
Figure 1**



757

ILLUSTRATED TOOL AND EQUIPMENT MANUAL

PART NUMBER: ST2580-334C

NAME: STANDARD TOOL - SPANNER NOSE PLIERS

AIRPLANE MAINTENANCE: YES

COMPONENT MAINTENANCE: NO

USAGE & DESCRIPTION: This tool is used to tighten anti-rattle nuts on passenger seats to seat tracks. Refer to AMM 25-25-01 for further usage instructions. The tool comes in two sizes: The -145, (0.145 inch spanner teeth) used on Rumbold seats and -185, (0.185 inch spanner teeth) used on Weber, Sicma and Recaro seats.

TABLE 1			
A DIAMETER + 0.005/-0.005	SEAT VENDOR	TOOL PART NUMBER	NUT PART NUMBER
0.185	RECARO	ST2580-334C-1-185	134-00-101-09
0.185	SICMA	ST2580-334C-1-185	91-000100-726-0
0.185	WEBER	ST2580-334C-1-185	823377-403
0.185	WEBER	ST2580-334C-1-185	845901-401
0.185	RUMBOLD	ST2580-334C-1-145	M78203-662

DIMENSIONS: 3 x 3 x 10 inches (76 x 76 x 254 mm)

NOTE: ST2580-334C replaces ST2580-163A for future procurement.

ILLUSTRATED TOOL AND EQUIPMENT MANUAL

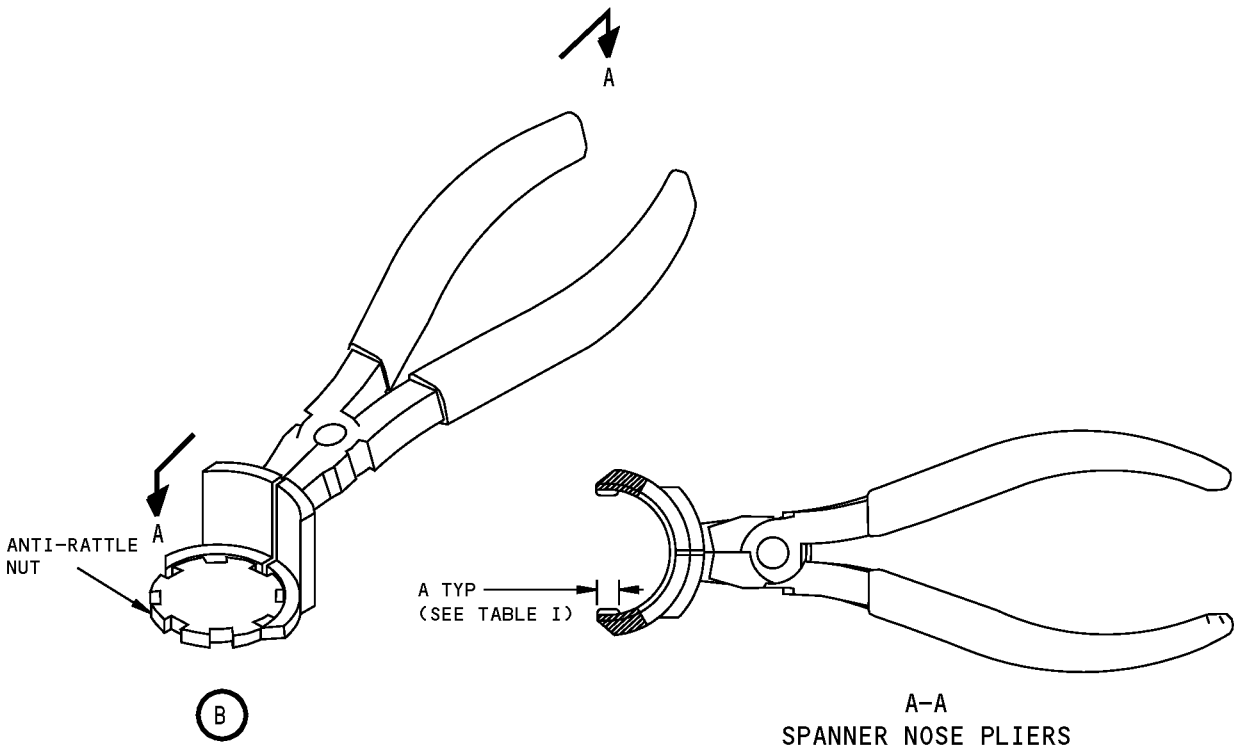
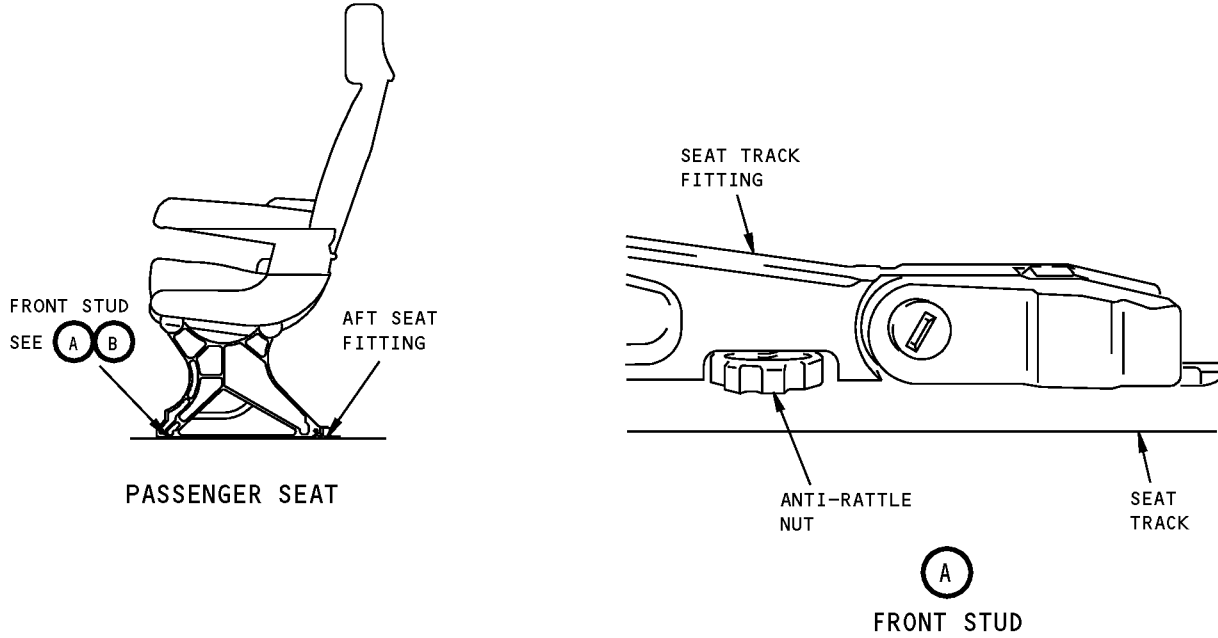

**Spanner Nose Pliers Standard Tool
Figure 1**



757

ILLUSTRATED TOOL AND EQUIPMENT MANUAL

PART NUMBER: ST2580-163A

NAME: WRENCH, SPANNER TYPE

AIRPLANE MAINTENANCE: YES

COMPONENT MAINTENANCE: NO

USAGE & DESCRIPTION: This tool is used to tighten the anti-rattle nut part number 823377-403 that connect the front legs on Weber passenger seats to the airplane seat tracks. This tool consists of a half socket with a handle welded to it.

DIMENSIONS: 1.5 x 7.0 inches (38 x 178 mm)

NOTE: ST2580-334C replaces ST2580-163A for future procurement.

**757
ILLUSTRATED TOOL AND EQUIPMENT MANUAL**

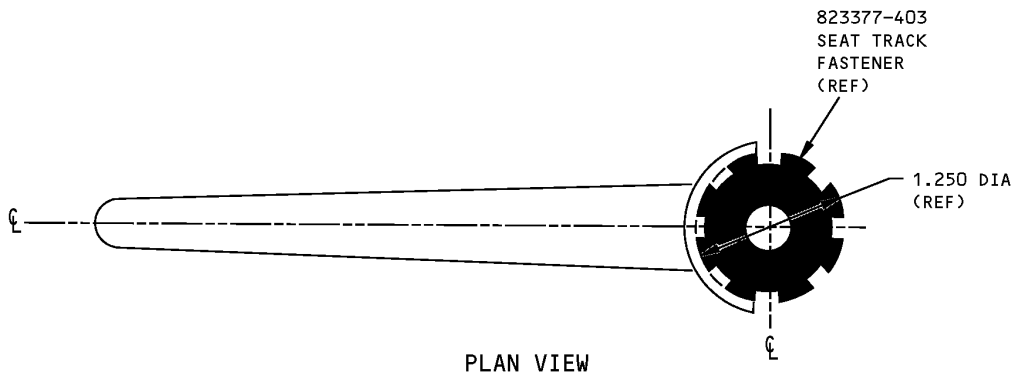
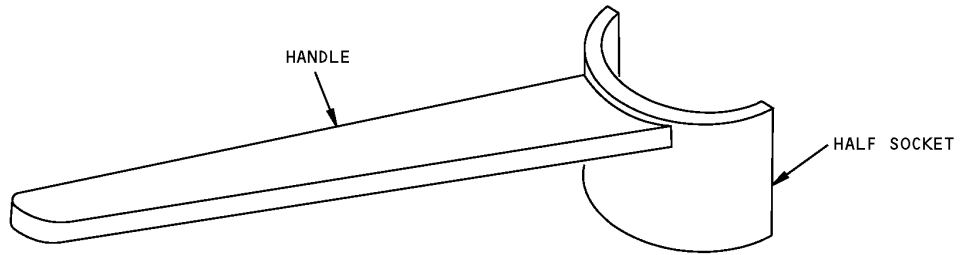

**Spanner Type Wrench
Figure 1**



757

ILLUSTRATED TOOL AND EQUIPMENT MANUAL

PART NUMBER: C25001-1

NAME: WRENCH - ANTI-RATTLE NUT

AIRPLANE MAINTENANCE: YES

COMPONENT MAINTENANCE: NO

USAGE & DESCRIPTION: The C25001-1 wrench is used on all 757 passenger airplanes equipped with certain Recardo, Sicma, Weber and Rumbold passenger seats. The C25001 wrench is used to tighten and loosen Recardo 134-00-101-09, Sicma 91-000100-726-0, Weber 82377-403 and 845901-401 and Rumbold M78203-662 anti-rattle nuts. Refer to AMM 25-20-01 for complete usage instructions. C25001-1 consists of a C25001-2 wrench assembly contained in a storage box.

WEIGHT: 1 lb (0.45 kg)

DIMENSIONS: 2 x 6 X 10 inches (51 x 152 x 254 mm)

ILLUSTRATED TOOL AND EQUIPMENT MANUAL

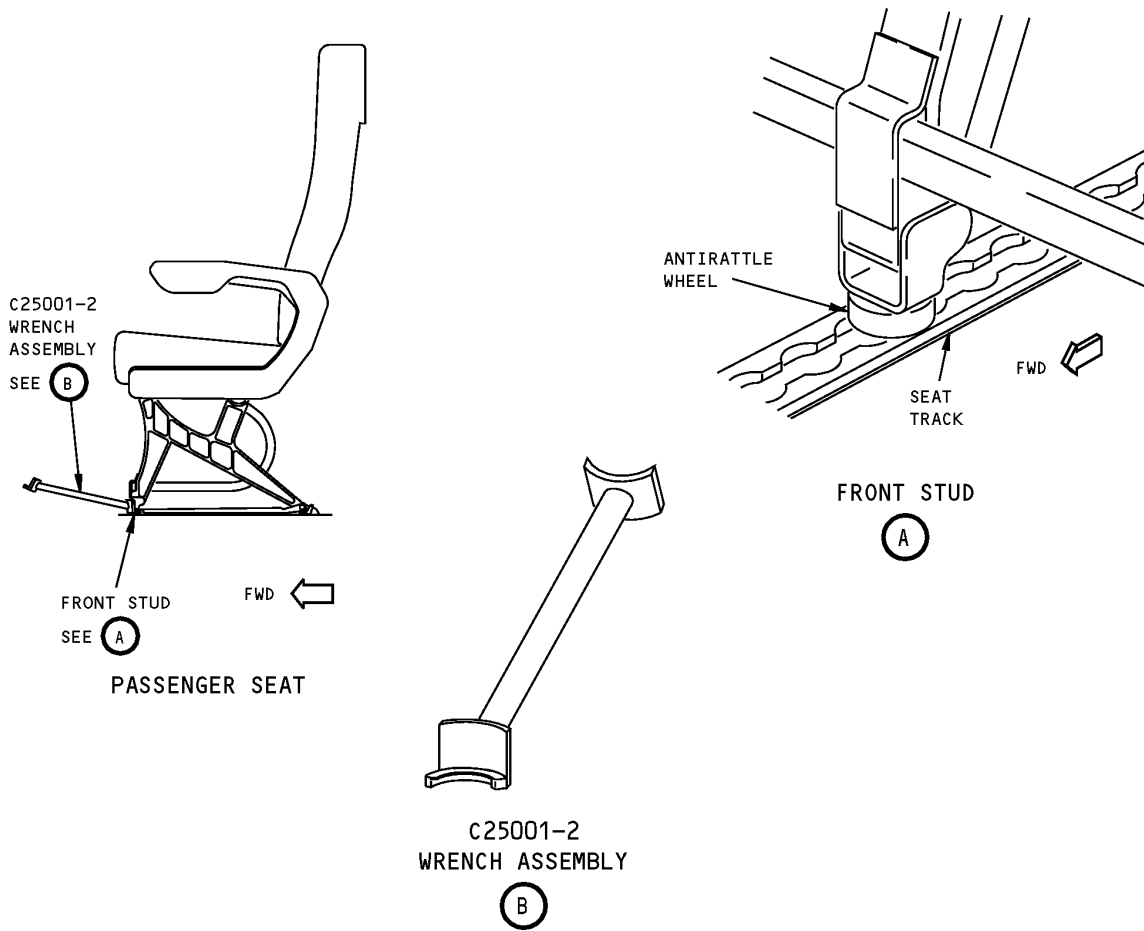

**Anti Rattle Nut Wrench
Figure 1**



757

ILLUSTRATED TOOL AND EQUIPMENT MANUAL

PART NUMBER: G25012-1

NAME: ANTI-RATTLE NUT WRENCH KIT

AIRPLANE MAINTENANCE: YES

COMPONENT MAINTENANCE: NO

USAGE & DESCRIPTION: The G25012-1 anti-rattle nut wrench kit is used on all passenger 757 airplanes, 737 airplanes, 747 airplanes, 767 airplanes and 777 airplanes.

G25012-1 anti-rattle nut wrench kit is used to tighten and loosen anti-rattle nuts and screws on passenger seats. Refer to the current G25012 drawing and AMM 25-25-01 for complete usage instructions.

G25012-1 consists of:

G25012-1 ANTI-RATTLE NUT WRENCH KIT		
QUANTITY	NOMENCLATURE	PART NUMBER
1	WRENCH	G25012-2
1	WRENCH	G25012-3
1	WRENCH	G25012-4
1	WRENCH	G25012-5
1	WRENCH ASSEMBLY	C25001-2
1	SCREWDRIVER, #3 PHILLIPS HEAD (OPTIONAL)	SDDP63
1	STORAGE BOX	

WEIGHT: 4.7 lbs (2 kg)

DIMENSIONS: 3 x 6 x 12 in (76 x 152 x 305 mm)

ILLUSTRATED TOOL AND EQUIPMENT MANUAL

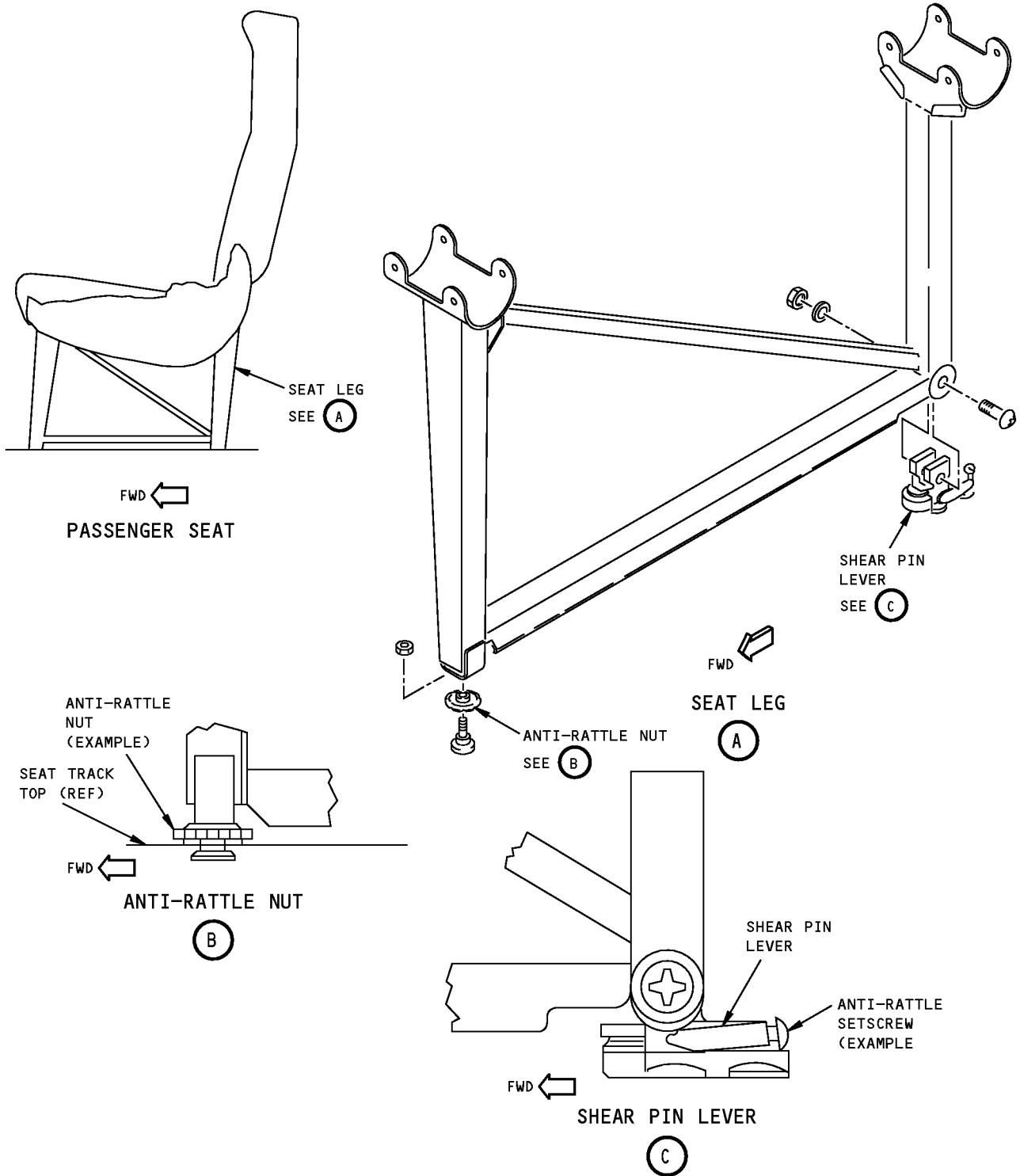

1627522 S0000297094_V1

G25012 ANTI-RATTLE WRENCH KIT
Figure 1 (Sheet 1 of 3)

757
ILLUSTRATED TOOL AND EQUIPMENT MANUAL

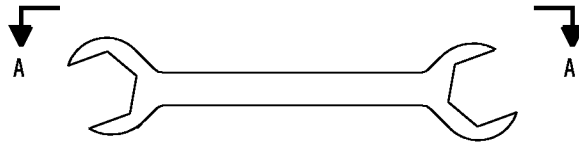

G25012-4
WRENCH

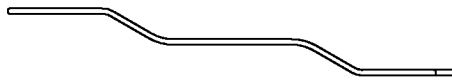

A-A

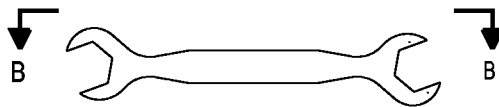

G25012-2 WRENCH SHOWN
G25012-3 WRENCH SIMILAR

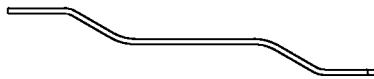

B-B

1627550 S0000297107_V1

G25012 ANTI-RATTLE WRENCH KIT
Figure 1 (Sheet 2 of 3)

757
ILLUSTRATED TOOL AND EQUIPMENT MANUAL

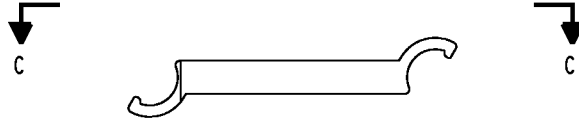

G25012-5
WRENCH

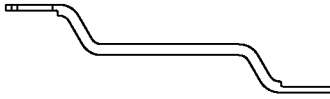

C-C

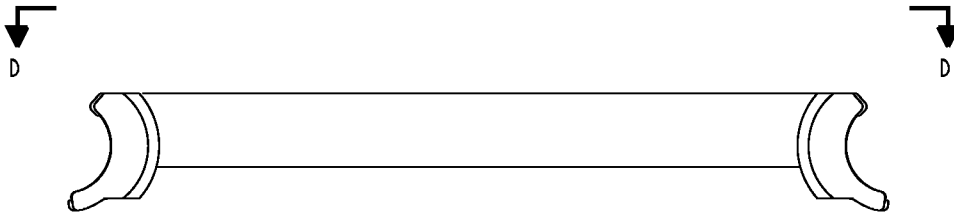

G25001-2
WRENCH ASSEMBLY

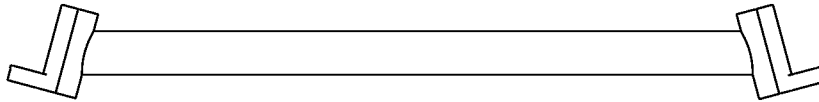

D-D

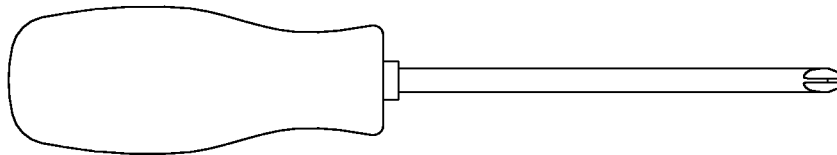

SDDP63 SCREWDRIVER

1627568 S0000297109_V1

G25012 ANTI-RATTLE WRENCH KIT
Figure 1 (Sheet 3 of 3)



757

ILLUSTRATED TOOL AND EQUIPMENT MANUAL

PART NUMBER: B25003-1

NAME: REMOVAL/INSTALLATION TOOL - AFT GALLEY G4B AIR CHILLER

AIRPLANE MAINTENANCE: YES

COMPONENT MAINTENANCE: NO

USAGE & DESCRIPTION: This tool is used to facilitate installation and removal of the aft galley, G4B chiller. This tool consists of a -2 ramp assembly, -3 handle assembly, -4 slide assembly, and a -26 storage box assembly.

WEIGHT: 15 lbs (7 kg)

DIMENSIONS: 18 x 45 x 48 inches (457 x 1143 x 1219 mm)

ILLUSTRATED TOOL AND EQUIPMENT MANUAL

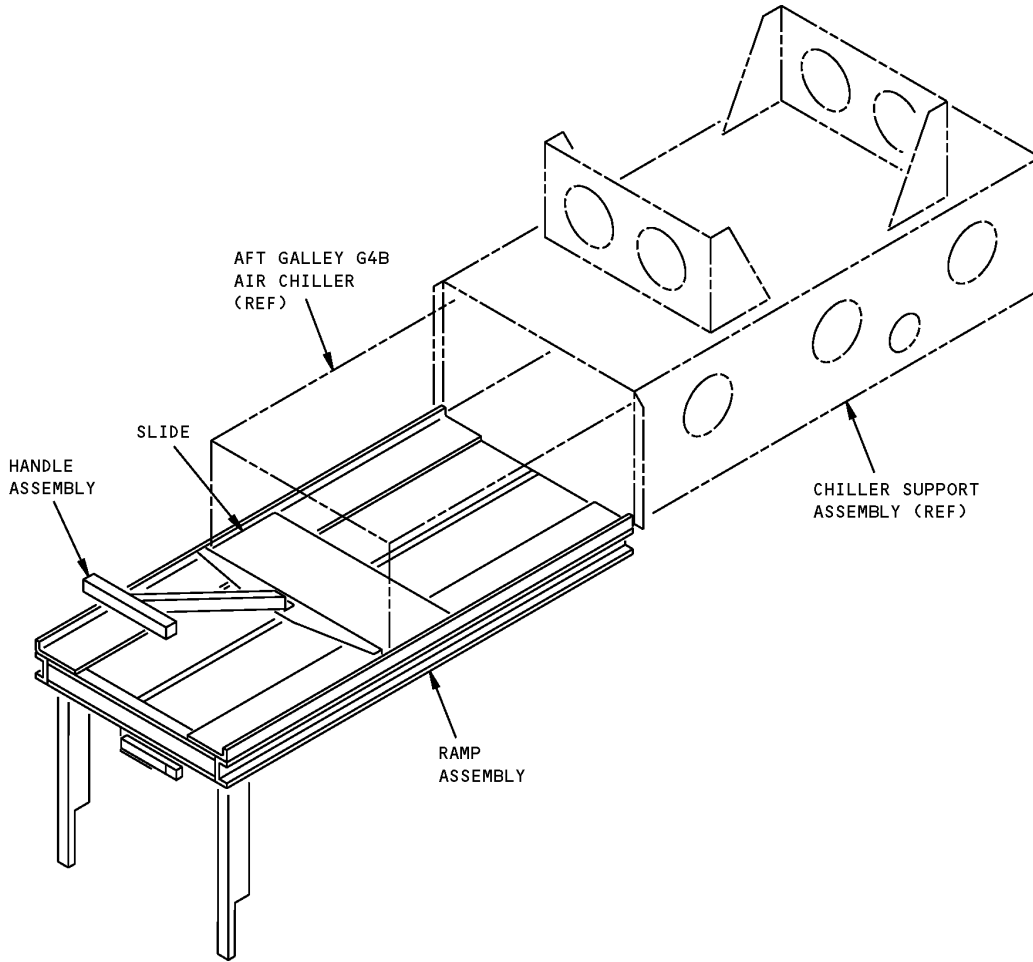

**Aft Galley G4B Air Chiller Removal/Installation Tool
Figure 1**



757

ILLUSTRATED TOOL AND EQUIPMENT MANUAL

PART NUMBER: B25002-37

NAME: FUNCTIONAL TEST EQUIPMENT - ADAPTER, OFF WING ESCAPE SLIDE

AIRPLANE MAINTENANCE: YES

COMPONENT MAINTENANCE: NO

USAGE & DESCRIPTION: This tool is used for attaching an external pressure source to the off-wing escape slide system for functional test involving simulated inflation of the slide. The tool is used in conjunction with B25001 test adaptor - off wing escape slide (Ref AMM 25-65-00/401 and AMM 25-65-00/501). The tool consists of two test fixtures, an adapter assembly, a valve assembly, and a storage box.

WEIGHT: 100 lbs (45 kg) (without box)

DIMENSIONS: 12 x 30 x 30 inches (305 x 762 x 762 mm) (with storage box)

NOTE: B25002-37 supercedes B25002-32
B25002-32 supercedes B25002-1

ILLUSTRATED TOOL AND EQUIPMENT MANUAL

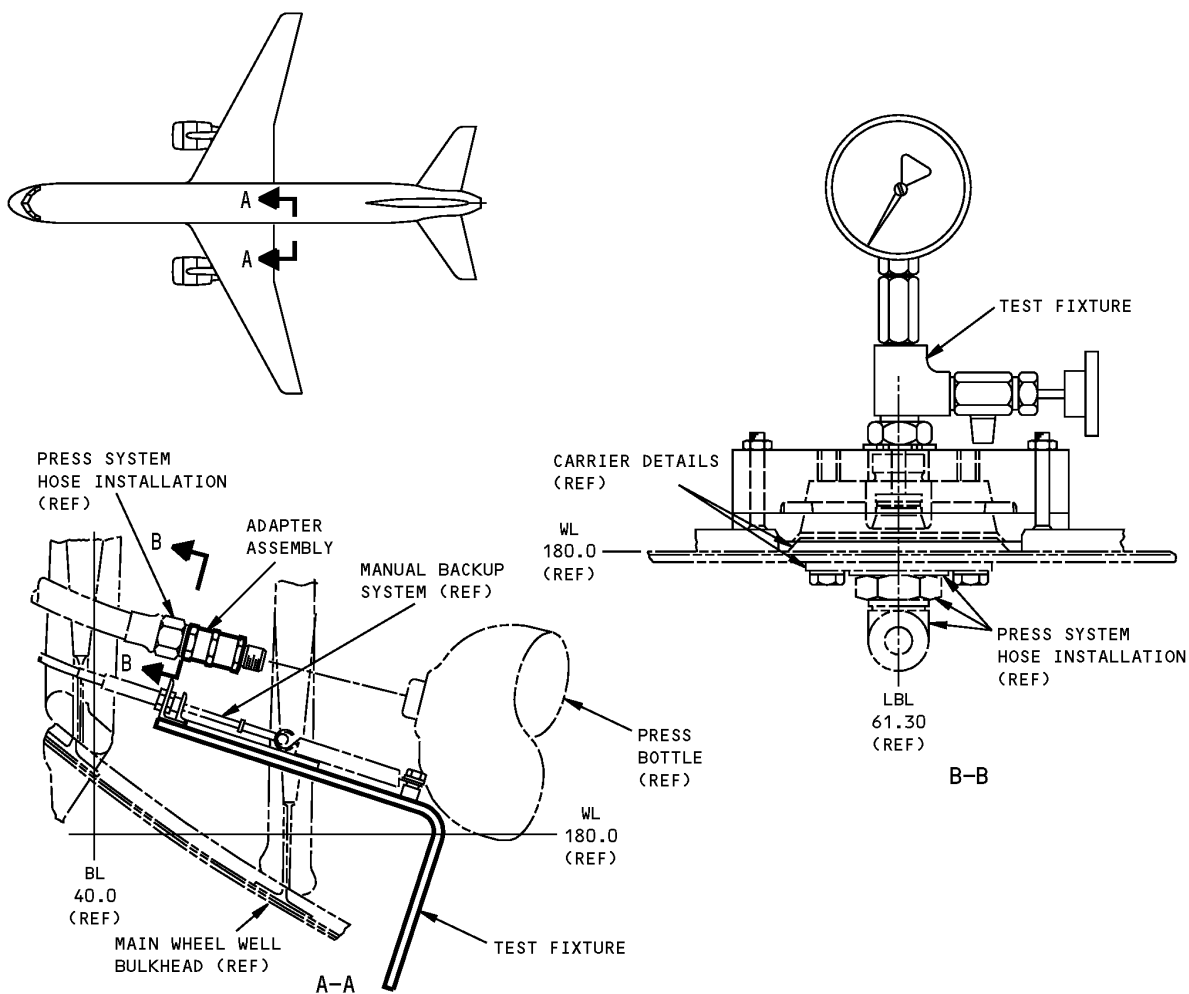

**Off Wing Escape Slide Adapter Functional Test Equipment
Figure 1**



757

ILLUSTRATED TOOL AND EQUIPMENT MANUAL

PART NUMBER: B25001-1

NAME: TEST BOX - OFF-WING ESCAPE SYSTEM

AIRPLANE MAINTENANCE: YES

COMPONENT MAINTENANCE: NO

USAGE & DESCRIPTION: Used during functional test of the off-wing escape system per Component Maintenance Manual procedure 25-65-00.

WEIGHT: 3 lbs (1 kg)

DIMENSIONS: 8 x 12 x 6 inches (203 x 305 x 152 mm)

**757
ILLUSTRATED TOOL AND EQUIPMENT MANUAL**

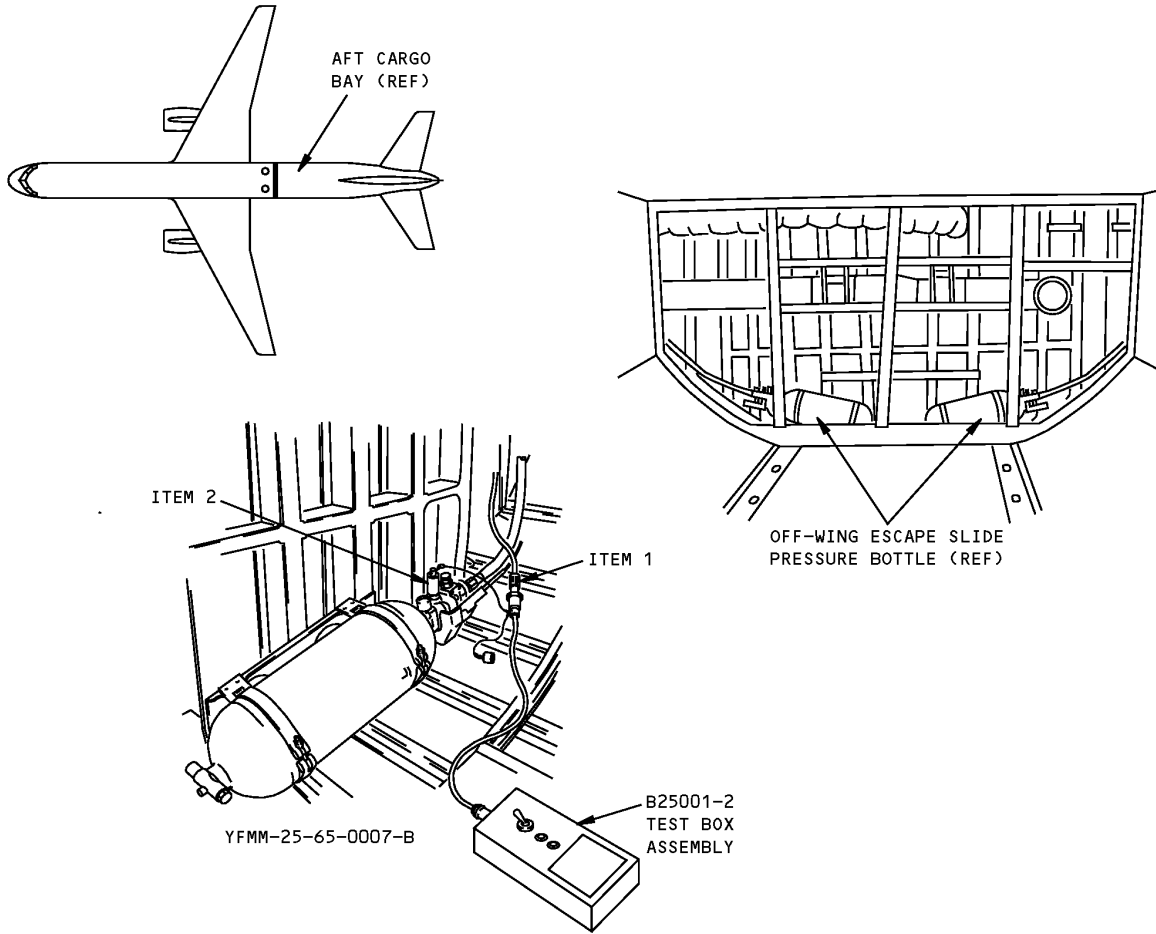

**Test Box - Off-Wing Escape System
Figure 1**

REPAIRABLE/REPLACEABLE PARTS			
ITEM NO.	PART NO	NOMENTCLATURE	VENDOR CODE
1	M83723/72R83N	CONNECTOR	
2	M83723/7583N	CONNECTOR	



757

ILLUSTRATED TOOL AND EQUIPMENT MANUAL

PART NUMBER: B52007-1

NAME: TEST FIXTURE - PASSENGER DOOR LATCHING MECHANISM

AIRPLANE MAINTENANCE: YES

COMPONENT MAINTENANCE: NO

USAGE & DESCRIPTION: The B52007-1 test fixture is used on all 757 airplanes. The B52007 is used to test the passenger door latching mechanism and door warning system. B52007-1 consists of a B52007-2 protractor/base assembly contained in a storage box.

WEIGHT: 5 lbs (2.3 kg)

DIMENSIONS: 3 x 7 x 9 inches (76 x 178 x 229 mm)

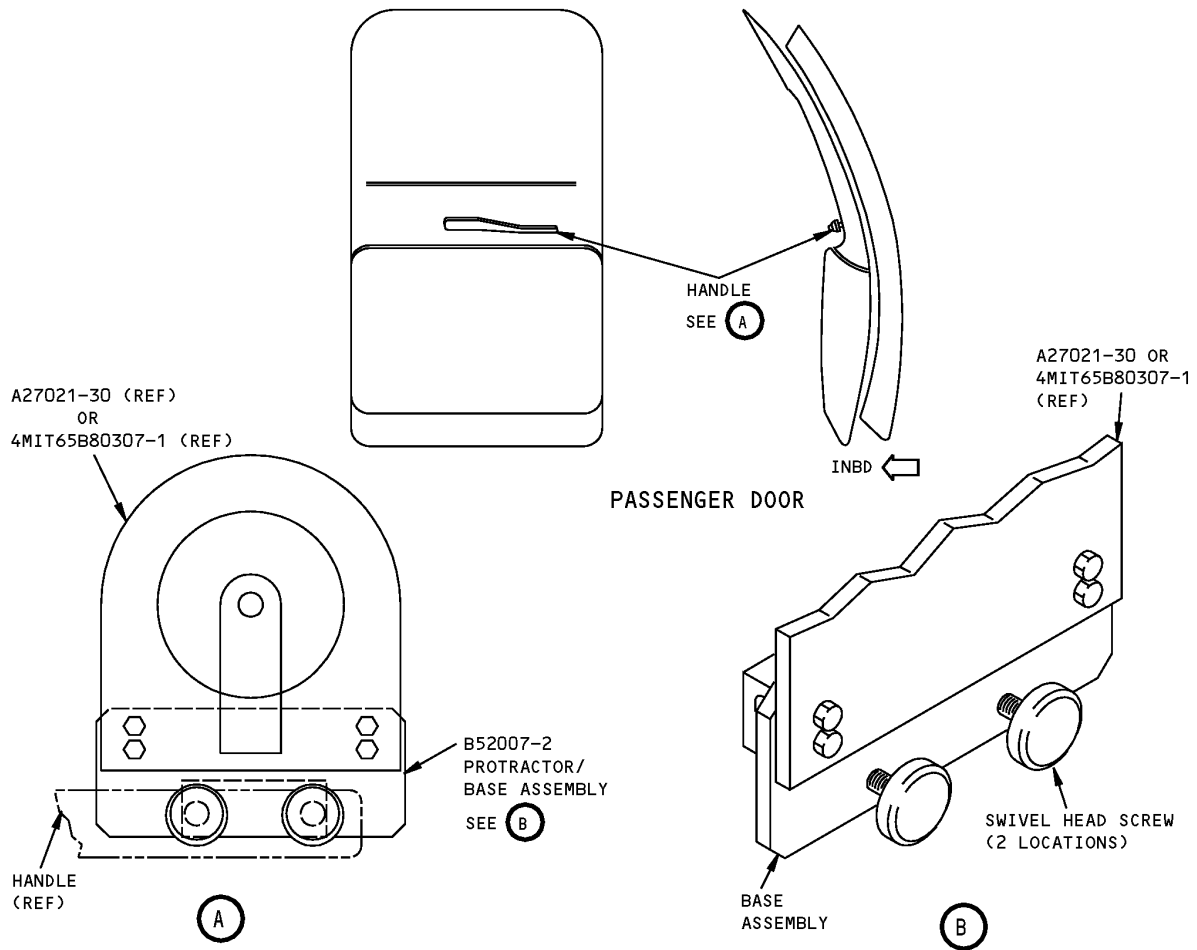

**Passenger Door Latching Mechanism Test Fixture
Figure 1**