

**CHAPTER**

**75**

**AIR**



CHAPTER 75  
AIR

CH-SC-SU	Schem	Page	Sheet	Date	CH-SC-SU	Schem	Page	Sheet	Date
75-EFFECTIVE PAGES					75-32-01 (cont.)		103.1		
		1		Oct 09/2008				2	Jan 21/2005
		2		BLANK				3	Jan 21/2005
75-CONTENTS									
		1		Dec 18/2007					
		2		BLANK					
75-ALPHABETICAL INDEX									
		1		Dec 18/2007					
		2		BLANK					
75-32-00									
		101		Jan 21/2005					
75-32-01									
		101	1	Jan 21/2005					
			2	Jan 21/2005					
			3	Jan 21/2005					
		101.1	1	Jan 21/2005					
			2	Jan 21/2005					
			3	Jan 21/2005					
		102	1	Jan 21/2005					
			2	Jan 21/2005					
			3	Jan 21/2005					
		103	1	Jan 21/2005					
			2	Jan 21/2005					
			3	Jan 21/2005					
		103.1	1	Jan 21/2005					

A = Added, R = Revised, D = Deleted, O = Overflow

**75-EFFECTIVE PAGES**

Page 1  
Oct 09/2008

D280N032S



CHAPTER 75  
AIR

Title	CH-SC-SU	Schem	Page	Sheet	Date	Effectivity
<b><u>COMPRESSOR BLEED CONTROL SYSTEM</u></b>						
COMPRESSOR BLEED VALVES CONTROL SYSTEM	75-32-00		101		Jan 21/2005	ALL
ENGINE BLEED VALVES CONTROL	75-32-01		101	1	Jan 21/2005	001-009
				2	Jan 21/2005	001-009
				3	Jan 21/2005	001-009
			101.1	1	Jan 21/2005	001-009
				2	Jan 21/2005	001-009
				3	Jan 21/2005	001-009
			102	1	Jan 21/2005	010-099
				2	Jan 21/2005	010-099
				3	Jan 21/2005	010-099
			103	1	Jan 21/2005	115-199
				2	Jan 21/2005	115-199
				3	Jan 21/2005	115-199
			103.1	1	Jan 21/2005	115
				2	Jan 21/2005	115
				3	Jan 21/2005	115

CHAPTER 75  
AIR

CH-SC-SU	Title
75-32-00	COMPRESSOR BLEED VALVES CONTROL SYSTEM
75-32-01	ENGINE BLEED VALVES CONTROL

CH-SC-SU	Title
----------	-------

**75-ALPHABETICAL INDEX**

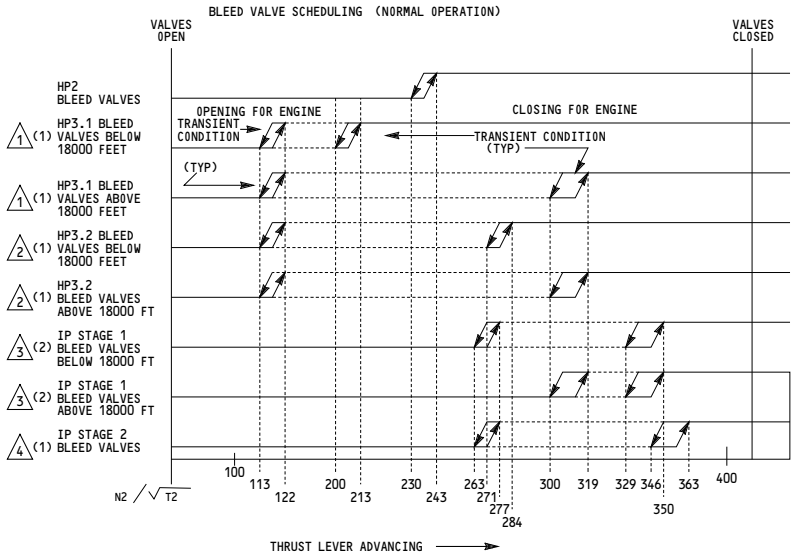
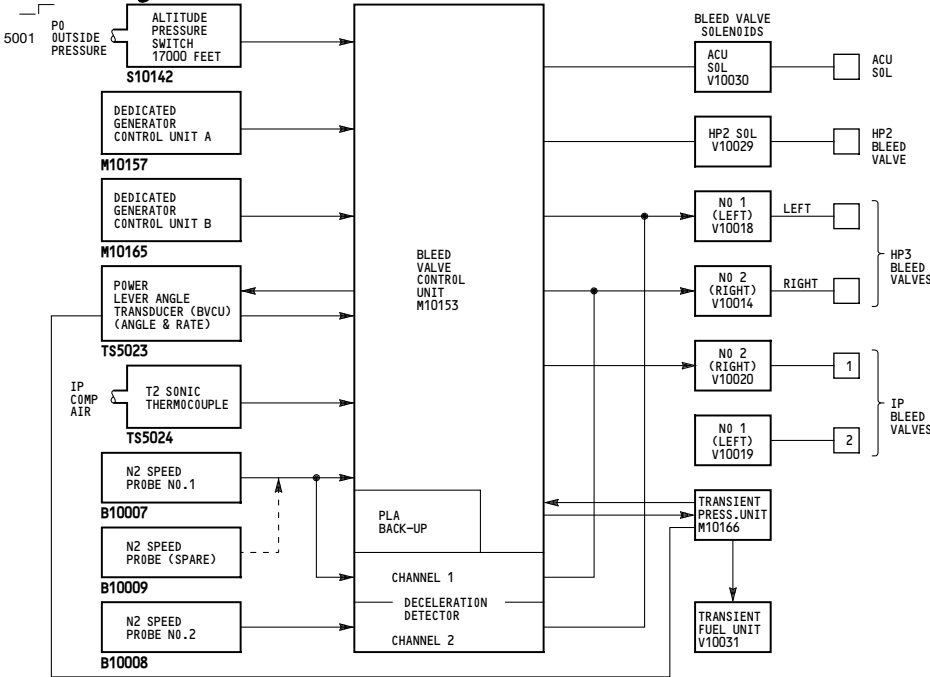

SYMBOL	BLEED VALVES	ALTITUDE	TIMER	ACTION ON BV
A	HP3S AND HP2S △1 AND △2	<18000 FT	6.5 SEC	WHEN BOTH A AND B ARE TIMED OUT CLOSE BLEED VALVES
		>18000 FT	13.0 SEC	
B	HP3S AND HP2S △1 AND △2	<18000 FT	2.5 SEC	WHEN BOTH D AND E ARE TIMED OUT CLOSE BLEED VALVES
		>18000 FT	5.0 SEC	
C	HP3S AND HP2S △1 AND △2	<18000 FT	IMMEDIATE	OPEN IMMEDIATELY
		>18000 FT	IMMEDIATE	OPEN IMMEDIATELY
D	IPS △3 & △4	<18000 FT	9.5 SEC	WHEN BOTH D AND E ARE TIMED OUT CLOSE BLEED VALVES
		>18000 FT	19.0 SEC	
E	IPS △3 & △4	<18000 FT	4.5 SEC	WHEN BOTH D AND E ARE TIMED OUT CLOSE BLEED VALVES
		>18000 FT	9.0 SEC	
F	IPS △3 & △4	<18000 FT	IMMEDIATE	OPEN IMMEDIATELY
		>18000 FT	IMMEDIATE	OPEN IMMEDIATELY

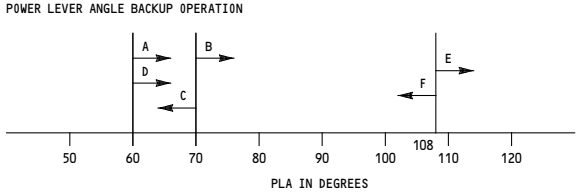

**NOTES:**  
 △ SEE 75-32-01  
 1 TRANSIENT ENGINE CONDITION EXISTS WHEN THE CHANGE IN N2/T2 IS MORE THAN 13 UNITS AT A RATE GREATER THAN 5 UNITS/SECOND.

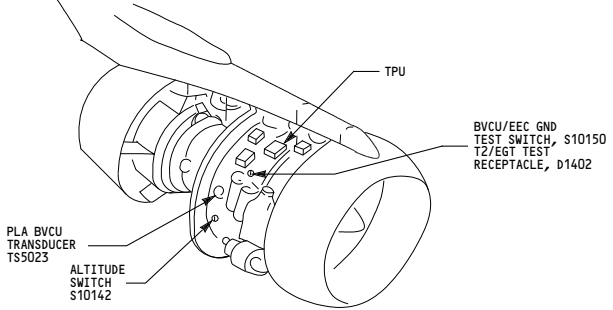

ALL	<b>COMPRESSOR BLEED VALVES CONTROL SYSTEM</b>
<b>D280N032S</b>	

5014

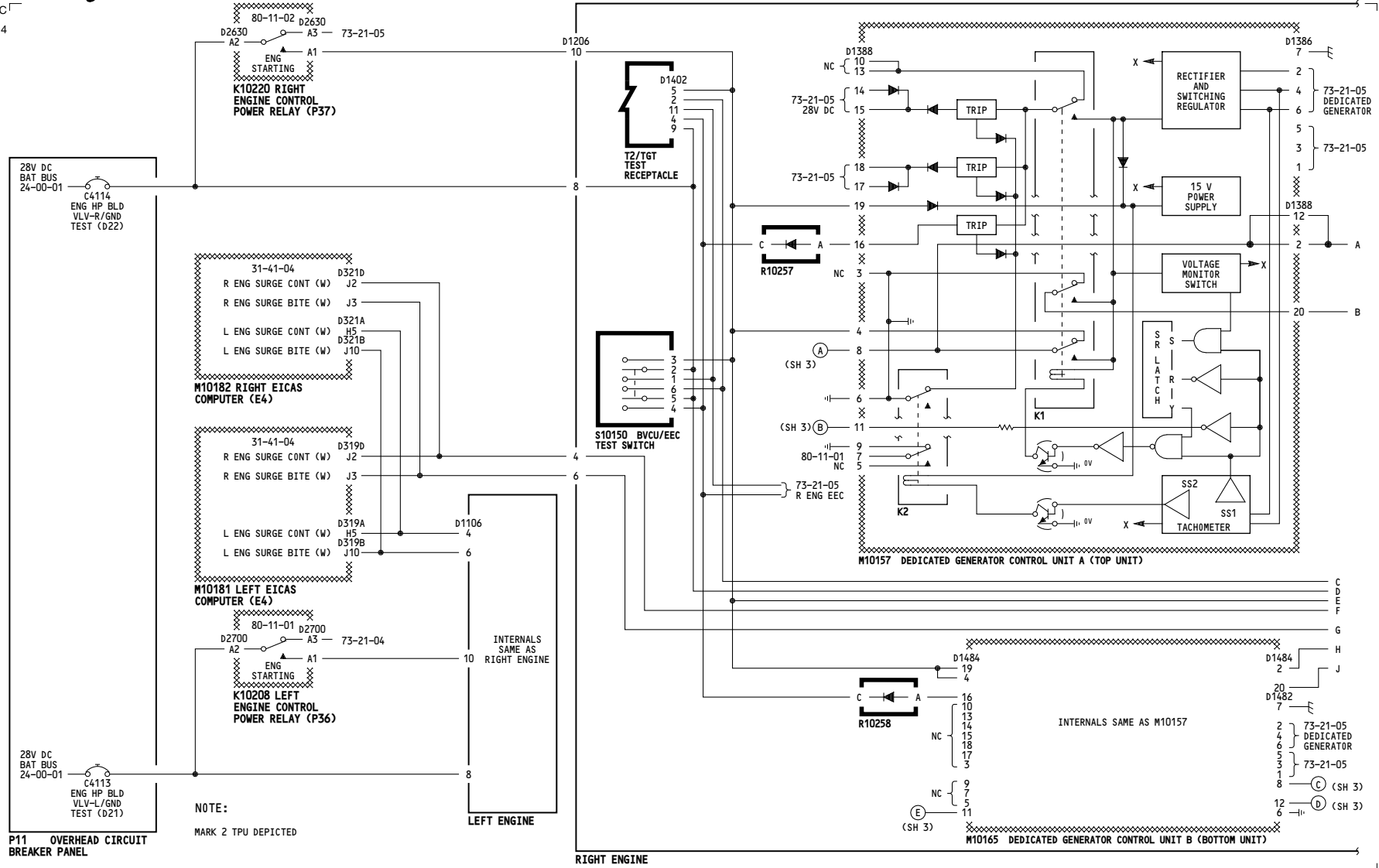

P11 OVERHEAD CIRCUIT BREAKER PANEL

NOTE:  
MARK 2 TPU DEPICTED

**ENGINE BLEED VALVES CONTROL**

D280N032S

**75-32-01**

5013

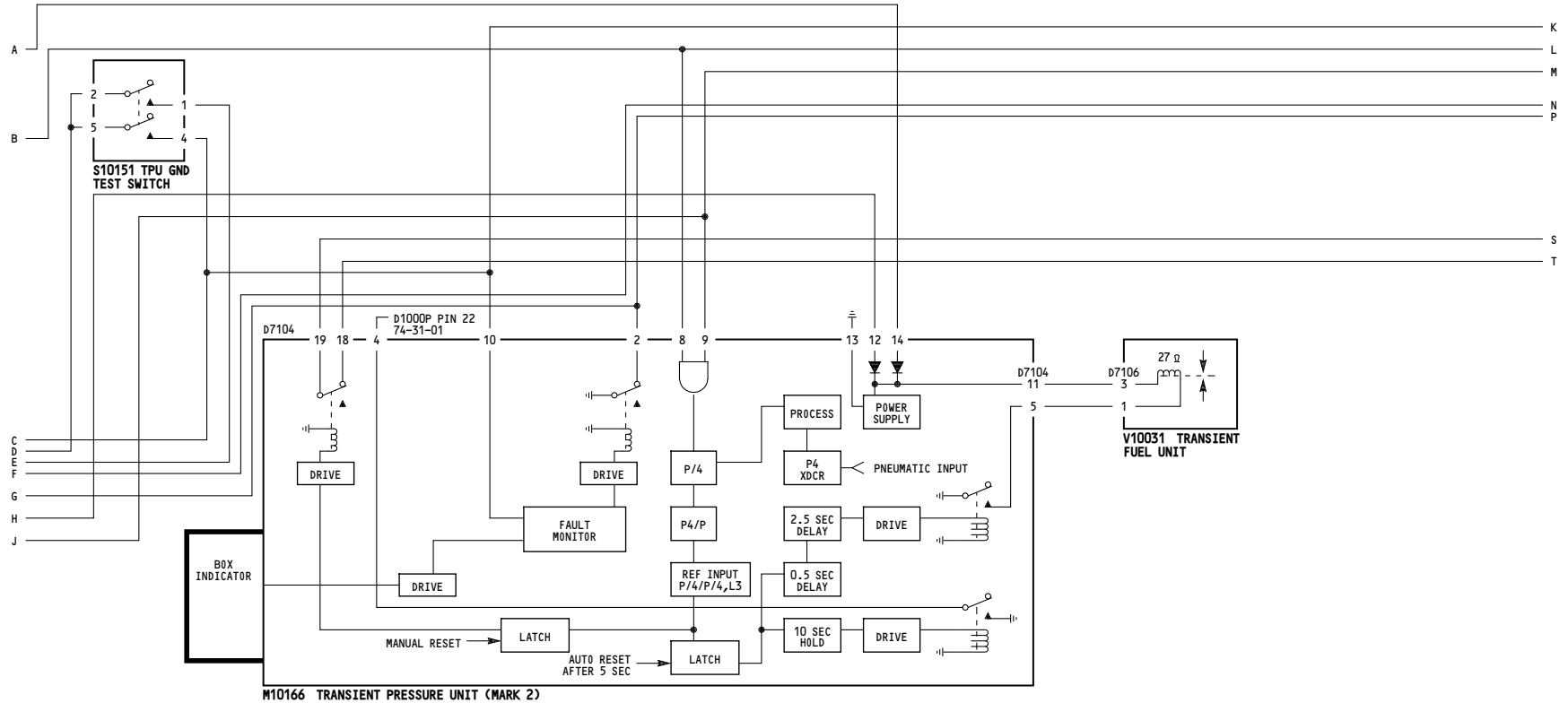

RIGHT ENGINE

NOTES: MARK 2 T.P.U. INSTALLATION DEPICTED

001-009	<p align="center"><b>ENGINE BLEED VALVES CONTROL</b></p> <p align="center">D280N032S</p>
---------	------------------------------------------------------------------------------------------

**75-32-01**

Page 101  
Sheet 2  
Jan 21/2005

5013

WIRING DIAGRAMS  
71-51-11  
75-31-11

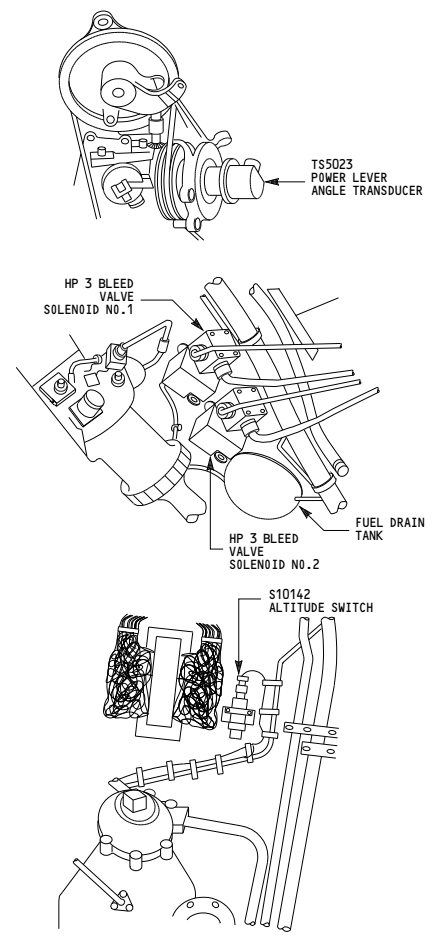
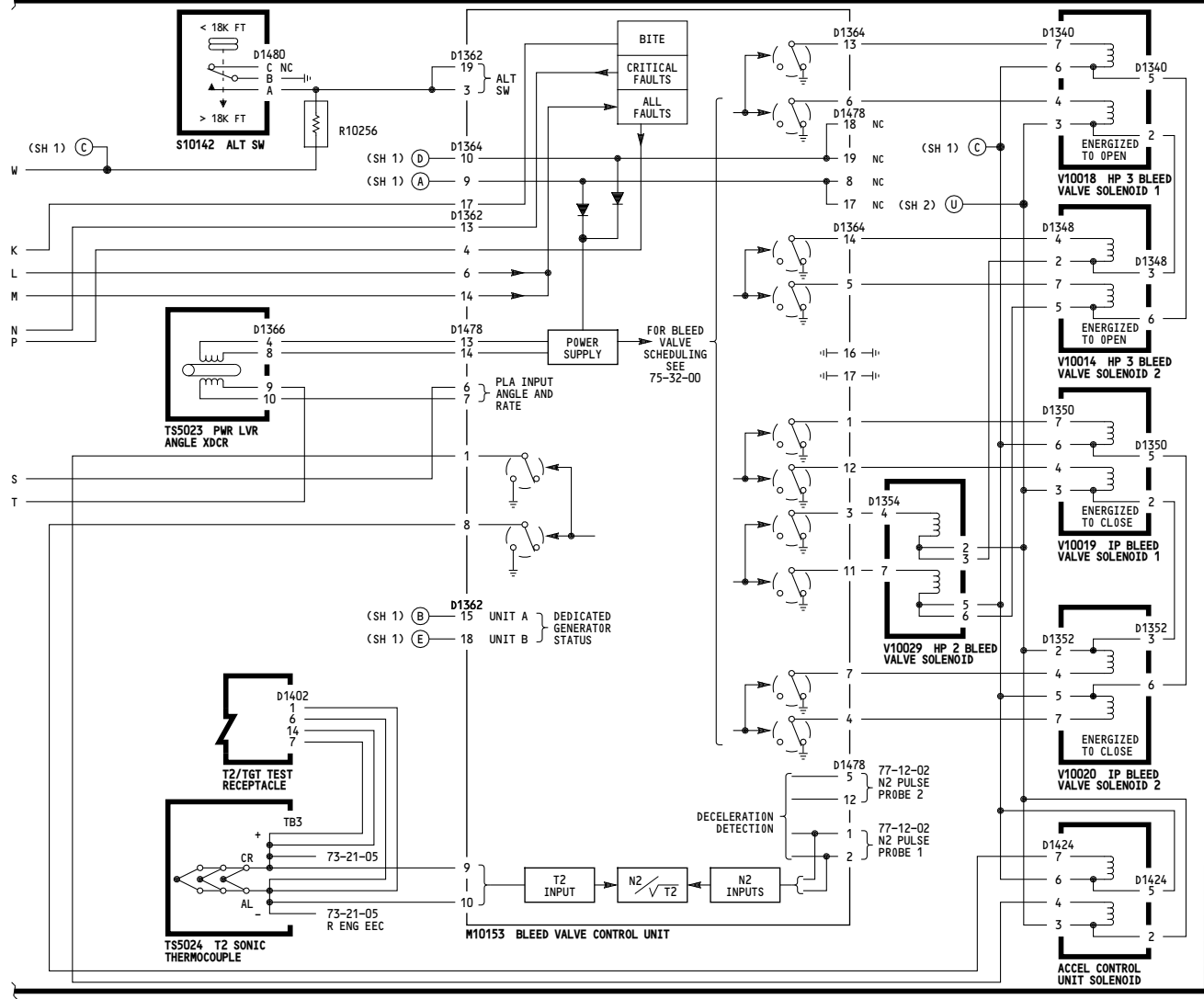

NOTES: MARK 2 T.P.U. INSTALLATION DEPICTED

RIGHT ENGINE

001-009

**ENGINE BLEED VALVES CONTROL**

D280N032S

**75-32-01**



THIS PAGE INTENTIONALLY LEFT BLANK

5017

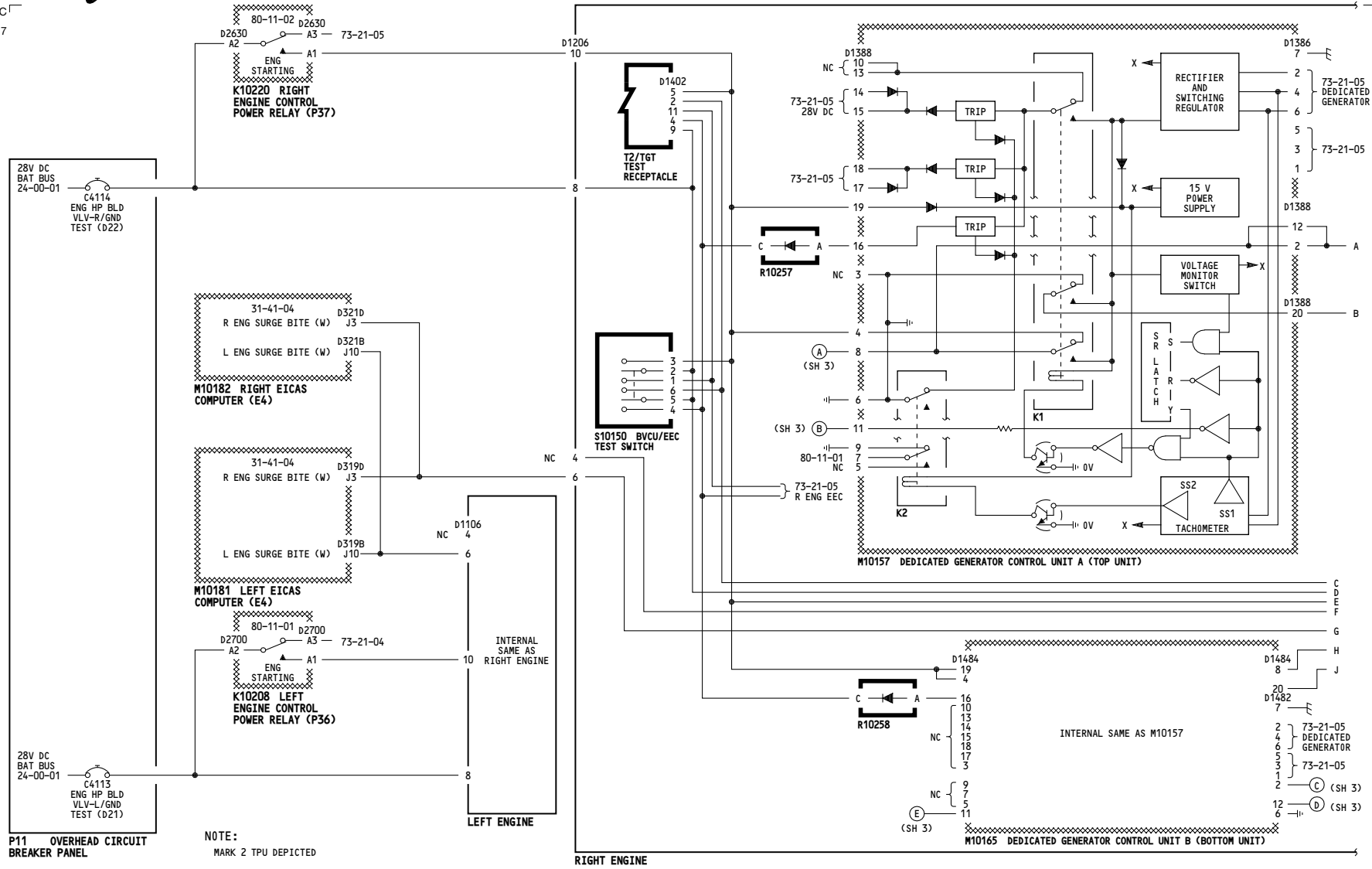

001-009

**ENGINE BLEED VALVES CONTROL**

Incorporates 75-0005

D280N032S

**75-32-01**

Page 101.1  
Sheet 1  
Jan 21/2005

5013

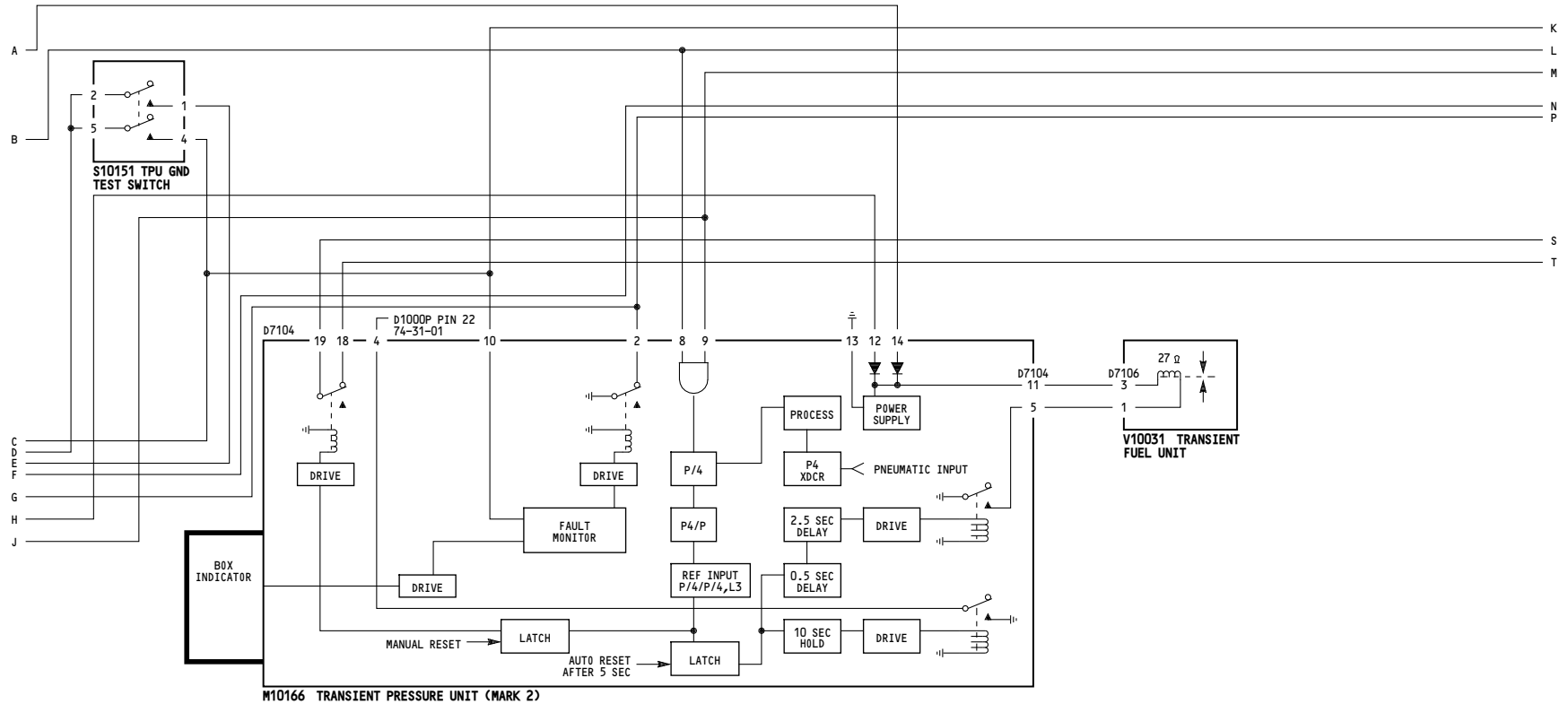
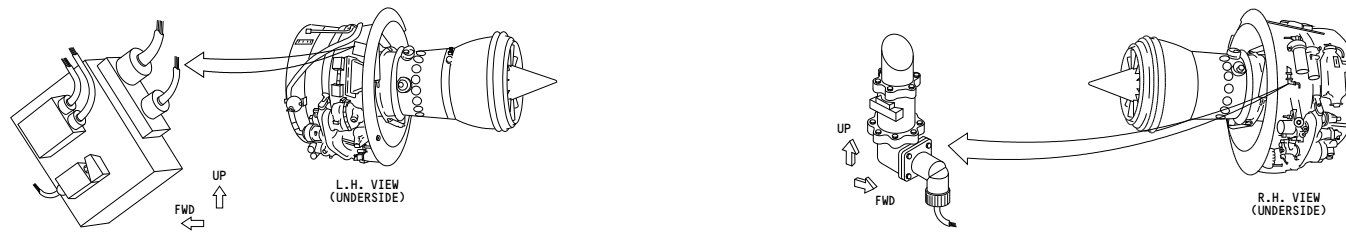

RIGHT ENGINE

NOTES: MARK 2 T.P.U. INSTALLATION DEPICTED

001-009	<p align="center"><b>ENGINE BLEED VALVES CONTROL</b></p> <p align="center">D280N032S</p>
---------	------------------------------------------------------------------------------------------

**75-32-01**

Page 101.1  
Sheet 2  
Jan 21/2005

5013

WIRING DIAGRAMS  
71-51-11  
75-31-11

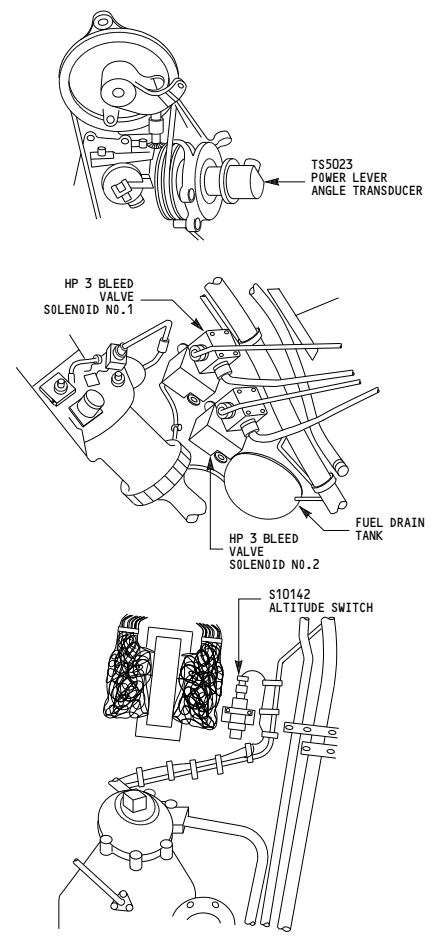
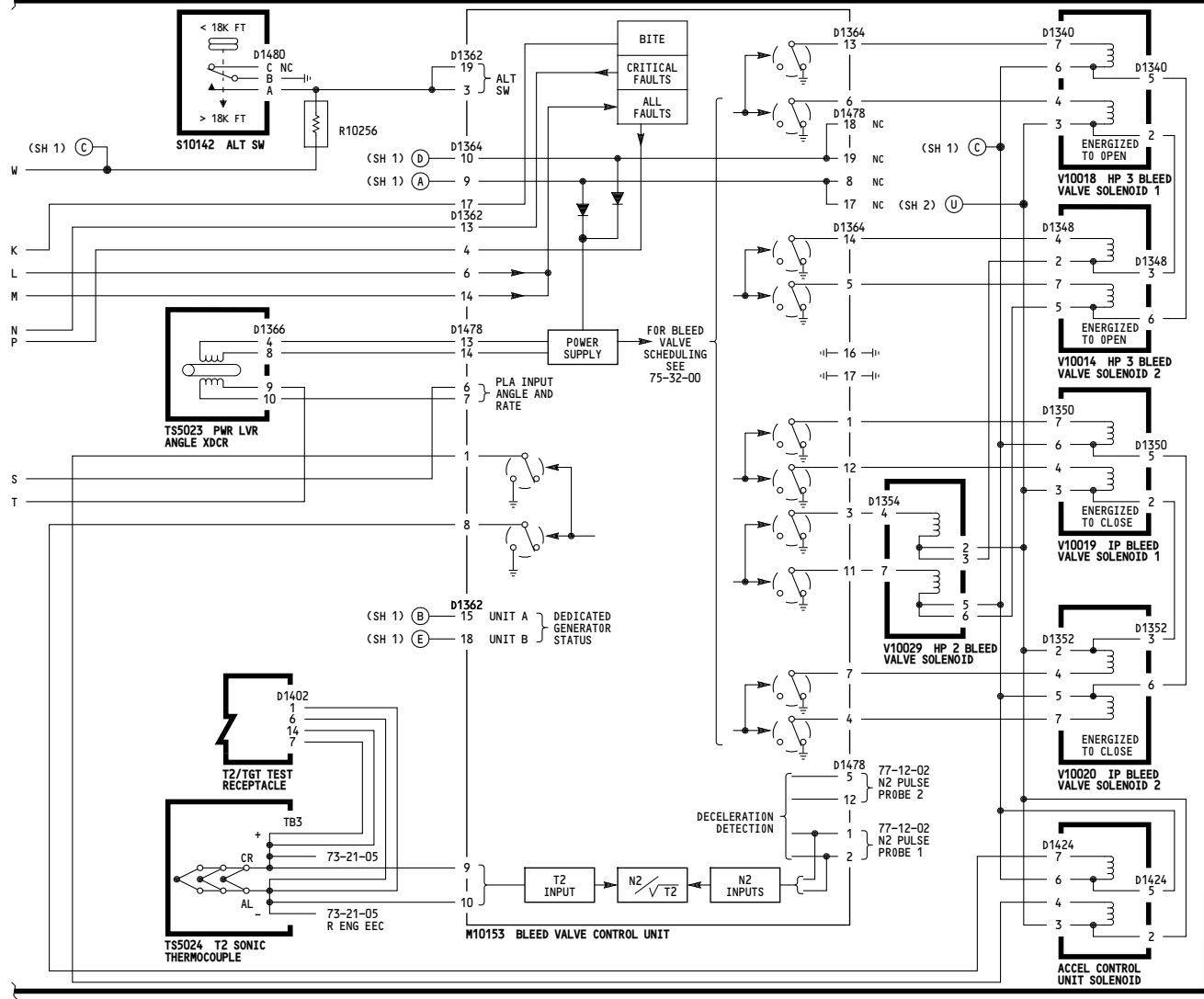

NOTES: MARK 2 T.P.U. INSTALLATION DEPICTED

RIGHT ENGINE

001-009

**ENGINE BLEED VALVES CONTROL**

D280N032S

**75-32-01**

Page 101.1  
Sheet 3  
Jan 21/2005

THIS PAGE INTENTIONALLY LEFT BLANK

-C  
5017

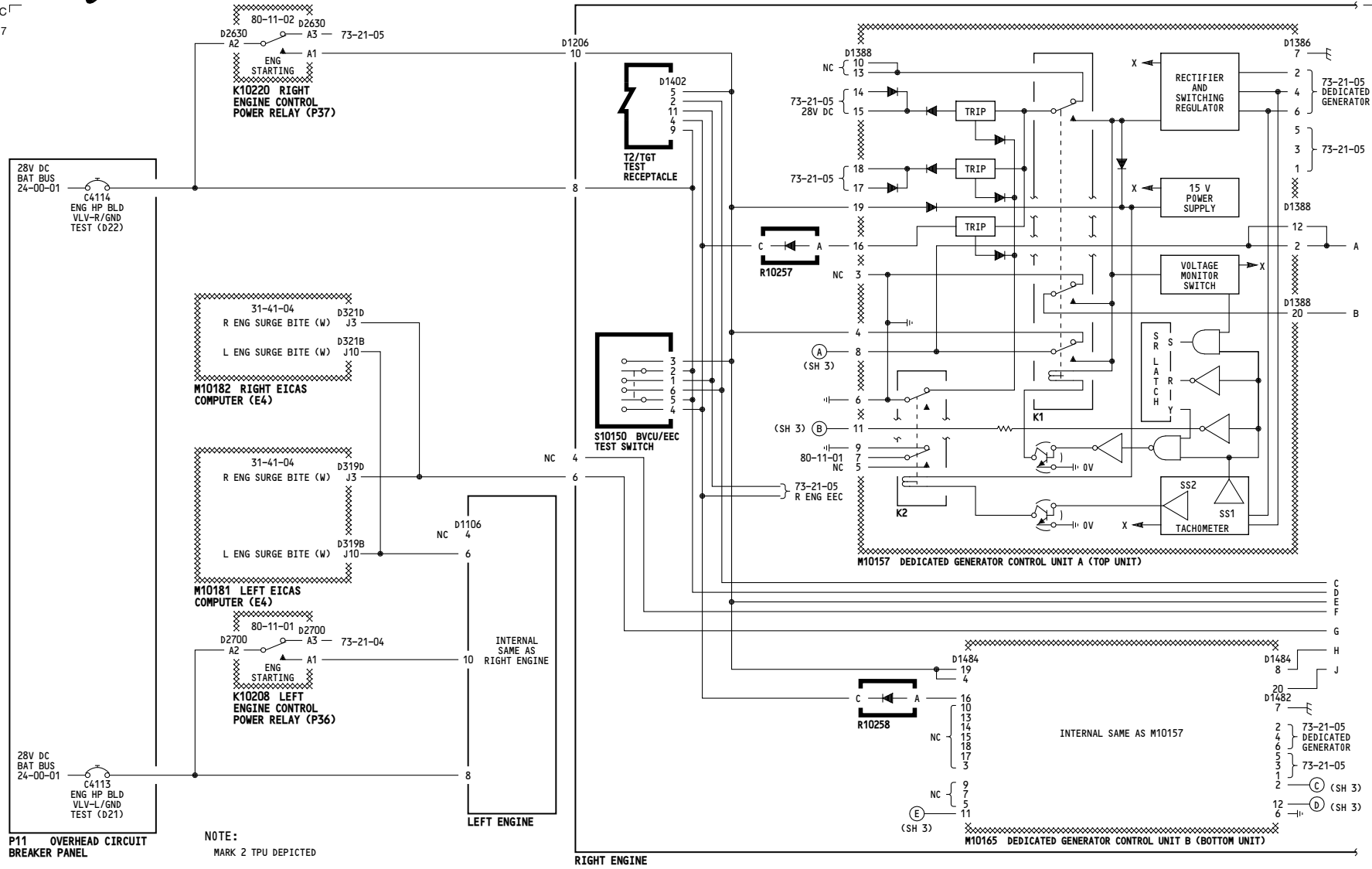

<p>010-099</p>	<p><b>ENGINE BLEED VALVES CONTROL</b></p> <p>D280N032S</p>
----------------	------------------------------------------------------------

**75-32-01**

5013

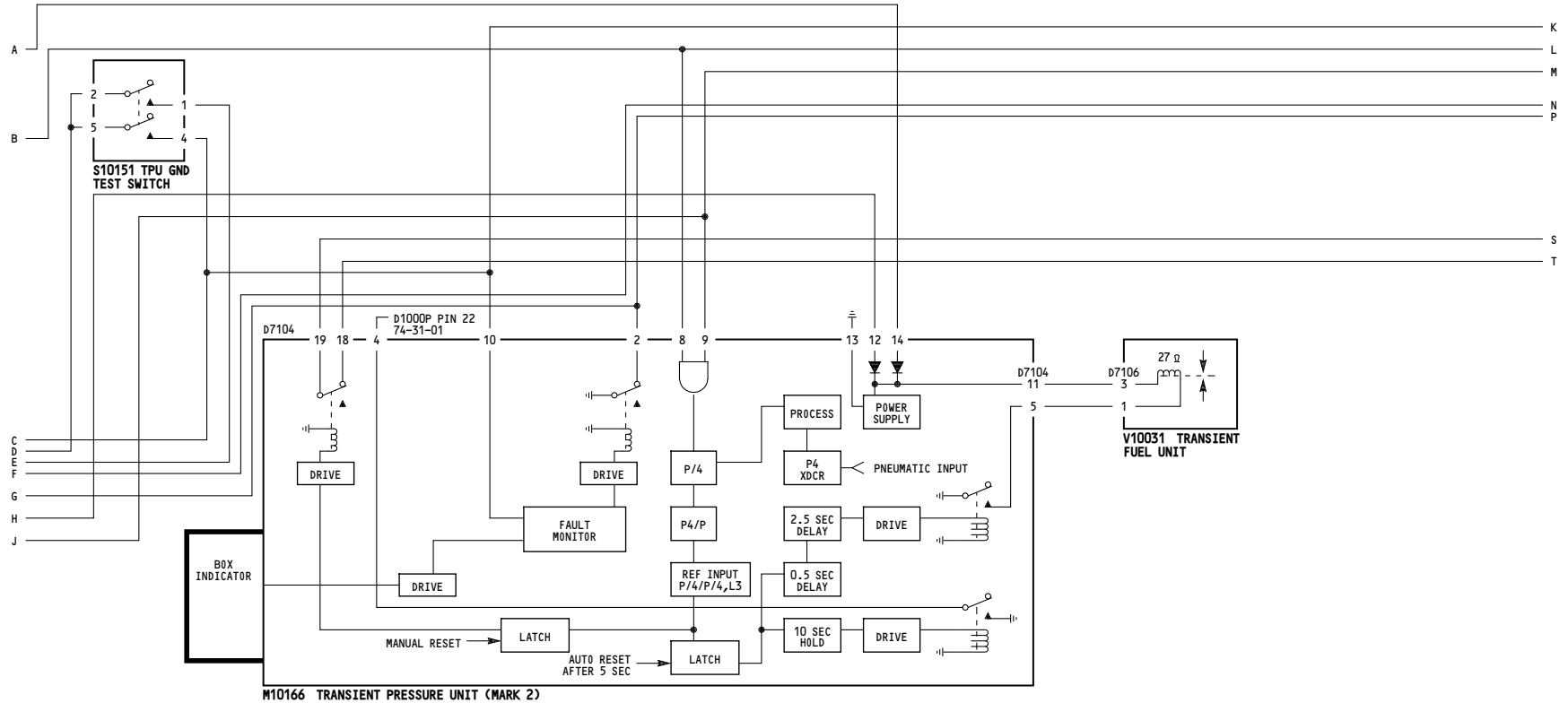
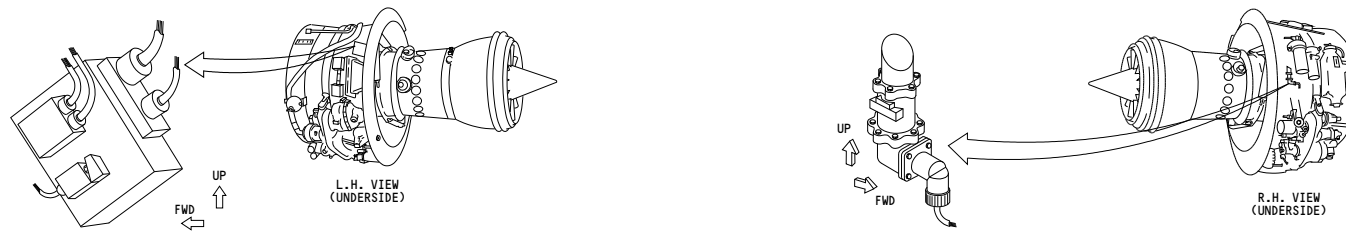

RIGHT ENGINE  
 NOTES: MARK 2 T.P.U. INSTALLATION DEPICTED

010-099	<p><b>ENGINE BLEED VALVES CONTROL</b></p> <p>D280N032S</p>
---------	------------------------------------------------------------

**75-32-01**

Page 102  
 Sheet 2  
 Jan 21/2005

5013

WIRING DIAGRAMS  
71-51-11  
75-31-11

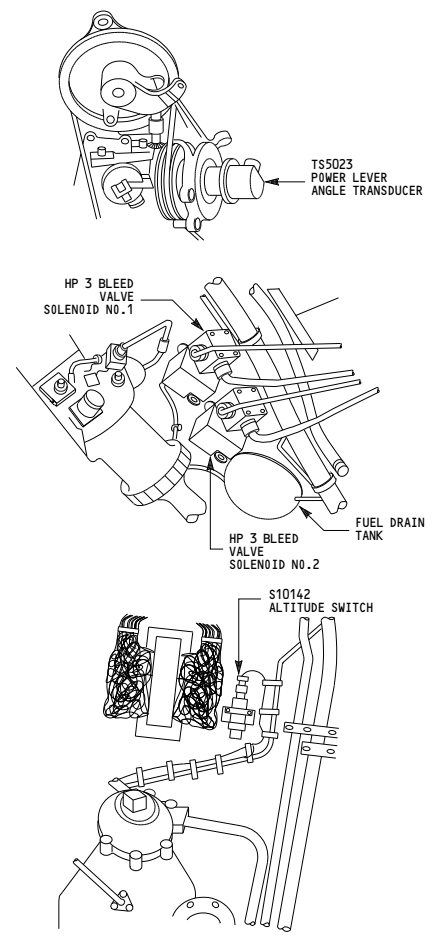
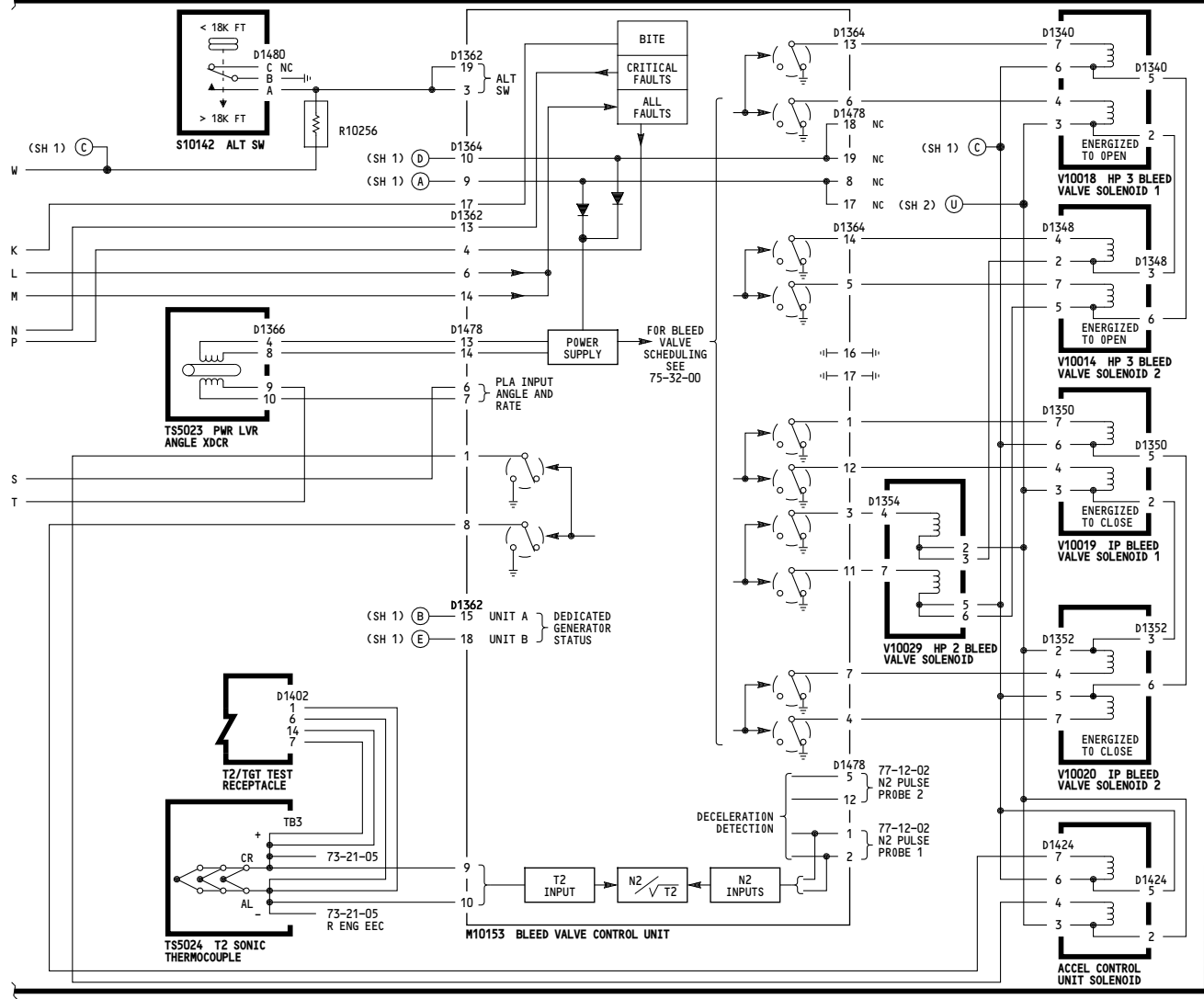

NOTES: MARK 2 T.P.U. INSTALLATION DEPICTED

RIGHT ENGINE

010-099

**ENGINE BLEED VALVES CONTROL**

D280N032S

**75-32-01**

Page 102  
Sheet 3  
Jan 21/2005



THIS PAGE INTENTIONALLY LEFT BLANK

-B  
5015

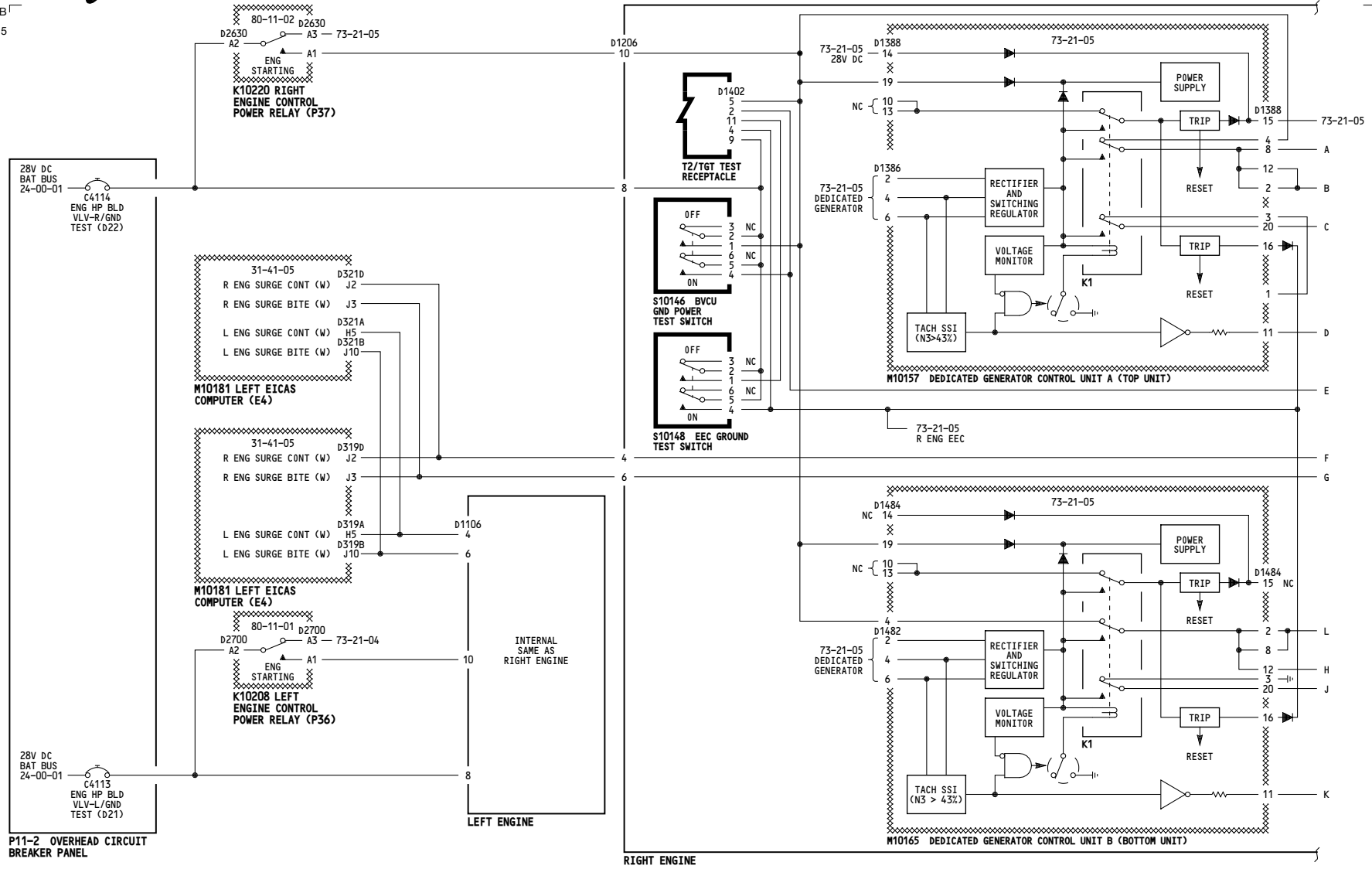

115-199

**ENGINE BLEED VALVES CONTROL**

D280N032S

**75-32-01**

5014

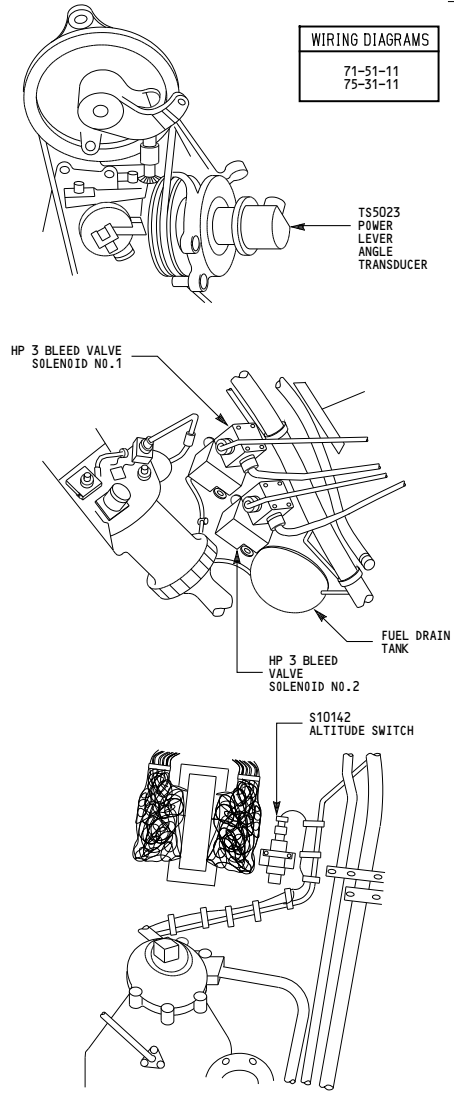
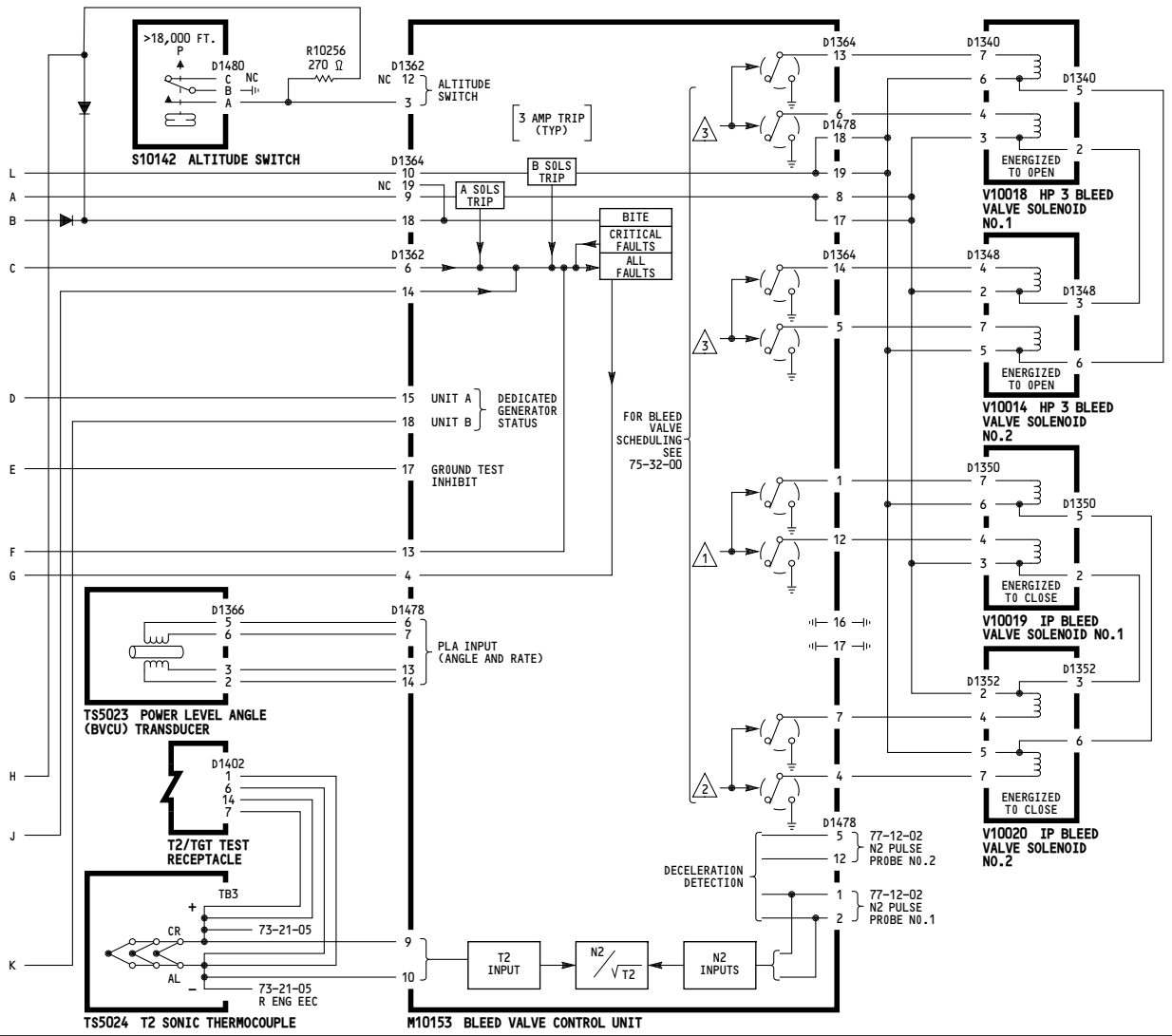

RIGHT ENGINE

115-199

**ENGINE BLEED VALVES CONTROL**

D280N032S

**75-32-01**

5013

WIRING DIAGRAMS  
71-51-11  
75-31-11

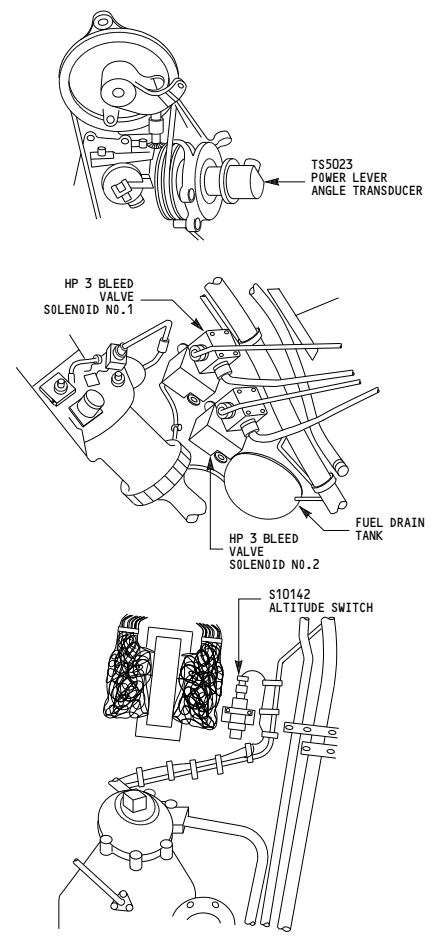
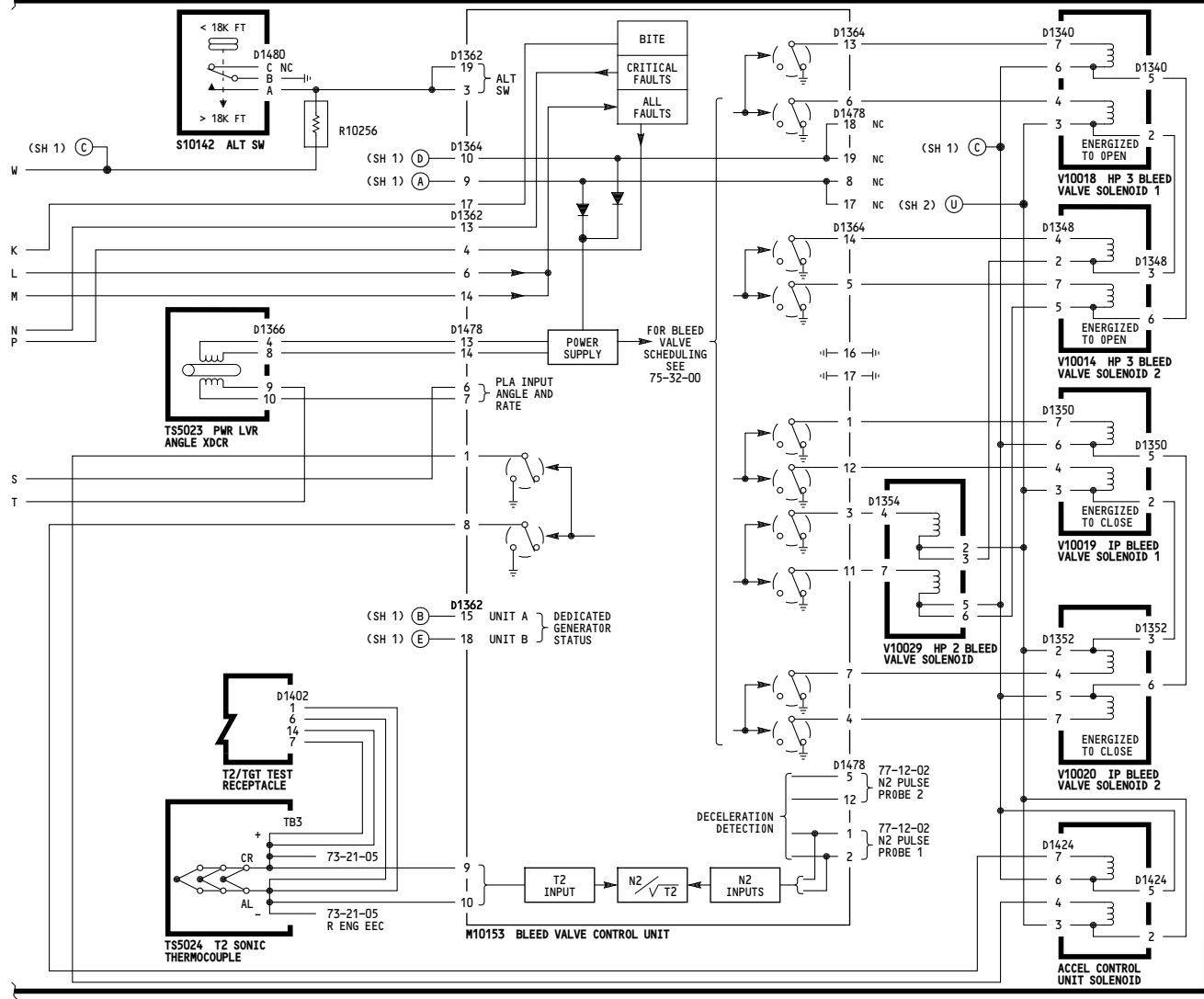

NOTES: MARK 2 T.P.U. INSTALLATION DEPICTED

RIGHT ENGINE

115-199

**ENGINE BLEED VALVES CONTROL**

D280N032S

**75-32-01**

THIS PAGE INTENTIONALLY LEFT BLANK

-B  
5018

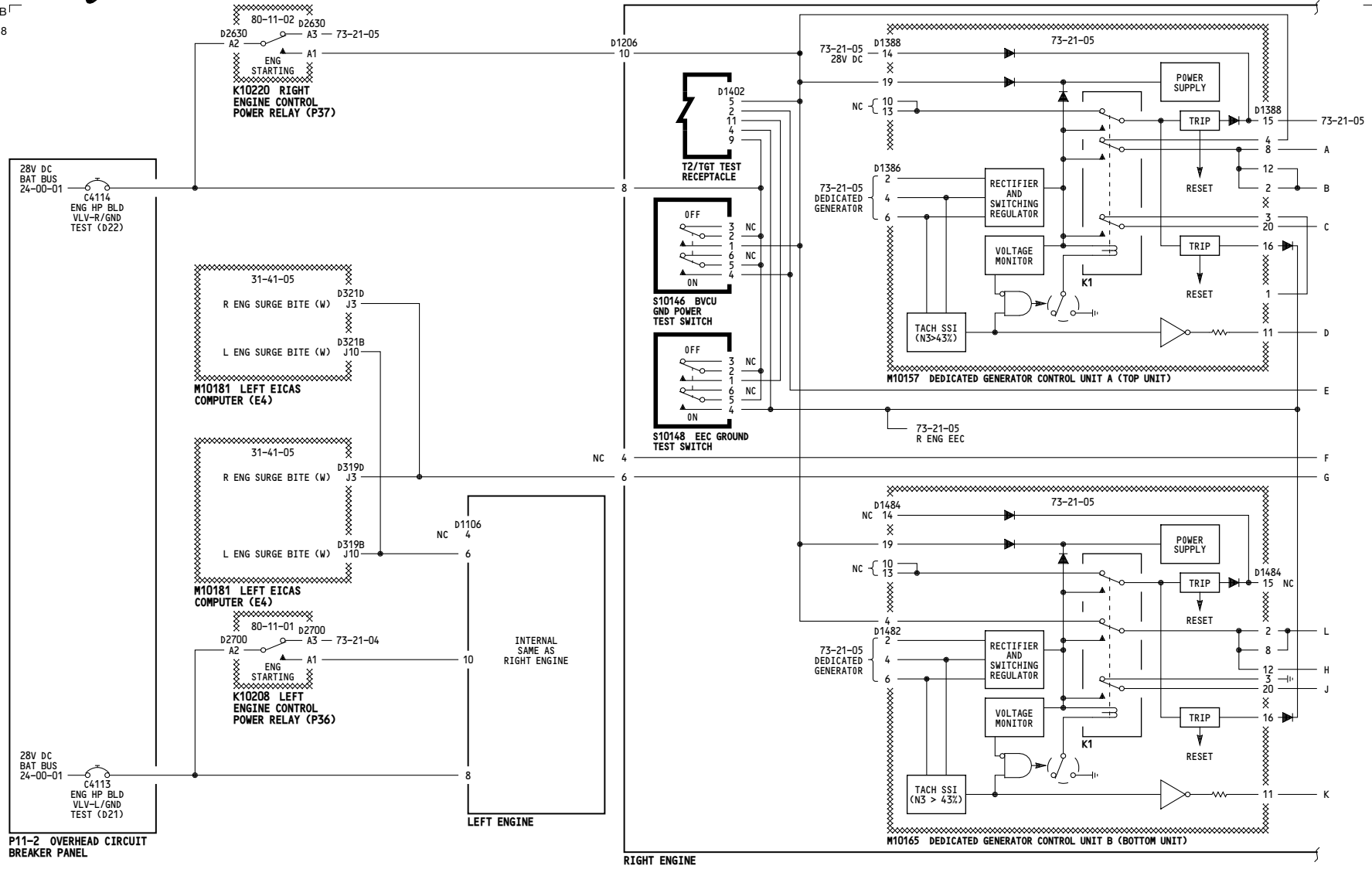

115	<b>ENGINE BLEED VALVES CONTROL</b>
	D280N032S

Incorporates  
75-0005

**75-32-01**

Page 103.1  
Sheet 1  
Jan 21/2005

5014

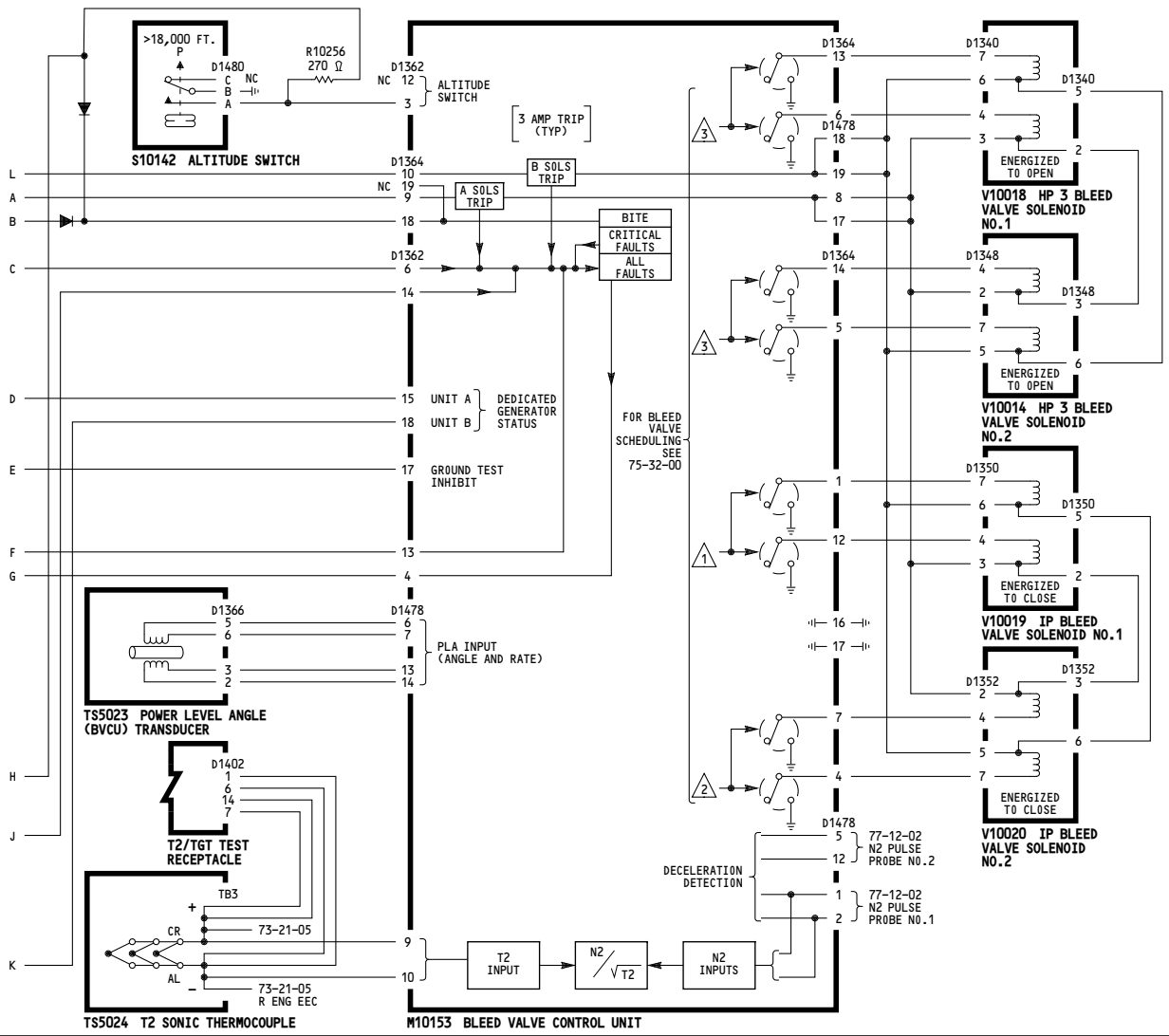

WIRING DIAGRAMS  
71-51-11  
75-31-11

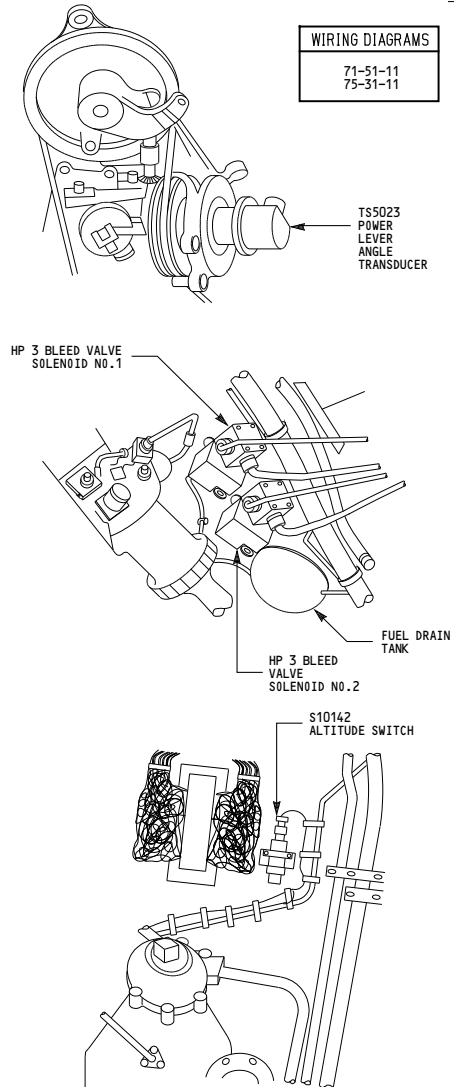

RIGHT ENGINE

115

**ENGINE BLEED VALVES CONTROL**

D280N032S

**75-32-01**

Page 103.1  
Sheet 2  
Jan 21/2005

5013

WIRING DIAGRAMS  
71-51-11  
75-31-11

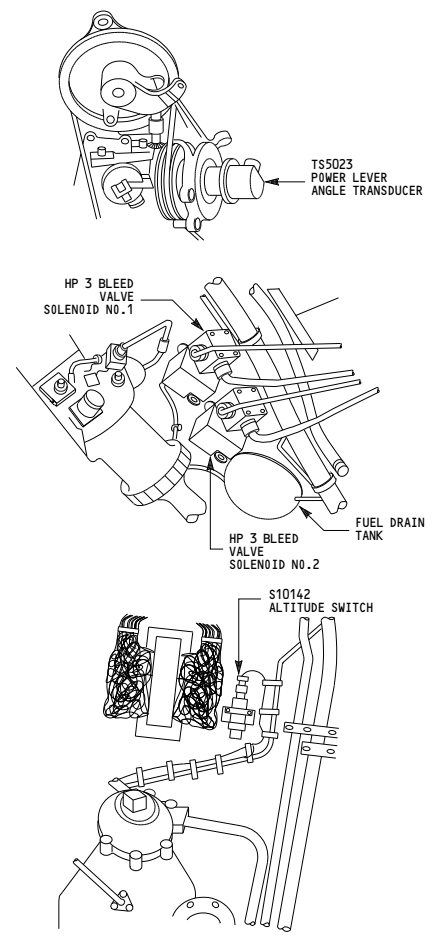
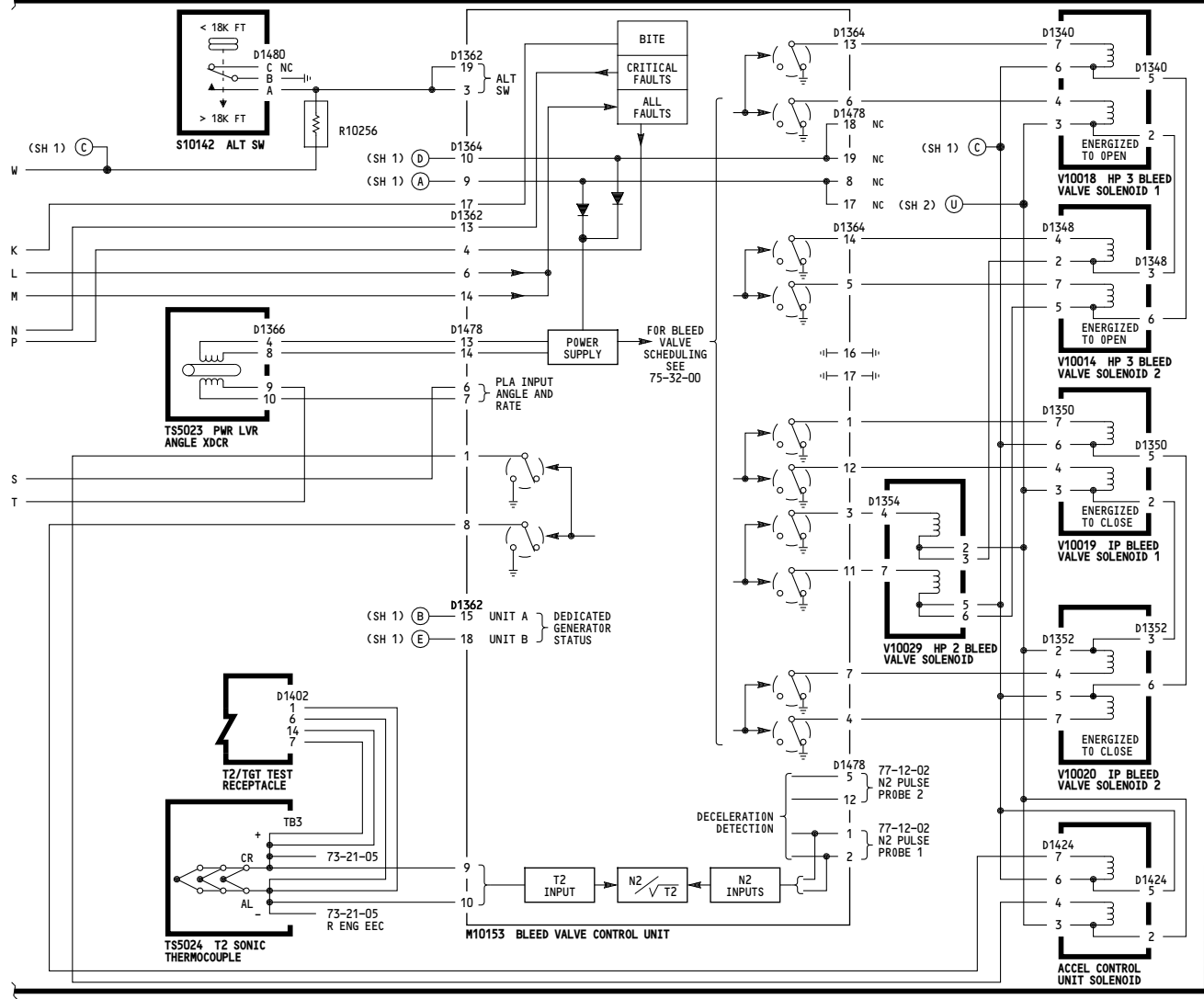

NOTES: MARK 2 T.P.U. INSTALLATION DEPICTED

RIGHT ENGINE

115

**ENGINE BLEED VALVES CONTROL**

D280N032S

**75-32-01**

Page 103.1  
Sheet 3  
Jan 21/2005