

CHAPTER

75

AIR



CHAPTER 75
AIR

CH-SC-SU	Schem	Page	Sheet	Date	CH-SC-SU	Schem	Page	Sheet	Date
75-EFFECTIVE PAGES					75-32-01 (cont.) 103.1				
		1		May 06/2009	D			2	May 06/2009
		2		BLANK	D			3	May 06/2009
75-CONTENTS									
R		1		May 06/2009					
		2		BLANK					
75-ALPHABETICAL INDEX									
		1		Dec 18/2007					
		2		BLANK					
	75-32-00								
R		101		May 06/2009					
	75-32-01								
		101	1	Jan 21/2005					
			2	Jan 21/2005					
			3	Jan 21/2005					
		101.1	1	Jan 21/2005					
			2	Jan 21/2005					
			3	Jan 21/2005					
		102	1	Jan 21/2005					
			2	Jan 21/2005					
			3	Jan 21/2005					
D		103	1	May 06/2009					
D			2	May 06/2009					
D			3	May 06/2009					
D		103.1	1	May 06/2009					

A = Added, R = Revised, D = Deleted, O = Overflow

75-EFFECTIVE PAGES



CHAPTER 75
AIR

Title	CH-SC-SU	Schem	Page	Sheet	Date	Effectivity
<u>COMPRESSOR BLEED CONTROL SYSTEM</u>						
COMPRESSOR BLEED VALVES CONTROL SYSTEM	75-32-00		101		May 06/2009	ALL
ENGINE BLEED VALVES CONTROL	75-32-01		101	1	Jan 21/2005	001-009
				2	Jan 21/2005	001-009
				3	Jan 21/2005	001-009
			101.1	1	Jan 21/2005	001-009
				2	Jan 21/2005	001-009
				3	Jan 21/2005	001-009
			102	1	Jan 21/2005	010-099
				2	Jan 21/2005	010-099
				3	Jan 21/2005	010-099

CHAPTER 75
AIR

CH-SC-SU	Title
75-32-00	COMPRESSOR BLEED VALVES CONTROL SYSTEM
75-32-01	ENGINE BLEED VALVES CONTROL

CH-SC-SU	Title
----------	-------

75-ALPHABETICAL INDEX

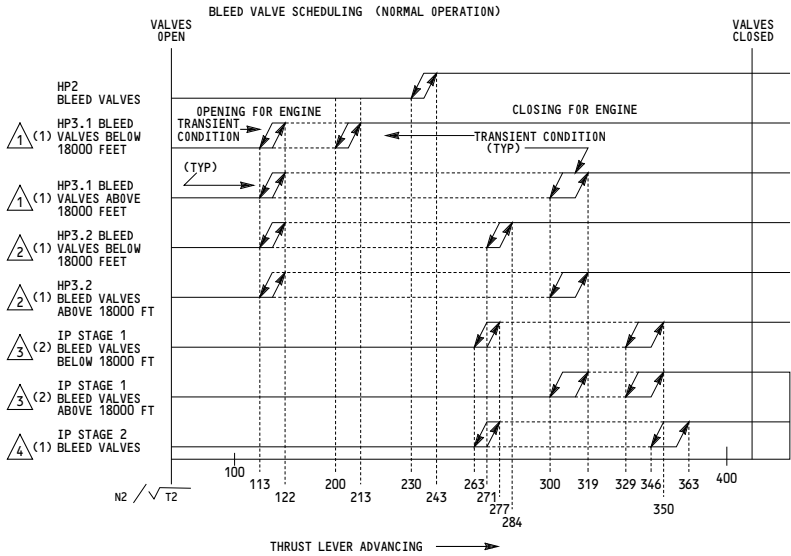
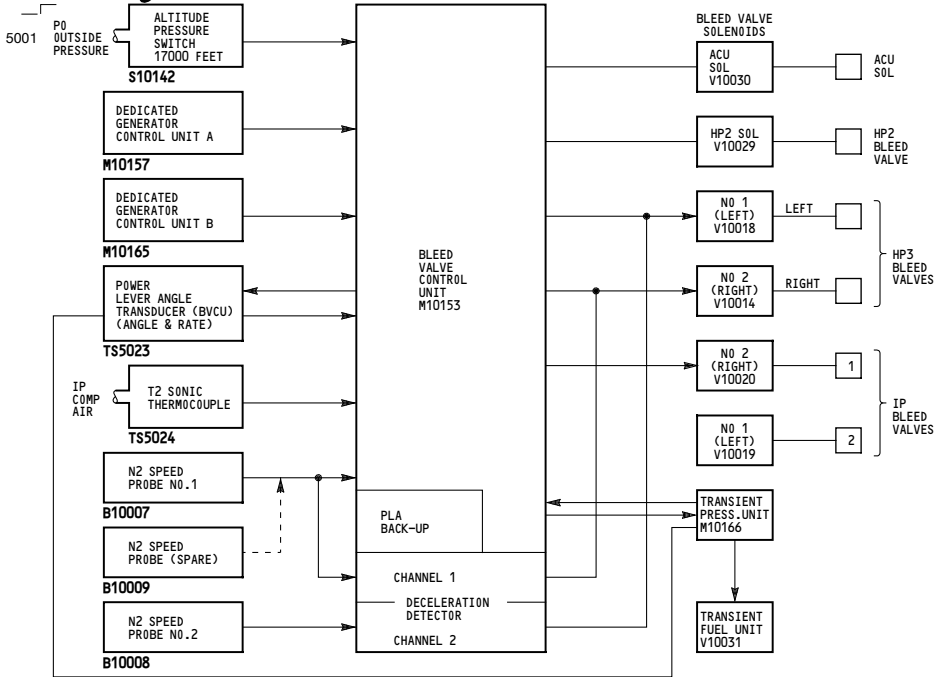

SYMBOL	BLEED VALVES	ALTITUDE	TIMER	ACTION ON BV
A	HP3S AND HP2S △1 AND △2	<18000 FT	6.5 SEC	WHEN BOTH A AND B ARE TIMED OUT CLOSE BLEED VALVES
		>18000 FT	13.0 SEC	
B	HP3S AND HP2S △1 AND △2	<18000 FT	2.5 SEC	WHEN BOTH D AND E ARE TIMED OUT CLOSE BLEED VALVES
		>18000 FT	5.0 SEC	
C	HP3S AND HP2S △1 AND △2	<18000 FT	IMMEDIATE	OPEN IMMEDIATELY
		>18000 FT	IMMEDIATE	OPEN IMMEDIATELY
D	IPS △3 & △4	<18000 FT	9.5 SEC	WHEN BOTH D AND E ARE TIMED OUT CLOSE BLEED VALVES
		>18000 FT	19.0 SEC	
E	IPS △3 & △4	<18000 FT	4.5 SEC	WHEN BOTH D AND E ARE TIMED OUT CLOSE BLEED VALVES
		>18000 FT	9.0 SEC	
F	IPS △3 & △4	<18000 FT	IMMEDIATE	OPEN IMMEDIATELY
		>18000 FT	IMMEDIATE	OPEN IMMEDIATELY

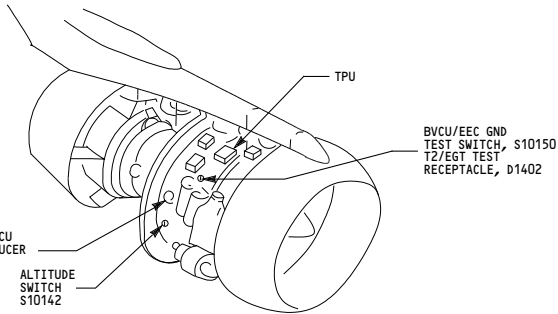

- NOTES:**
- △ SEE 75-32-01
 - 1 TRANSIENT ENGINE CONDITION EXISTS WHEN THE CHANGE IN N2/T2 IS MORE THAN 13 UNITS AT A RATE GREATER THAN 5 UNITS/SECOND.

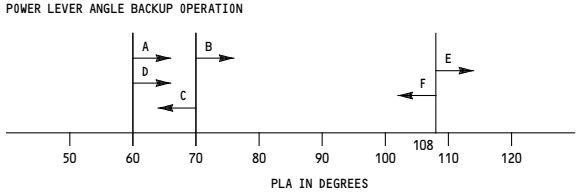

ALL	COMPRESSOR BLEED VALVES CONTROL SYSTEM
D280N032S	

5014

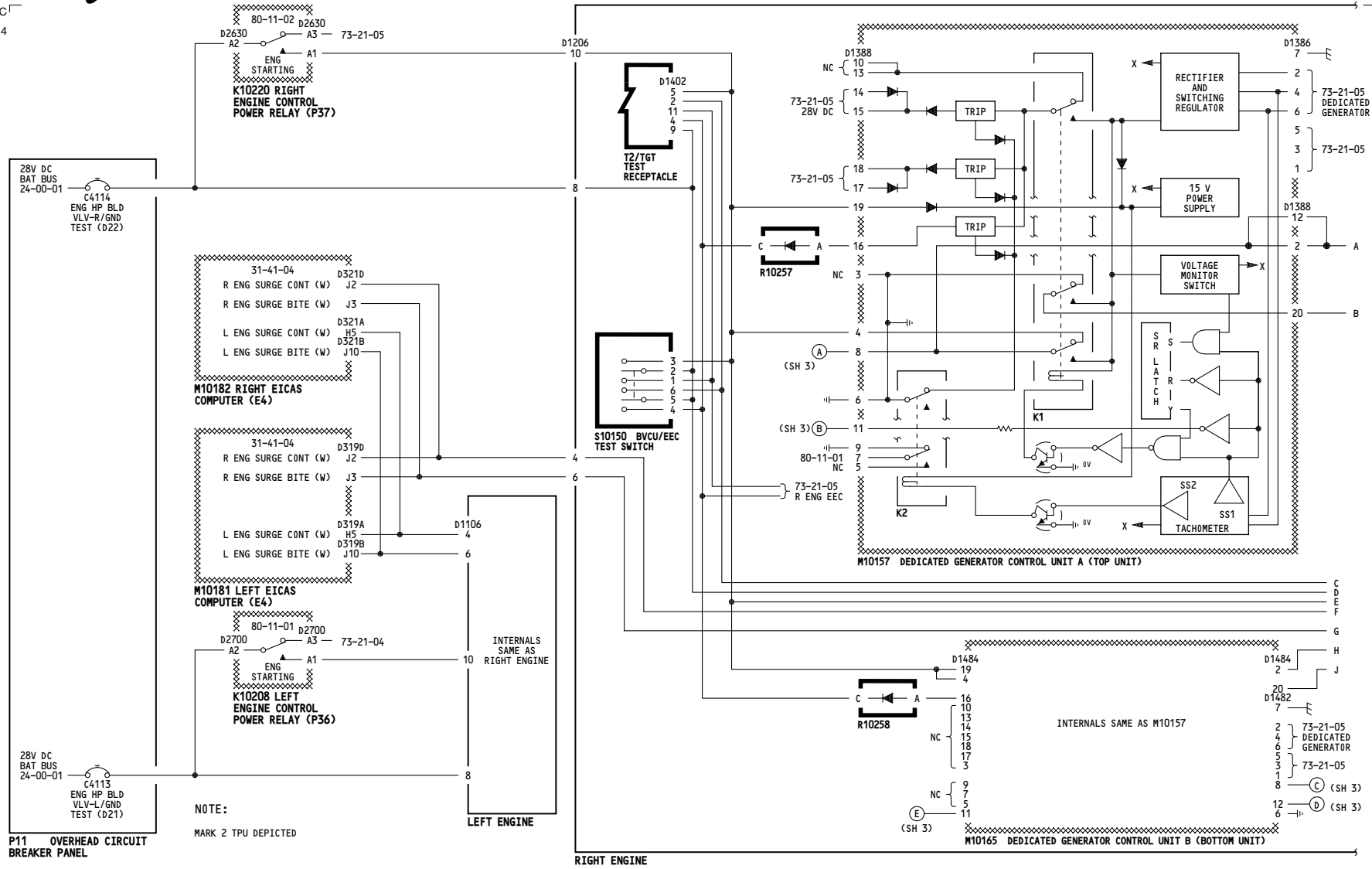

P11 OVERHEAD CIRCUIT BREAKER PANEL

001-009	<p>ENGINE BLEED VALVES CONTROL</p> <p>D280N032S</p>
---------	--

75-32-01

5013

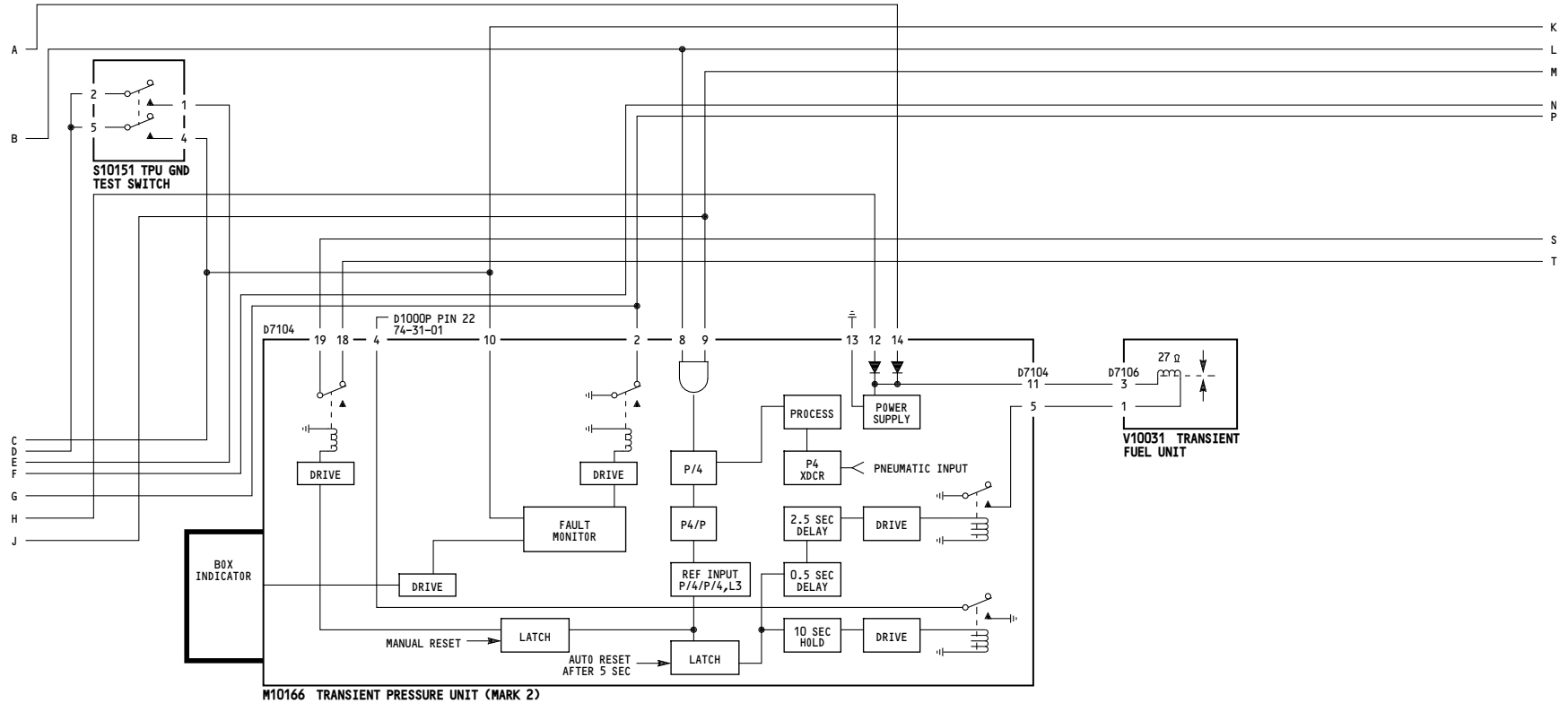

RIGHT ENGINE

NOTES: MARK 2 T.P.U. INSTALLATION DEPICTED

001-009	<p align="center">ENGINE BLEED VALVES CONTROL</p> <p align="center">D280N032S</p>
---------	--

75-32-01

Page 101
Sheet 2
Jan 21/2005

5013

WIRING DIAGRAMS
71-51-11
75-31-11

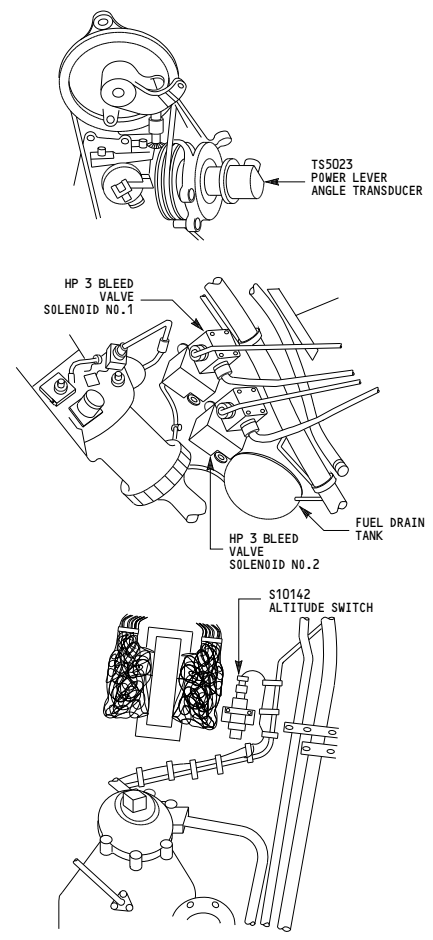
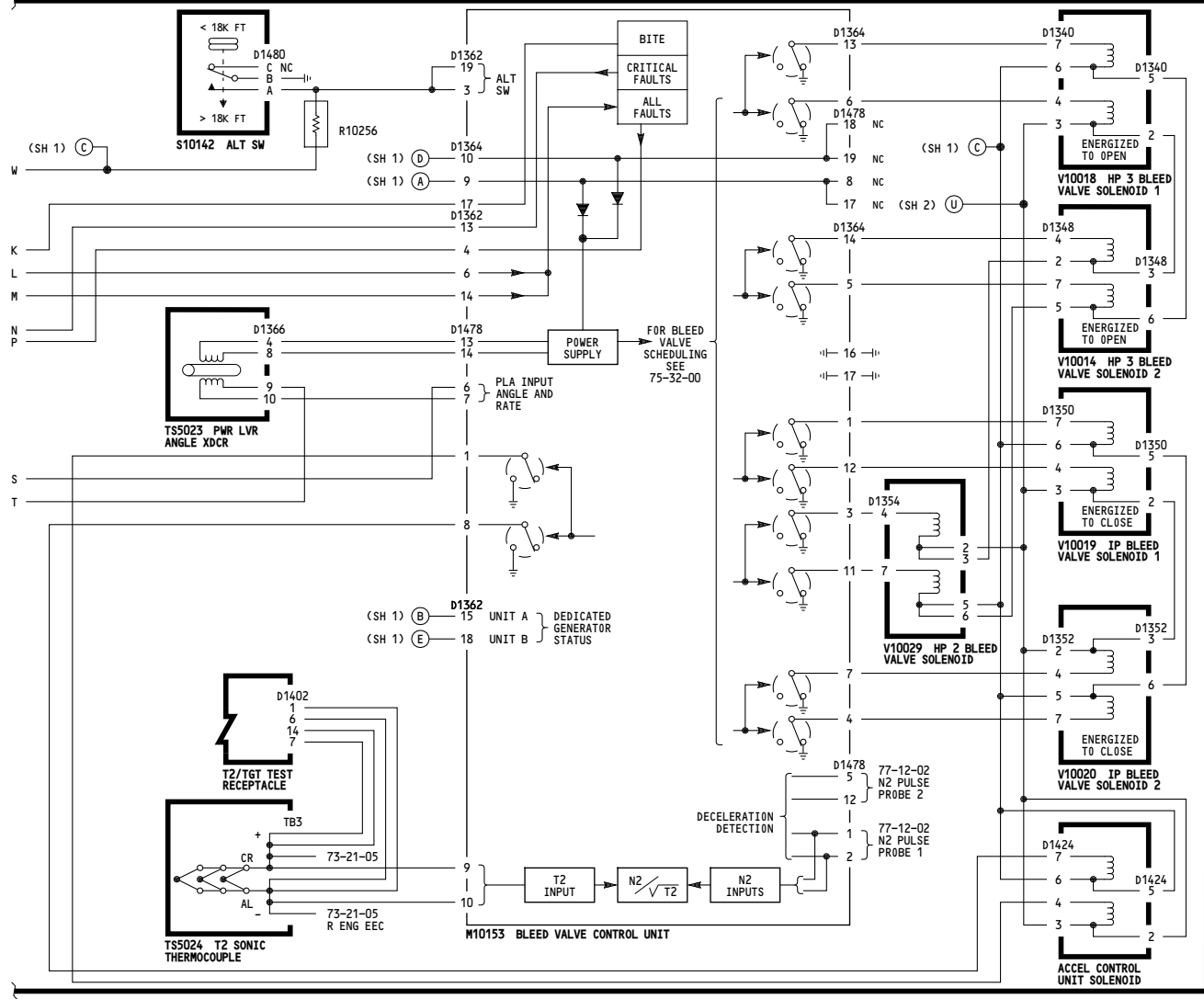

NOTES: MARK 2 T.P.U. INSTALLATION DEPICTED

RIGHT ENGINE

001-009

ENGINE BLEED VALVES CONTROL

D280N032S

75-32-01

Page 101
Sheet 3
Jan 21/2005

THIS PAGE INTENTIONALLY LEFT BLANK

5017

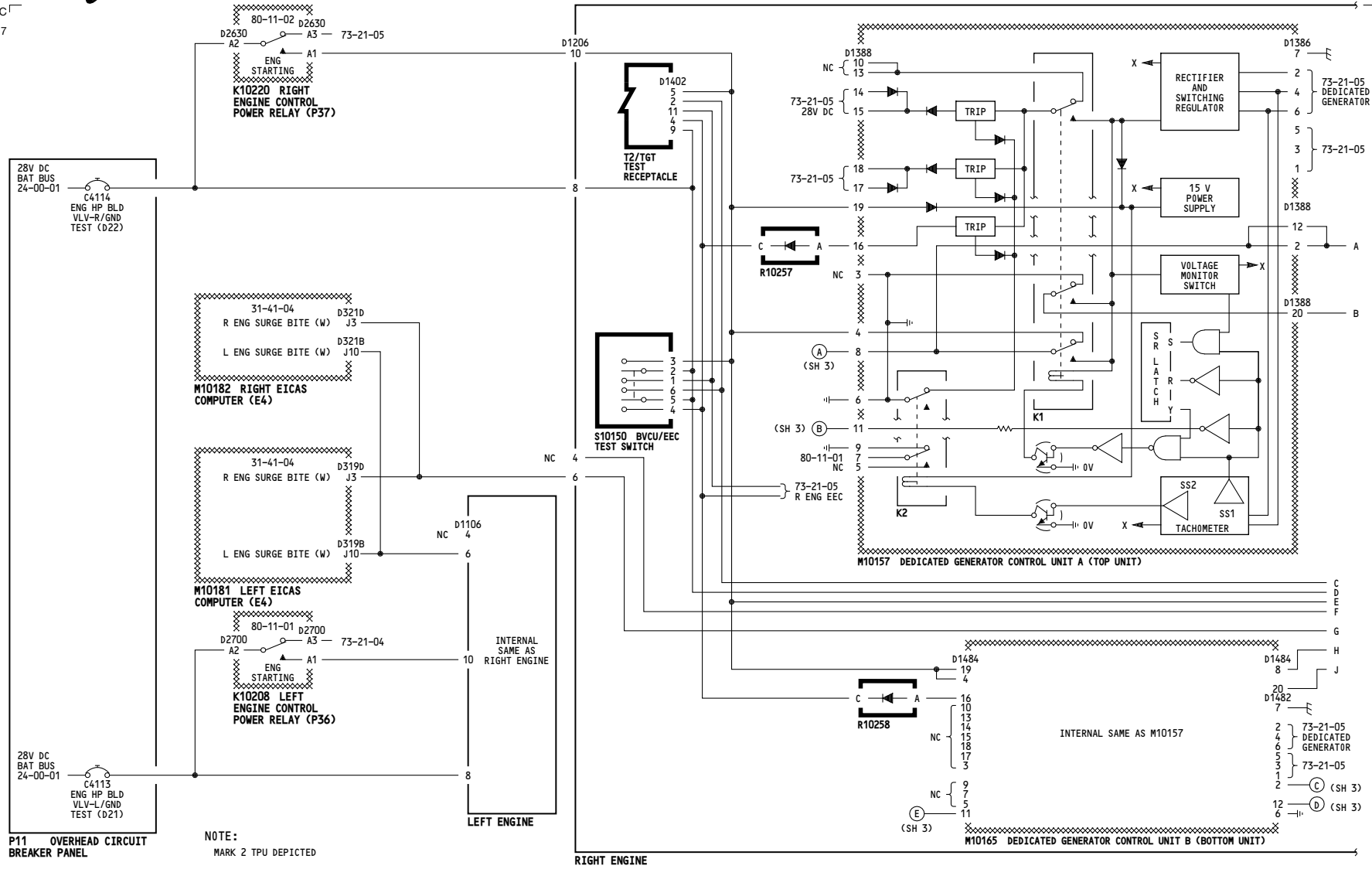

P11 OVERHEAD CIRCUIT BREAKER PANEL

NOTE:
MARK 2 TPU DEPICTED

RIGHT ENGINE

001-009	ENGINE BLEED VALVES CONTROL	Incorporates 75-0005
D280N032S		

75-32-01

Page 101.1
Sheet 1
Jan 21/2005

5013

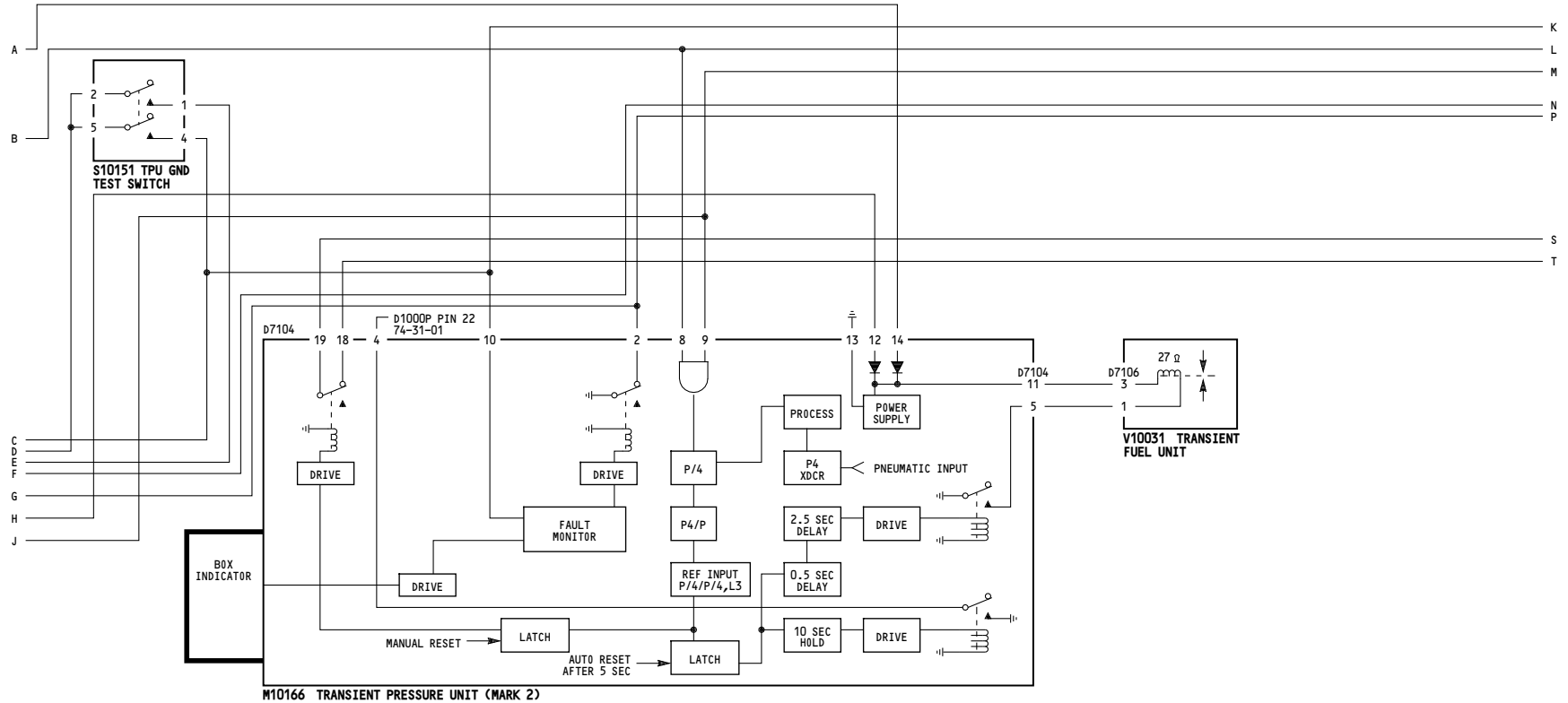

RIGHT ENGINE

NOTES: MARK 2 T.P.U. INSTALLATION DEPICTED

001-009

ENGINE BLEED VALVES CONTROL

D280N032S

75-32-01

Page 101.1
Sheet 2
Jan 21/2005

5013

WIRING DIAGRAMS
71-51-11
75-31-11

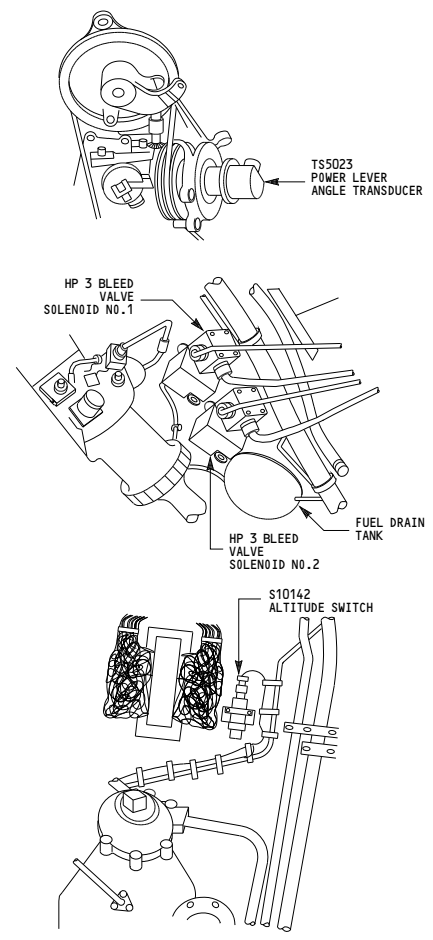
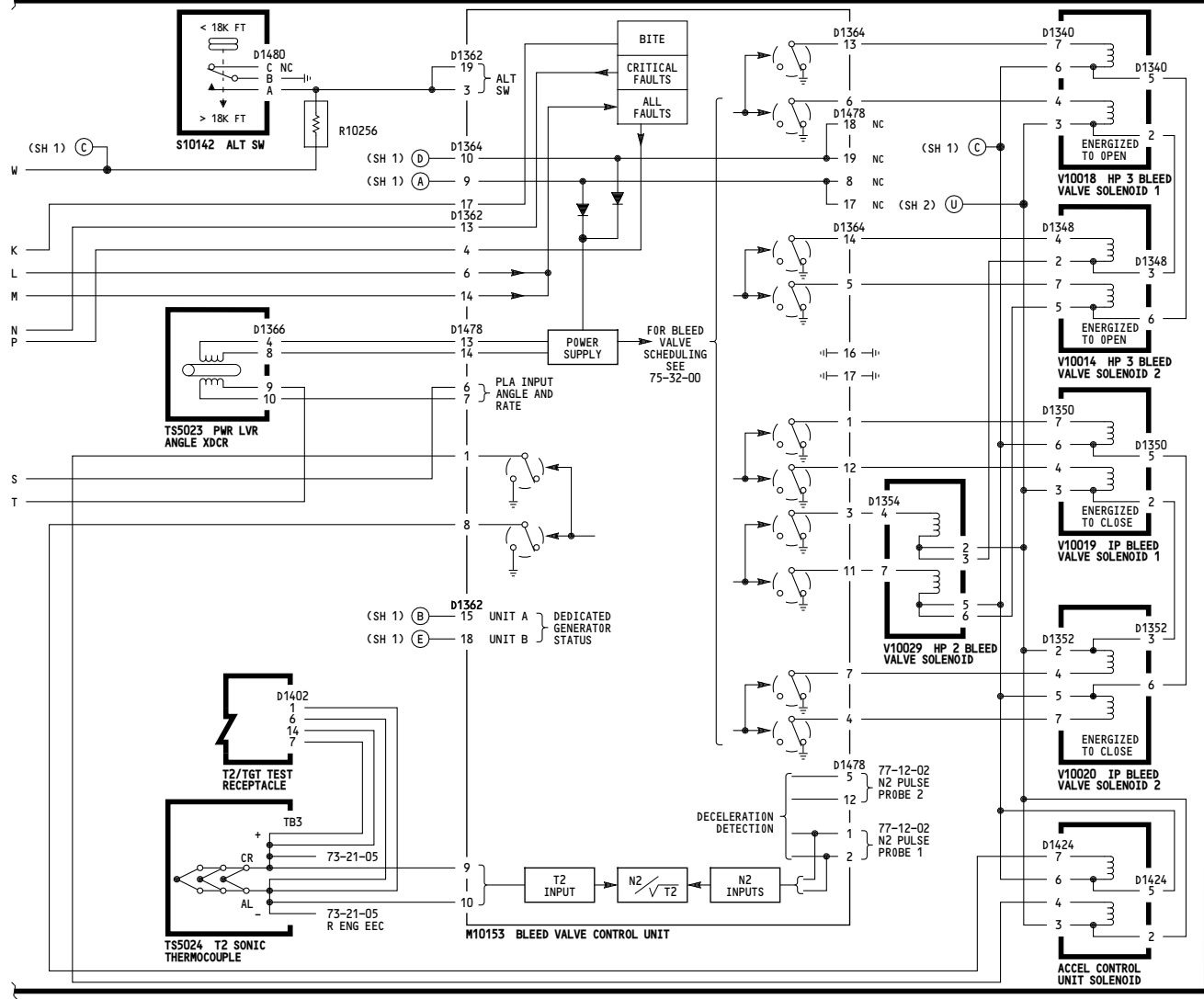

NOTES: MARK 2 T.P.U. INSTALLATION DEPICTED

001-009	<p>ENGINE BLEED VALVES CONTROL</p> <p>D280N032S</p>
---------	--

75-32-01

Page 101.1
Sheet 3
Jan 21/2005

THIS PAGE INTENTIONALLY LEFT BLANK

5017

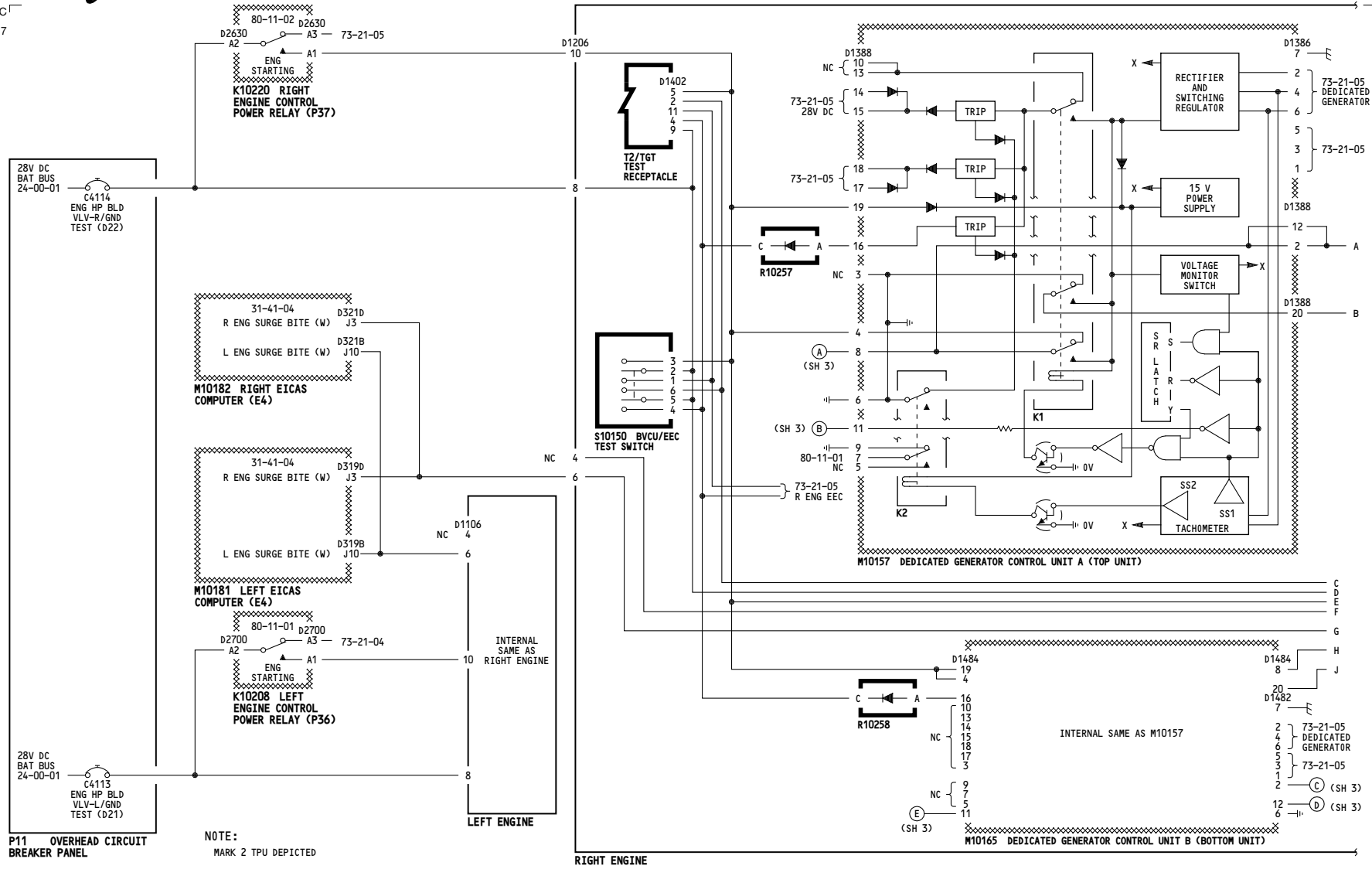

<p>010-099</p>	<p>ENGINE BLEED VALVES CONTROL</p> <p>D280N032S</p>
----------------	--

75-32-01

5013

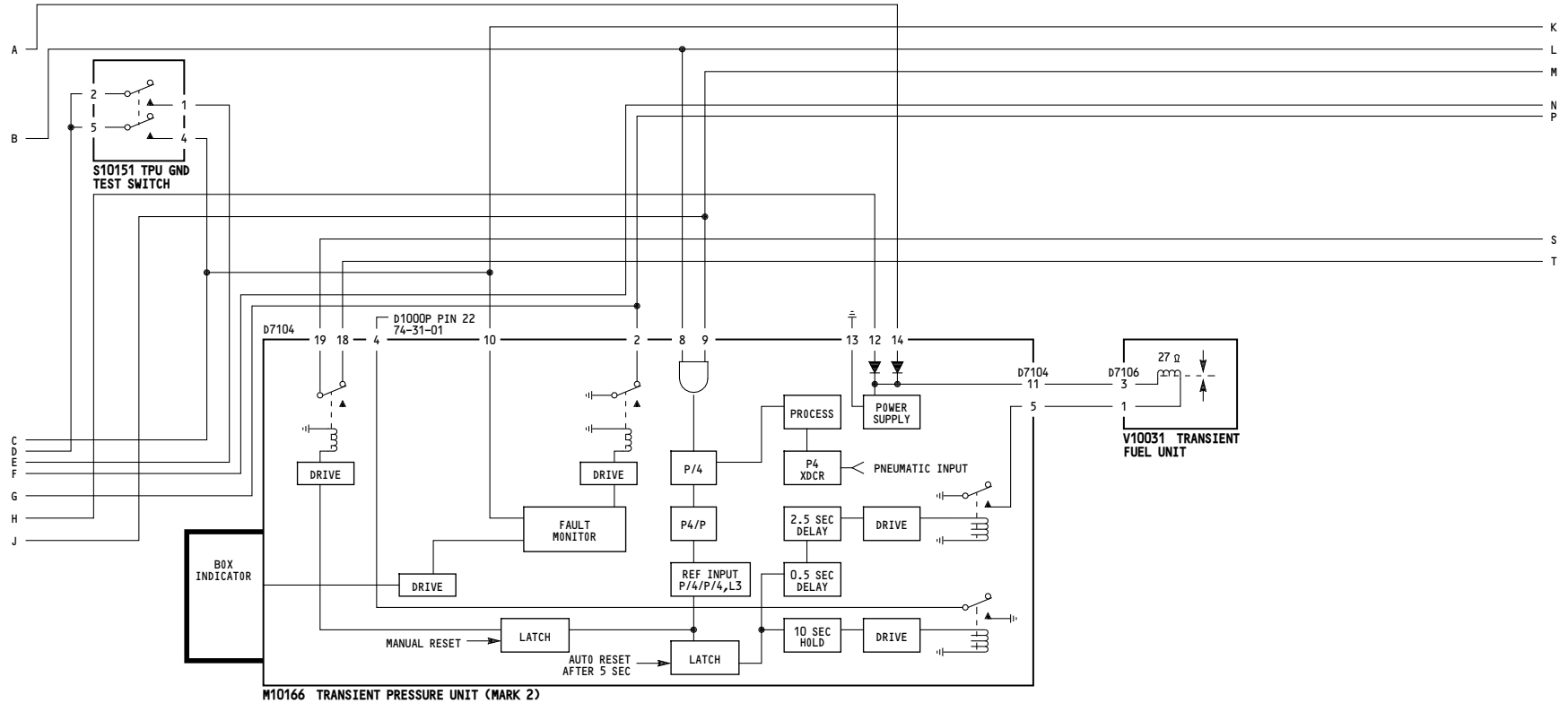

RIGHT ENGINE

NOTES: MARK 2 T.P.U. INSTALLATION DEPICTED

010-099

ENGINE BLEED VALVES CONTROL

D280N032S

75-32-01

Page 102
Sheet 2
Jan 21/2005

5013

WIRING DIAGRAMS
71-51-11
75-31-11

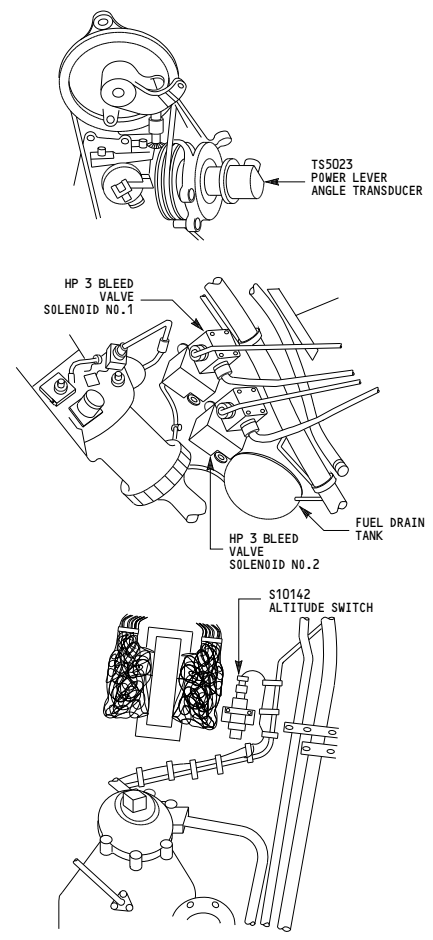
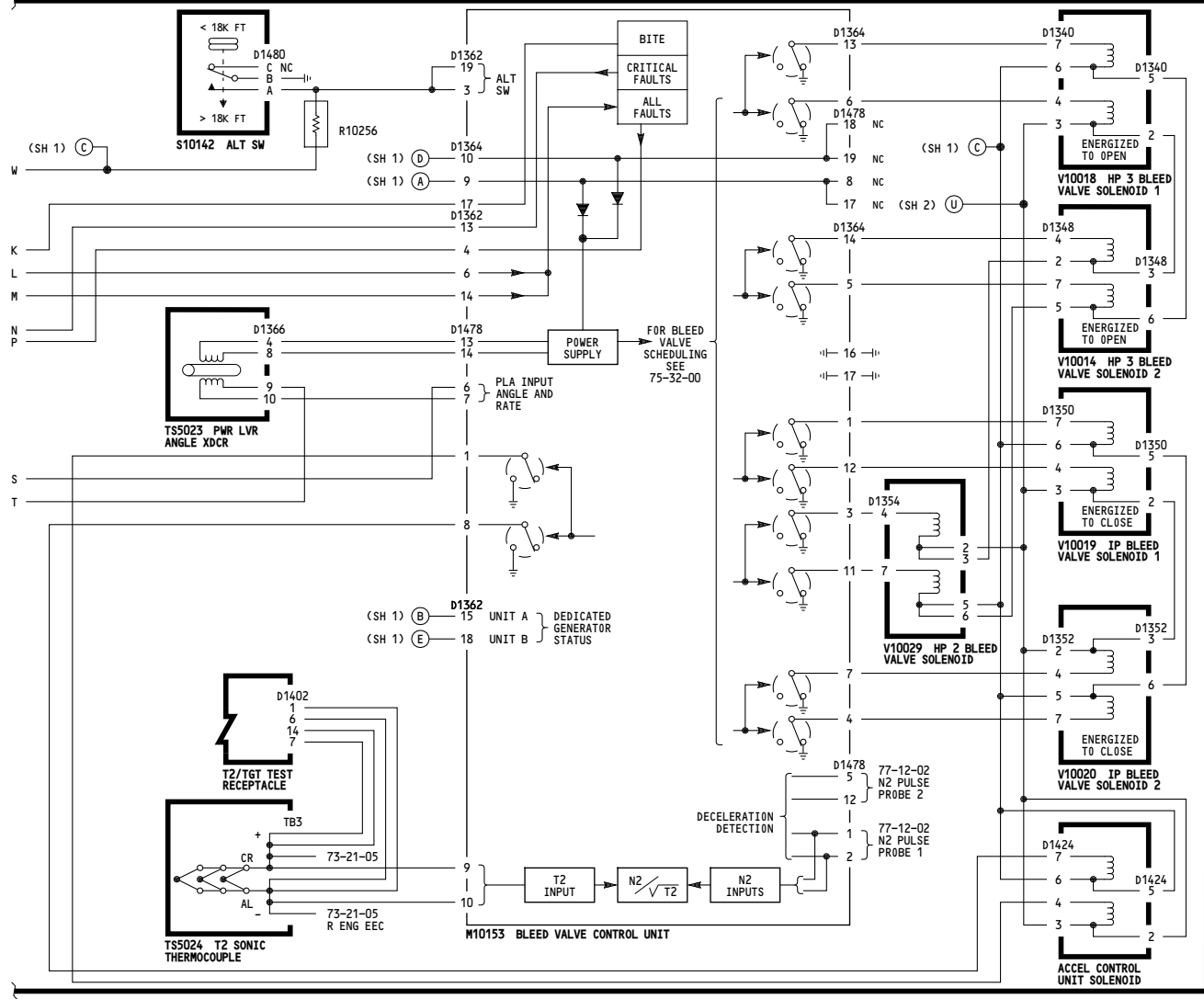

NOTES: MARK 2 T.P.U. INSTALLATION DEPICTED

010-099	<p>ENGINE BLEED VALVES CONTROL</p> <p>D280N032S</p>
---------	--

75-32-01