

**CHAPTER**

**09**

**TOWING AND TAXIING**



**767**  
**ILLUSTRATED TOOL AND EQUIPMENT MANUAL**

**CHAPTER 09**  
**TOWING AND TAXIING**

Subject/Page	Date	Subject/Page	Date	Subject/Page	Date
EFFECTIVE PAGES					
1	Oct 10/2008				
2	BLANK				
09-CONTENTS					
1	Apr 10/2008				
2	BLANK				
09-00-01					
1	Oct 10/2006				
2	BLANK				
09-00-02					
1	Apr 10/2008				
2	Apr 10/2006				

A = Added, R = Revised, O = Overflow, D = Deleted

## 09-EFFECTIVE PAGES

Page 1  
Oct 10/2008

D634T501



**767**  
**ILLUSTRATED TOOL AND EQUIPMENT MANUAL**

**TABLE OF CONTENTS**

<b><u>Subject</u></b>	<b><u>Title</u></b>	<b><u>Part No.</u></b>
<b>09-</b>	<b>TOWING AND TAXIING</b>	
09-00-01	DATA SHEET - 767 TOWBAR	A09002
09-00-02	LOCK PIN - NOSE GEAR TOWING LEVER	A09003-1, -2

# 09-CONTENTS



**767**

## **ILLUSTRATED TOOL AND EQUIPMENT MANUAL**

**PART NUMBER: A09002**

**NAME:** DATA SHEET - 767 TOWBAR

**AIRPLANE MAINTENANCE:** YES

**COMPONENT MAINTENANCE:** NO

**USAGE & DESCRIPTION:** The A09002 data sheet provides design load data and tow fitting dimensions required for 767 airplane towbar design.



**767**

## **ILLUSTRATED TOOL AND EQUIPMENT MANUAL**

**PART NUMBER: A09003-1, -2**

**NAME:** LOCK PIN - NOSE GEAR TOWING LEVER

**AIRPLANE MAINTENANCE:** YES

**COMPONENT MAINTENANCE:** NO

**USAGE & DESCRIPTION:** The A09003-1 or -2 lock pin is used on all 767 airplanes. A09003 is used to lock the nose landing gear towing lever during towing procedures. A09003-1 or -2 is a basic quick-release pin with an attached warning streamer. Refer to AMM 09-11-00, 10-11-01, 22-00-02, 22-10-00, 22-13-01, 22-13-02, 22-13-05, 27-21-00, 27-21-02, 27-21-05, 27-21-07, 27-21-10, 27-21-13, 27-21-18, 27-21-19, 27-23-00, 27-28-00, 27-28-01, 32-09-08, 32-21-11, 32-34-05, 32-45-02, 32-51-00, 32-51-01, 32-51-05 and 32-51-10 for further usage instructions.

**DIMENSIONS:** 1 x 1 x 5 inches (25 x 25 x 127 mm)

**NOTE:** A09003-2 replaces A09003-1 for future procurement.

**767**  
**ILLUSTRATED TOOL AND EQUIPMENT MANUAL**

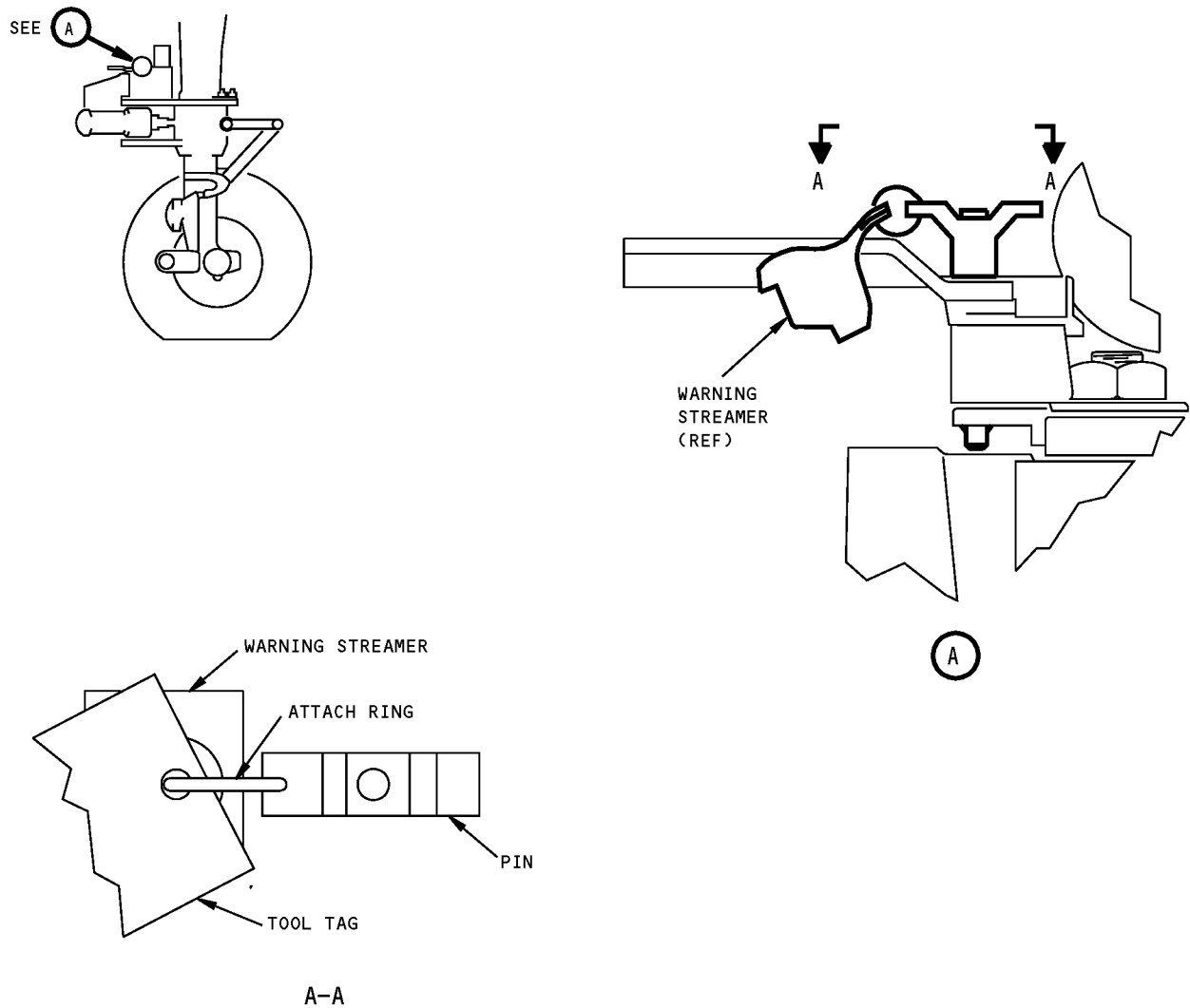

**Nose Gear Towing Lever Lock Pin**  
**Figure 1**