

Scandinavian Airlines System

PAGE	DATE	CODE	PAGE	DATE	CODE	PAGE	DATE	CODE
CHAPTER 75 TAB								
AIR (PW4000)								
EFFECTIVE PAGES SEE LAST PAGE OF LIST FOR NUMBER OF PAGES								
75-CONTENTS								
1	AUG 22/99	NSAS						
2	BLANK							
75-FAULT CODE INDEX								
1	MAY 10/96	N03						
2	BLANK							
75-22-00								
101	FEB 10/95	N01						
102	FEB 10/95	N01						
75-23-00								
101	AUG 10/91	N01						
102	AUG 10/91	N01						
103	DEC 10/98	N01						
104	DEC 10/98	N01						
75-24-00								
101	AUG 10/91	N01						
102	AUG 10/91	N01						
103	AUG 10/91	N01						
104	AUG 10/91	N01						
75-31-00								
101	MAY 10/94	N01						
102	MAY 10/94	N01						
75-32-00								
101	MAY 10/94	N01						
102	MAY 10/94	N01						
103	MAY 10/94	N01						
104	BLANK							
75-33-00								
101	MAY 10/94	N01						
102	MAY 10/94	N01						
103	MAY 10/94	N01						
104	MAY 10/94	N01						
105	MAY 10/94	N01						
106	BLANK							

R = REVISED, A = ADDED OR D = DELETED

F = FOLDOUT PAGE

33

AUG 22/09

D633T633

CHAPTER 75

EFFECTIVE PAGES

N PAGE 1

LAST PAGE

CHAPTER 75 - AIR

TABLE OF CONTENTS

<u>Subject</u>	Chapter Section <u>Subject</u>	<u>Page</u>	<u>Effectivity</u>
FAULT ISOLATION	75-FAULT CODE INDEX	1	ALL
<u>AIR</u>	75-00-00		
<u>COOLING</u>	75-20-00		
ENGINE BEARING COOLING SYSTEM	75-22-00		
Component Location		101	ALL
Component Index			
Component Location			
ENGINE EXTERNAL ACCESSORIES	75-23-00		
COOLING			
Component Location		101	ALL
Component Index			
Component Location			
Fault Isolation			
L (R) NAC VENT VAL EICAS		103	
Maintenance Message Displayed (Fig. 103)			
TURBINE COOLING SYSTEM	75-24-00		
Component Location		101	ALL
Component Index			
Component Location			
<u>COMPRESSOR CONTROL</u>	75-30-00		
COMPRESSOR STATOR VANE CONTROL SYSTEM	75-31-00		
Component Location		101	ALL
Component Index			
Component Location			
COMPRESSOR BLEED CONTROL SYSTEM	75-32-00		
Component Location		101	ALL
Component Index			
Component Location			
HPC SECONDARY FLOW CONTROL SYSTEM	75-33-00		
Component Location		101	ALL
Component Index			
Component Location			

75-CONTENTS

NSAS

Page 1

Aug 22/99



FAULT CODE	1. LOG BOOK REPORT 2. FAULT ISOLATION REFERENCE
75 03 XA --	Not Used.
75 03 01 00	1. EICAS msg L NAC VENT VAL displayed. (Ref Chapter 31 fault code diagram.) 2. FIM 75-23-00/101, Fig. 103, Block 1
75 03 02 00	1. EICAS msg R NAC VENT VAL displayed. (Ref Chapter 31 fault code diagram.) 2. FIM 75-23-00/101, Fig. 103, Block 1
75 03 03 --	Not Used.

EFFECTIVITY

ALL

75-FAULT CODE INDEX

N03

Page 1
May 10/96

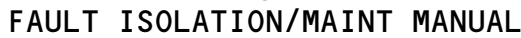

//////////////////////////////////////
 / PW4000 SERIES /
 / ENGINES /
 //////////////////////////////////////

ENGINE BEARING COOLING SYSTEM

COMPONENT	FIG. 102 SHT	QTY	ACCESS/AREA	AMM REFERENCE
COOLER - NO. 3 BEARING BUFFER AIR		2	416AR,426AR THRUST REVERSER	75-22-01

Engine Bearing Cooling System - Component Index
Figure 101

EFFECTIVITY-

ALL

75-22-00

N01

Page 101
Feb 10/95

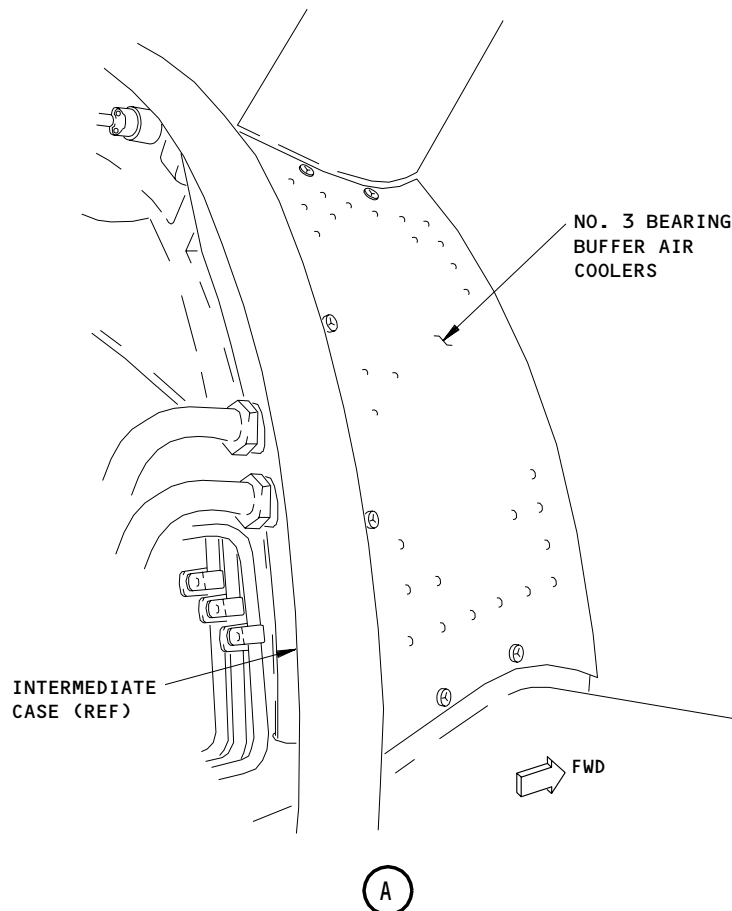
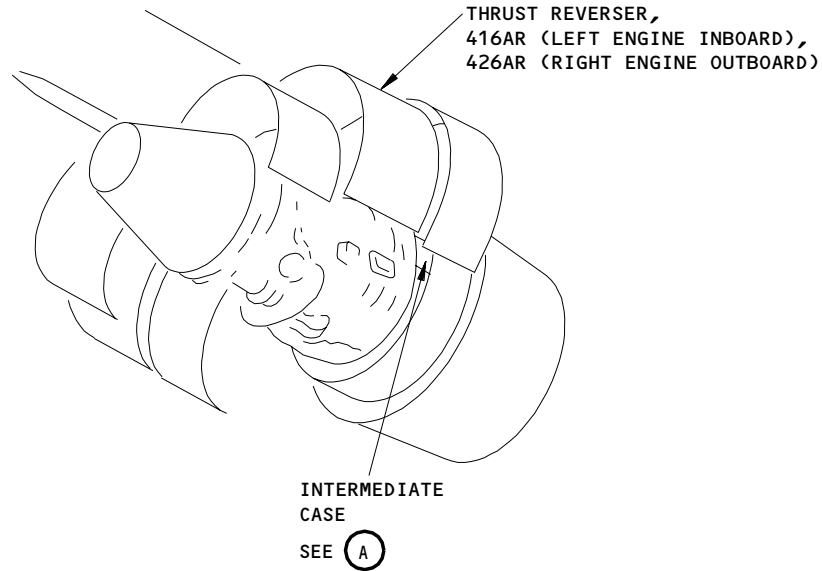

Engine Bearing Cooling System - Component Location
Figure 102

EFFECTIVITY

ALL

75-22-00

N01

Page 102
Feb 10/95

ENGINE EXTERNAL ACCESSORIES COOLING

COMPONENT	FIG. 102 SHT	QTY	ACCESS/AREA	REFERENCE
CIRCUIT BREAKERS	1		FLT COMPT, P11	
NAC VENT VALVE, C1449		1	11K9	*
NAC VENT VALVE, C1450		1	11L35	*
COMPUTER - (REF 31-41-00, FIG. 101)				
L EICAS, M10181				
R EICAS, M10182				
DUCT - NAC ZONE VENTILATION	1	2	415AL,425AL, THRUST REVERSER	75-23-03
RELAY - (REF 31-01-36, FIG. 101)				
L NACELLE COOLING VALVE DISAGREE, K676				
R NACELLE COOLING VALVE DISAGREE, K677				
SWITCH - L BAROMETRIC, S494	1	1	441CT, FWD STRUT PRESS RELIEF UPPER ACCESS DOOR	75-23-04
SWITCH - R BAROMETRIC, S495	1	1	431CT, FWD STRUT PRESS RELIEF UPPER ACCESS DOOR	75-23-04
VALVE - NACELLE ZONE VENTILATION SHUTOFF, V353	1	2	415AL,425AL, THRUST REVERSER	75-23-02

* SEE THE WDM EQUIPMENT LIST

 Engine External Accessories Cooling - Component Index
 Figure 101

EFFECTIVITY

ALL

75-23-00

N01

 Page 101
 Aug 10/91

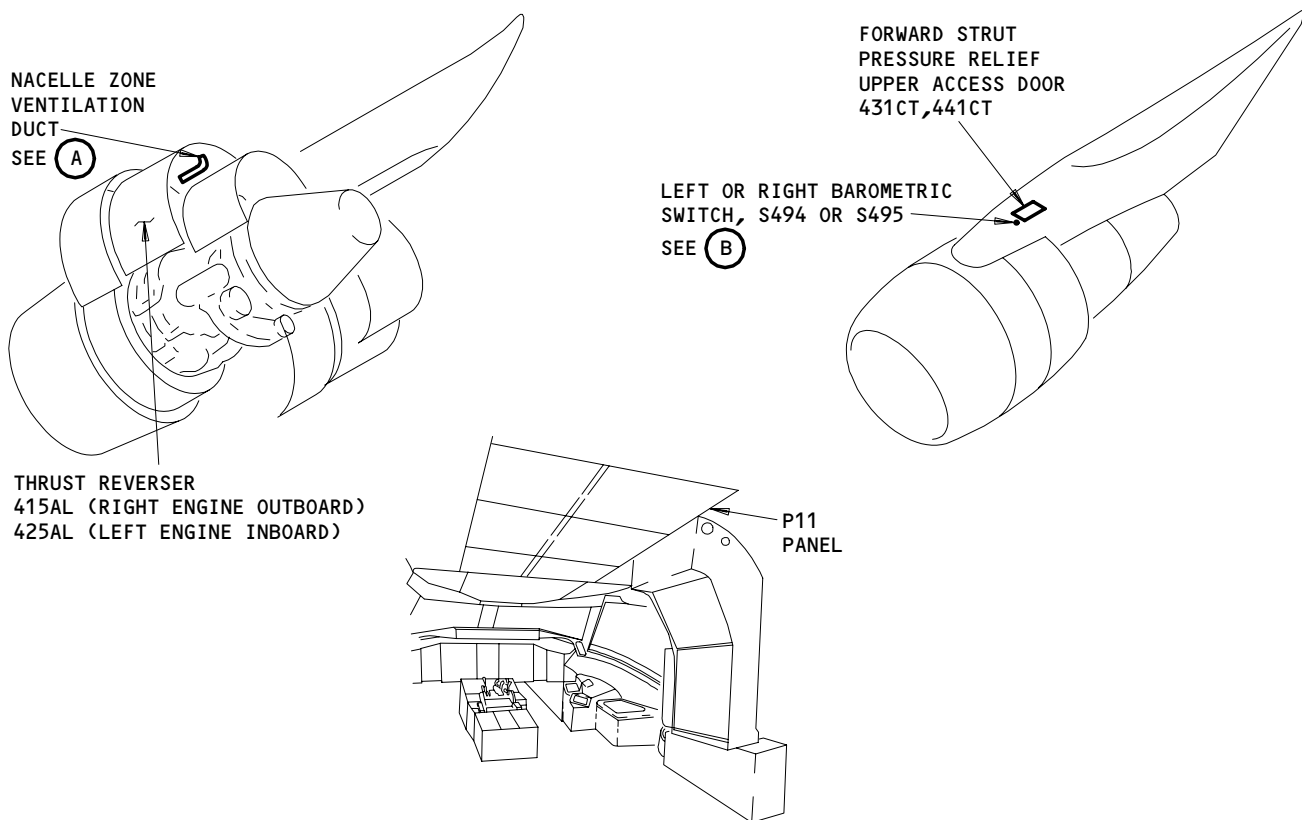

FLIGHT COMPARTMENT

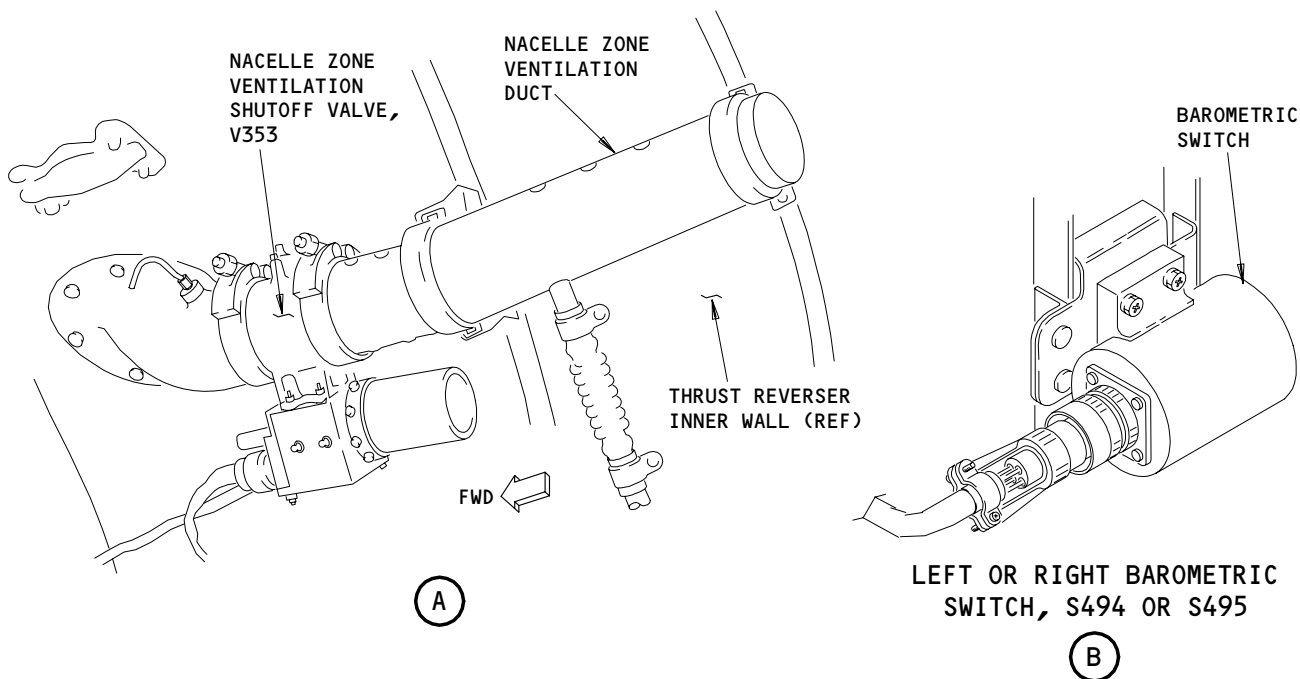

Engine External Accessories Cooling - Component Location
Figure 102

EFFECTIVITY

ALL

75-23-00

N01

Page 102
Aug 10/91

"L (R) NAC VENT VAL"
EICAS MAINTENANCE
MESSAGE DISPLAYED



POSSIBLE CAUSES:

1. AIRPLANE OPERATED ABOVE 23,000 FEET WITH THE ASSOCIATED ENGINE BLEED SYSTEM OFF
2. BAROMETRIC SWITCH FAILURE (AMM 75-23-04/401)
3. VENTILATION SHUTOFF VALVE FAILURE (AMM 75-23-02/401)
4. DISAGREE RELAY FAILURE (WDM 75-23-11)
5. REPAIR THE DISAGREE RELAY CIRCUIT (WDM 75-23-11)
6. VENTILATION SHUTOFF VALVE LINES LEAK (AMM 71-07-00/101)

FAULT ISOLATION:

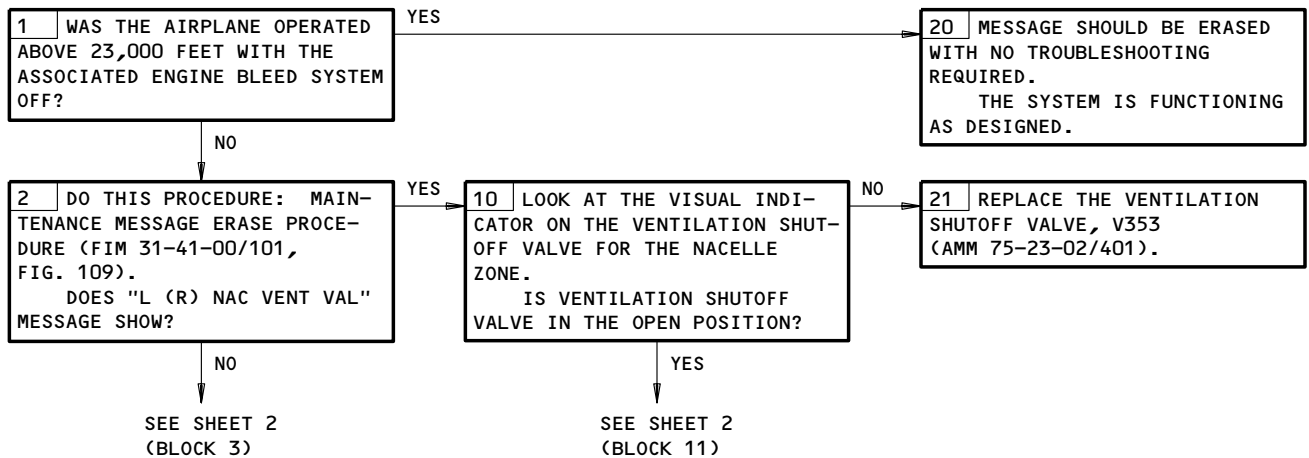

L (R) NAC VENT VAL EICAS Maintenance Message Displayed
Figure 103 (Sheet 1)

EFFECTIVITY

ALL

75-23-00

N01

Page 103
Dec 10/98

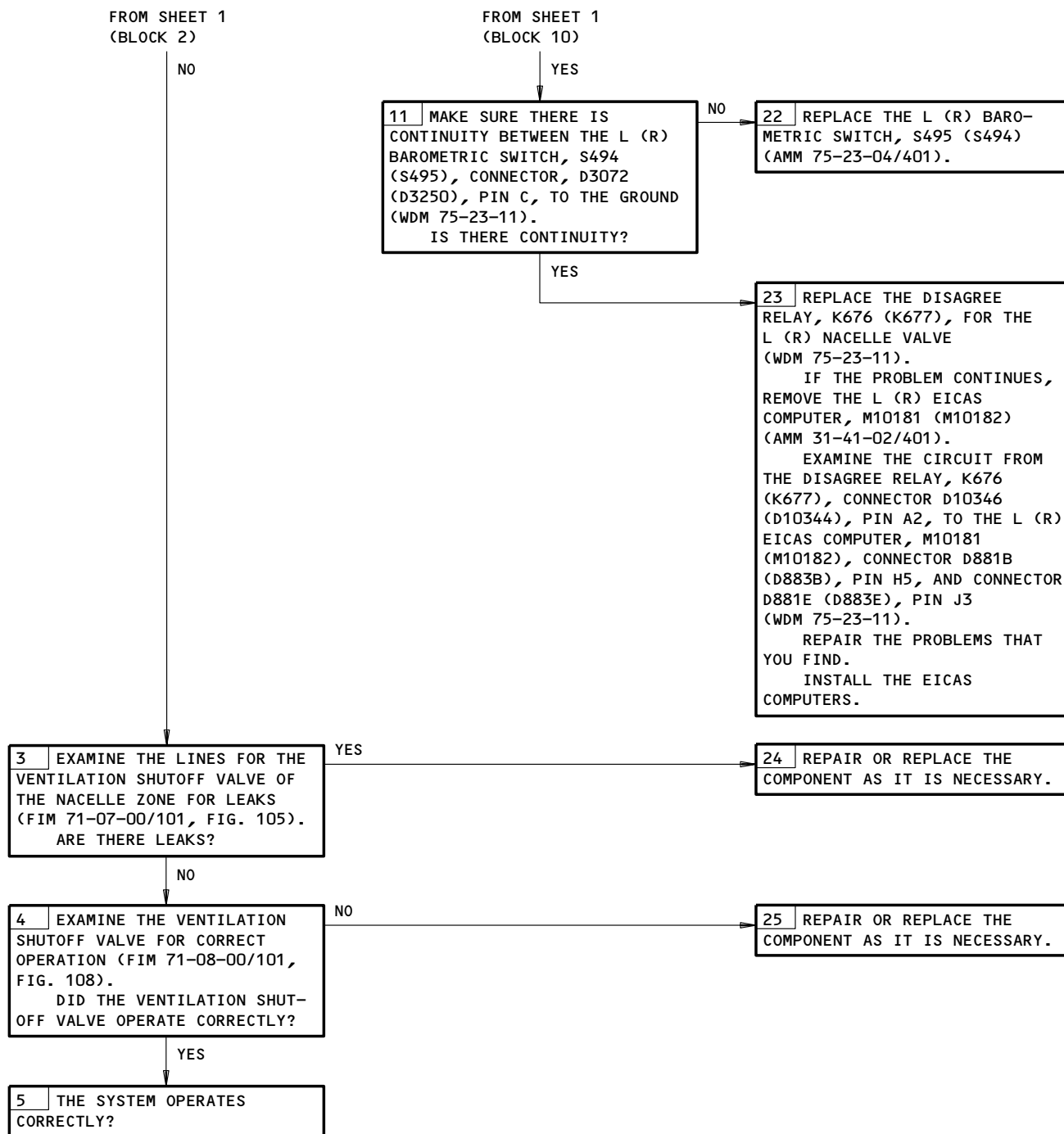

L (R) NAC VENT VAL EICAS Maintenance Message Displayed
Figure 103 (Sheet 2)

EFFECTIVITY

ALL

75-23-00

N01

Page 104
Dec 10/98

TURBINE COOLING SYSTEM

COMPONENT	FIG. 102 SHT	QTY	ACCESS/AREA	REFERENCE
CIRCUIT BREAKERS	1		FLT COMPT, P11	
L ENG CH A PERF SOL, C1465		1	11L3	*
L ENG CH B PERF SOL, C1466		1	11L4	*
R ENG CH A PERF SOL, C1467		1	11L30	*
R ENG CH B PERF SOL, C1468		1	11L31	*
ACTUATOR - TURBINE CASE COOLING (TCC) AIR VALVE	2	2	416AL,426AL, THRUST REVERSER	75-24-05
CABLE - TURBINE CASE COOLING (TCC) AIR VALVE CONTROL	2	2	416AR,426AR, THRUST REVERSER	75-24-11
COLLECTOR - TURBINE CASE COOLING (TCC) HPT	1	2	418AR,428AR, CORE COWL PANEL	75-24-06
COLLECTOR - TURBINE CASE COOLING (TCC) LPT	1	2	418AR,428AR, CORE COWL PANEL	75-24-08
CONTROL - (REF 73-21-00, FIG. 101)				
ELECTRONIC ENGINE, M7198				
DUCT - TURBINE CASE COOLING (TCC) INLET	1	2	418AR,428AR, CORE COWL PANEL	75-24-12
DUCTS - TURBINE VANE AND BLADE COOLING AIR	2	2	416AR,426AR, THRUST REVERSER	75-24-02
DUCTS - TURBINE VANE AND BLADE COOLING AIR	3	2	415AL,425AL, THRUST REVERSER	75-24-02
FILTER - TURBINE VANE AND BLADE COOLING AIR VALVE	3	2	415AL,425AL, THRUST REVERSER	75-24-14
MANIFOLDS - TURBINE CASE COOLING (TCC) HPT	1	8	417AL,418AR,427AL,428AR, CORE COWL PANELS	75-24-07
MANIFOLDS - TURBINE CASE COOLING (TCC) LPT	1	14	417AL,418AR,427AL,428AR, CORE COWL PANELS	75-24-09
SOLENOID - (REF 75-33-00, FIG. 101)				
HPC SECONDARY FLOW CONTROL VALVE, TURBINE VANE AND BLADE COOLING AIR VALVE				
SWITCH - TURBINE VANE AND BLADE COOLING AIR VALVE POSITION	2	2	416AR,426AR, THRUST REVERSER	75-24-13
VALVE - HPT TURBINE CASE COOLING (TCC) AIR SHUTOFF	1	2	418AR,428AR, CORE COWL PANEL	75-24-03
VALVE - LPT TURBINE CASE COOLING (TCC) AIR SHUTOFF	1	2	418AR,428AR, CORE COWL PANEL	75-24-04
VALVE - TURBINE VANE AND BLADE COOLING AIR	2	2	416AR,426AR, THRUST REVERSER	75-24-01
VALVE - TURBINE VANE AND BLADE COOLING AIR	3	2	415AL,425AL, THRUST REVERSER	75-24-01

* SEE THE WDM EQUIPMENT LIST

Turbine Cooling System - Component Index
Figure 101

EFFECTIVITY

ALL

75-24-00

N01

Page 101
Aug 10/91

BOEING
767
FAULT ISOLATION/MAINT MANUAL

////////////////////
/ PW4000 SERIES /
/ ENGINES /
////////////////////

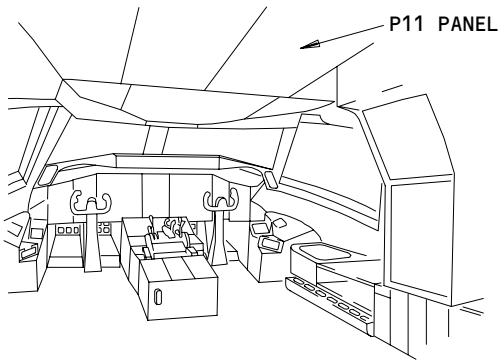

417AL (LEFT ENGINE OUTBOARD)
418AR (LEFT ENGINE INBOARD)
427AL (RIGHT ENGINE INBOARD)
428AR (RIGHT ENGINE OUTBOARD)

THRUST REVERSER
416AR (LEFT ENGINE INBOARD)
426AR (RIGHT ENGINE OUTBOARD)

TURBINE CASE
SEE (A)

COMPRESSOR CASE
SEE (B) (C) SHT 2

FLIGHT COMPARTMENT

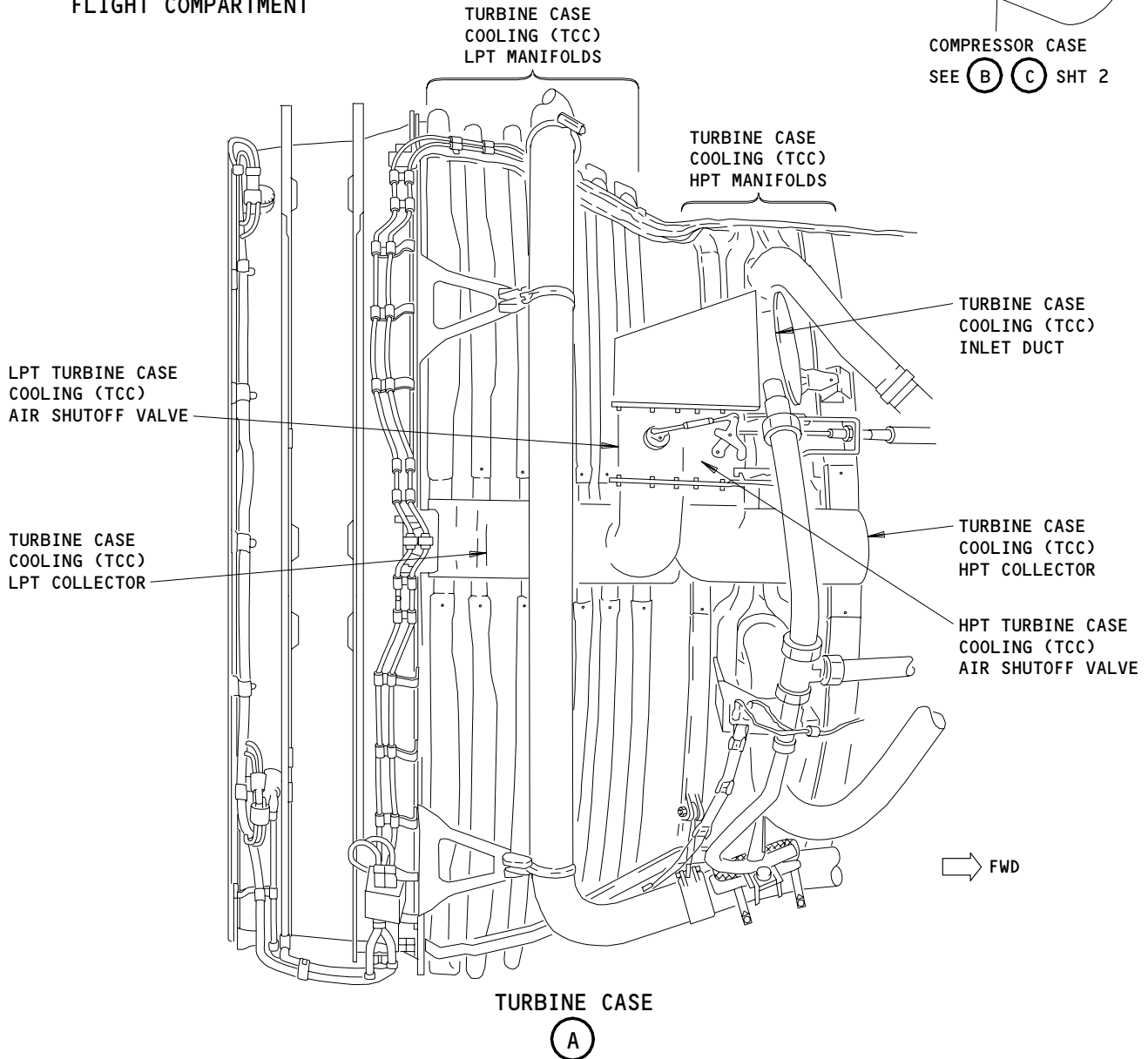

Turbine Cooling System - Component Location
Figure 102 (Sheet 1)

EFFECTIVITY

ALL

75-24-00

N01

Page 102
Aug 10/91

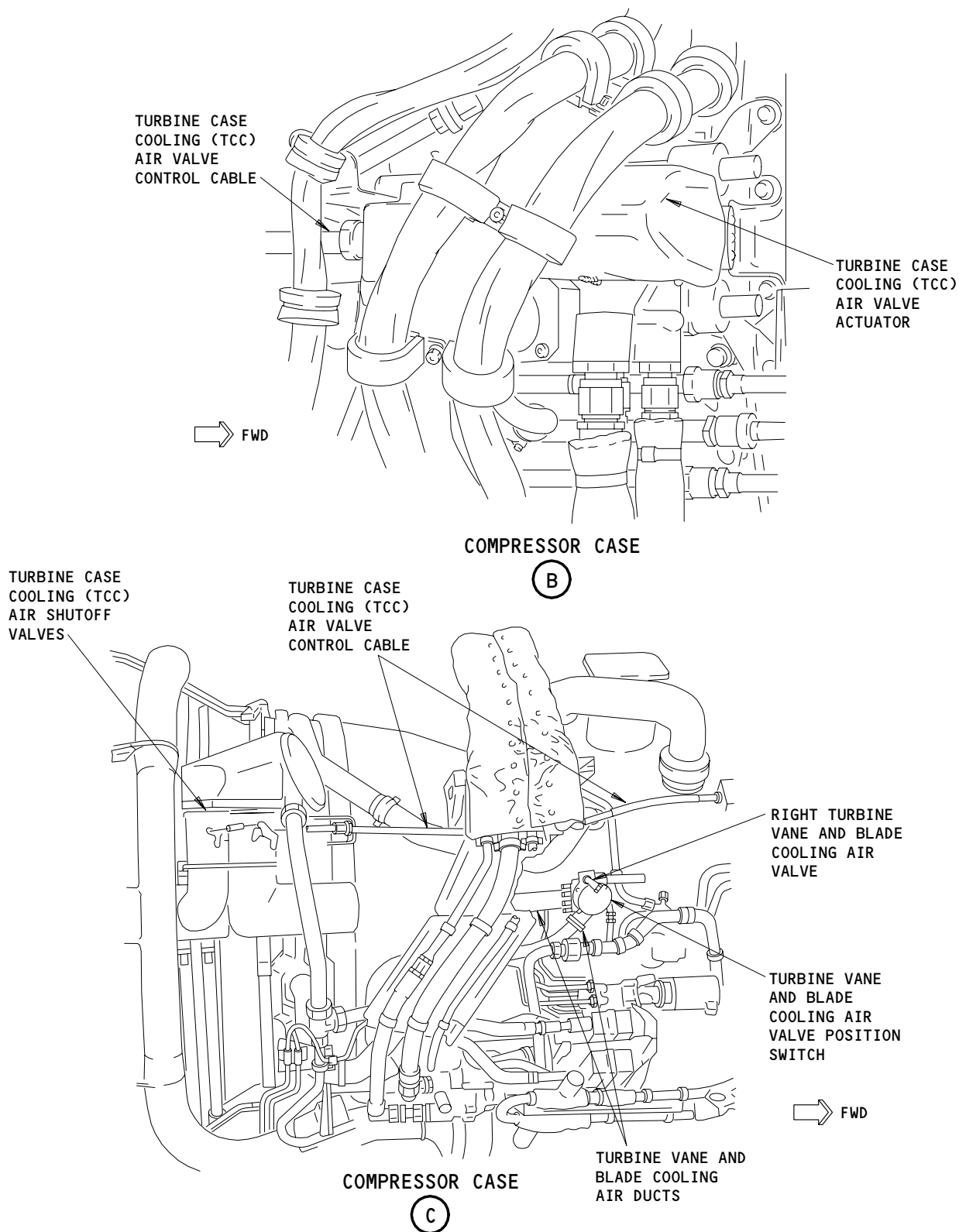

Turbine Cooling System - Component Location (Details from Sht 1)
Figure 102 (Sheet 2)

EFFECTIVITY

ALL

75-24-00

N01

Page 103
Aug 10/91

THRUST REVERSER
415AL (LEFT ENGINE OUTBOARD)
425AL (RIGHT ENGINE INBOARD)

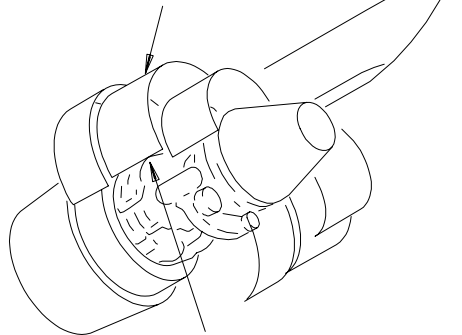

COMPRESSOR CASE
SEE (D)

TURBINE VANE AND
BLADE COOLING AIR
VALVE FILTER

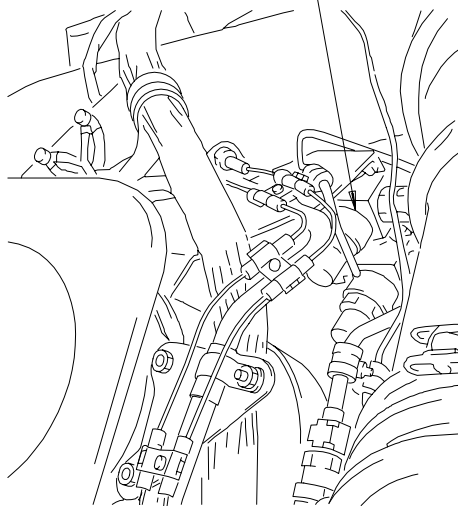

(E)

TURBINE VANE AND
BLADE COOLING AIR
VALVE FILTER
SEE (E)

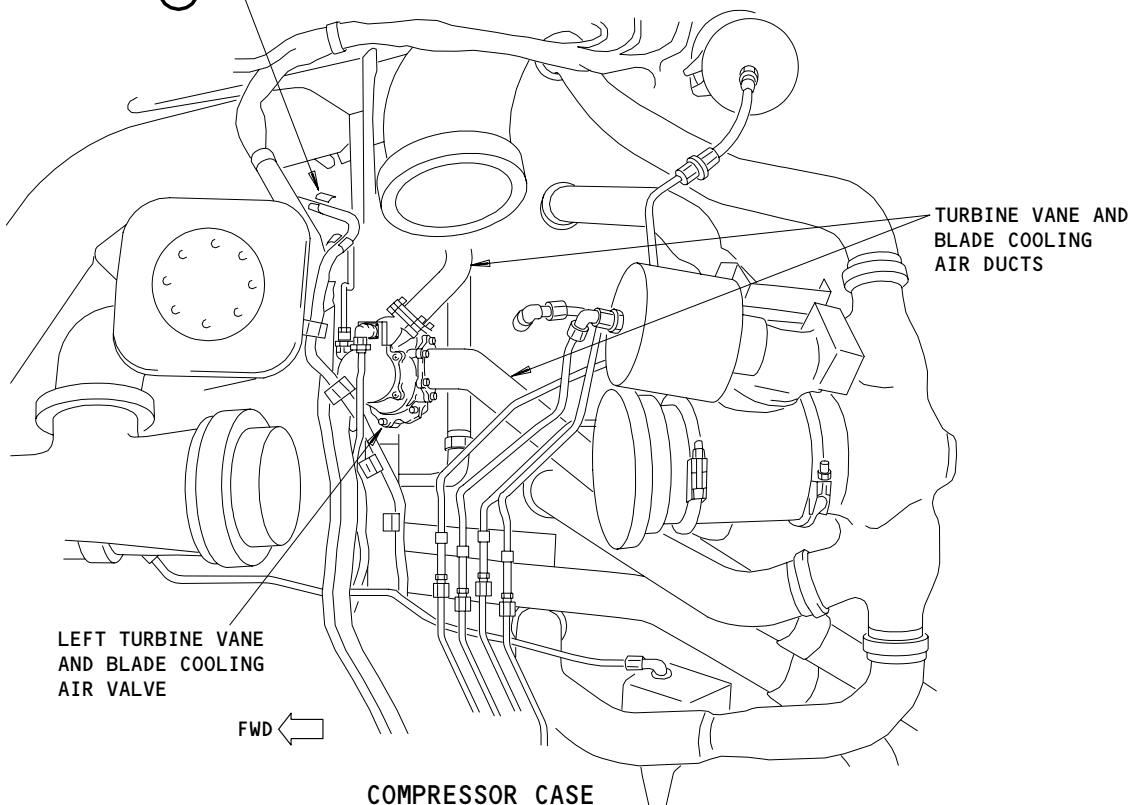

TURBINE VANE AND
BLADE COOLING
AIR DUCTS

LEFT TURBINE VANE
AND BLADE COOLING
AIR VALVE

FWD ←

COMPRESSOR CASE

(D)

Turbine Cooling System - Component Location
Figure 102 (Sheet 3)

EFFECTIVITY

ALL

75-24-00

N01

Page 104
Aug 10/91



COMPRESSOR STATOR VANE CONTROL SYSTEM

COMPONENT	FIG. 102 SHT	QTY	ACCESS/AREA	AMM REFERENCE
ACTUATOR - VARIABLE STATOR VANE	--	2	416AR,426AR, REAR COMPRESSOR CASE	75-31-02
BELLCRANK - VARIABLE STATOR VANE	--	2	416AR,426AR, REAR COMPRESSOR CASE	
CONTROL - (FIM 73-21-00/101)				
ELECTRONIC ENGINE, M7198				
LINK - ADJUSTER	--	8	416AR,426AR, REAR COMPRESSOR CASE	
RING - UNISON	--	8	416AR,426AR, REAR COMPRESSOR CASE	

Compressor Stator Vane Control System - Component Index
Figure 101

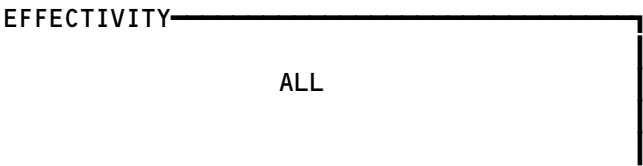

75-31-00

E20598

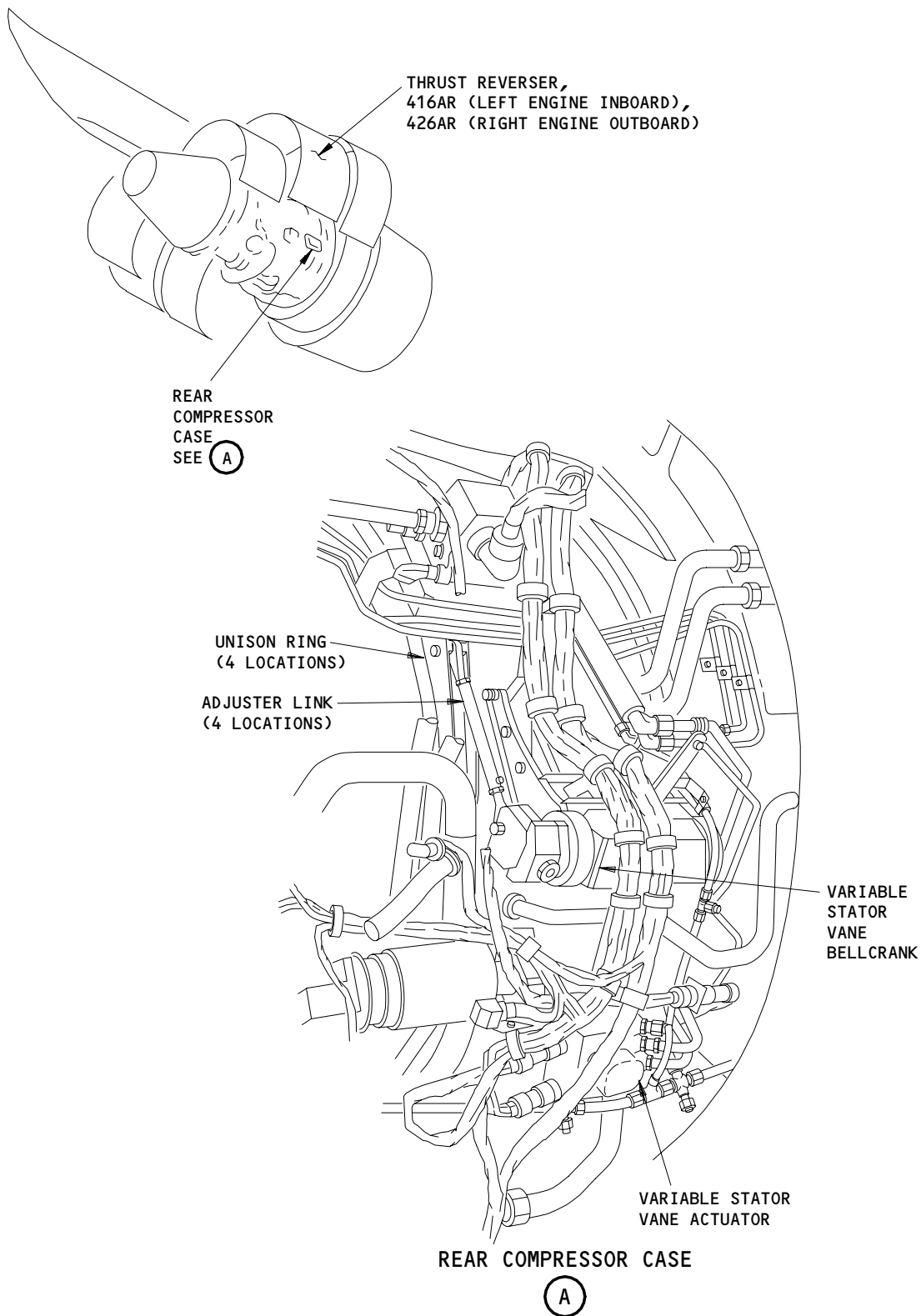

Compressor Stator Vane Control System - Component Location
Figure 102

EFFECTIVITY

ALL

75-31-00

N01

Page 102
May 10/94

COMPRESSOR BLEED CONTROL SYSTEM

COMPONENT	FIG. 102 SHT	QTY	ACCESS/AREA	AMM REFERENCE
ACTUATOR - 2.5 BLEED VALVE, M3105	2	2	415AL,425AL THRUST REVERSER	75-32-01
CONTROL - (FIM 73-21-00/101)				
ELECTRONIC ENGINE, M7198				
SOLENOID - 2.9 BLEED VALVE, V356	2	2	416AR,426AR THRUST REVERSER	75-32-04
VALVE - LEFT (STABILITY) 2.9 BLEED	1	2	415AL,425AL THRUST REVERSER	75-32-03
VALVE - RIGHT (START) 2.9 BLEED	2	2	416AR,426AR THRUST REVERSER	75-32-03
VALVE - STABILITY BLEED PNEUMATIC RELAY	2	2	416AR,426AR THRUST REVERSER	75-32-04

Compressor Bleed Control System - Component Index
 Figure 101

EFFECTIVITY

ALL

75-32-00

N01

 Page 101
 May 10/94

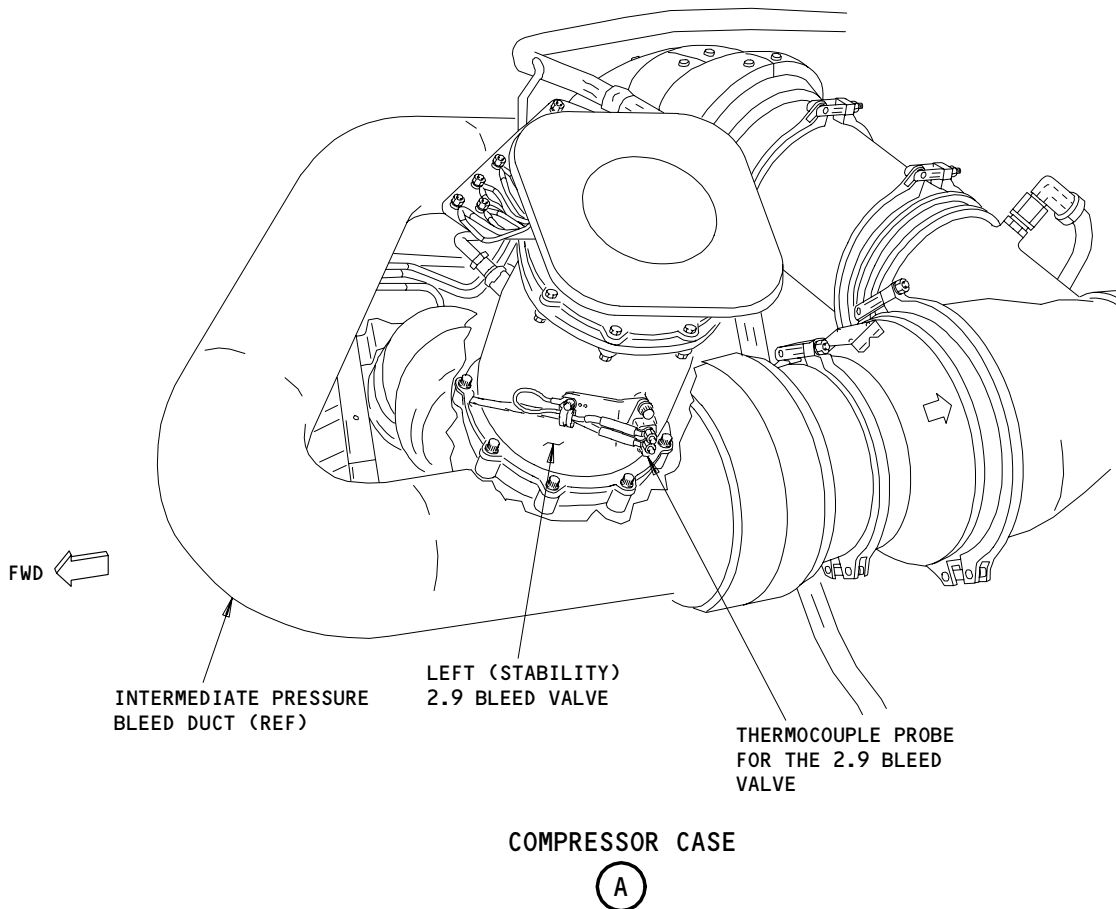
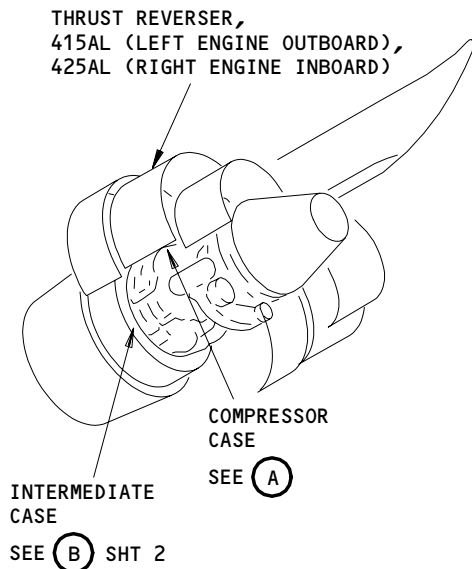

Compressor Bleed Control System - Component Location
Figure 102 (Sheet 1)

EFFECTIVITY	
ALL	

75-32-00

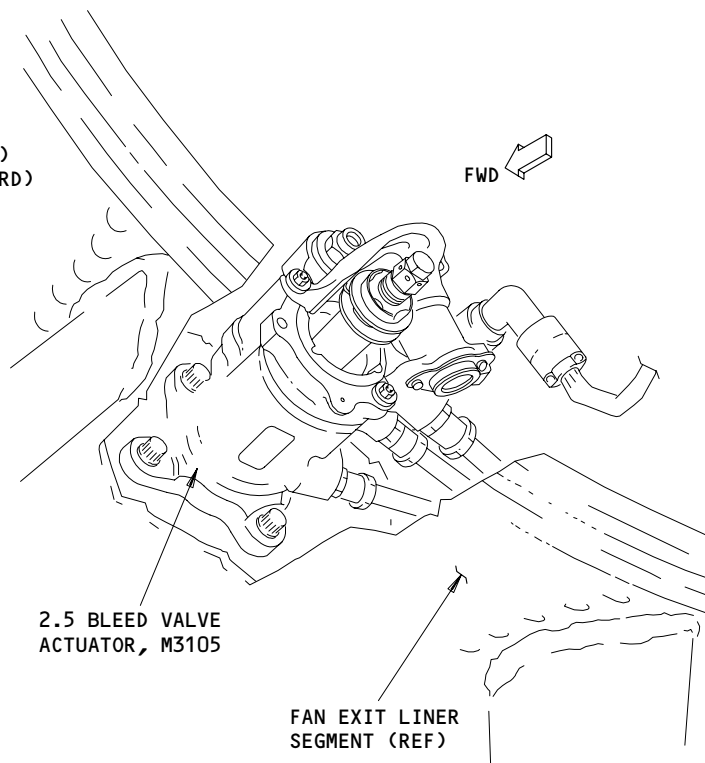
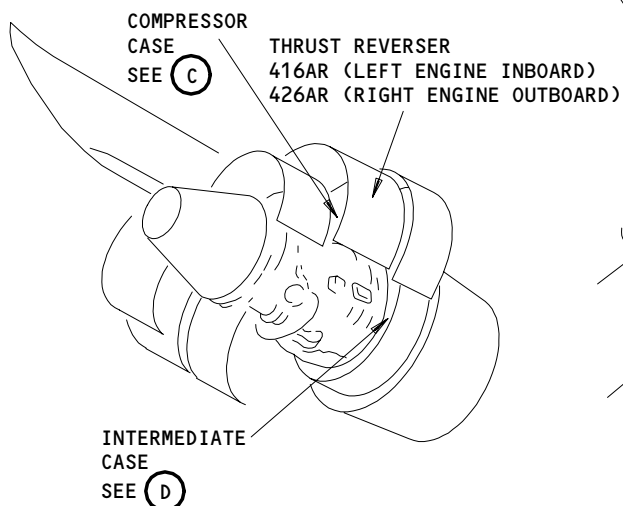

INTERMEDIATE CASE

(B) FROM SHT 1

RIGHT (START)
2.9 BLEED VALVE

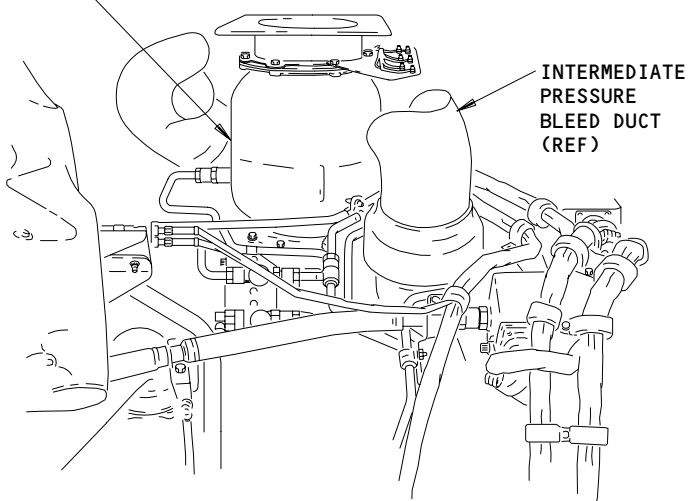

COMPRESSOR CASE

(C)

STABILITY BLEED PNEUMATIC RELAY VALVE

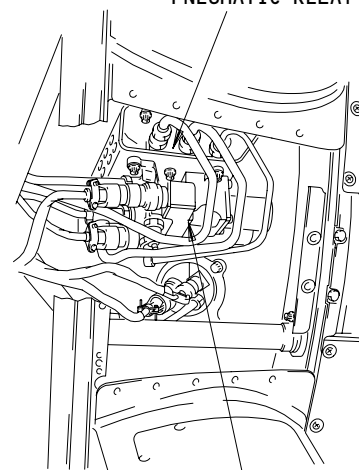

INTERMEDIATE CASE

(D)

Compressor Bleed Control System - Component Location
Figure 102 (Sheet 2)

EFFECTIVITY

ALL

75-32-00

N01

Page 103
May 10/94

HPC SECONDARY FLOW CONTROL SYSTEM

COMPONENT	FIG. 102 SHT	QTY	ACCESS/AREA	AMM REFERENCE
CONTROL - (FIM 73-21-00/101) ELECTRONIC ENGINE, M7198				
FILTER - HPC SECONDARY FLOW CONTROL VALVE	2	2	415AL,425AL THRUST REVERSER	75-33-02
FILTER - HPC SECONDARY FLOW CONTROL VALVE	3	4	416AR,426AR THRUST REVERSER	75-33-02
SOLENOID - HPC SECONDARY FLOW CONTROL VALVE, IDG AIR/OIL HEAT EXCHANGER VALVE OVERRIDE	4	2	416AR,426AR THRUST REVERSER	75-33-04
SOLENOID - HPC SECONDARY FLOW CONTROL VALVE, TURBINE BLADE AND VANE COOLING AIR VALVE	1	2	415AL,425AL THRUST REVERSER	75-33-03
VALVE - HPC SECONDARY FLOW CONTROL	2	2	415AL,425AL THRUST REVERSER	75-33-01
VALVE - HPC SECONDARY FLOW CONTROL	4	2	416AR,426AR THRUST REVERSER	75-33-01

 HPC Secondary Flow Control System - Component Index
 Figure 101

EFFECTIVITY

ALL

75-33-00

N01

 Page 101
 May 10/94

THRUST REVERSER,
415AL (LEFT ENGINE OUTBOARD),
425AL (RIGHT ENGINE INBOARD)

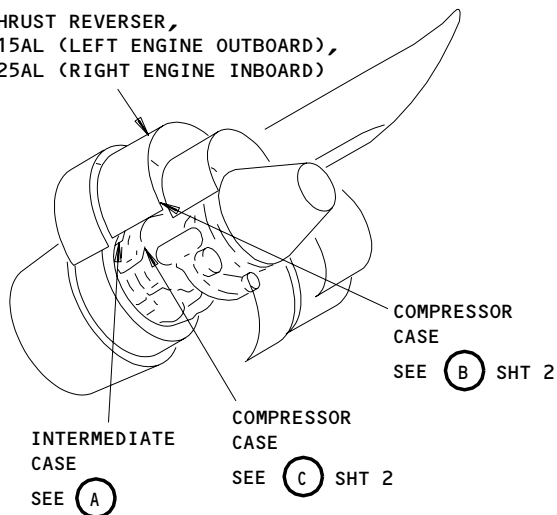

HPC SECONDARY FLOW
CONTROL VALVE, TURBINE
VANE AND BLADE COOLING
AIR VALVE SOLENOID

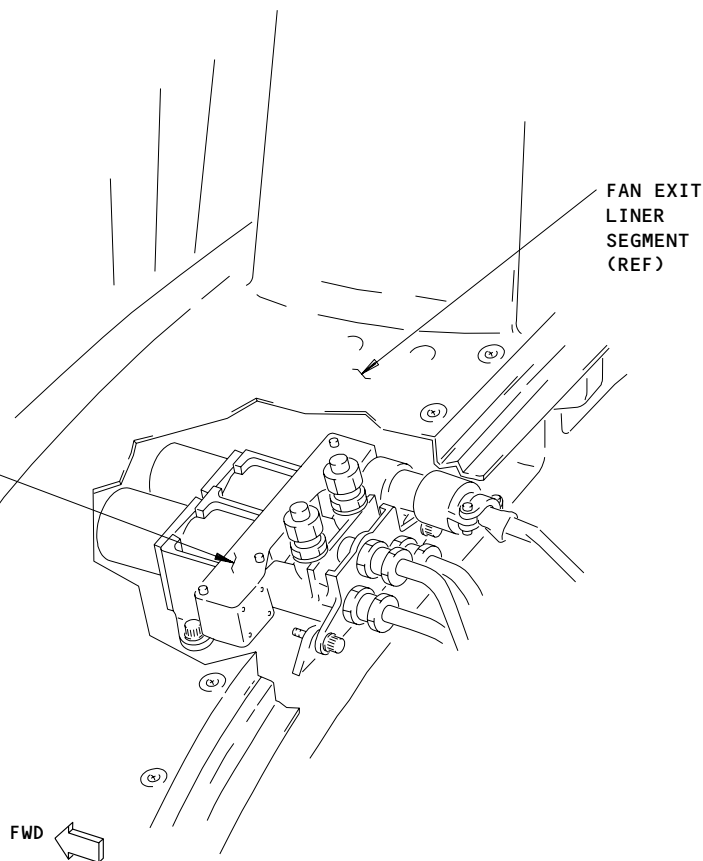

INTERMEDIATE CASE

(A)

HPC Secondary Flow Control System - Component Location
Figure 102 (Sheet 1)

EFFECTIVITY

ALL

75-33-00

N01

Page 102
May 10/94

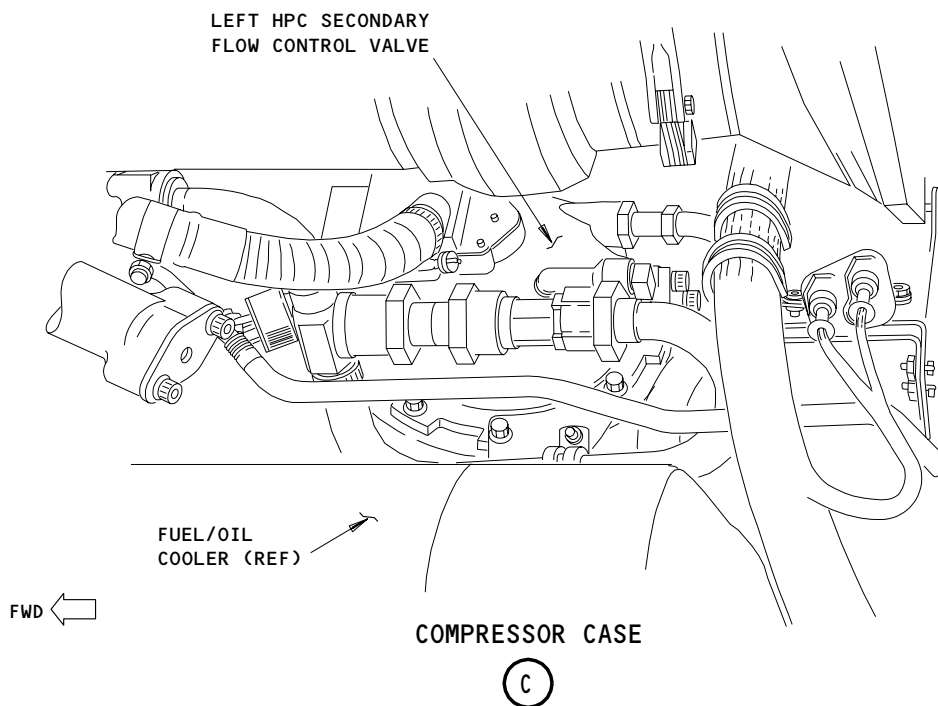
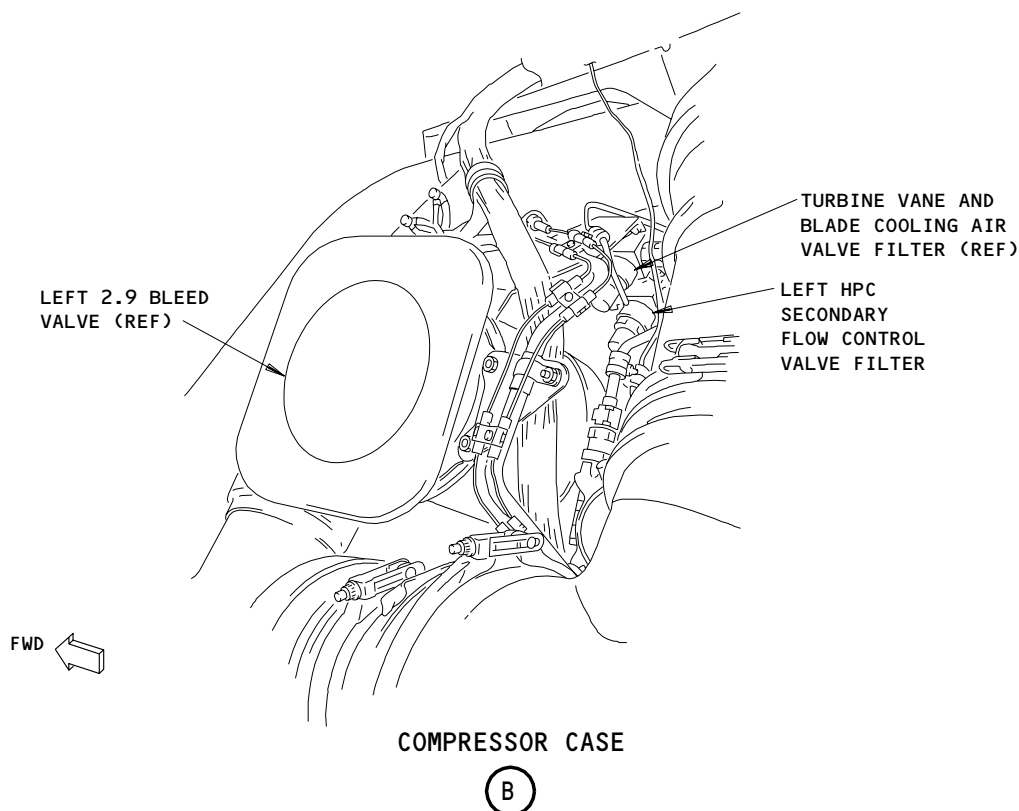

HPC Secondary Flow Control System - Component Location (Details from Sht 1)
Figure 102 (Sheet 2)

EFFECTIVITY

ALL

75-33-00

N01

Page 103
May 10/94

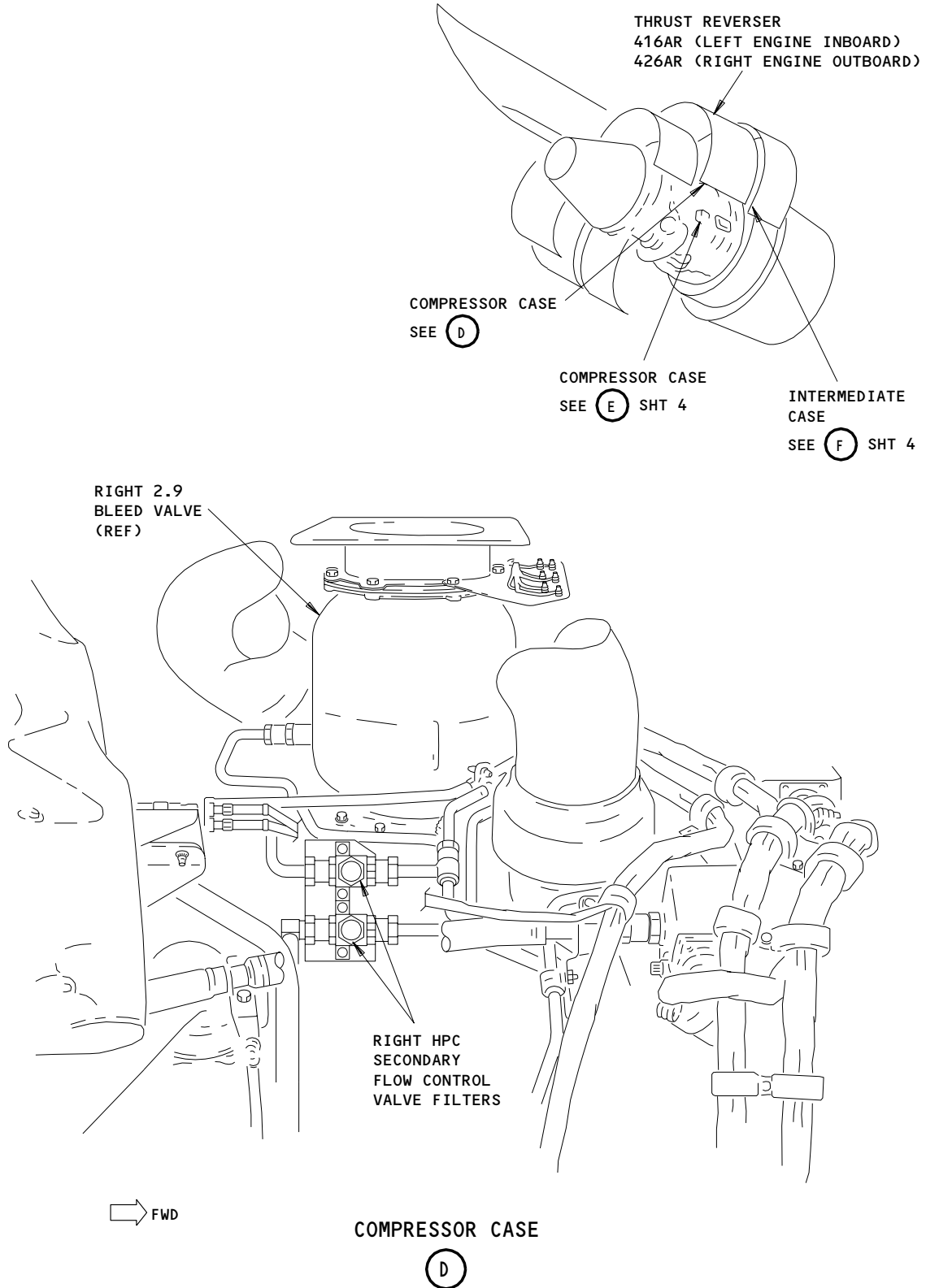

HPC Secondary Flow Control System - Component Location
Figure 102 (Sheet 3)

EFFECTIVITY

ALL

75-33-00

N01

Page 104
May 10/94

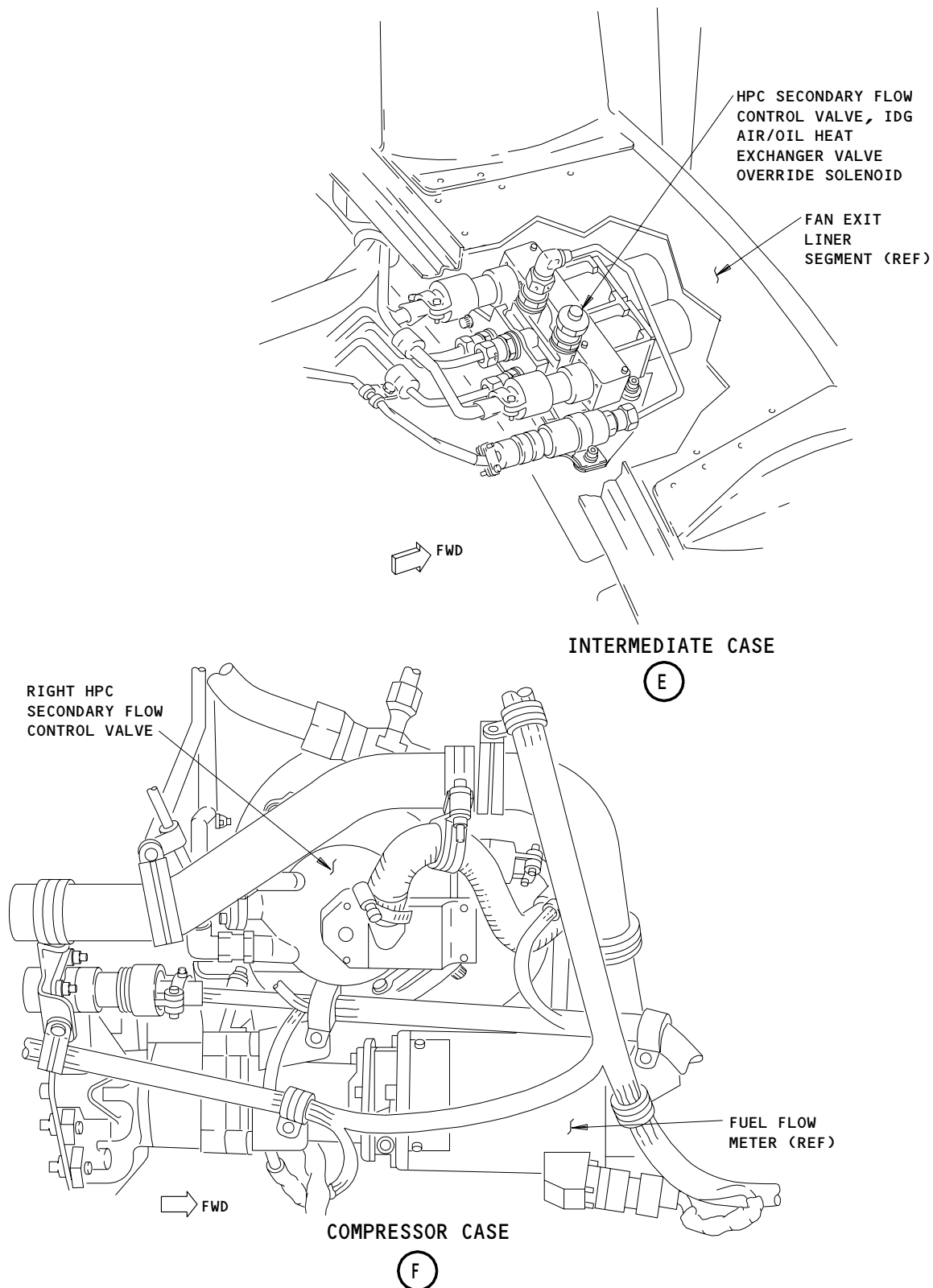

HPC Secondary Flow Control System - Component Location (Details from Sht 3)
Figure 102 (Sheet 4)

EFFECTIVITY

ALL

75-33-00

N01

Page 105
May 10/94