



## Towing Package Retrofit, Model X

<b>Classification</b>	Parts and Accessories Bulletin	<b>Section/Group</b>	90 - Accessories	<b>Country/Region</b>	North America, Asia-Pacific
<b>Year</b>	All	<b>Model</b>	Model X	<b>Version</b>	All

**Bulletin Classification:** *This bulletin provides instructions and guidelines for a vehicle procedure that is not the result of a defect. This bulletin might not be VIN-specific. These instructions assume knowledge of motor vehicle and high voltage electrical component repairs, and should only be executed by trained professionals. Tesla assumes no liability for injury or property damage due to a failure to properly follow these instructions or repairs attempted by unqualified individuals*

*This Service Bulletin supersedes SB-16-90-003 R3, dated 13-Jul-18. Each content change is marked by a vertical line in the left margin. Discard the previous version and replace it with this one.*

Some customers have a due bill for an Accessories Hitch. The Accessories Hitch has been discontinued. In place of the Accessories Hitch, these customers are to receive the Hitch Package, which can be used to attach hitch accessories. These customers also have the option to upgrade to the Full Tow Package at a special price.

Additionally, the Full Tow Package is available as a retrofit for customers who did not originally order a tow package or Accessories Hitch with their vehicle.

Use the following job lines when creating the Repair Order:

### Job Line 1:

#### Symptom:

If the customer has a due bill: "Due Bill - Model X Tow Package Installation"

If the customer does not have a due bill: "Perform Model X Tow Package Installation"

Correction Code: 7100001, no labor performed

Reference any part numbers specified in the concern details on the due bill. If there is no due bill, or if no part numbers are specified on the due bill, use one of the following:

Part: 1111273-00-A Tow Package Upgrade (if vehicle had standard bumper assembly)

Part: 1111274-00-A Tow Package Upgrade (if vehicle had trailer hitch or if customer requested upgrade to Full Tow Package)

Pay Type: Rectification (if customer has a due bill and wishes to receive Hitch Package)

Customer Pay (if customer does not have a due bill, or if customer has a due bill and wishes to upgrade to Full Tow Package)

### Job Line 2:

Symptom: Additional Items for Model X Tow Hitch Installation

Correction Code: <code selected from the table below>

Part: Refer to the Required Parts table

Pay Type: Customer Pre-Paid

Correction Description	Correction	Time
SB-16-90-003 Not Applicable	S011690003	0.00
Update Vehicle Configuration To Allow Towing, Provide Towing Accessories	S021690003	0.05
Install Trailer Hitch, Update Vehicle Configuration To Allow Towing, Provide Towing Accessories	S031690003	0.55

Required Part(s):	Description	Quantity
<b>North America</b>		
1027581-00-F	TRAILER HITCH - NA	1
1027582-00-A	TRAILER HITCH ADAPTER – NA	1
1027587-00-A	TRAILER HITCH ADAPTER STORAGE BAG	1
1047337-00-A	NUT HF M10 PC10	8
1079620-00-B	WASHER,FL,M10x25x0.8,AL	8
1072586-00-A	ASY,HARN,TRAILER BRAKE ECU ADAPTER	1
<b>Australia</b>		
1027583-00-F	TRAILER HITCH - EU	1
1027584-00-A	TRAILER HITCH BALL NECK	1
1027588-00-A	TRAILER HITCH BALL NECK STORAGE BAG	1
1047337-00-A	NUT HF M10 PC10	8
1079620-00-B	WASHER,FL,M10x25x0.8,AL	8
1072586-00-A	ASY,HARN,TRAILER BRAKE ECU ADAPTER	1
1046032-02-A	ASY,CBL,MX,TRAILER,LIGHT,ADAPT,EU-AUS	1
<b>Asia-Pacific</b>		
1027583-00-F	TRAILER HITCH - EU	1
1027584-00-A	TRAILER HITCH BALL NECK	1
1027588-00-A	TRAILER HITCH BALL NECK STORAGE BAG	1
1047337-00-A	NUT HF M10 PC10	8
1079620-00-B	WASHER,FL,M10x25x0.8,AL	8
1072586-00-A	ASY,HARN,TRAILER BRAKE ECU ADAPTER	1
<b>If Necessary:</b>		
1058356-00-C	MX RR DIFFUSER, WITH AND WITHOUT TOW HITCH	1
1058357-00-D	COVER, WITH AND WITHOUT TOW HITCH, MX	1

These part numbers were current at the time of publication. Use the revisions listed or later, unless otherwise specified in the Parts Manual.

# Inspection

1. Remove the tow hitch access cover from the rear diffuser (Figure 1).

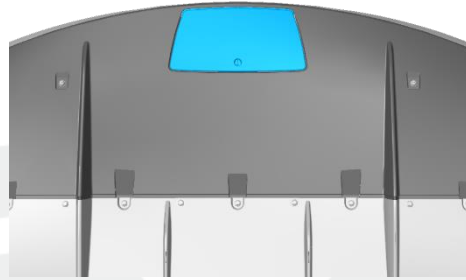
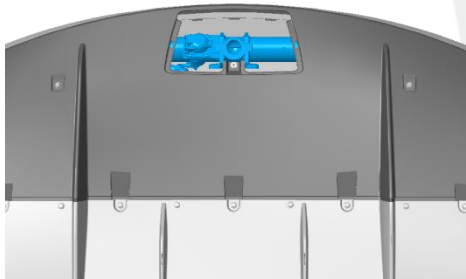

**Figure 1**

2. Examine the vehicle to determine if there is a trailer hitch or a standard bumper assembly.

**NOTE:** The part that is currently installed determines the part number for Job Line 1 or concern notes.

- If there is a trailer hitch (Figure 2), skip to the “Configure and Deliver” section of this document.
- If there is a standard bumper assembly (Figure 3), continue to the “Install Trailer Hitch” section of this document.



**Figure 2 (Trailer hitch)**

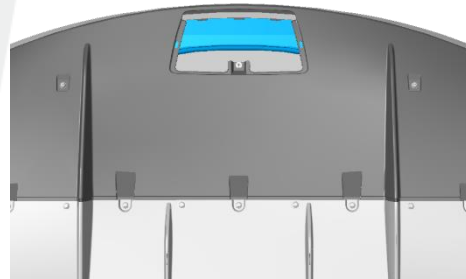

**Figure 3 (Standard bumper assembly)**

## Install Trailer Hitch

1. Remove the rear bumper assembly (refer to Service Manual procedure 10013102).
2. Determine if the rear diffuser should be replaced (Figure 4 and Figure 5):
  - If the diffuser is part number 1058356-00-A: Discard the diffuser and access cover, and then do the following:
    - a. Replace the rear diffuser panel with part number 1058356-00-C (refer to Service Manual procedure 12030802)
    - b. Replace the tow hitch access cover with part number 1058357-00-D.
  - If the diffuser panel is part number 1058356-00-B or later: Continue this procedure.

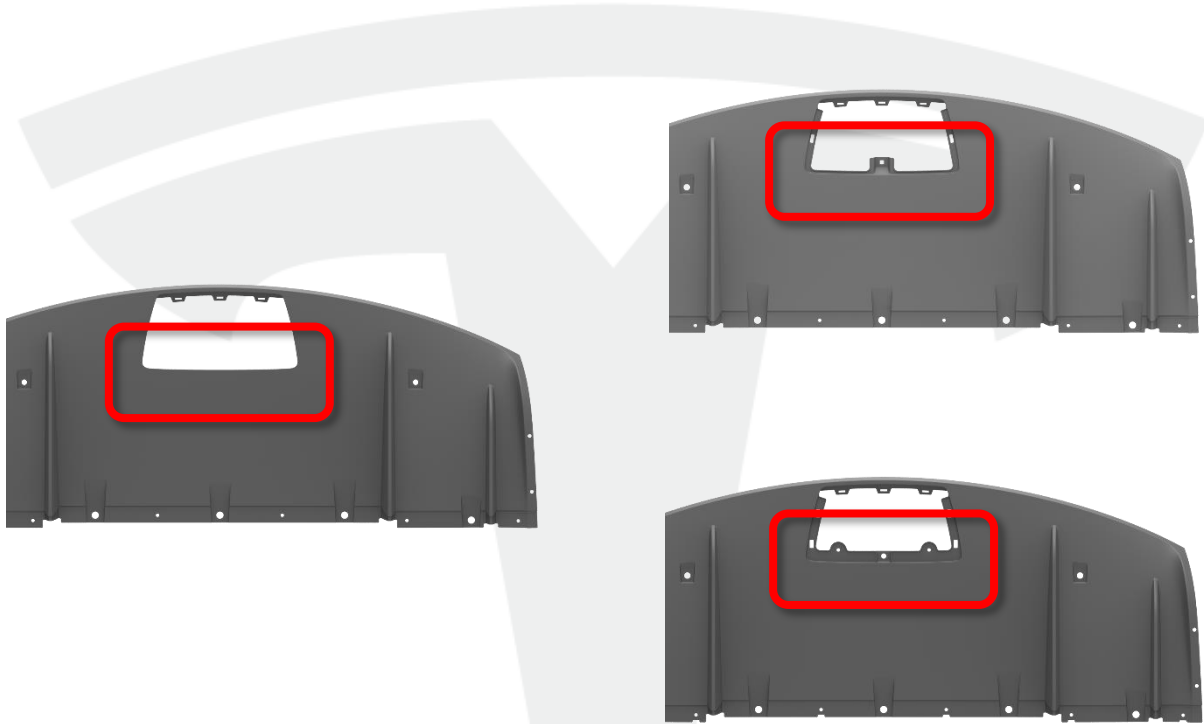

**Figure 4 (Diffuser revision A)**

**Figure 5 (Diffuser revisions B and C)**

**NOTE:** Before performing the next step, make sure that there are aluminum washers on the rear bumper/trailer hitch mounting studs. If no washers are present, install an aluminum washer over each stud before installing the trailer hitch.

3. Install the new trailer hitch (refer to Service Manual procedure 12300202).
4. Reinstall the rear fascia.

**NOTE:** Use new bolts and steel washers to secure the forward edge of the diffuser to the mid aero shield.
5. Reinstall the tow hitch access cover.
6. Continue to the “Configure and Deliver” section of this document.

## Configure and Deliver

1. Check the customer concern:
  - If the customer has a due bill for an Accessories Hitch, no further work is required. Discontinue this procedure.
  - If the customer requests the Full Tow Package, continue this procedure.
2. Connect a laptop with Toolbox to the vehicle.
3. Use Toolbox to update the “Tow Package” configuration variable to **Tesla Rev 1**.
4. Ensure the following items are delivered to the customer:
  - Brake ECU adapter harness
  - Trailer hitch adapter storage bag or trailer hitch ball neck storage bagEnsure the following items are in the storage bag:
  - Trailer hitch adapter
  - Trailer hitch adapter keys

For feedback on the accuracy of this document, email [ServiceBulletinFeedback@tesla.com](mailto:ServiceBulletinFeedback@tesla.com).