

(No Model.)

F. B. BESSETTE.
CONVERTIBLE TOY.

No. 419,405.

Patented Jan. 14, 1890.

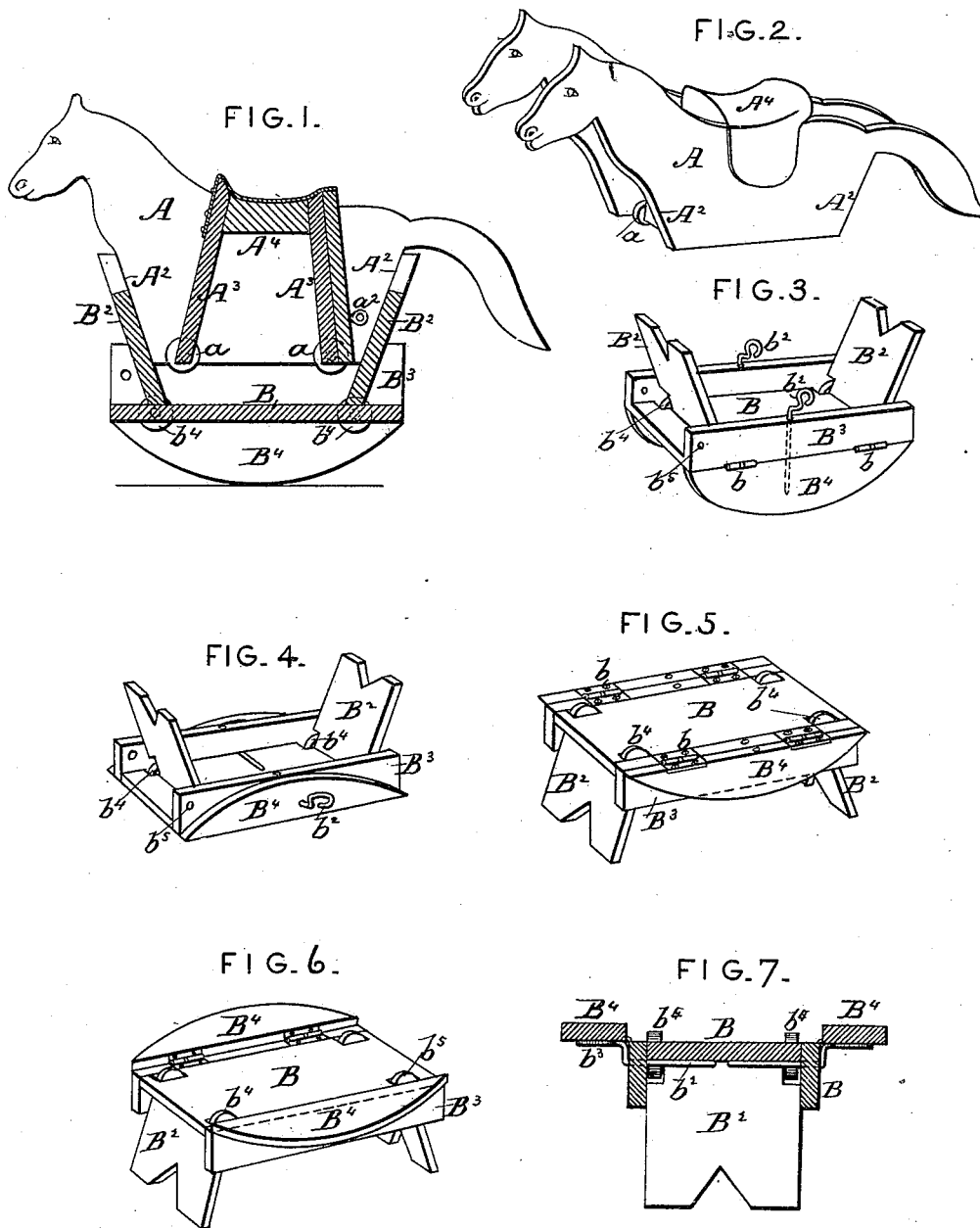

ATTEST-

Harry L. Amer.
J. J. Masson

INVENTOR-

Frank B. Bessette
by E. E. Masson
atty.

UNITED STATES PATENT OFFICE.

FRANK. B. BESSETTE, OF ST. CLOUD, MINNESOTA, ASSIGNOR, BY DIRECT AND MESNE ASSIGNMENTS, TO JOSEPH P. WILSON AND ADDIE BESSETTE, BOTH OF SAME PLACE.

CONVERTIBLE TOY.

SPECIFICATION forming part of Letters Patent No. 419,405, dated January 14, 1890.

Application filed March 23, 1889. Serial No. 304,443. (No model.)

To all whom it may concern:

Be it known that I, FRANK. B. BESSETTE, a citizen of the United States of America, residing at St. Cloud, in the county of Stearns and State of Minnesota, have invented certain new and useful Improvements in Convertible Toys, of which the following is a specification, reference being had therein to the accompanying drawings.

My invention relates to toys which can be converted so as to be capable of many uses; and the objects of my improvement are to provide a durable and inexpensive toy movable on wheels and on rockers, and also capable of assuming great stability when resting upon its legs. I attain these objects by the construction shown in the accompanying drawings, in which—

Figure 1 is a longitudinal vertical section of a wooden horse and its rocking support constituting a rocking-horse in accordance with my invention. Fig. 2 is a perspective view of the wooden horse resting upon its wheels and adapted to be used as a traveling horse. Fig. 3 is a perspective view of the horse-support adapted to be used as a cradle. Fig. 4 is a perspective view of the horse-support resting upon its wheels and adapted to be used as a wagon. Fig. 5 is a perspective view of the horse-support or wagon shown in Fig. 4 turned upside down and adapted to be used as a stool. Fig. 6 is a perspective view of the horse support or stool shown in Fig. 5 with the rockers of said support turned up and retained horizontally and adapted to be used as a table. Fig. 7 is a vertical transverse section of said table, showing the wire supports for the hinged leaves.

It is well known that nearly all children will soon become tired of a toy after the novelty has worn off when said toy has to be used constantly in the same manner, even if the toys are very ingenious and provided with complex mechanism to give them motion. They generally desire to take them apart, so as to exert their ingenuity in reconstructing them again. Very often they cannot reconstruct them, as some of the parts may have

become lost or broken when taken to pieces, and then the toy loses its attraction.

In this invention only two important parts are used to produce six or seven distinct toys that can be appreciated by either boys or girls, as will be hereinafter described.

In the drawings, A represents a hobby-horse consisting of two boards forming its sides cut on the outline of the body of a horse without any legs, but having the front or breast and the rear cut on the same bevel A². The two sides are united together by the transverse boards A³, which support the top board A⁴, forming with a suitable cover the saddle of the horse. Said horse is provided with four wheels *a*, having their axles inserted in the bottom of the connecting-boards A³, and of the sides A close to their lower edge. A staple or screw-eye *a*² is also inserted in the rear connecting-board A³, to which a cord can be secured to harness the horse to a wagon, as hereinafter described, while the horse is led or drawn with a cord.

The support for the horse when used as a rocking-horse consists of a bottom board B, and front and rear boards B² inclined to said bottom board at the same angle that is given to the breast and rear A² of the horse. To strengthen the connection between the boards B and B², and to prevent the horse from sliding laterally when used upon its support, the narrow boards B³ are secured to the edges of the boards B B². To permit the horse and its support, or the support alone, to be rocked, segmental rockers B⁴ are hinged at *b* to the bottom edge of the side boards B³, and are retained in the same plane as the boards B³ by means of pins *b*² inserted in the edge of these boards and of the rockers. Said horse-support can also be used as a toy cradle.

To transform the horse-support into a wagon the segmental rockers are folded against the side of the side boards B³, as shown in Fig. 4, and as the bottom board B has four wheels *b*⁴ projecting through its surface it can be pulled as a wagon by fastening a cord thereto through the perforations *b*⁵. Said wagon can be attached to the rear of the

traveling horse, or the horse can be made to stand in it to add to its height and the latter still be used as a traveling horse. When the rockers are folded, as shown in Fig. 4, they
5 are retained in that position by inserting the pins b^2 horizontally through them and through the side boards B^3 . If the wagon is reversed upside down, a stool will be obtained, as shown in Fig. 5, and by turning the rockers B^4 hori-
10 zontally a table is obtained having segmental leaves. Said leaves are retained horizontally by means of the pins b^2 , the free ends of which are turned up and bent in the form of a loop b^3 , that bears against the under side of said
15 leaves.

Having now fully described my invention, I claim—

1. A toy consisting of a hobby-horse having its front and rear end beveled, and a remov-
20 able support having front and rear horse-supporting boards set at an angle corresponding

with the level of the body of the horse, substantially as described.

2. A toy consisting of a hobby-horse and a removable support having segmental rockers 25 hinged thereto, substantially as and for the purpose described.

3. A toy consisting of a hobby-horse and a removable support having carrying-wheels and segmental rockers hinged to said sup- 30 port, substantially as described.

4. The combination of a hobby-horse, a removable support having segmental rockers hinged thereto, and pins to retain said rockers, substantially as and for the purpose de- 35 scribed.

In testimony whereof I affix my signature in presence of two witnesses.

FRANK. B. BESSETTE.

Witnesses:

ANDREW C. ROBERTSON,
W. H. VOSSBERG.