

(12) **United States Design Patent** (10) **Patent No.:** **US D1,077,080 S**
Qiu (45) **Date of Patent:** **** May 27, 2025**

(54) **TOY GUN**

(71) Applicant: **Hongying Qiu**, Foshan (CN)

(72) Inventor: **Hongying Qiu**, Foshan (CN)

(**) Term: **15 Years**

(21) Appl. No.: **29/967,246**

(22) Filed: **Oct. 9, 2024**

(51) **LOC (15) Cl.** **21-01**

(52) **U.S. Cl.**

USPC **D21/573; D21/570; D21/567; D21/574**

(58) **Field of Classification Search**

USPC **D21/573, 560, 557, 550, 572, 574, 567,**
D21/570; D22/100, 103

(Continued)

(56) **References Cited**

U.S. PATENT DOCUMENTS

D610,218 S * 2/2010 Barrett D22/103
D641,825 S * 7/2011 Gridelet D22/103

(Continued)

FOREIGN PATENT DOCUMENTS

CN 306739320 * 8/2021
CN 307143253 * 3/2022
CN 307350420 * 5/2022

OTHER PUBLICATIONS

Amazon Website, Kyliandi Toy Gun, Earliest Comment Date: Nov.
27, 2023 [Website Visited Jan. 7, 2025] Available on the internet
URL <https://www.amazon.com/dp/B0CHY8KZFY?th=1> (Year: 2023).*

(Continued)

Primary Examiner — S. Bryan Reinholdt, Jr.

Assistant Examiner — James T Tyree

(74) *Attorney, Agent, or Firm* — Ying-Ting Chen; Law
Office of Michael Chen

(57) **CLAIM**

The ornamental design for a toy gun, as shown and
described.

DESCRIPTION

FIG. 1 is a perspective view of a toy gun showing my new
design;

FIG. 2 is a perspective view thereof from another angle;

FIG. 3 is a left side elevational view thereof;

FIG. 4 is a right side elevational view thereof;

FIG. 5 is a rear elevational view thereof;

FIG. 6 is a front elevational view thereof;

FIG. 7 is a top plan view thereof;

FIG. 8 is a bottom plan view thereof;

FIG. 9 is a partial enlarged view of portion 9 in FIG. 1;

FIG. 10 is a partial enlarged view of portion 10 in FIG. 1;

FIG. 11 is a partial enlarged view of portion 11 in FIG. 1;

FIG. 12 is a partial enlarged view of portion 12 in FIG. 1;

FIG. 13 is a partial enlarged view of portion 13 in FIG. 2;

FIG. 14 is a partial enlarged view of portion 14 in FIG. 2;

FIG. 15 is a partial enlarged view of portion 15 in FIG. 2;

FIG. 16 is a partial enlarged view of portion 16 in FIGS. 2;

and,

FIG. 17 is a partial enlarged view of portion 17 in FIG. 8.

The evenly spaced broken lines shown in the drawings
depict portions of the toy gun that form no part of the
claimed design. The dot-dash-dot broken lines in FIGS. 1, 2,
8, 9, 10, 11, 12, 13, 14, 15, 16, and 17 depict boundaries of
the detailed enlargement that form no part of the claimed
design.

1 Claim, 17 Drawing Sheets

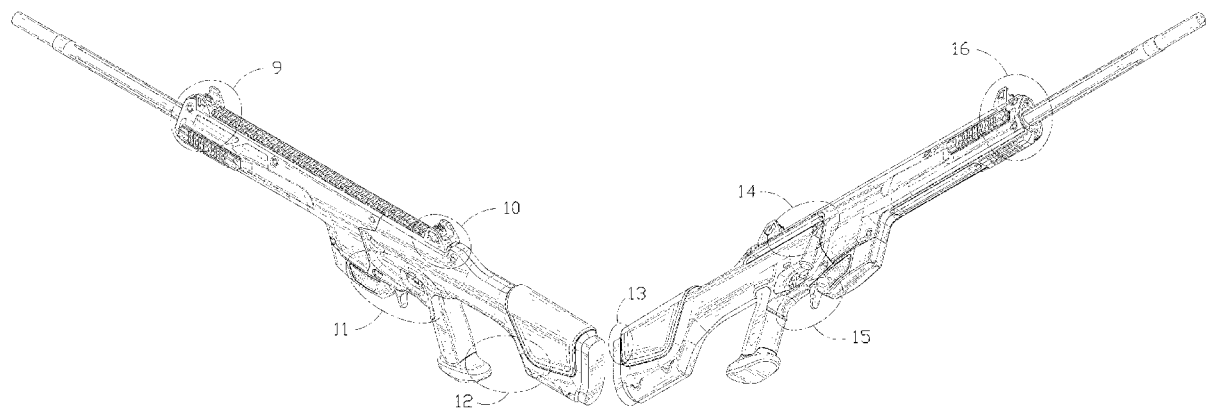

(58) **Field of Classification Search**

CPC A63H 5/04; F41B 7/003; F41C 3/06

See application file for complete search history.

(56) **References Cited**

U.S. PATENT DOCUMENTS

D739,478	S	*	9/2015	Yang	D21/570
D739,479	S	*	9/2015	Yang	D21/570
D785,122	S	*	4/2017	Mather	D22/104
D827,753	S	*	9/2018	Lessard	D22/103
D916,224	S	*	4/2021	Laney	D21/573
D926,911	S	*	8/2021	McLeroy	D22/103
D1,006,131	S		11/2023	Cai		
D1,019,814	S	*	3/2024	Lin	D21/573
D1,024,252	S	*	4/2024	Baumbach	D22/103
D1,029,133	S	*	5/2024	Lin	D21/573
D1,035,793	S	*	7/2024	Lin	D21/570
2016/0116250	A1	*	4/2016	Mather	F41A 3/66

42/73

OTHER PUBLICATIONS

Amazon Website, Kyliandi Toy Gun, Earliest Comment Date: Feb. 14, 2024 [Website Visited Jan. 7, 2025] Available on the internet URL <https://www.amazon.com/dp/B0CNT2FPQS?th=1> (Year: 2024).*

Amazon Website, Kyliandi Toy Gun, Earliest Comment Date: Mar. 3, 2024 [Website Visited Jan. 7, 2025] Available on the internet URL <https://www.amazon.com/dp/B0CRKK9ZTD/> (Year: 2024).*

* cited by examiner

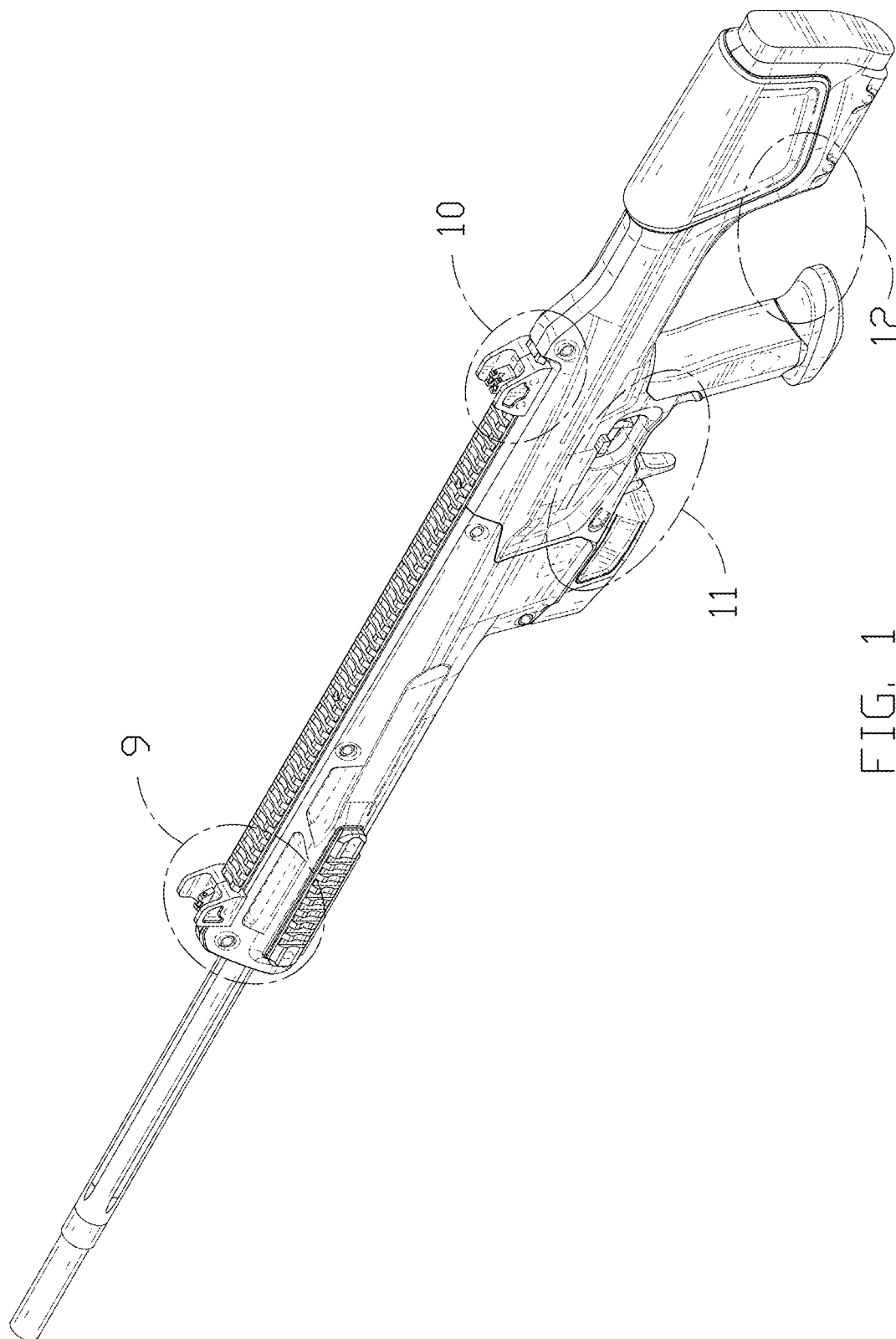

FIG. 1

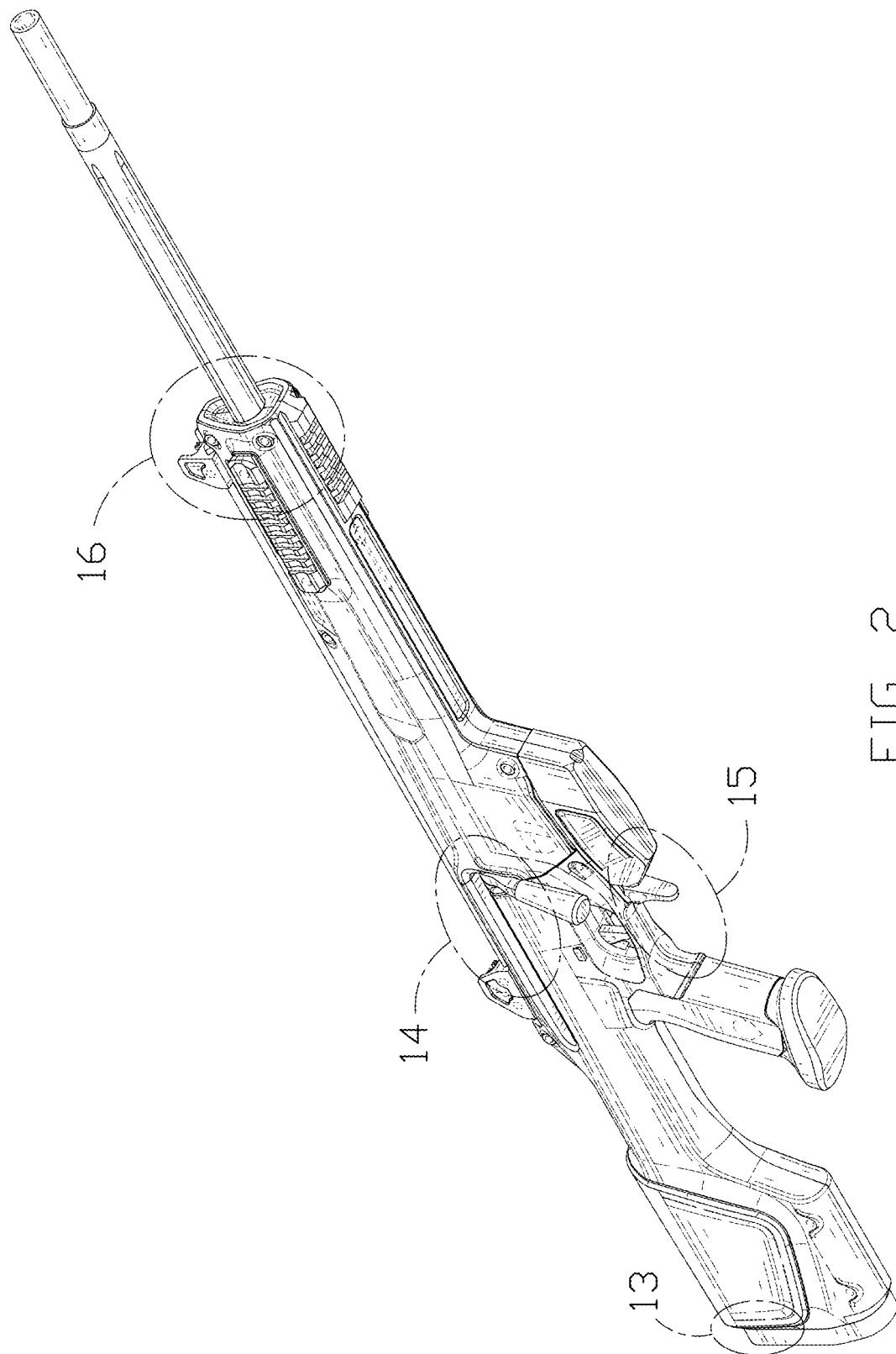

FIG. 2

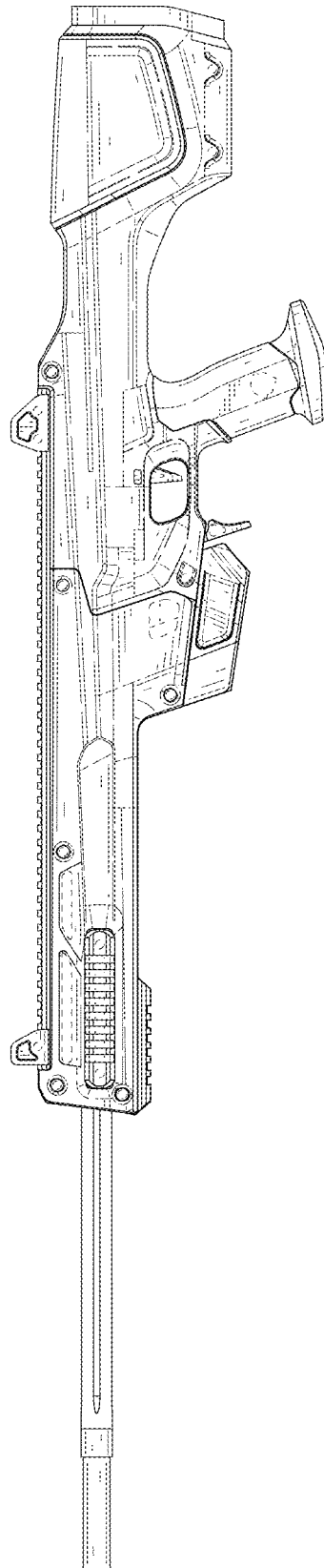

FIG. 3

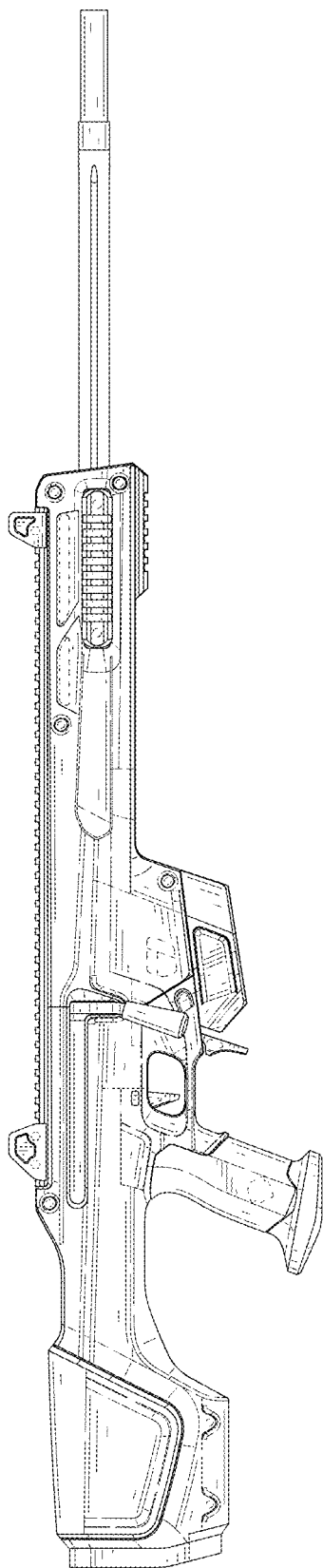

FIG. 4

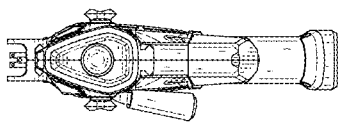

FIG. 5

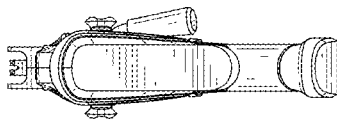

FIG. 6

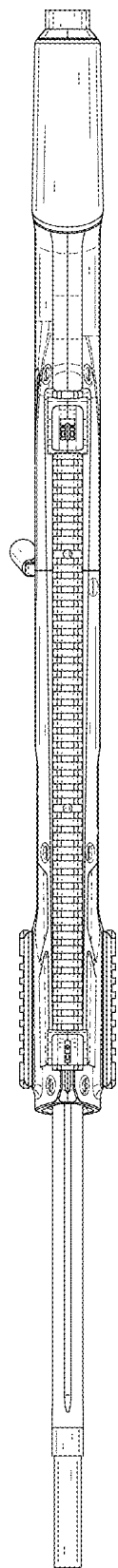

FIG. 7

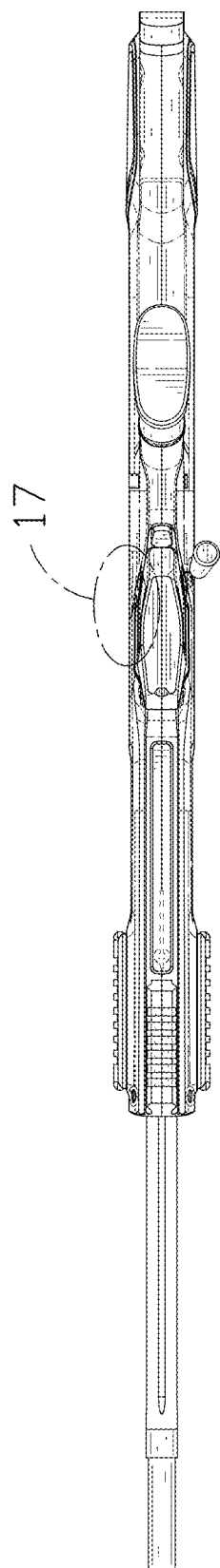

FIG. 8

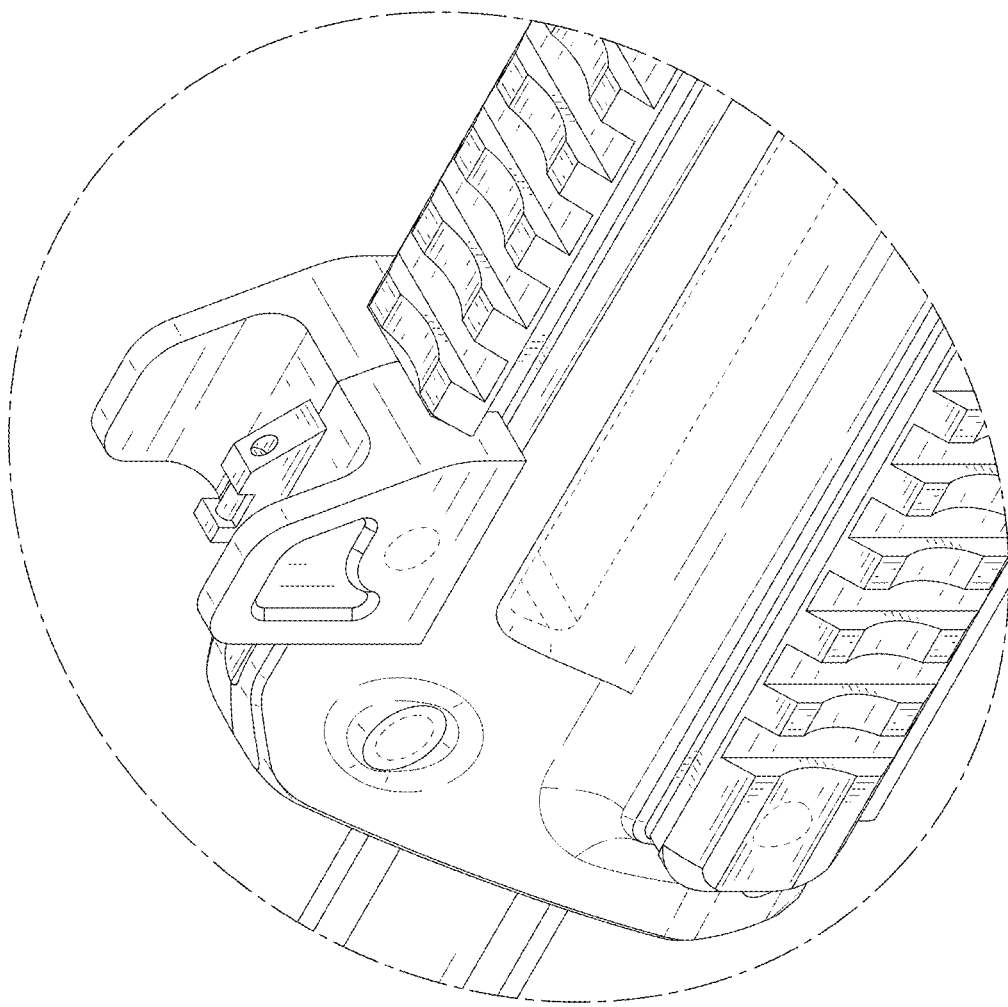

FIG. 9

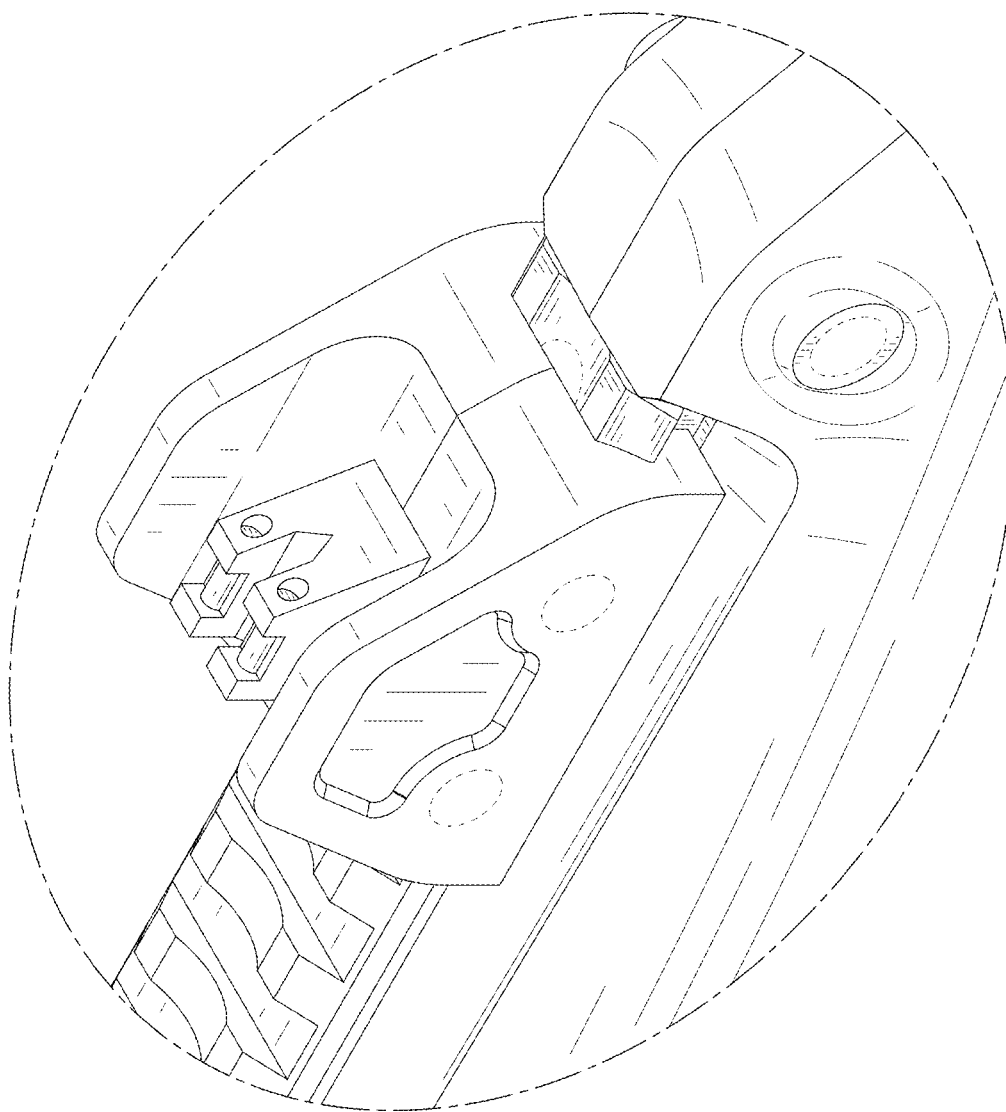

FIG. 10

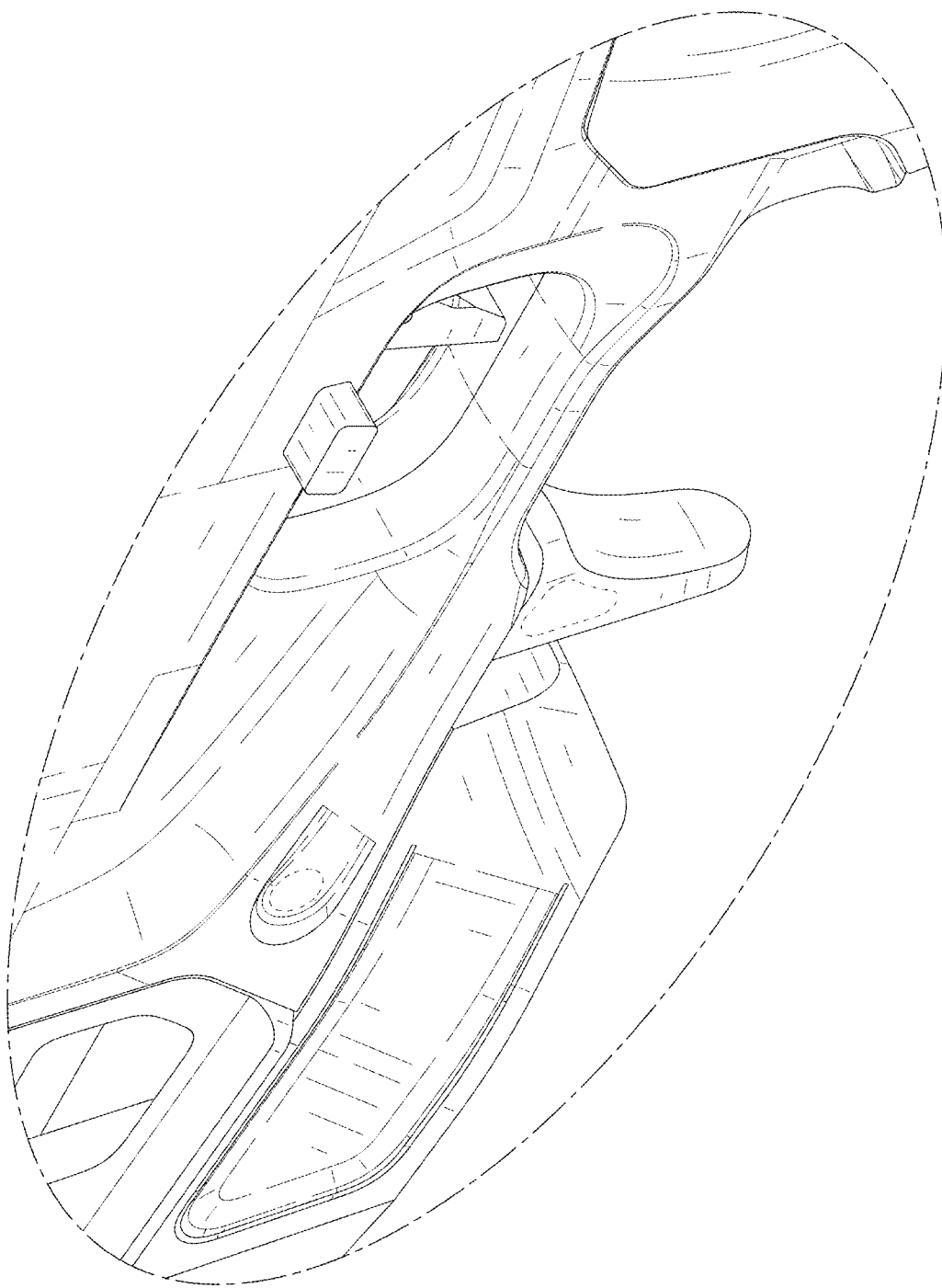

FIG. 11

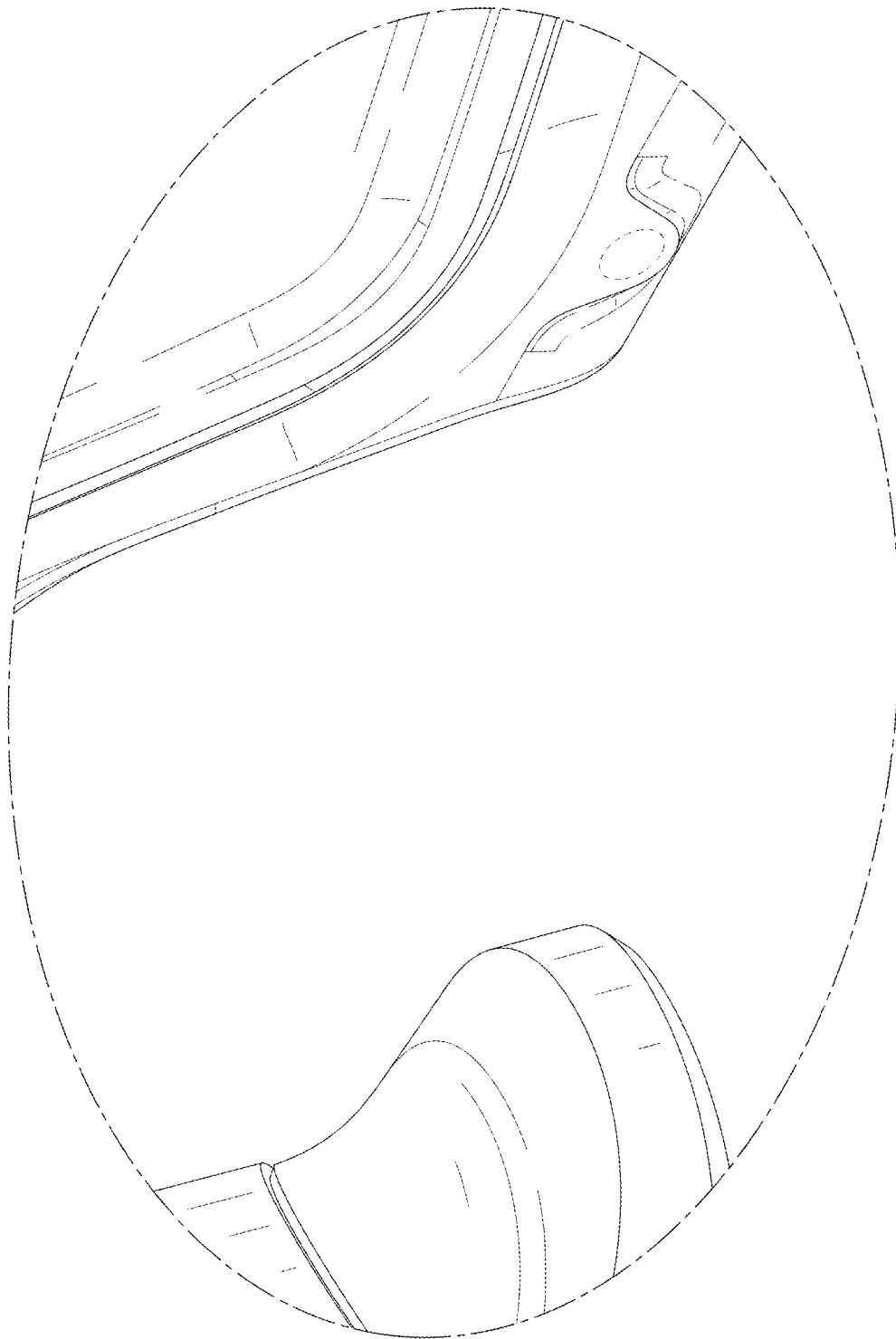

FIG. 12

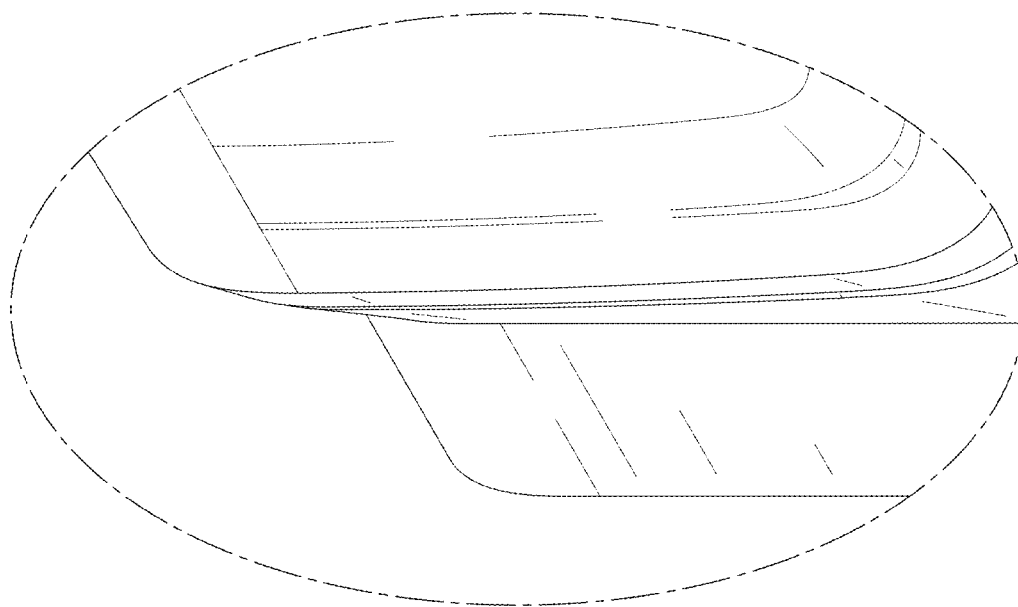

FIG. 13

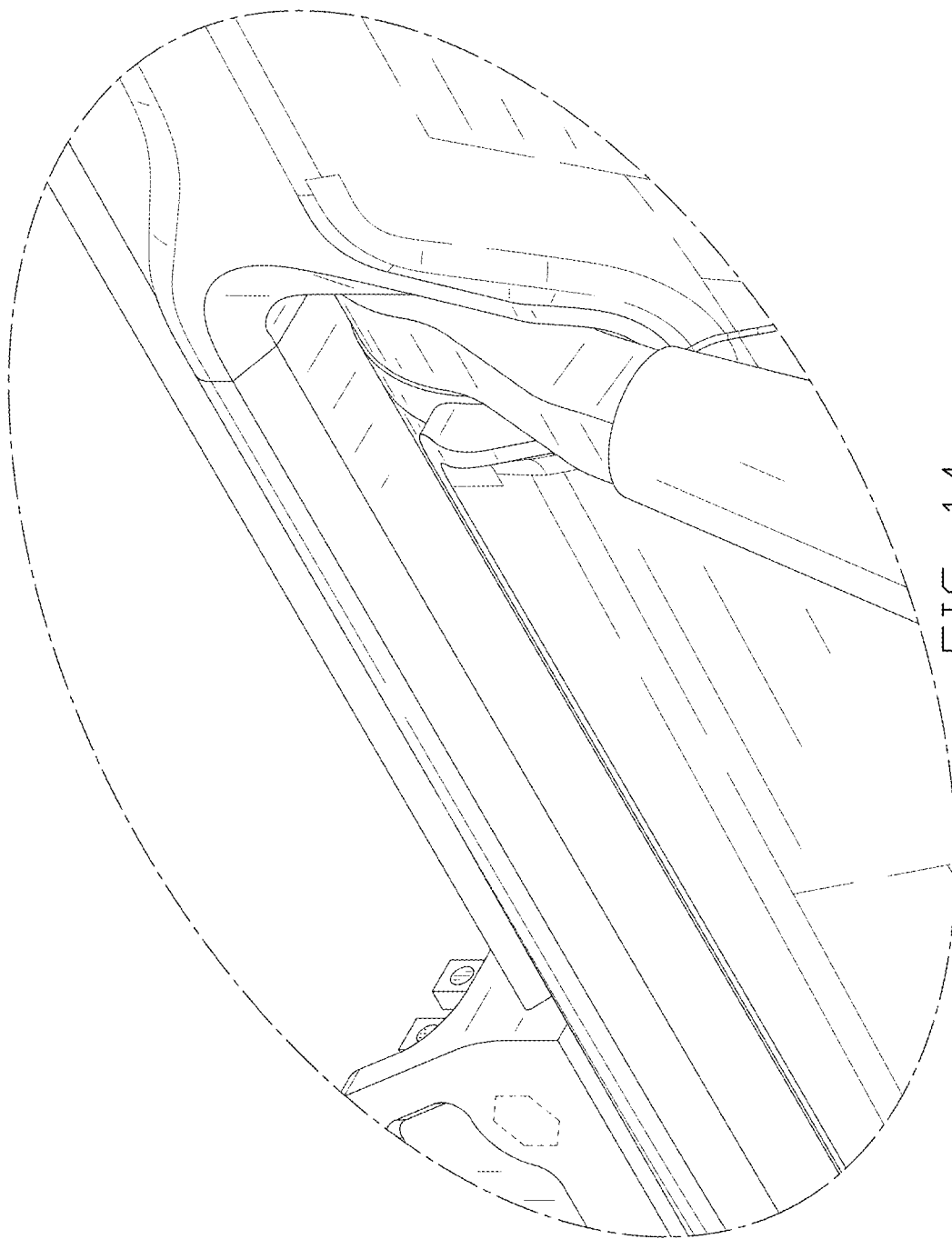

FIG. 14

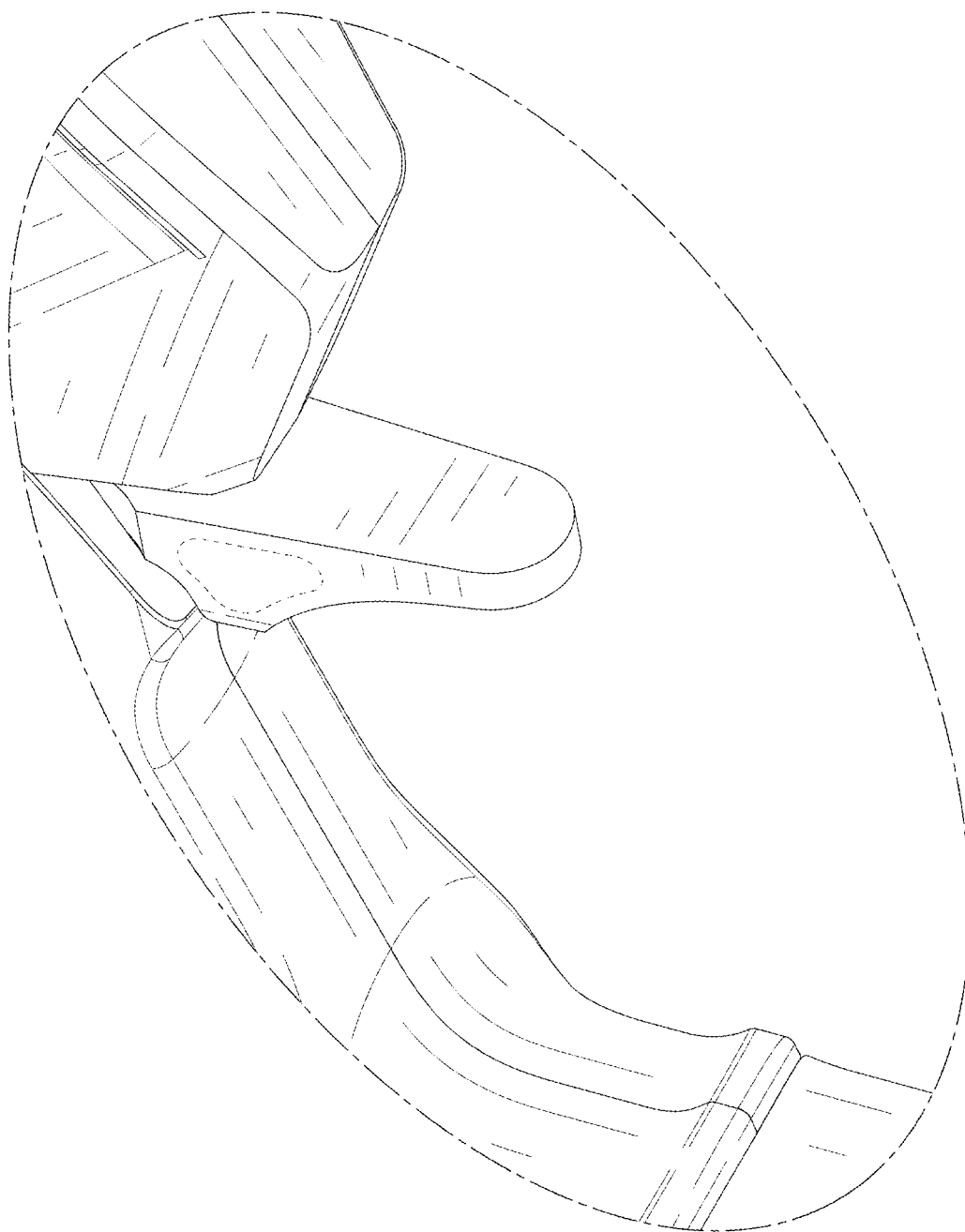

FIG. 15

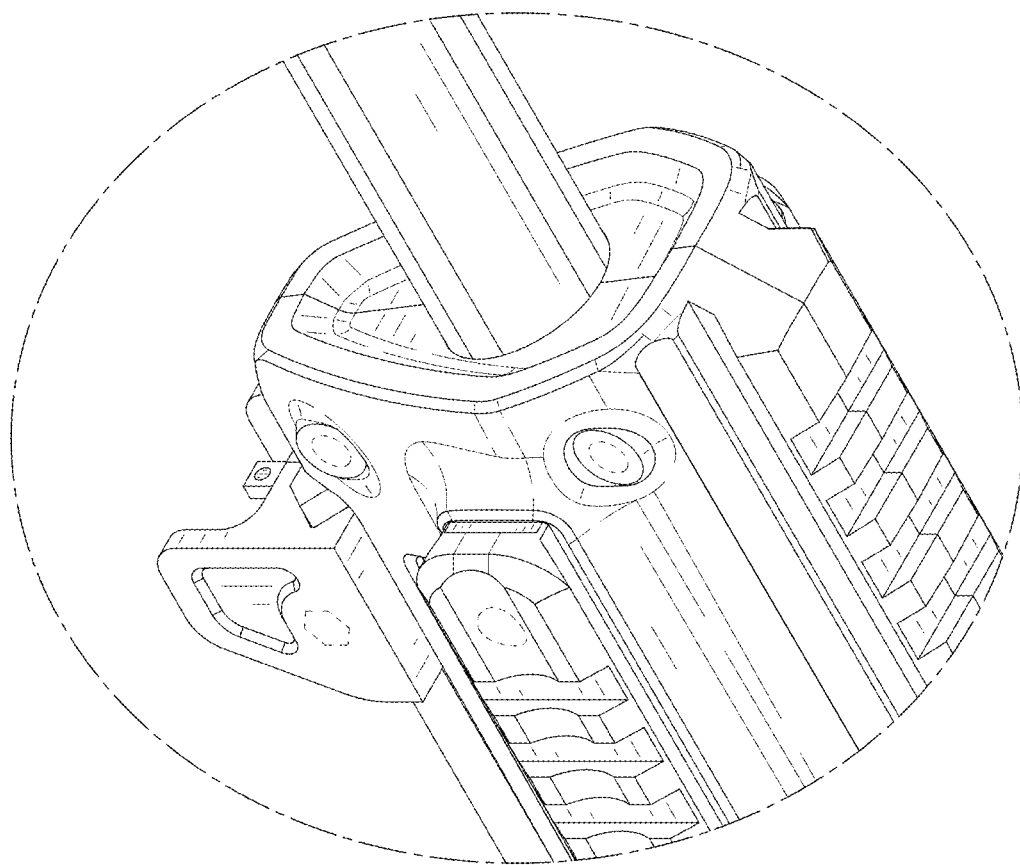

FIG. 16

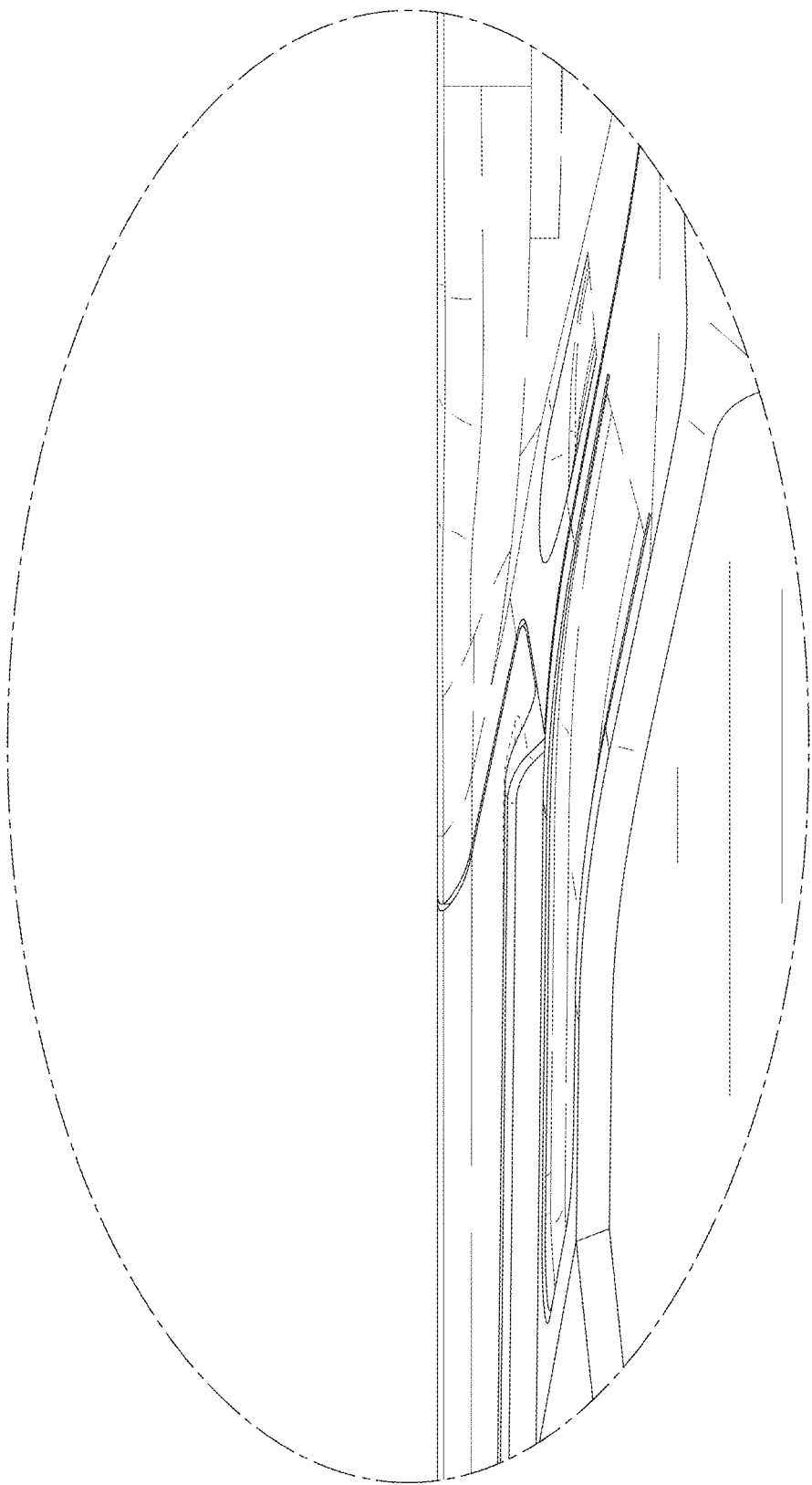

FIG. 17