

A. T. SAFFORD.
CARPET STRETCHER.

No. 190,985.

Patented May 22, 1877

Fig. 1.

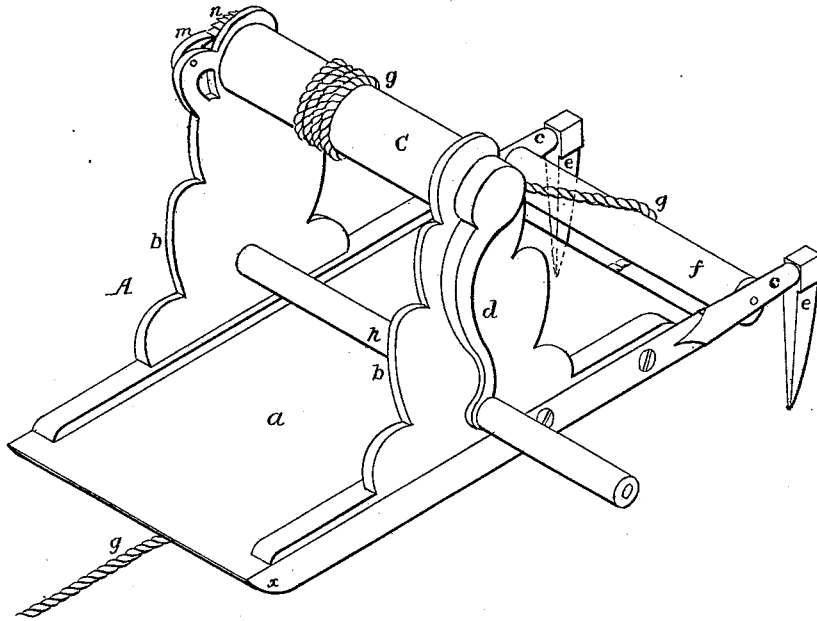
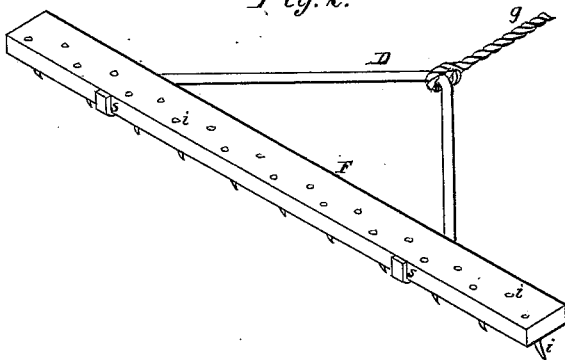

Fig. 2.



Witnesses.
George Thoml
Fred Benjamin.

Inventor.
A. T. Safford
By his attorney
Charles E. Foster

UNITED STATES PATENT OFFICE.

ALONZO T. SAFFORD, OF POMPEY CENTRE, NEW YORK.

IMPROVEMENT IN CARPET-STRETCHERS.

Specification forming part of Letters Patent No. 190,985, dated May 22, 1877; application filed December 5, 1876.

To all whom it may concern:

Be it known that I, ALONZO T. SAFFORD, of Pompey Centre, Onondaga county, New York State, have invented certain Improvements in Carpet-Stretchers, of which the following is the specification:

The object of my invention is a carpet-stretcher economically constructed, as fully described hereafter, so as to secure a ready and sure attachment to the floor, and to readily apply the power requisite to draw the heaviest carpets fully up to the wash-boards.

In the drawing, Figure 1 is a perspective view, showing my improved carpet-stretcher, and Fig. 2 a perspective view of the grasping device.

The frame A of the implement consists of a base, *a*, and two side pieces, *b b*, and in the latter turn the journals of a drum, C, one provided with a crank-handle, *d*, and the other with a ratchet-wheel, *n*, with which engages a pawl, *m*. From the rear of the frame extend two arms, *c c*, from the ends of which project downward sharp-pointed teeth *e e*, and between these arms turns a roller, *f*.

A cord, *g*, is wound on the drum C, and passes around the drum or roller *f*, beneath the plate *a*, and is connected to a yoke, D, turned up at the ends *s s*, and secured to a cross-bar, F, carrying the teeth *i*, pointed, projecting downward, and arranged in two rows, or "staggered," for a purpose described hereafter.

The implement is used by driving the pointed studs *e e* into the floor close to the wash-board, drawing forward the toothed bar F, and inserting the teeth in the carpet a few inches from the edge, and then turning the drum C, on which the cord will be wound, drawing the carpet forward.

As the drum is small in diameter, and the

handle *d* of considerable length, sufficient power to draw the heaviest carpets will be obtained with little exertion on the part of the operator. As the cord is carried beneath the frame, and the roller *f* is near the wall, the carpet will be drawn close up to the latter without moving the machine, and as the arms *c c* extend to the rear of the frame, the rear edge of the latter is kept so far from the wall that the tacks may be inserted in the edge of the carpet after it is drawn close without disturbing the machine, the pawl and ratchet holding the carpet in place by preventing the revolution of the drum.

By turning up the ends *s s* of the bar D, a firm gripe is obtained on the bar without depending on the rivets or bolts, and by arranging the pointed pins in two rows a better hold, less likely to tear the carpet, is obtained, while the strain on the strip is better distributed, and there is less danger of splitting the latter than if the pins were in one row.

Without confining myself to the precise construction shown, I claim—

1. The combination, in a carpet-stretcher, of the frame A, arms *c c*, teeth *e e*, roller *f*, drum C, pawl and ratchet, and cord *g*, passing from the drum around the roller and beneath the frame to the griping-bar, as set forth.

2. The arms *c c*, carrying studs *e e*, and projecting rearward beyond the edge of the frame, to permit access to the edge of the carpet, as specified.

In testimony whereof I have signed my name to this specification in the presence of two subscribing witnesses.

ALONZO T. SAFFORD.

Witnesses:

ROBERT MOORE,
W. G. SOUTHARD.