

W. S. MOON.  
Plow.

No. 200,559.

Patented Feb. 19, 1878.

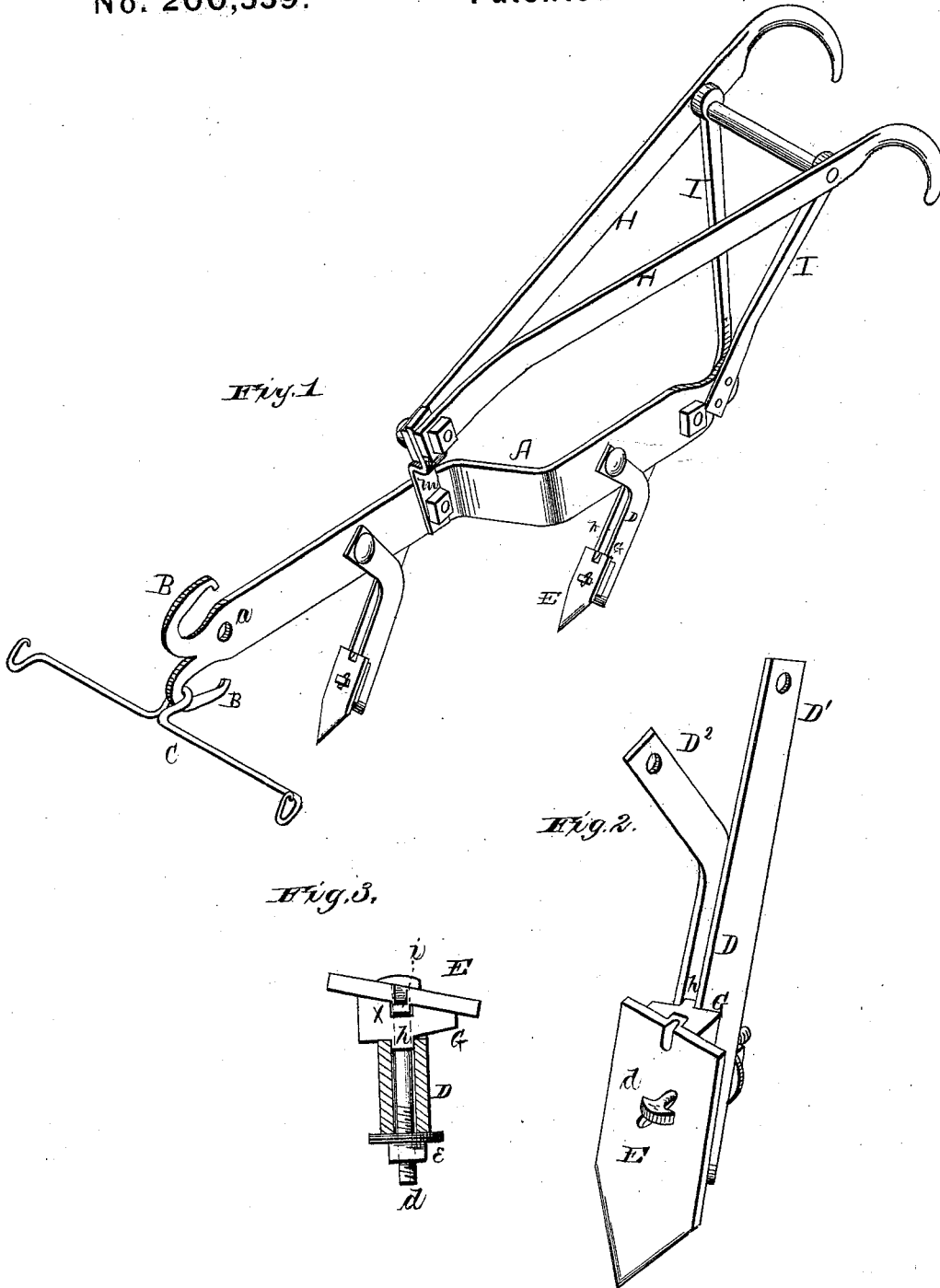

WITNESSES  
*Frank L. Curand*  
*H. Aubrey Foulmer*

INVENTOR  
*W. S. Moon*  
*Franklin Mason*  
ATTORNEYS

# UNITED STATES PATENT OFFICE.

WILLIAM S. MOON, OF PLEASANT GROVE, GEORGIA.

## IMPROVEMENT IN PLOWS.

Specification forming part of Letters Patent No. **200,559**, dated February 19, 1878; application filed December 18, 1877.

*To all whom it may concern:*

Be it known that I, WILLIAM S. MOON, of Pleasant Grove, in the county of Forsyth, and in the State of Georgia, have invented certain new and useful Improvements in Plows; and do hereby declare that the following is a full, clear, and exact description thereof, reference being had to the accompanying drawings, and to the letters of reference marked thereon, making a part of this specification.

The nature of my invention consists in the construction and arrangement of a plow, as will be hereinafter more fully set forth.

In order to enable others skilled in the art to which my invention appertains to make and use the same, I will now proceed to describe its construction and operation, referring to the annexed drawings, in which—

Figure 1 is a perspective view of my invention. Fig. 2 is an enlarged perspective view of the plow-foot, and Fig. 3 is a horizontal section immediately above the plow.

A represents the plow-beam, made of a single piece of iron about half an inch thick, and of suitable length and width, and set edgewise. The front end of the beam A is formed with two hooks, B B, one on top and one underneath, for the attachment of the double-tree C, either high or low, as desired. The double-tree is made of a single iron rod, bent in the form shown, and is to have a similar single-tree at each end. There is also a hole, *a*, in the front end of the beam for the attachment of a clevis, if desired. The beam A is bent, as shown, so that its front and rear portions will be in different though parallel planes, and each part is provided with a plow-foot, D. The plow-foot is made of a single piece of iron, bent at or near the center, so that the two parts will run close together and parallel for a suitable distance, after which one arm, D<sup>1</sup>, continues in the same direction, while the other arm, D<sup>2</sup>, bends forward, and both arms are fastened by bolts *b* to the beam A. The arm D<sup>2</sup> is intended to have several holes, for the passage of the bolt through either of them, so that the plow-foot can be adjusted at any angle that may be desired.

E represents the shovel-plow, which is connected to the plow-foot by means of a bolt, *d*, with nut *e* on the rear end. Between the plow and the foot is interposed a wedge-shaped block, G, having a projection, *h*, on the under side, at each end, to fit between the two arms of the plow-foot. On the front side of the block G, at each end, is a notch, *x*, as shown. The plow has at its upper end a projection, *i*, either projecting from its under side or formed by indenting the plow on the front, said projection fitting in the top notch *x* of the block. The bolt *d* passes through the plow and the block and between the arms of the foot and the nut *e* on its rear end, holding the parts together, and the projections, as described, preventing any lateral or rotating motion. The block G being wedge-shaped, the plow is, of course, inclined to one side, and the block is reversible, so that the plow can be made inclined to either side, as may be desired.

By removing the rear plow-foot, a single plow is formed; or in place of the rear plow, a subsoiler may be attached.

H H represent the handles, the front ends of which are connected to a bar, *m*, fastened to the beam A, and their rear ends connected by braces I I to the rear end of the beam.

Having thus fully described my invention, what I claim as new, and desire to secure by Letters Patent, is—

The combination, with the plow-foot D, of the reversible wedge-shaped block G, having projections *h h* and notches *x x*, the plow E having projection *i*, and the bolt *d*, with nut *e*, all substantially as and for the purposes herein set forth.

In testimony that I claim the foregoing I have hereunto set my hand this 6th day of December, 1877.

W. S. MOON.

Witnesses:

H. C. KELLOGG,  
A. H. WOODLIFF.