

P. B. HOWELL & E. COLE
Butter-Worker.

No. 207,742.

Patented Sept. 3, 1878.

Fig. 1.

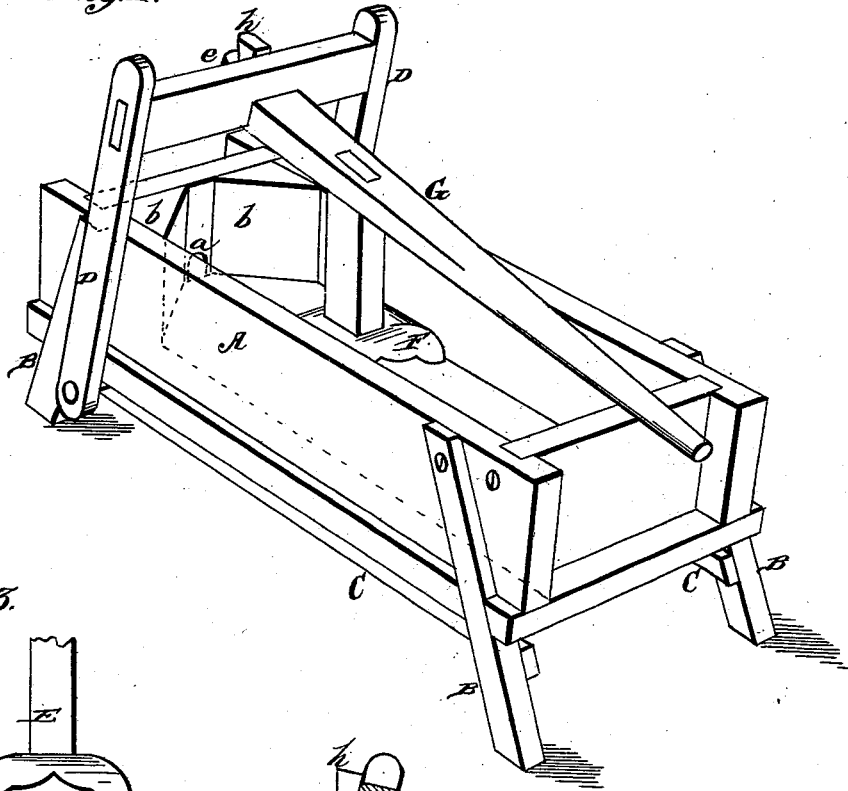

Fig. 5.

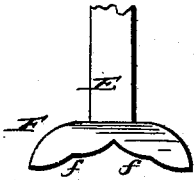
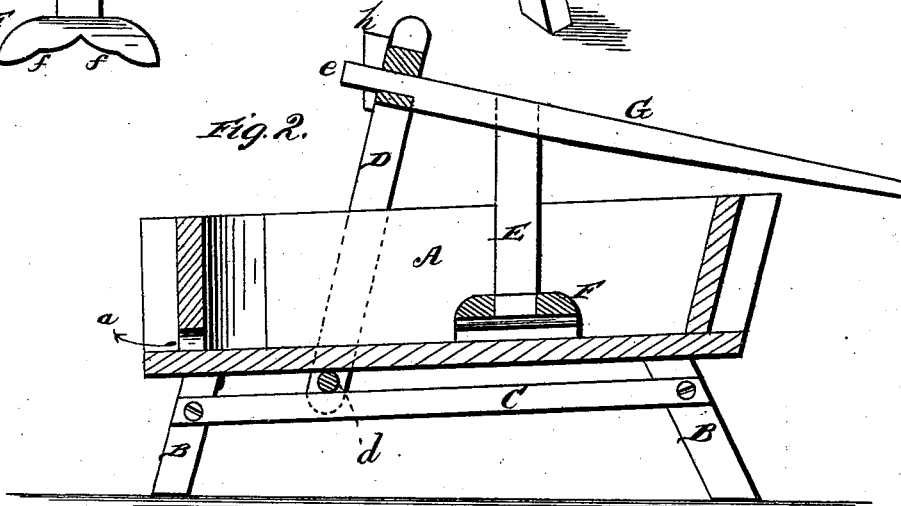

Fig. 2.



WITNESSES

Robert Emmett,
James J. Sheehy.

INVENTOR.

Peter B. Howell,
Eli Cole,
J. Moore, Smith & Co.
ATTORNEYS

UNITED STATES PATENT OFFICE.

PETER B. HOWELL AND ELI COLE, OF HORSEHEADS, NEW YORK.

IMPROVEMENT IN BUTTER-WORKERS.

Specification forming part of Letters Patent No. 207,742, dated September 3, 1878; application filed August 3, 1878.

To all whom it may concern:

Be it known that we, PETER B. HOWELL and ELI COLE, of Horseheads, in the county of Chemung and State of New York, have invented a new and valuable Improvement in Butter-Workers; and we do hereby declare that the following is a full, clear, and exact description of the construction and operation of the same, reference being had to the annexed drawings, making a part of this specification, and to the letters and figures of reference marked thereon.

Figure 1 of the drawings is a representation of a perspective of our butter-worker. Fig. 2 is a vertical central sectional view of the same, and Fig. 3 is a detail view.

The nature of our invention consists in the construction and arrangement of a butter-worker, as will be hereinafter more fully set forth.

The annexed drawing, to which reference is made, fully illustrates our invention.

A represents a box of any suitable dimensions, supported in an inclined position by means of legs B B at each end. At the lower end of the box are interior corner-pieces *b b*, which form a sort of channel to conduct the buttermilk to an outlet, *a*, made in this end of the box, so that the same can run out as it is being worked out of the butter. Under the bottom of the box are bars C C attached to the legs B, and running longitudinally and parallel with the bottom of the box. In the space between these bars and the bottom of the box is passed a round, *d*, the ends of which connect the side bars of a frame, D, passing outside and over the box.

The ladle for working the butter consists of a block, F, which is made concave on its under side, and grooved to form convex ridges *f f*, as shown. This ladle is provided with a stem or shank, E, which is mortised into and fastened at an angle to a handle or lever, G, as shown.

The inner end of the handle G is formed with a tenon, *e*, which is passed through a mortise in the center of the top bar of the frame D, and fastened by means of a pin or wedge-key, *h*, inserted in a hole in said tenon.

The ladle can, by means of the handle G and the movable frame D, be moved back and forth from end to end of the box, and by pressure on the handle work the butter thoroughly and quickly and with perfect ease.

What we claim as new, and desire to secure by Letters Patent, is—

1. The ladle F, made concave and having convex ridges *f*, in combination with the handle G and movable frame D, as and for the purpose set forth.

2. The inclined box A, provided with the corner-pieces *b b*, drain *a*, and bars C C, in combination with the round *d*, frame D, handle G, and ladle F, all constructed substantially as and for the purpose set forth.

In testimony that we claim the above we have hereunto subscribed our names in the presence of two witnesses.

PETER B. HOWELL.
ELI COLE.

Witnesses:

ALFRED FORCE,
SIMEON ROYCE.