

W. MASTERS.
Plow-Clevis.

No. 208,621.

Patented Oct. 1, 1878.

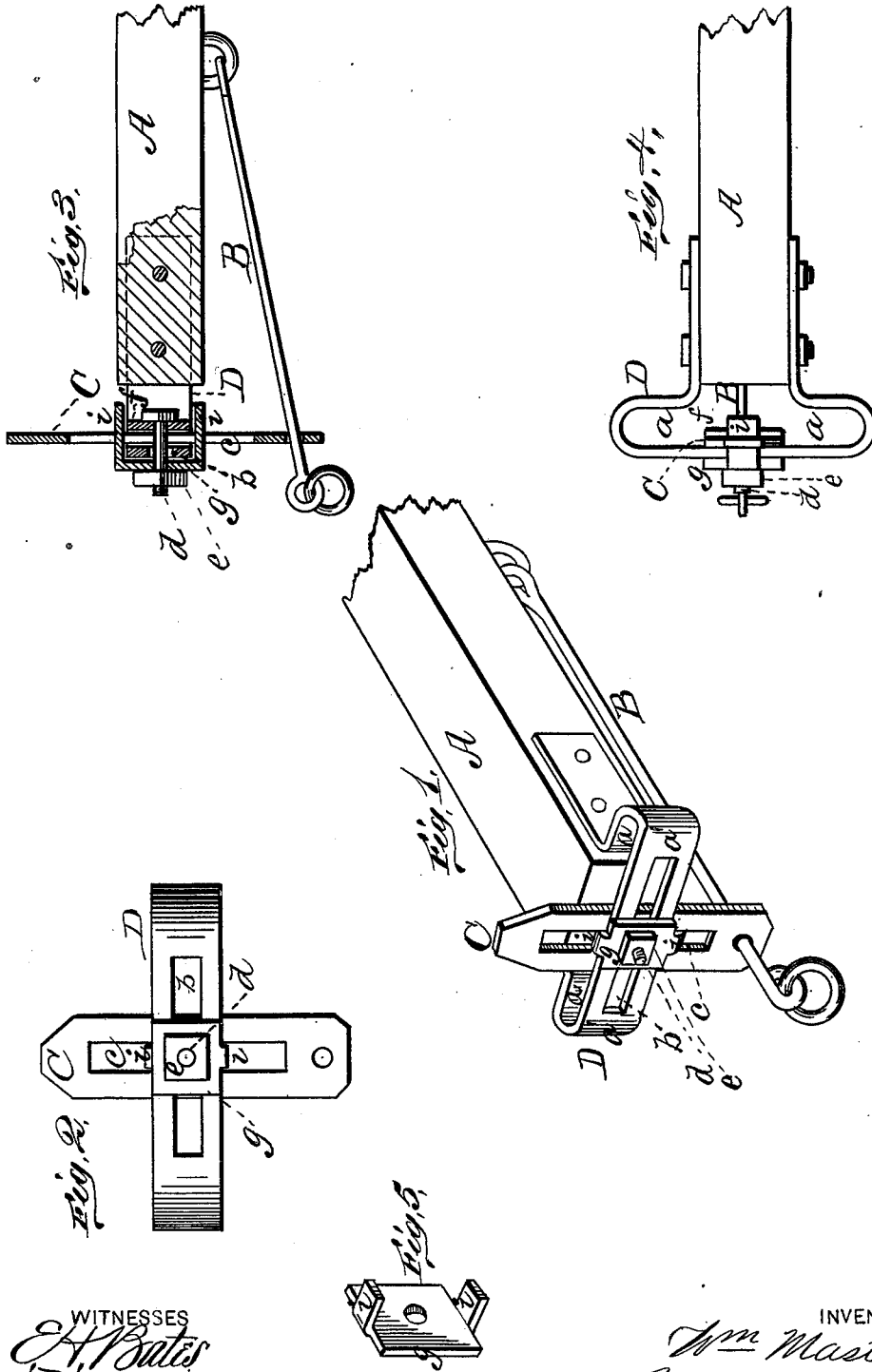

WITNESSES
E. H. Bates
F. J. Chasi.

INVENTOR
Wm. Masters,
By E. W. Anderson.
ATTORNEY

UNITED STATES PATENT OFFICE.

WILLIAM MASTERS, OF MARTINSBURG, PENNSYLVANIA.

IMPROVEMENT IN PLOW-CLEVISES.

Specification forming part of Letters Patent No. **208,621**, dated October 1, 1878; application filed July 6, 1878.

To all whom it may concern:

Be it known that I, WILLIAM MASTERS, of Martinsburg, in the county of Blair and State of Pennsylvania, have invented a new and valuable Improvement in Plow-Clevises; and I do hereby declare that the following is a full, clear, and exact description of the construction and operation of the same, reference being had to the annexed drawings, making a part of this specification, and to the letters and figures of reference marked thereon.

Figure 1 of the drawings is a representation of a perspective view of my improved plow-clevis. Figs. 2, 3, and 4 are, respectively, an end view, a section, and a top view thereof; and Fig. 5 is a detail view of the cap.

This invention has relation to improvements in plow-clevises.

The object of the invention is to devise a plow-clevis that may be adjusted high or low, for the purpose of lessening or increasing the penetration of the plow into the soil, or to either side of the beam, to correct or produce side draft.

The nature of the invention consists in a T-plate secured to the front end of the plow-beam, and having a horizontal slot in its face and a longitudinally-slotted hanger supporting the draft-rod and clamped to said plate, combined as hereinafter more fully described and shown.

In the accompanying drawings, the letter A designates a plow-beam, to the under side of which is secured, so as to be capable of both horizontal and vertical vibration, a metallic draft-rod, B. Upon the front end of the beam is rigidly bolted a metallic T-iron, having a space, *a*, between its face-plate *a'* and the extremity of the said beam, and provided in said plate with slot *b*. C represents the hanger, supporting at its end, below the beam, the draft-rod B, and provided with a slot, *c*, of about the length of the slot *b* aforesaid. The hanger C is secured to the T-iron D by means of a headed bolt, *d*, extending through their slots *c b*, and a clamp-nut, *e*, applied upon the end of the said bolt, as shown in Fig. 1.

Usually the head of bolt *d* is sufficiently large to afford it a properly-extended bearing on the hanger C; but when the said head is deficient in size I use a washer, *f*, of sufficient width to make up the lack and provide an adequate bearing.

In between the clamp-nut *e* and the face-plate *a'* of the iron D is a cap, *g*, having a perforation for the passage of the clamp-bolt, and provided at its top and bottom edges with an arm, *i*. These arms extend through the slot *c* of the hanger that is applied to the T-iron D through the space *a*, behind the face-plate *a'*, and embrace the washer *f*, the hanger being thus kept from rotating on the bolt *d* and maintained in a vertical position at all times.

By loosening the nut *e* the hanger C may be raised or lowered at pleasure, or directed to one side or the other of the beam, for the purpose of producing or correcting a side draft.

This latter feature—providing a side draft—will be found particularly useful in plowing hill-sides, and the vertical adjustment in regulating the depth of the furrow and keeping the plow down to its work.

The object of the clamp-cap and its lugs is to fix the relation of the two slotted plates C and D after adjustment, so that the vertical plate cannot turn on the clamp-bolt as a center, throwing the adjustment out of true.

I am aware that a clevis has been formed with a vertically-slotted bar and a horizontally-slotted end plate, said parts being formed with face corrugations for engagement and held together by a clamp-bolt and rib-faced washer; also, that a vertical clevis-rod bar has been held against a beam-loop by a clamp passing over said loop and a set-screw passing through the clamp, and I do not claim such devices.

What I claim as new, and desire to secure by Letters Patent, is—

The combination, with the plow-beam, of the lateral T-loop D, horizontally slotted on its front wall, the vertically-slotted plate C, carrying the forward end of the draft-rod, and the clamp-plate *g*, having lugs *i* extending into the slot of the plate C and embracing the loop D, whereby the vertical plate is prevented from turning on the clamp-plate, substantially as specified.

In testimony that I claim the above I have hereunto subscribed my name in the presence of two witnesses.

WILLIAM MASTERS.

Witnesses:

EPHRAIM R. HOLSINGER,
J. BROWN.