

J. S. VAN BUREN.
Cooking-Stove.

No. 160,557.

Patented March 9, 1875.

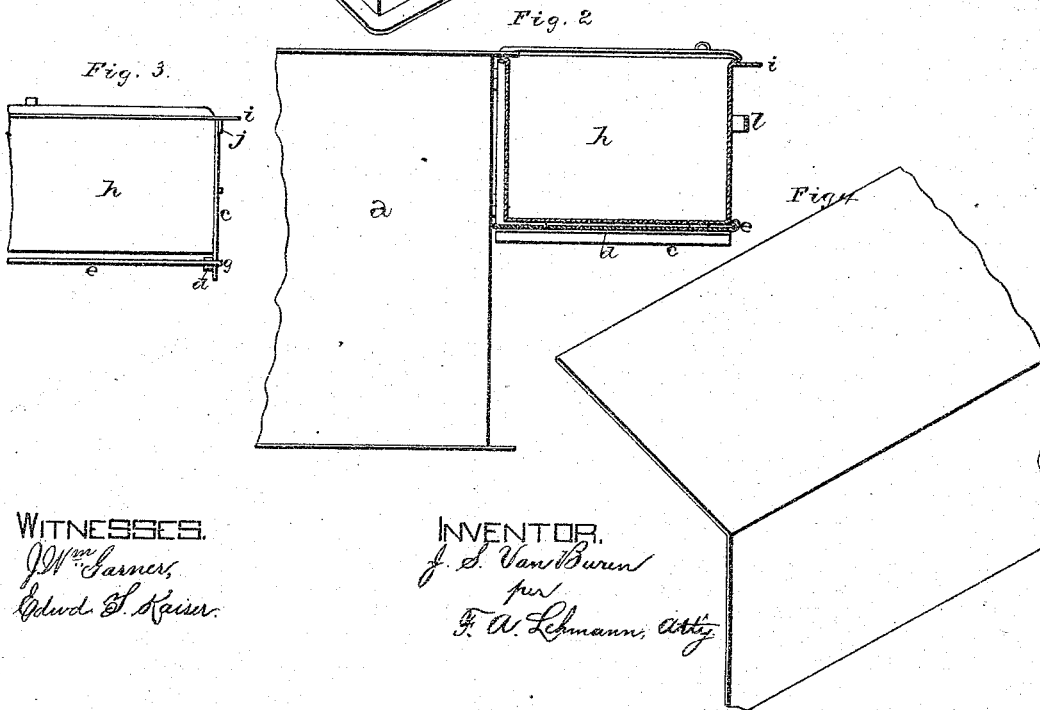
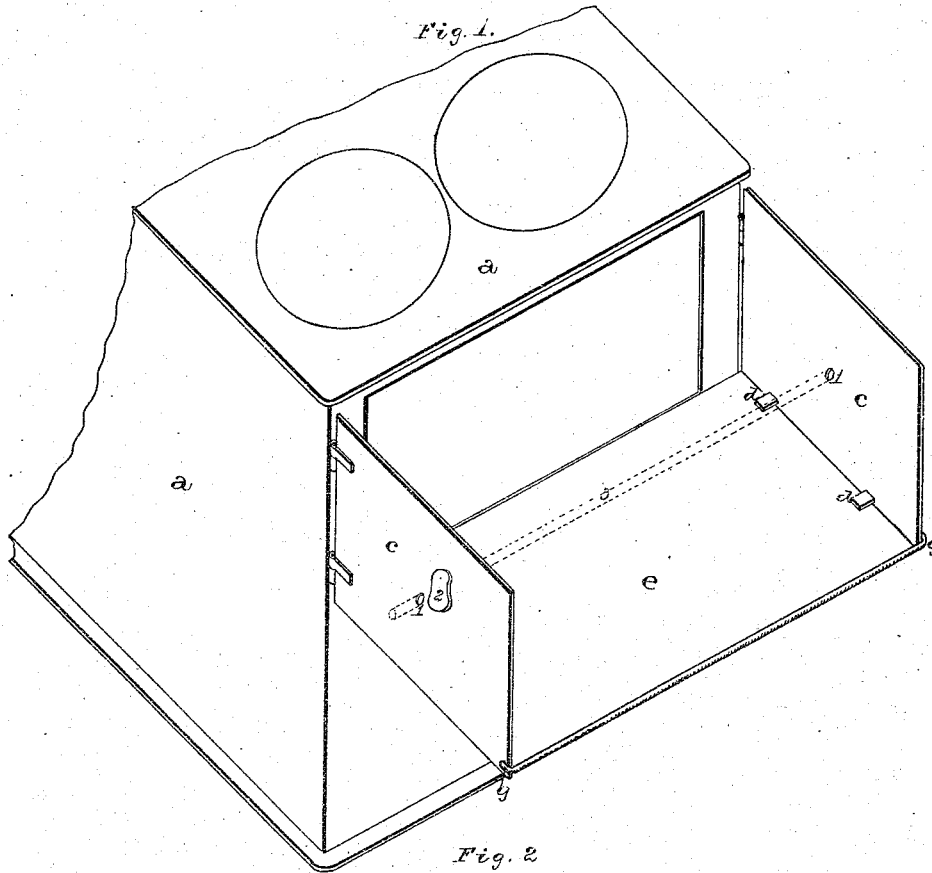

WITNESSES.
J. W. Carner,
Edw. S. Kaiser.

INVENTOR.
J. S. Van Buren
per
F. W. Lehmann, Atty.

UNITED STATES PATENT OFFICE.

JAFEW S. VAN BUREN, OF TROY, NEW YORK.

IMPROVEMENT IN COOKING-STOVES.

Specification forming part of Letters Patent No. **160,557**, dated March 9, 1875; application filed April 29, 1874.

To all whom it may concern:

Be it known that I, JAFEW S. VAN BUREN, of Troy, in the county of Rensselaer and State of New York, have invented certain new and useful Improvements in Cooking-Stoves; and I do hereby declare the following to be a full, clear, and exact description of the invention, such as will enable others skilled in the art to which it pertains to make and use it, reference being had to the accompanying drawings, which form part of this specification.

The nature of my invention relates to an improvement in cooking-stoves; and it consists, first, in forming an additional oven to the stove by attaching a bottom plate and cover to the doors; second, in the arrangement and combination of devices, which will be more fully described hereafter.

The accompanying drawings represent my invention.

a represents an ordinary cooking stove or range, upon one or more sides of which are hung the two doors *C*, which can be readily removed at will. Upon the inner lower edge of each of these doors is formed a groove, slide, or rest, *d*, in or upon which is placed a shelf, *e*, the shelf having at each outer corner a lip or catch, *g*, which passes around the outer edge of each door, and locks the two firmly in position. This shelf, in this position, forms a convenient place for putting dishes to be kept warm, heating irons, and many other purposes.

Upon the top edges of the doors is supported the reservoir *h*, which has a wide flange, *i*, formed upon each end and its front side, and from the under side of the flange at each end there project downward one or more lips, *j*, which catch over the top edges of the doors, and hold them rigidly in position. Upon the top of this case are pivoted two covers, which can be freely opened outward, and which, when closed, form a convenient shelf for placing articles. When these covers are not used, a flat plate may be placed over the top of the case, and serve the same purpose.

The reservoir is provided with a handle, *l*, upon its side, by means of which the same can be adjusted back and forth within the case

formed by the doors and bottom plate, so as to have it nearer to or farther from the fire, as may be desired.

When it is desired to form an additional oven to the stove or range, the doors are braced in position by the bottom plate, as shown in Fig. 1, and then the cover *o*, shown in Fig. 4, is placed over their top, and thus a perfect oven, for all kinds of cooking, is formed.

Through each door is made a small opening, *1*, provided with a pivoted cover, *2*, and through which can be passed a spit, *3*, upon which the meat to be roasted can be hung; or, if so preferred, the cooking can be done entirely in pans placed upon the bottom plate. This oven may be formed equally as well upon the oven-doors (thereby forming an extension to the main oven) as upon the front doors.

Where the stove has a hearth formed upon its front, this hearth may be made to take the place of the bottom plate *e*, there being a flange formed along the edges of the hearth, which act as stops to the doors.

By attaching the doors *c* and bottom plate *e* firmly together, the doors may be lifted off of their hinges or pivots and hung by means of hooks or catches upon the top or body of the stove or range, as convenience or necessity may require.

I am aware that folding ovens to be attached to stoves are not new, and I do not desire to claim such; but never has an oven and reservoir-case been combined, as here shown and described, nor an oven formed by the doors of a stove.

Having thus described my invention, I claim—

1. The combination of the doors, a cover, and a bottom plate, substantially as described.

2. The doors *c* or end plates, pivoted or hung upon a stove or range, in combination with a reservoir, *h*, provided with lips *j*, whereby the reservoir is supported upon the side of the stove or range, substantially as shown.

3. The combination of the doors *c*, provided with supports *d*, with the plate *e*, having braces

or catches for holding the doors in position, substantially as shown.

4. A water-reservoir, *h*, having the flange *i* upon each end, in combination with suitable supports, whereby it is supported in position, and can be adjusted back and forth in relation to the side of the stove, substantially as specified.

In testimony that I claim the foregoing I have hereunto set my hand and seal this 22d day of April, 1874.

JAFEW S. VAN BUREN. [L. S.]

Witnesses:

ALFRED W. RICHARDSON,
EMMET A. CHAMPLIN.