

Field Feature Bill of Material

PN 05F2599

CONVERT an IBM 3745 Model 1X0 to 17A

Written by: J. Michaut
Checked by: J. Combes
Approved by: A. Badino
Reviewed by: B. Smith?

3745 FFBM	PN 05F2599 1 of 22	See EC History	EC D55799 16SEP94	EC D55883 11MAY95	EC D55889 04SEP95	EC E27926 14MAR97
--------------	-----------------------	-------------------	----------------------	----------------------	----------------------	----------------------

3745
FFBM

PN 05F2599 2 of 22

See EC History

EC D55799 16SEP94

EC D55883 11MAY95

EC D55889 04SEP95

EC E27926 14MAR97

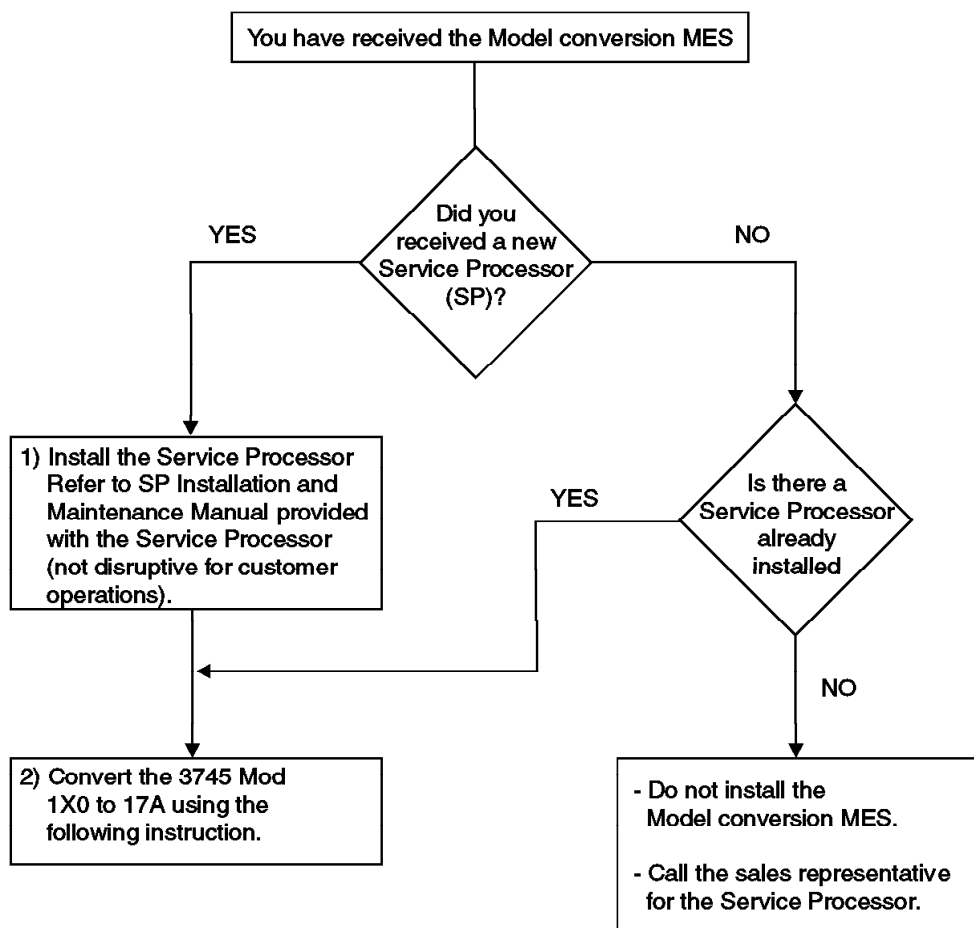

Before Installation (Steps 1-8)

VERY IMPORTANT

MES should be installed without delay, after receipt, to avoid multiple MCLs needed for the microcode.

Net Priced Feature

All parts removed from this machine are IBM property and must be returned to IBM.

3745 FFBM	PN 05F2599 3 of 22	See EC History	EC D55799 16SEP94	EC D55883 11MAY95	EC D55889 04SEP95	EC E27926 14MAR97
--------------	-----------------------	-------------------	----------------------	----------------------	----------------------	----------------------

1.0 Machines Affected

3745 Models 130/150/160/170.

This feature should only be applied on the machine serial for which it is specified.

2.0 Related BMs and ECs

2.1 Prerequisites

(Must be installed prior to this installation)

- NCP minimum level V6R3 must be installed and validated before starting the Model conversion MES.
Checkpoint: Perform MLT function on MOSS.
- A Service Processor must be installed and ready to be connected to the 3745 before starting the Model conversion MES.
A Service Processor can connect to a maximum of 4 3745 Model XXAs.

2.2 Concurrent

(Must be installed together)

None.

2.3 Companion

(May be installed Together)

None.

3.0 FFBMs to be Installed

- Model conversion MES:
05F2599 - Installation Instructions
57G7495 - Convert a 3745-130/160/170 to 17A
or 57G7496 - Convert a 3745-150 to 17A
or 57G7497 - Convert a 3745-150 to 17A (US only)
- An external console cable is provided:
43G3172 - Console cable (US only)
or 43G3173 - Console cable (World Trade)
- An SP is required for 3745 operations.
FFBM shipped at customer request.

58G5543 - Service Processor (World Trade)
or 58G5547 - Service Processor (US/Canada)

4.0 Preparation

1. Familiarize yourself with the purpose and details of the installation instruction before negotiating machine time with the customer.
2. Check all items listed on the BM(s) to verify that all parts have been received.
3. The installation must be performed off-line.
4. Ensure that RETAIN search has been performed and all prerequisites have been installed. Perform a search using **3745UPGRADE** and technical **37451X0T017A** as SAS keyword to get some TIPs regarding the conversion.
5. Ensure that a current set of backup diskettes have been created by saving the hard disk contents onto diskettes before powering OFF the 3745 (refer to **Disk/diskette Management Function** in *Service Function Manual*).
6. Ensure that RSF link is installed and working. If the customer has not provided a RSF link, review or have marketing review with the customer for maintenance exposure.
7. To check if a new MCLs level is necessary, perform a RETAIN search using **3745UPGRADE CODE LEVEL** for the TDR which gives the most recent level of microcode available for this machine (model).

To install the last level of MCLs, the most efficient way is with the LIC upgrade procedure. Use the RETAIN search, **3745ECA134 COF**, for the TDR which explains the procedure for ordering the latest level microcode from COF.

Third party can get the latest level of code through their normal microcode ordering procedures.

MCLs can be obtained from RETAIN (If if the customer provide an RSF link), or by ordering the 3746 optical disk MCL via CCSS.

8. Do not damage the packing boxes. They will be use for repacking.

3745 FFBM	PN 05F2599 4 of 22	See EC History	EC D55799 16SEP94	EC D55883 11MAY95	EC D55889 04SEP95	EC E27926 14MAR97
--------------	-----------------------	-------------------	----------------------	----------------------	----------------------	----------------------

9. To support the new Model, ACF/NCP V6R3 (or later) must be installed.
10. Before starting this MES, verify that the serial number on the *3745 Installation parameters* diskette is written in the following format: **YY-XXXXX** where **YY** is the plant ID. If plant ID on the 3745 console is **00**, diskette will have **23** on label. **XXXXX** serial number portion will remain the same as on the console.
11. Use the DII function to purge all NCP dumps from the MOSS hard disk.
12. Use the DDD function to delete the MOSS dump (CHGDMP) from the MOSS hard disk.

Additional information:

- All adapter cards will be reinstalled in the same position after the Model conversion.
- If a TRA feature is installed, the BPC1 cards must be plugged in positions A1M4, N4, P4, Q4, R4, and T4 when these card positions are free.

5.0 Programming

5.1 Diagnostic Programs

To reflect this change, CDF will be upgraded in Step 11.0. This is essential to allow the internal diagnostics to be run properly.

5.2 System Programs

NCP V6R3 is the minimum level required to support the 3745 Model 17A.

6.0 Purpose and Description

To convert a 3745 Model 1X0 to a Model 17A.

1. Install a Service Processor.
2. Replace the MOSS board and cards.
3. Replace the console tailgate.
4. Replace the EPO switch.
5. Replace the base board.

7.0 Installation Time

To be reported as MES.

FFBMs	Machine Hours	System Hours	Nbr of CE
57G7495 or 57G7496 or 57G7497	7.6	0.0	1

8.0 Tools/Materiels Required

- ESD kit (PN 6428316)
- Isopropyl Alcohol.

3745 FFBM	PN 05F2599 5 of 22	See EC History	EC D55799 16SEP94	EC D55883 11MAY95	EC D55889 04SEP95	EC E27926 14MAR97
--------------	-----------------------	-------------------	----------------------	----------------------	----------------------	----------------------

Installation (Steps 9-11)

9.0 Safety

- Review the **Safety Procedures** and the **Safety Notices** located at the beginning of the 3745 *Maintenance Information Procedures (MIP)* manual, SY33-2070.

10.0 Details of Installation

Before the installation, ask the customer:

- To set all lines off-line for this 3745.
- The maintenance password.
- To log OFF the console, if not already done.

10.1 Checking, Diagnostics, Power OFF

10.1.1 Checking

10.1.1.1 From the 3745 Control Panel

- 1. Check that **Power Control** displays **3**.
- 2. If it does not, record the value ____.
Set the **Power Control** value to **3**.
Press the **Validate** key.

10.1.1.2 From the Local Console

- 1. When the **CA INTERFACE DISPLAY** screen is displayed, press **F4**.
Note: For APG/LA countries: if a channel adapter is installed, disable the channel adapter first.
- 2. Enter the maintenance password, press **Send**.
- 3. If the CCU is running, enter **RST** to reset the CCU, otherwise, continue.
The MOSS goes in **MOSS ALONE** state.

10.1.1.3 Verify the CDF

- 1. Enter **CDF**, press **Send**.
- 2. Enter **4** (VERIFY), press **Send**.
The value from the **CDF DATA** and the **MACHINE DATA** should be identical.
- 3. When **CDF VERIFY COMPLETED** is displayed, press **F1**.

10.1.1.4 Record Scheduled Power ON

- 1. Enter **TIM**, press **Send**.
- 2. Enter **2**, press **Send**.
- 3. Record, on the screen below, the **SCHEDULED POWER ON DATA** if filled.

```

FUNCTION ON SCREEN:  TIME SERVICES
                     SCHEDULED POWER ON DATA

- FILL IN, MODIFY, OR BLANK APPROPRIATE FIELD, PRESS SEND.

SUNDAY      (HH:MM) ==>
MONDAY      (HH:MM) ==>
TUESDAY     (HH:MM) ==>
WEDNESDAY   (HH:MM) ==>
THURSDAY    (HH:MM) ==>
FRIDAY      (HH:MM) ==>
SATURDAY    (HH:MM) ==>

SCHEDULING ACTIVE (Y=YES, N=NO) ==>
  
```

- 4. Press **F1**.

10.1.2 Diagnostics

- 1. Enter **ODG**, press **Send**.
- 2. Enter **1** (ALL), press **Send**.
 - If **NO ERROR FOUND** displayed, press **F1**.
 - Otherwise, see the *MIP*, Chapter 1.

10.1.3 Power OFF

- 1. From the control panel, press the **Power OFF** key.
- 2. Open the front system cover and switch OFF **CB1**.

3745 FFBM	PN 05F2599 6 of 22	See EC History	EC D55799 16SEP94	EC D55883 11MAY95	EC D55889 04SEP95	EC E27926 14MAR97
--------------	-----------------------	-------------------	----------------------	----------------------	----------------------	----------------------

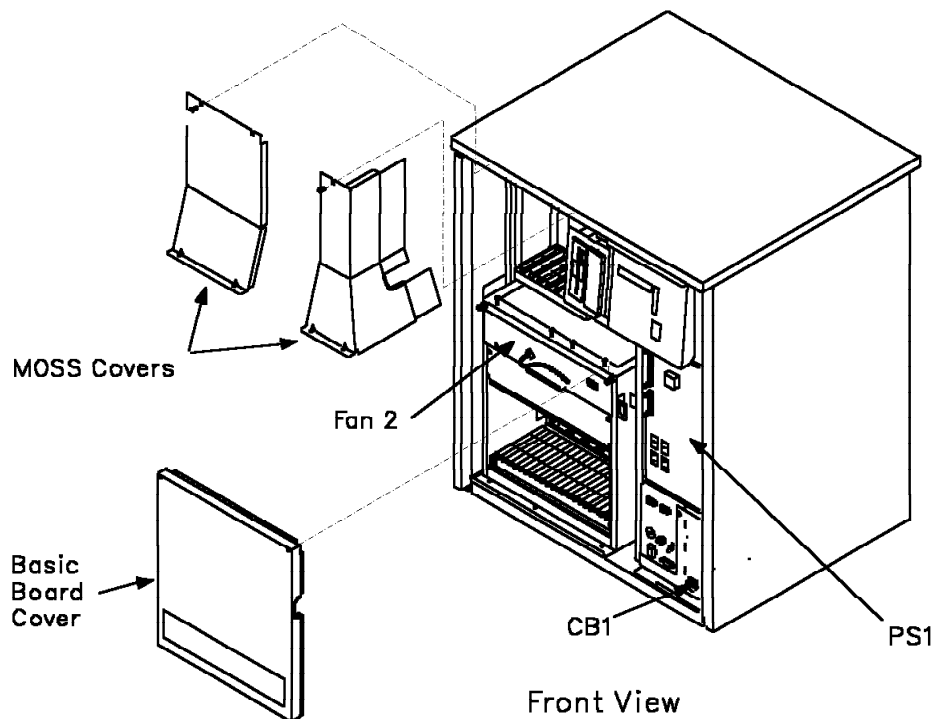

Front View

10.2 Hardware Installation

Warning: Follow the existing ESD procedures when handling logic parts.

10.2.1 MOSS Board Removal

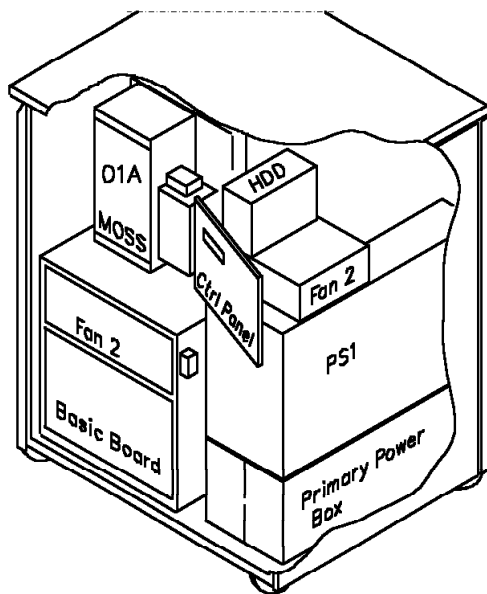

- ___ 1. Locate the MOSS board in O1A.
- ___ 2. Remove the two MOSS board covers (7 screws). Save for reinstallation.

- ___ 3. Disconnect all cables from MOSS board.
Note: Verify that cables are **labeled** according to their **positions** (it is recommended for the reinstallation). If they are not, use labels (PN 811825).
- ___ 4. Remove the 8 screws securing the MOSS board assembly to the frame. Save screws for re-installation.
- ___ 5. Carefully, disengage first the left side of the MOSS board assembly.
- ___ 6. Remove the MOSS board assembly from the 3745, and place it in a safe place.

10.2.2 Console Tailgate Replacement

- ___ 1. Locate the console tailgate in O1R (see figure in Step 10.10.1, "CA Tailgate(s)" on page 11), and note the routing of three console cables.
- ___ 2. Remove the three console cables from clamps.
- ___ 3. Remove the console tailgate (2 screws) from location O1R with the three console cables. Save screws to reinstall the new tailgate.

3745 FFBM	PN 05F2599 7 of 22	See EC History	EC D55799 16SEP94	EC D55883 11MAY95	EC D55889 04SEP95	EC E27926 14MAR97
--------------	-----------------------	-------------------	----------------------	----------------------	----------------------	----------------------

- 4. Route the new console cable to the MOSS area following the path of the old cables just removed reusing the existing clamps.
- 5. Secure the new tailgate (PN 57G7505) with the two screws previously saved.

10.2.3 New MOSS Board Installation

- 1. Carefully, install the new MOSS board assembly provided by the FFBM, using saved screws.
- 2. Reconnect all the removed cables to the MOSS board.
- 3. Plug the new console cable on MLA card (X0-D3).

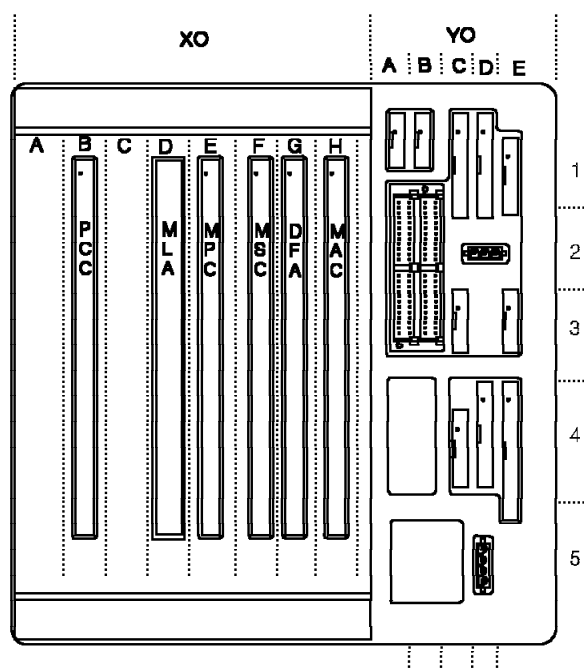

10.2.4 External Console Cable

- 1. Connect external console cable (PN 76F9440 or 76F9441) provided by FFB/M 43G3172 or 43G3173 to connector J1 of the console tailgate.
- 2. Route and plug the cable in any empty slot of the **Service Processor Access Unit**.
- 3. If you have just installed the Service Processor as part of this MES, check that the SP is connected to the Service Processor Access Unit.

10.3 Power ON

From the primary power box, switch CB1 ON and close the system cover(s).

10.3.1 From the Service Processor

- 1. When the **MOSS-E Logon** window is displayed, enter the maintenance password (the default password is IBM3745).
- 2. Click on **OK**.
- 3. On the **MOSS-E View** window, double click on the **Service Processor** icon (green).
- 4. On the **Service Processor Menu** window, click on **Configuration Management**. Then, double click on **Manage 3745/3746-900 Installation/Removal** (scroll in the window or set the window in full screen).
- 5. On the **Controller Installation** window, if not already selected (black line), click on the first 3745 flagged not installed.
- 6. Click on **ADD**.

10.4 IML From Diskette

Take the two sets (NORMAL and BACKUP) of diskettes shipped with this MES. If not already done, mark one set NORMAL and one set BACKUP.

Note: There are six diskettes in a set.

- 1. Insert the new **NORMAL PRIMARY** diskette, into the 3745 diskette drive.
- 2. From the control panel, check that **Service Mode** indicator displays **0**. If it does not, set the **Service Mode** indicator to **0**. Press the **Validate** key.
- 3. Set the **Function** indicator to **9** (load from diskette). Press the **Validate** key.
- 4. Press the **Power ON Reset** key.

A MOSS IML will be complete with **F0E** or **FE9** displayed on the control panel.

Note: The code **B9F** can be displayed indicating a timeout. This does not affect the proper oper-

3745 FFBM	PN 05F2599 8 of 22	See EC History	EC D55799 16SEP94	EC D55883 11MAY95	EC D55889 04SEP95	EC E27926 14MAR97
--------------	-----------------------	-------------------	----------------------	----------------------	----------------------	----------------------

ation. If an other code is displayed, see the *MIP*, Chapter 1.

10.5 3745 Installation

From the Service Processor:

- ___ 1. Click on **OK**.
Window **ADD a 3745** is displayed.
- ___ 2. Enter the 3745 Serial Number in the following format: **YY-XXXXX** (do not forget the dash (-)).

Note: YY is the plant ID. If the plant ID = **00**, you must enter **23**.
Click on **OK**.
- ___ 3. When requested, insert the *3745 Installation Parameters* diskette (received with the MES) in the SP diskette reader.
Click on **OK**.
- ___ 4. When a panel saying **Controller Parameters successfully loaded**, click on **OK**.
- ___ 5. When a controller installation message saying that **the controller information has been successfully added** is displayed, remove the **Installation Parameters** diskette from the diskette drive of the SP.
Click on **OK**.
- ___ 6. Enter the new system name (provided by the customer), click on **OK**.
Click on **OK**.
- ___ 7. On the **Controller Installation** window, click on **Cancel**.
- ___ 8. On the **MOSS-E View** window, double click on the 3745 icon you have just installed (color should be PURPLE).
- ___ 9. On the **3745 Menu** window, double click on **MOSS Console**.

The 3745 **Disk Function Selection** screen will be displayed after a short interval.

10.6 Microcode EC Installation

- ___ 1. Enter 1 (EC Microcode Installation), press **Enter**.

Note: You will get the following messages while reading the PRIMARY diskette:

Increasing in disk size (up to 80 MB) - Please wait several minutes.

Read checking in progress - Please wait several minutes.

(Alternate Track Assignment screen will now be displayed).

- ___ 2. Use the **NORMAL** set of diskettes, and follow the prompts on the console until the function is completed.

Note: Use only one set of diskettes (NORMAL) for this installation. The same set must be used for the checking pass and for the pass which installs on the hard disk. Use of different set can lead to lost CDF data.
- ___ 3. Press **F6** to continue with EC Installation. Follows prompts on SP screen.
If Microcode installation fails on 'diskette checking', try again with BACKUP diskettes.
If installation fails during 'diskette loading', see the *Service Function* manual, Chapter 11, hard disk trouble analysis and replacement, Procedure 1.

Note: **Copy file in progress - Please wait several minutes** may be displayed if two NCP load modules are on Hard Disk.
- ___ 4. When message **EC DXXXXX correctly installed** appears, remove the sixth diskette from the diskette drive.
- ___ 5. On the **3745 Menu** window, double click on **Operation Management**.
- ___ 6. Double click on **Set 3745/MOSS-E Connection Mode**, to set to normal mode.
- ___ 7. On the information panel, click on **OK**.

10.7 MOSS IML

From the control panel:

- ___ 1. Press **Power OFF** key.
- ___ 2. Set the **Function** indicator to 1.
Press the **Validate** key.
- ___ 3. Set the **Service Mode** indicator to 2.
Press the **Validate** key.
- ___ 4. Press the **Power ON Reset** key.
 - The **MOSS IML** is completed when **F0E** is displayed on the control panel.
 - If another code is displayed, see the *MIP*, Chapter 2, and follow the appropriate procedure.

3745
FFBM

PN 05F2599
9 of 22

See EC
History

EC D55799
16SEP94

EC D55883
11MAY95

EC D55889
04SEP95

EC E27926
14MAR97

10.8 Verify the CDF

- ___ 1. Enter **CDF**, press **Enter**.
- ___ 2. Enter **4** (VERIFY), press **Enter**.
The value from the **CDF DATA** and the **MACHINE DATA** should be identical except for the new hardware you have just installed, enter **2**, press **Enter**. If there is another discrepancy, check the IOC bus cables setting on the MOSS board.
- ___ 3. When **CDF VERIFY COMPLETED** is displayed, press **F1**.

10.9 Power OFF

- ___ 1. From the control panel, press the **Power OFF** key.
- ___ 2. Open the front system cover and switch **OFF CB1**.

10.10 Base Board Removal

- If there is no CA tailgate(s) installed, go to Step 10.10.2, "Cable Disconnection" on page 12.
- Otherwise, continue.

10.10.1 CA Tailgate(s)

1. Open the rear cover of the 3745.
2. Locate the CA tailgate(s) and set the select out bypass switch to the bypass position on each tailgate.

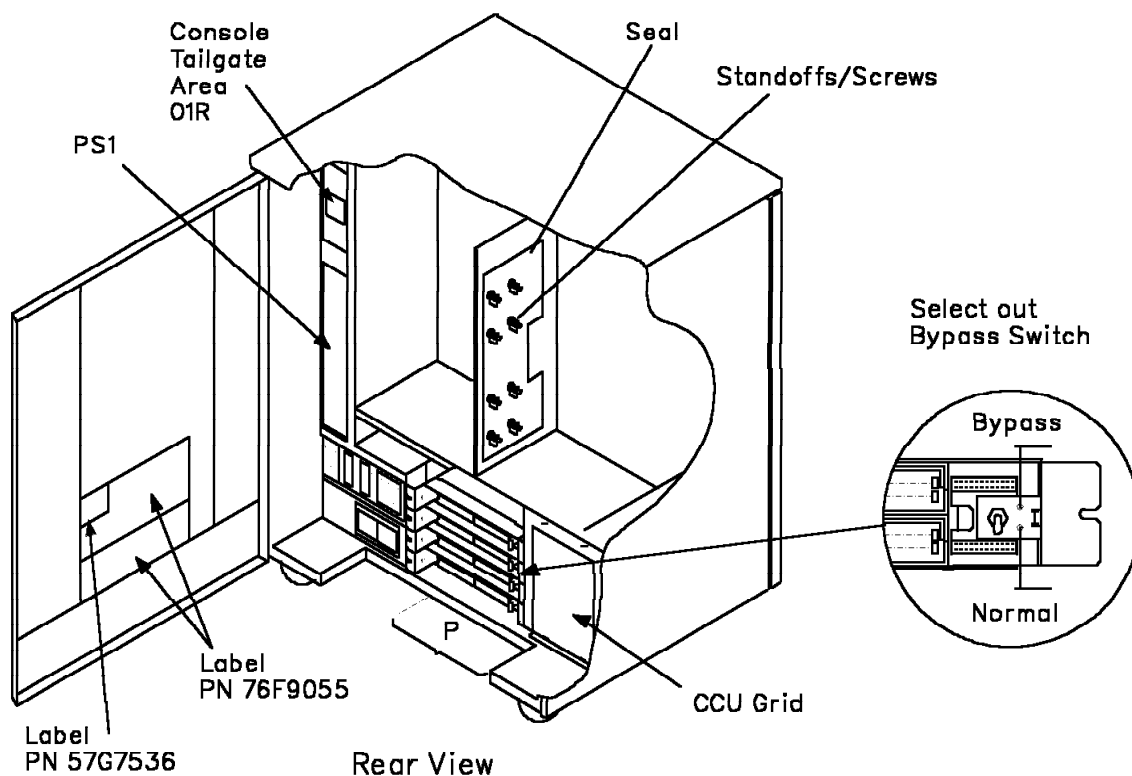

3. Locate and remove the CCU grid (four screws).
4. Disconnect the CA tailgate cables from the basic board (knurled screws) (note their positions - reference YZ052).
5. From the front of the 3745 locate and remove the basic board cover (two screws) by lifting upwards using the finger hole.

3745 FFBM	PN 05F2599 11 of 22	See EC History	EC D55799 16SEP94	EC D55883 11MAY95	EC D55889 04SEP95	EC E27926 14MAR97
--------------	------------------------	-------------------	----------------------	----------------------	----------------------	----------------------

10.10.2 Cable Disconnection

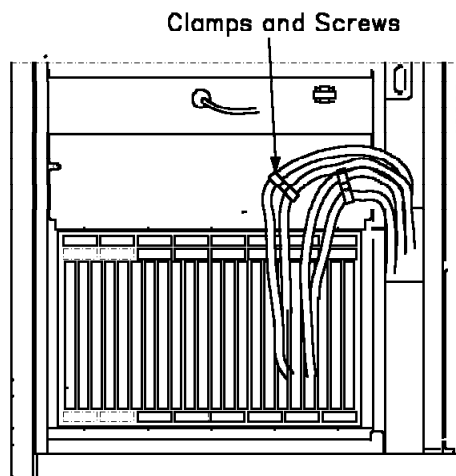

- ___ 1. On all adapters installed, remove the screws securing the adapter cables to the frame. Save for the reinstallation.

Important Note

A 3745-17A does not support 2 TRAs.

If you convert a 3745 Models 130, 150, or 160 there will a need to fit BPC1 cards in empty slots as stated in step 4.0 Preparation under the heading **Additional Information**.

Part numbers required are as follows:

- BPC1 card 03F4372.
- Extender 1953093.
- Retainer 1953110.

- ___ 2. Remove the tailgate and install a dummy plate (PN 58X9369).

10.10.3 Power and Fan Cables

- ___ 1. Locate the PS1 and the fan 2.

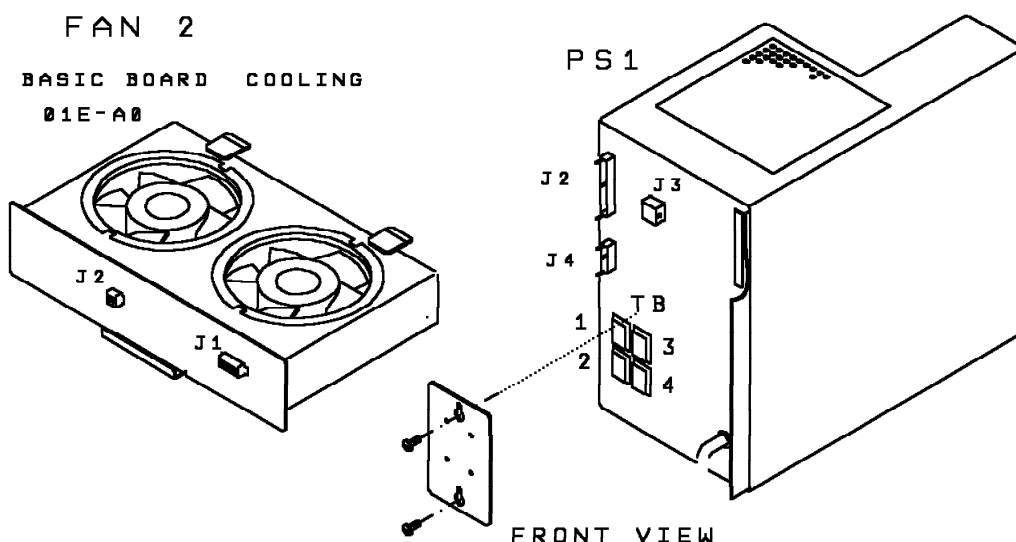

- ___ 2. On the PS1, remove the plastic cover from the TB, and disconnect the FDS cables from TB3, TB1, TB4, and TB2.
- ___ 3. Disconnect the multivoltage cable from the connector J4.
- ___ 4. On the fan box asm, unplug the air flow detector cable from J1 and the power cable from J2.

- ___ 5. Remove the fan box (two screws) from the enclosure. Save for reinstallation.

10.10.4 Card Removal

- ___ 1. Remove the crossovers from the cards, and note their positions.
- ___ 2. Remove all cards, bypass cards, and spacers from the board. Disconnect the cables. Be sure that the cards are labeled according to their positions (use label PN 811825).

Note: The TIC2 and FESH/CSC/EAC cards have cables plugged on, **note their positions.**

- ___ 3. Keep the cards and crossovers in a safe place.

10.10.5 Base Board Enclosure Removal

- ___ 1. Unplug the 4 cables from positions A2, B2, A3, and B3 of the MOSS board.

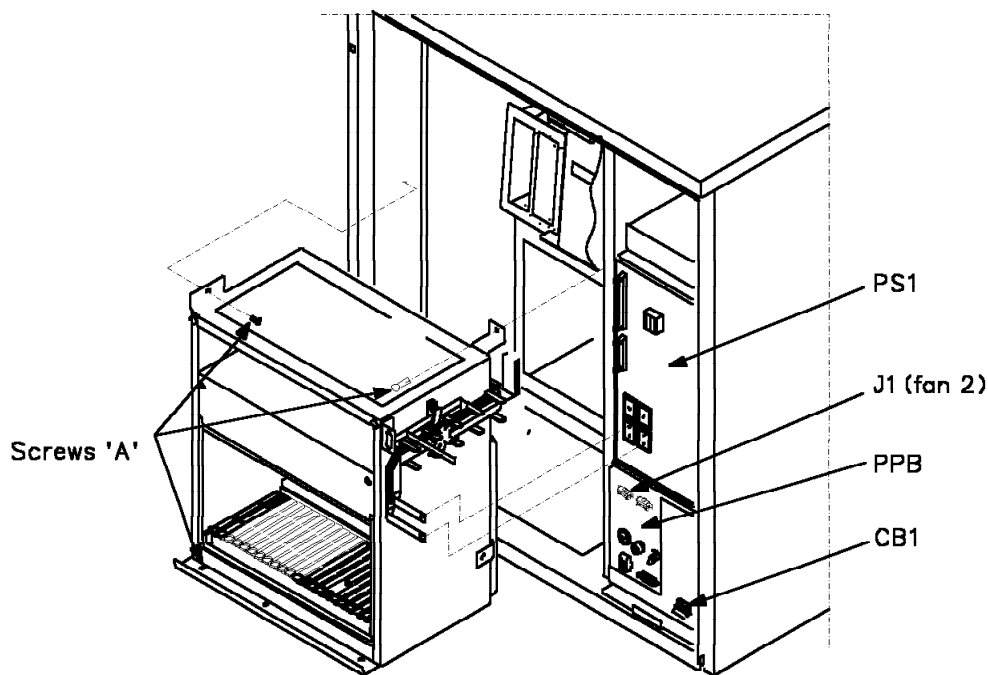

- ___ 2. Remove the enclosure (five screws 'A') from the frame, taking care not to damage the cables.

10.11 LIB3 Board Removal/LIB1 Board Installation

- If you are converting a 3745/150 with a LIB3 installed in 01M-A2 (a LIB3 is populated with cassettes labeled LIC5 and/or LIC6), go to 10.11.1, "LIB3 Board Removal."
- Otherwise, go to Step 10.12, "EPO Switch Exchange" on page 16.

10.11.1 LIB3 Board Removal

- ___ 1. Remove cover 'A' with two screws and cover 'B' with two screws.
- ___ 2. Keeping the external LIC cables and MUX cable connected on cassettes, remove up to 4 LICs and the DMUX card from board.
- ___ 3. Unplug the power cable from LIB board.
- ___ 4. Remove the LIB3 from the machine (four screws).

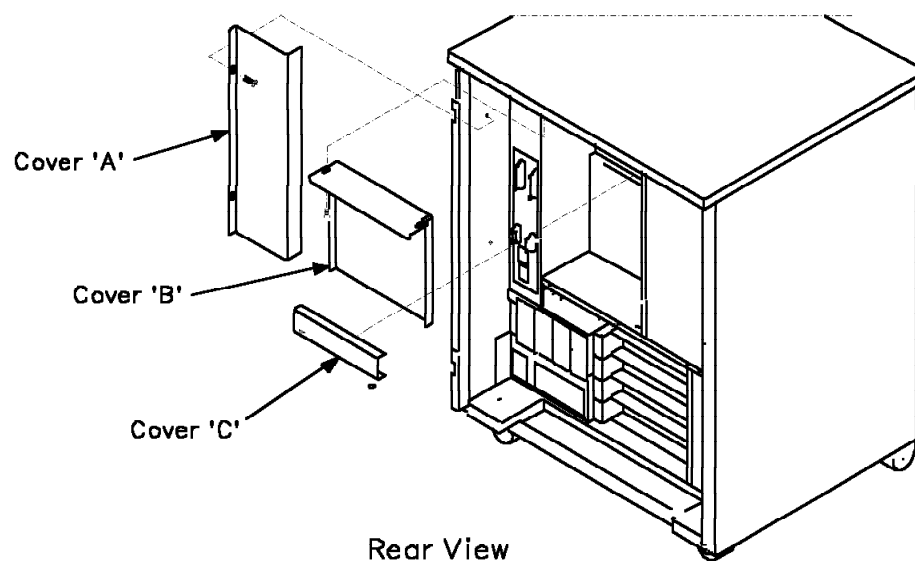

10.11.2 Installation of the LIB1 Board

The parts for LIB1 installation are coming with FFBM 57G7496.

3745 FFBM	PN 05F2599 14 of 22	See EC History	EC D55799 16SEP94	EC D55883 11MAY95	EC D55889 04SEP95	EC E27926 14MAR97
--------------	------------------------	-------------------	----------------------	----------------------	----------------------	----------------------

- ___ 1. Set the LIB1 board address as follows:

LIB1 Position	Switch Positions				
	5	4	3	2	1
01M-A2	0	0	0	0	0

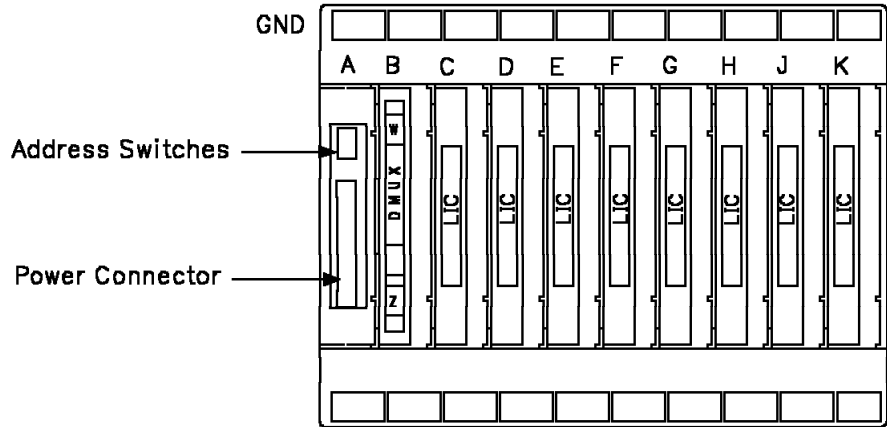

- ___ 2. Install the LIB1 ASM with four screws (PN 1621210).
 ___ 3. Plug one end of the power cable (PN 03F4514) in board power connector and the other end in position 01F-A1J6 (rear of the Power Supply Type 1).

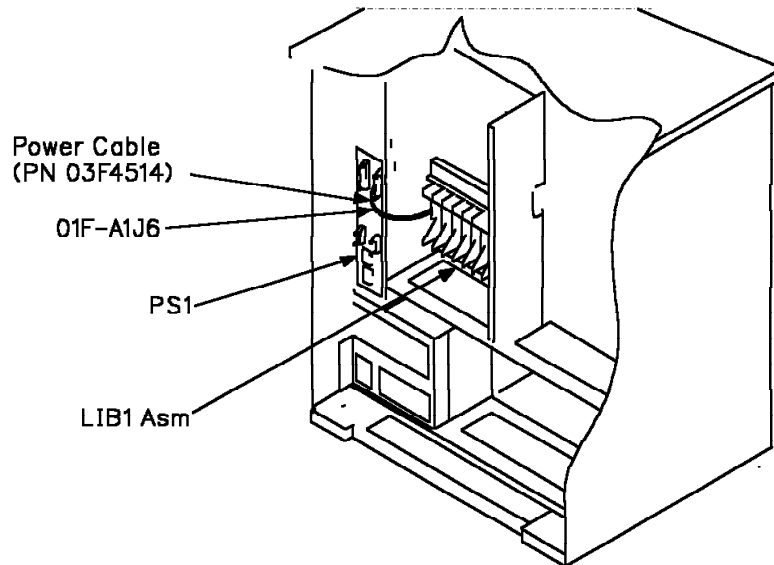

- ___ 4. Plug DMUX card in position B0 of the board.

Notes:

- a. If you have to install TSS via others MESs, you can perform their installation at this time.
 b. You may have spare scanner(s) installed on the machine with MUX cable(s) saved in the right side of basic board in front of the machine. If present, connect them.
 ___ 5. Reinstall cover 'A' with two screws and cover 'B' with two screws.

10.12 EPO Switch Exchange

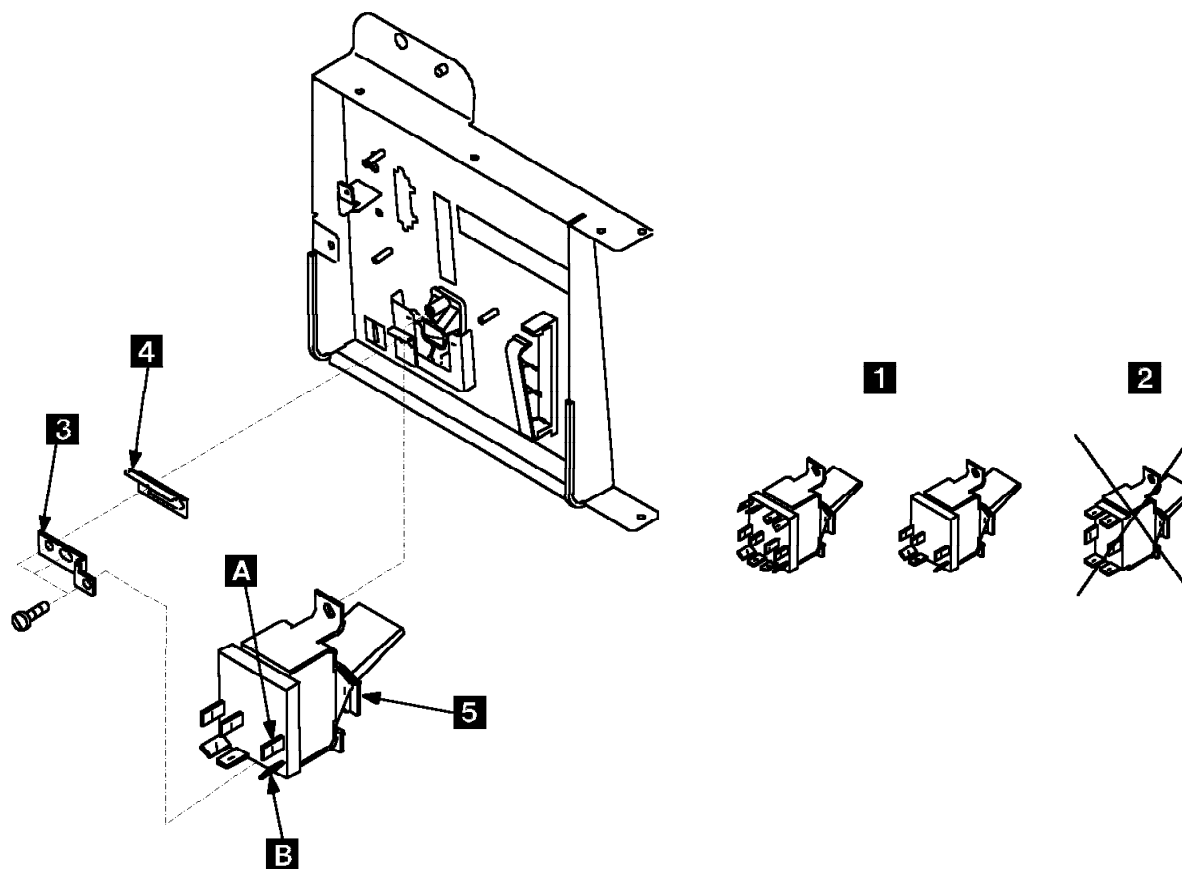

- 1. Open the 3745 control panel gate.
- 2. From the rear of the gate, locate the EPO switch, and compare with the above figure:
 - If it looks like switches **1**, the replacement is not required. Close the control panel gate and go to Step 10.13, "New Enclosure Installation" on page 17.
 - If it looks like switch **2**, you must install the switch (PN 8492368) with the bracket (PN 43G3154) provided by the FFB/M as follows:
 - a. Remove the bracket **3** by removing three screws. Save screws and spring **4**.
 - b. Remove the switch **5** by removing the upper screw. Save the screw.
 - c. Install the new EPO switch using the screw saved in previous step.
 - d. Install the new bracket **3** and the spring **4** using the three screws saved earlier.

Note: Push the spring to the right for switch locking.

 - e. Disconnect the wires from the old switch. Reconnect one wire (1) on contact **A** and second wire (2) on contact **B**.
- 3. Close the control panel gate.

10.13 New Enclosure Installation

- 1. Install the new enclosure (5 screws 'A') in the frame, taking care not to damage the cables (see figure in Step 10.2.2.5).
- 2. Route the cables from the base board to the PS1. Reconnect the FDS cables and the multivoltage cable.
- 3. Reinstall the fan asm (two screws), and reconnect the power and the air flow detector cables.
- 4. Plug the four flat cables according to their labels in the MOSS board (A2/B2/A3/B3).

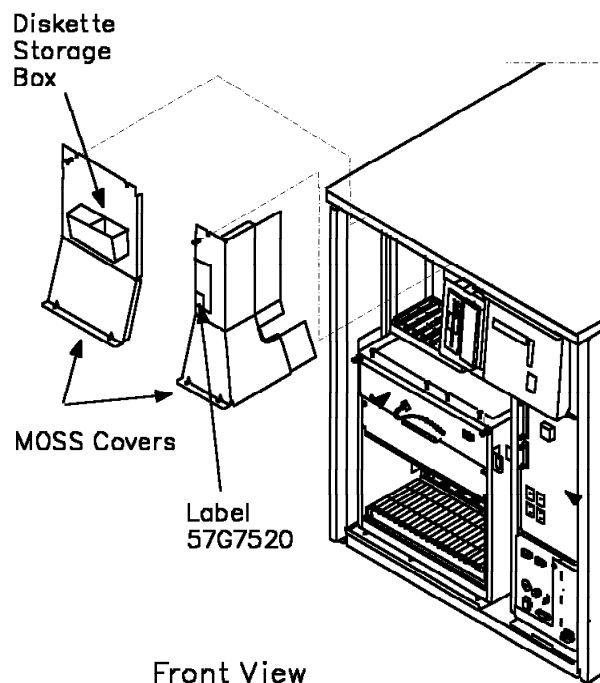

10.13.1 Card Reinstallation

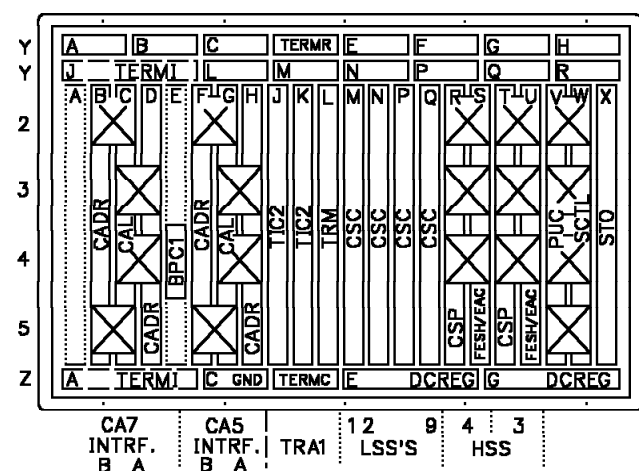

- 1. According to their labels, reinstall the cards/fillers/Bypass cards in the board.

Note: Reconnect the adapter cables on the cards before locking.

- 2. Reinstall the crossovers.
- 3. Secure the adapter cables with the clamps and screws on the enclosure.

Note: If you have received additional feature(s), proceed to the installation at this Step.

10.14 Covers

- 1. Reinstall the MOSS board and CCU board covers.
- 2. Affix on the left MOSS cover the diskette storage box (PN 57G7502).

10.15 CA(s) Reconnection

- 1. Reconnect CA(s) if previously removed and reinstall the CCU grid.
- 2. Set the select out bypass switch to the NORMAL position on each tailgate.

10.16 Standoffs

Note: 8 standoffs should be present in a 3745-17A.

- • If necessary, install standoffs (PN 03F4507), screws (PN 79778) and a seal (PN 03F5266) provided with FFBM 57G7495/6/7.

10.17 Labels

- 1. Affix on the right MOSS cover the label (PN 57G7520) over the console marks.
- 2. Affix on the rear cover the label (PN 76F9055) over the existing one.
- 3. Affix on the rear cover the label (PN 57G7536) over the console marks.

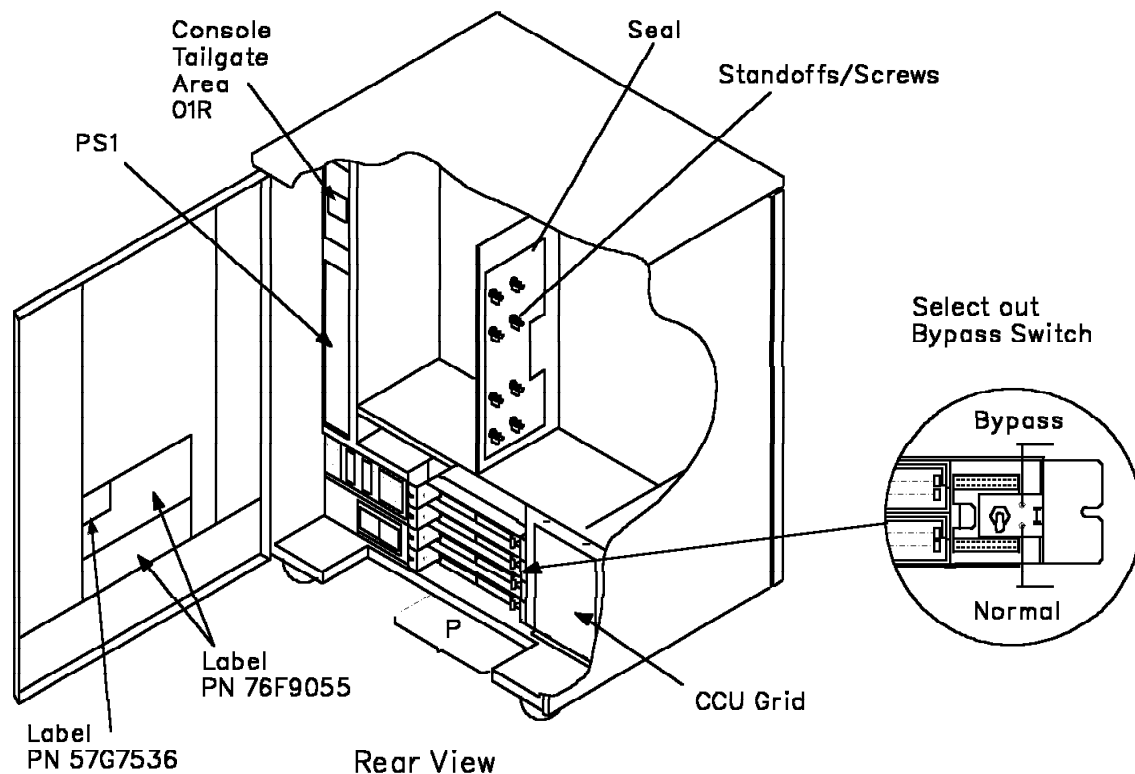

10.18 Name Plate

1. Remove the name plates from the front and back system covers.
2. Clean the adhesive residue from the recessed area of covers with Freon or Isopropyl alcohol.
3. Remove the paper from the back of the new name plates (PN 57G7515) and stick in place.
4. Strike out the model number on the S/N label located on the Control Panel. Now only the name plate will identify the model number.

10.19 Power ON

Switch **CB1** ON and close the system cover(s).

10.19.1 MOSS IML

From the control panel:

1. Set the **Function** indicator to 1.
Press the **Validate** key.
2. Set the **Service Mode** indicator to 2.
Press the **Validate** key.
3. Press the **Power ON Reset** key.

- The **MOSS IML** is completed when **F0E** is displayed on the control panel.
- If another code is displayed, see the *MIP*, Chapter 2.

10.20 3745 MCLs

- If the diskette *3745 MCL Backup* received with this microcode contains MCLs continue with the following procedure.
- Otherwise, go to Step 10.21, "Access to 3745 MOSS" on page 19.

10.20.1 Retrieve 3745 MCLs from Diskette

From the Service Processor:

1. Double click on the SP icon.
2. Click on **Change Management**. Then, double click on **Manage Microcode Changes**.
3. On the **Change Microcode** screen, click on **Retrieve microcode changes**. Then, click on **OK**.

3745 FFBM	PN 05F2599 18 of 22	See EC History	EC D55799 16SEP94	EC D55883 11MAY95	EC D55889 04SEP95	EC E27926 14MAR97
--------------	------------------------	-------------------	----------------------	----------------------	----------------------	----------------------

- ___ 4. Click on **Retrieve from diskette**. Then, click on **OK**.
When requested, insert the *3745 MCL Backup* diskette in the SP diskette reader.
- ___ 5. Click on **ALL changes**, then click on **OK**.
- ___ 6. To confirm your choice, click on **OK**. Then, follow the prompts.
- ___ 7. When **Retrieve completion** is displayed, click on **OK**.
- ___ 8. On the **Change Microcode** screen, click on **Display cover letter**, and click on **OK**. The cover letter may contain prerequisites or corequisites needed before applying the MCLs.
- ___ 9. Click on **Cancel** to exit.

10.20.2 Transfer MCLs to MOSS Disk

Establish the MOSS session:

- ___ 1. When the 3745 icon is PURPLE on the **3745 Menu** window, double click on **MOSS Console**.
Wait for **Function Selection Rules** screen.
- ___ 2. Enter **MCF**, press **Enter**.
- ___ 3. Enter **2** (copy the MCL file), press **Enter**. Follow the prompts until the function is completed, press **F6**.

10.20.3 Applying MCLs on 3745

- ___ 1. On the **Microcode fixes** screen, select option **1**, press **Enter**.
- ___ 2. Select option **2**, enter the date, press **Enter**. When the function is completed, press **Enter**.
- ___ 3. On the 3745 control panel, press the **Power on Reset** key to perform a MOSS IML and to validate the MCLs.

10.21 Access to 3745 MOSS

- ___ 1. Wait until the 3745 icon becomes PURPLE.
- ___ 2. On the **3745 Menu** displayed, double click on **MOSS Console**.

Wait for **Function Selection Rules** screen.

11.0 Test Procedures

11.1 Diagnostics

11.1.1 Update Scheduled Power ON

- ___ 1. Enter **TIM**, press **Enter**.
- ___ 2. Update the screen according to the data recorded in Step 10.1.1.4, "Record Scheduled Power ON" on page 6. Press **Enter**.
- ___ 3. Press **F1**.

11.1.2 Verify the CDF

- ___ 1. Enter **CDF**, press **Enter**.
- ___ 2. Enter **4** (VERIFY), press **Enter**.
The value from the **CDF DATA** and the **MACHINE DATA** should be identical except for the new hardware you have just installed, enter **2**, press **Enter**. If there is another discrepancy, check the IOC bus cables setting on the MOSS board.
- ___ 3. When **CDF VERIFY COMPLETED** is displayed, press **F1**.

11.1.3 Diagnostics

- ___ 1. Enter **ODG**, press **Enter**.
- ___ 2. Enter **1** (ALL), press **Enter**.
 - If **NO ERROR FOUND** displayed, press **F1**.
 - Otherwise, see the *MIP*, Chapter 1.

3745 FFBM	PN 05F2599 19 of 22	See EC History	EC D55799 16SEP94	EC D55883 11MAY95	EC D55889 04SEP95	EC E27926 14MAR97
--------------	------------------------	-------------------	----------------------	----------------------	----------------------	----------------------

11.2 Record the 3745 Model

From the Service Processor:

- ___ 1. On the **Service Processor** menu, double click on **Manage 3745/3746-900 Installation**.
- ___ 2. Click on the line of the 3745 you have just converted.
- ___ 3. Click on **Change**.
- ___ 4. On **Controller Model Change** message, click on **Yes**.

From the 3745 control panel:

- ___ 5. Press the **Power OFF** key.
- ___ 6. Set the **Service Mode** indicator to 2. Press the **Validate** key.
- ___ 7. Set the **Function** indicator to 1. Press the **Validate** key.
- ___ 8. Press the **Power On Reset** key. The MOSS IML is completed when **F0E** is displayed on the control panel.

From the Service Processor:

- ___ 9. Click on **OK**. The 3745 Model number is being recorded.
- ___ 10. When the operation is completed, click on **OK**.
- ___ 11. Click on **Cancel**.
- ___ 12. On the **3745 Menu** window, double click on **MOSS Console**.

Wait for **Function Selection Rules** screen.

11.3 Install latest MCLs.

Prior to returning the 3745 to the customer, you must install the latest MCLs.

- ___ 1. If you have an RSF link: Refer to the *SP Installation and Maintenance* Manual. Follow the procedure **Reporting problem to retain** in Chapter 3 and, when requested enter **Converting a Model A and testing the RSF link** as short description of the problem. The

latest MCLs are automatically downloaded. Then go to **:Handling Microcode Change level** in Chapter 3. When the RSF link is completed and the MCLs are installed, go to 11.4, "Close MOSS/MOSS-E Session."

- ___ 2. If you use the LIC Upgrade kit: Refer to the *SP Installation and Maintenance* Manual. Follow the procedure **Installing a new version of the Licensed Internal Code** in Chapter 3. When done go to 11.4, "Close MOSS/MOSS-E Session."
- ___ 3. If you use the 3746 Optical Disk MCLs: Refer to the *SP Installation and Maintenance* Manual. Follow the procedure **Handling Microcode Change Level** in Chapter 3. When done go to 11.4, "Close MOSS/MOSS-E Session."

11.4 Close MOSS/MOSS-E Session

- ___ 1. Wait until 3745 Icon is purple, then on **3745 Menu**, double click on **MOSS Console**. Wait for **Function Selection Rules** screen.
- ___ 2. Enter **CID**, press **Enter**.
- ___ 3. Re-enable the channel adapters disabled in Step 10.1.1.2, "From the Local Console" on page 6.
- ___ 4. When all CAs are enabled, press **F1**.
- ___ 5. Enter **OFF**, press **Enter**.
- ___ 6. On the **3745 Menu** window, click on **Function**, then click on **Exit**.

The session between the MOSS and the Service Processor is closed.

11.5 General IPL

From the 3745 Control Panel:

- ___ 1. Set the Power control indicator to its original value recorded in Step 10.1.1.
- ___ 2. Set the **Service Mode** indicator to 0. Press the **Validate** key.

3745 FFBM	PN 05F2599 20 of 22	See EC History	EC D55799 16SEP94	EC D55883 11MAY95	EC D55889 04SEP95	EC E27926 14MAR97
--------------	------------------------	-------------------	----------------------	----------------------	----------------------	----------------------

- ___ 3. Set the **Function** indicator to **0**. Then, press the **Validate** key.
- ___ 4. The general IPL starts.
 - If **FF4** code is displayed on the control panel, ask the customer to load the control program.
 - If the control program is loaded from the hard disk, **000** will be displayed when **IPL** successful.

Note: The control program can fail if a mismatch exists between the control program and the hardware configuration.

From the Service Processor

- ___ 5. On the **MOSS-E View** window, double click on the **ICON** of the 3745 you have just installed.
- ___ 6. On the **3745 Menu** displayed, double click on **MOSS Console**.
- ___ 7. Wait for **Function Selection Rules** screen.

11.6 Save Disk Contents onto Diskettes

- ___ 1. If NCP is restarted and MOSS ON-LINE, set the MOSS OFF-LINE, enter **MOF**, press **Enter**.
- ___ 2. Select **DIF**, press **Enter**.
- ___ 3. Select **2**.
- ___ 4. Enter the save-ID and press **Enter**.
- ___ 5. Follow prompts on console.
- ___ 6. When function completed, press **F1**.

11.7 Close MOSS/MOSS-E Session

- ___ 1. Enter **OFF**, press **Enter**.
- ___ 2. On the **3745 Menu** window, click on **Function**. Then, click on **Exit**.
- ___ 3. On **MOSS-E View** window, click on **Program**.
- ___ 4. Click on **LOG OFF MOSS-E**.

11.8 Re-Packing

- ___ 1. Place all the parts removed from the 3745 in the MES packing (MOSS board assembly, console tailgate, console cables).
- ___ 2. If a Service Processor and a new RSF modem have been provided with the MES, disconnect the previous 3745 RSF modem, remove the RSF cable and put them in the MES packing.
- ___ 3. If a new RSF modem has not been provided, remove the previous RSF cable from the 3745 and put it in the MES packing for return.

Note: In US/Canada, the modem is integrated in the Service Processor.

11.9 3745 Local Console

- ___ • Disconnect the previous 3745 local console and return it to customer.

3745 FFBM	PN 05F2599 21 of 22	See EC History	EC D55799 16SEP94	EC D55883 11MAY95	EC D55889 04SEP95	EC E27926 14MAR97
--------------	------------------------	-------------------	----------------------	----------------------	----------------------	----------------------

After Installation (steps 12-15)

12.0 Field Updating

None.

13.0 Publications Update

Replace with received documentation.

14.0 Parts Disposition

- For parts listed in the RMER

All these parts become the property of IBM.
 You **MUST RETURN** these parts following the instructions given on the Returned Material Equipment Report (RMER) provided with this FFBM.

- For parts not listed in the RMER

All these parts should be returned according to your local procedure.

15.0 Machine Records

- Install the new **MACHINE HISTORY** supplied.
- Report installation (as MES activity) and quality to existing procedures.

End of instructions.